



Board of Architectural Review (BAR) Certificate of Appropriateness

Please Return To: City of Charlottesville
Department of Neighborhood Development Services
P.O. Box 911, City Hall
Charlottesville, Virginia 22902
Telephone (434) 970-3130 Fax (434) 970-3359

Please submit ten (10) copies of application form and all attachments.

For a new construction project, please include \$375 application fee. For all other projects requiring BAR approval, please include \$125 application fee. For projects that require only administrative approval, please include \$100 administrative fee. Make checks payable to the City of Charlottesville.

The BAR meets the third Tuesday of the month.

Deadline for submittals is Tuesday 3 weeks prior to next BAR meeting by 4 p.m.

Owner Name	<u>Voe and Bobby Montgomery</u>	Applicant Name	<u>Bobby Montgomery</u>
Project Name/Description	<u>Ext. changes to unit a23</u>	Parcel Number	<u>040304500</u>
Property Address	<u>1215 Wertland St A23, Charlottesville Va 22903</u>		

Applicant Information

Address: 1810 Edgewood Lane
Charlottesville Va 22903
 Email: voeandbobby@gmail.com
 Phone: (W) 434-466-5650 (H) 434-466-5645
 FAX: 800-210-8518

Property Owner Information (if not applicant)

Address: _____
 Email: _____
 Phone: (W) _____ (H) _____
 FAX: _____

Do you intend to apply for Federal or State Tax Credits for this project? no

Signature of Applicant

I hereby attest that the information I have provided is, to the best of my knowledge, correct. (Signature also denotes commitment to pay invoice for required mail notices.)

11/23/2014

Signature

Date

Bobby Montgomery 11/23/2014

Print Name

Date

Property Owner Permission (if not applicant)

I have read this application and hereby give my consent to its submission.

Signature

Date

Print Name

Date

Description of Proposed Work (attach separate narrative if necessary): Replace 9' sliding door with 6' sliding door and window

List All Attachments (see reverse side for submittal requirements):

Approval of hoa board of directors. Floor plan & elevation of change photos of rear of condominium building, deck from walking path and view from deck.

For Office Use Only

Received by: W. Eubank
 Fee paid: 1001.00 Cash/Ck. # 524
 Date Received: 12/2/14

Approved/Disapproved by: MJ Scala
 Date: Dec. 3, 2014

Conditions of approval: New sliding door + window to match others (aluminum) on building; Window + door trim to match existing; Siding to match existing.

November 19th, 2014

To: Corner Village Board of Directors

Re: Proposal for Exterior Changes to Unit A23

To whom it may concern,

I request your approval for the following alterations to the existing nine foot slider door leading to the outside deck.

1. Remove existing 9 ft. sliding door to rear deck.
2. Install new 6 ft. sliding door with Screen door
3. Frame new wall with 2x4 material
4. Install 48" x 26" (approx) single casement window
5. Finish off inside with 1/2" drywall, tape and finish
6. Finish off exterior to match existing painted plywood look.

Please find attache floor plan and elevation drawing showing these changes.

Thank you

Yours truly,

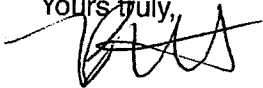

Bobby Montgomery

THE CORNER VILLAGE UNIT B33

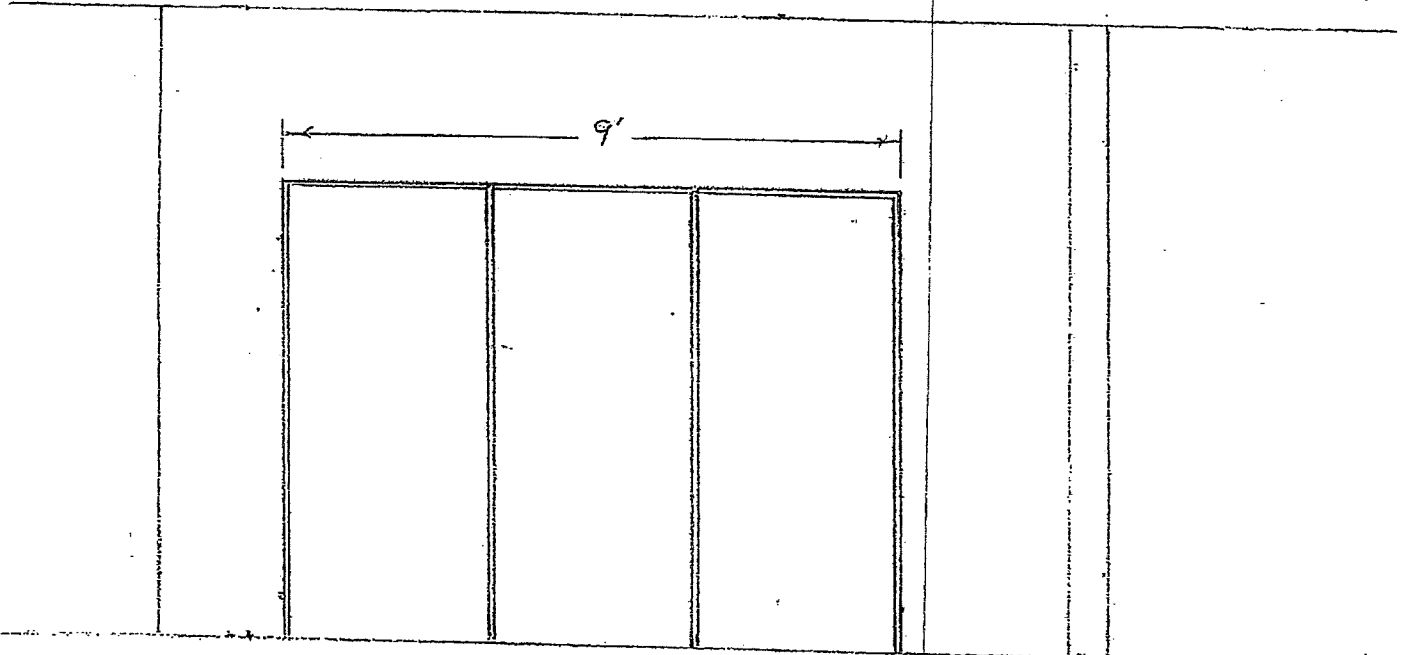

CURRENT 3 SLIDING DOORS TO DECK

$\frac{3}{8}'' = 1'$

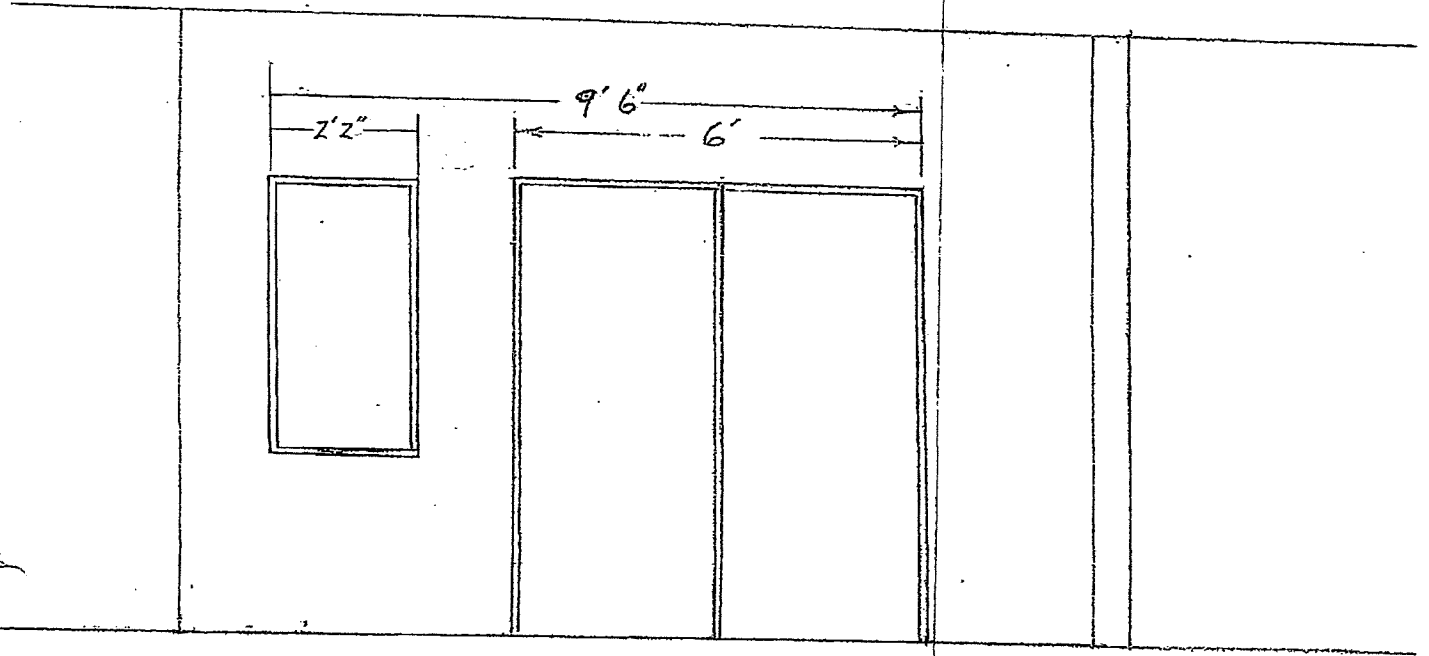

REPLACE WITH 2 SLIDING DOORS & WINDOW

THE CORNER VILLAGE UNIT B-33

DECK

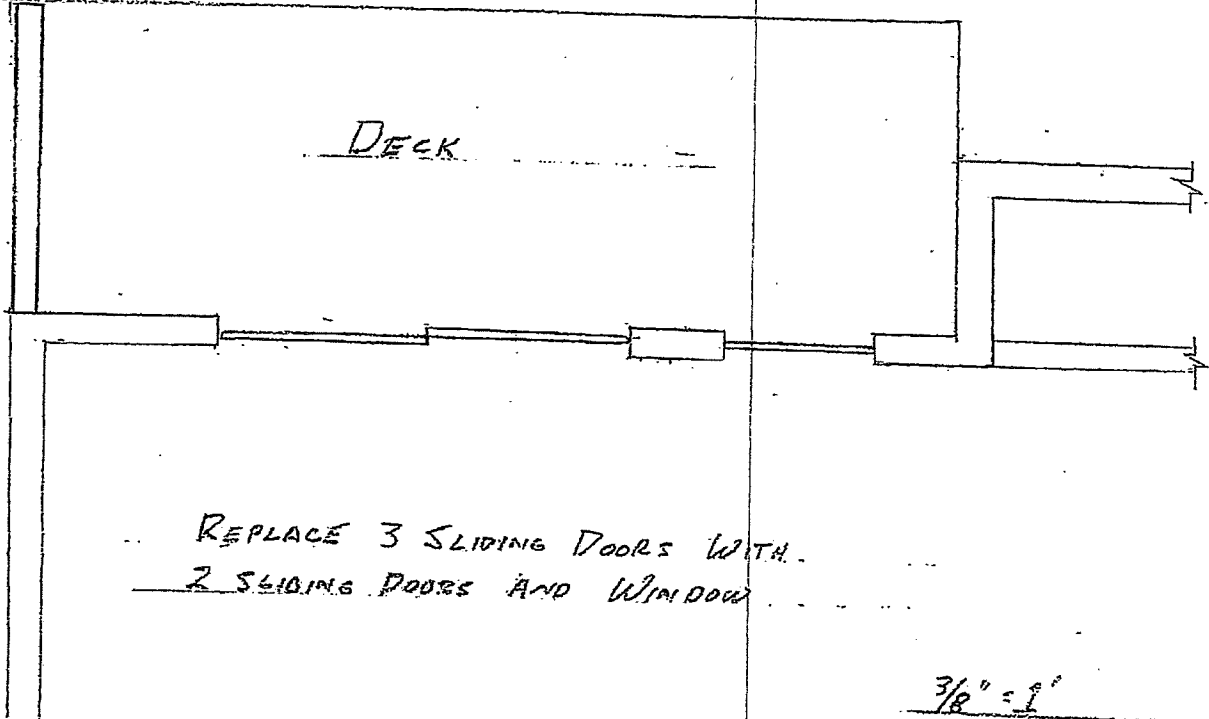

REPLACE 3 SLIDING DOORS WITH
2 SLIDING DOORS AND WINDOW

$\frac{3}{8}'' = 1'$

