

28-105 ✓

Matacía Fruit Co,
320 ~~Smith St~~

49.7 x 189.48 }
28.93 x " } 12,057
M-1
#533

- 396-660 H M Gleason Co, Inc 1978 PO Box 290 plot 396-662 (part - city)
- 343-558 " " 1973 " 13-16
- 280-445 Carmelino F. Matacía, et al 1966 (int. Portner S.F.)
- 253-138 " , W.V., L.A., & E.T. Matacía "
- 226-469 " " 1961
- 163-80 " Matacía et al 1952
- 115-204 August "

Storage

1-5 re-inforced conc faced w/ brick
 conc blk found, brick & conc walls, built-up flat roof
 built 1927-1957
 1978 - addn to office area

Built 1927

Prog. 4/13/62 - Hist Shrivels - p 8
Business 775 yr old
320 Second St SE

1962
- 75
1884

1914-15
1910-11, City Dir August Matavia, fruits, 112 W. Main W.

Built 1927

320 ~~South 1st~~

116-204 W O Fife, Spec Commr, ~~1st~~ → A. Matacía, Louis J. Matacía,
4/30/1943 Carmelino Matacía, & Wm Matacía
lot bet South 1st, ^(49.7') & South 2nd (79.4')
same as 76-462 ~~(see plat)~~
Matacía Fruit Co, Inc, dissolved 12/27/1938

76-462 A. & Rosa Matacía, Louis J. & Anna Matacía, Carmelino F
2/1/1932 ~~Matacía~~ & Louise Matacía, Wm V & Clara Matacía
→ Matacía Fruit Co, Inc
bounded by S 1st, C & O, S 2nd, C & O siding
same as 55-147
A. Matacía contracted 7/28/31 to sell $\frac{3}{4}$ int in all property
used by fruit Co.

55-147
11/4/1926 Albert S Bolling, spec commr in chancery came Ballard
or Ballard, → A. Matacía \$6,000
tract bounded by C & O, ~~siding~~, ^{49.7'} 1st, & ^{79.4'} 2nd, & E L Carroll
property on south across C & O siding
same as 18-314 (see plat 13-16)

18-314 Robert Portner Brewing Co → Mrs L. Ballard \$3,800
4/29/1907 tract bounded by C & O, 2nd, 1st, & Carroll (across siding)
Carroll had siding built 1902 (see plat 12-378)
same as 13-1445

13-14
4/15/1902 E L & Nannie N Carroll → Robt Portner Brewing Co
in exchange for property on Main St
lot bounded by C & O, S 2nd, ^{49.4'} 51st, ^{49.7'} & Carroll

Tax - Matatia

1925	3rd	Wm L Ballard est	cor 1st x 200	2500 + 800 = 4300	
1927	"	A. Matatia	" "	3900 + " = 4700	fr Wm Ballard est
1928	"	" "	" "	" + 10,400 = 23,200	bl'd added

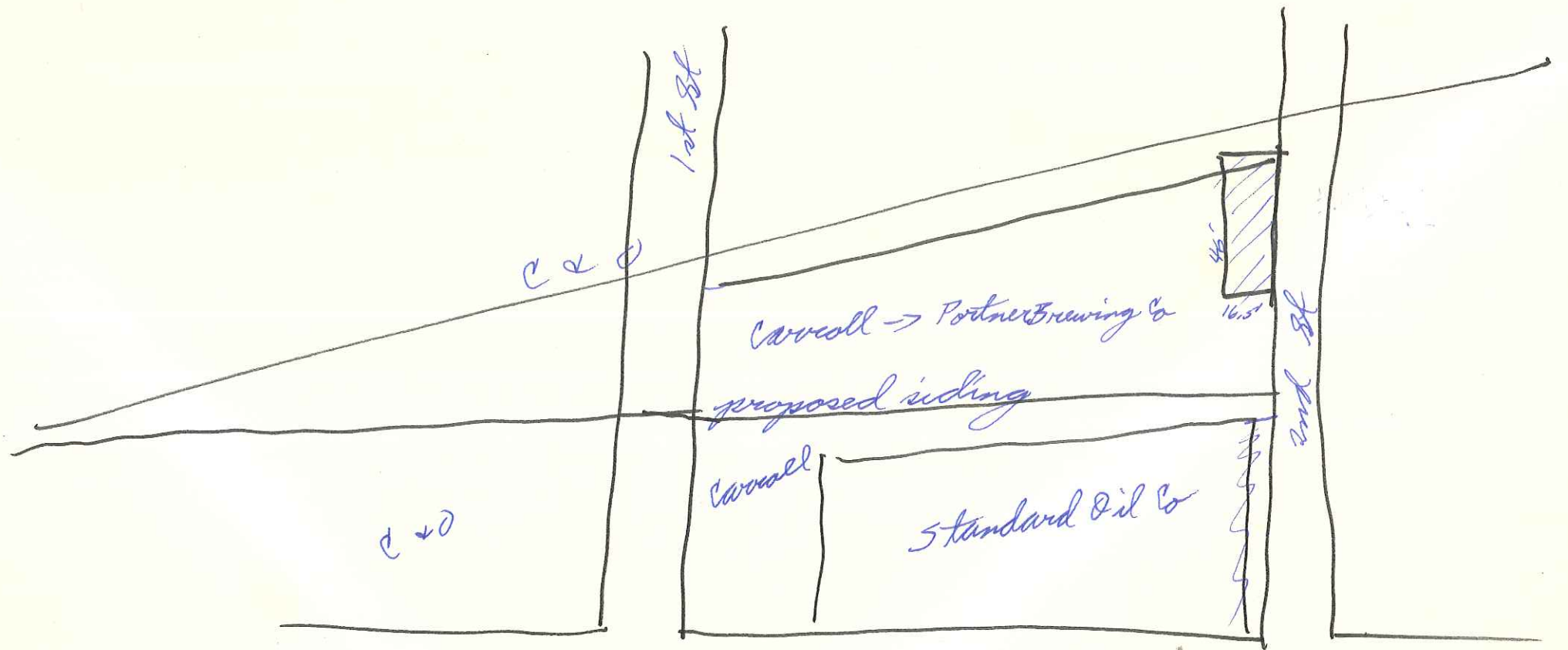

Gawwett St

found. -
~~ent. entered?~~

flat roof, tiled parapet
7-c am, mostly

E

8 + ⁵proj, ^{metal} ~~corr~~ iron flush

1 - door - l

2) ^{4,5} 6-l ind w 

3 - pr ent doors, glass, 6-l w above 

~~3,4~~ ⁶ warehouse, corr, ⁺ metal, " "

7 - sm 4-l

8 - blank

proj - door onto dock, 12-l ^{on} facade
corr metal awning over loading dock
on N wall & B

S

7 ~~bay~~ before

1, 3, 4, 6, 7 = 12-l wind

2 - sm wind w/ ^{12-l} sm above ^{6-l}

5 - same door w/ sm above
int end chim 1-2

N

seam & int end chim 1-2

1 - 4-l

2, 3, 4 - 12-l } $\frac{1}{2}$

5 - 6-l

blank - "

