

Architectural And Historic Survey

Identification

STREET ADDRESS: 200 Sixth Street, NW

MAP & PARCEL: 32-124

CENSUS TRACT AND BLOCK:

PRESENT ZONING: R-3

ORIGINAL OWNER:

ORIGINAL USE:

PRESENT USE: Rental Property (2 apartments)

PRESENT OWNER: Glennie L. Walker

ADDRESS: 6304 Piney Branch Road, NW

Washington, D.C. 20011

HISTORIC NAME:

DATE / PERIOD: c. 1875-76

STYLE: Vernacular

HEIGHT (to cornice) OR STORIES: 2 storeys

DIMENSIONS AND LAND AREA: 39' x 140' (5460 sq. ft.)

CONDITION: Good

SURVEYOR: Bibb

DATE OF SURVEY: Spring 1984

SOURCES: City/County Records

1877 Gray Map

Sanborn Map Co., 1896, 1907, 1920

ARCHITECTURAL DESCRIPTION

This house was once owned jointly by four fraternal organizations, but it does not appear to have been used as anything other than a residence. It is a 2-storey, 3-bay, single-pile vernacular house with a 2-storey rear addition making it double pile. It is set on a low brick foundation, Walls & foundations are faced with stucco painted a light moss green with white trim. The original section of the house has a steep gable roof with projecting eaves and everges, a boxed cornice with returns, and a plain frieze. It is covered with composition shingles. A central gable on the facade emphasizes the asymmetrical fenestration. The center and north openings are perfectly spaced for a 2-bay facade, which may have been the original plan. The south opening is far to one side and may have been a later addition to provide more light for a dark hall. Windows are double-sash, 2-over-2 light, with rudimentary architrave surrounds. They are somewhat shorter at the second level. There is a one-storey semi-octagonal bay window in the northern bay of the facade. It has a steep hip roof covered with composition shingles, a boxed cornice and a frieze with dentil moulding. Any other details are now covered by the stucco. There is a 2-over-2 light window in the center plane and 1-over-1 light windows at the sides. A one-storey veranda covers the southern half of the facade. It has a steep hip roof covered with composition shingles, with a boxed cornice, a plain frieze, battered piers covered with stucco and set on stuccoed pedestals, and a concrete floor at ground level. The entrance in the center bay of the facade has a door with a single large pane of glass and single-paned leveled sidelights and rectangular transom. A 2-flight open stair with turned newels and balusters rises from the large square entrance hall in the southeast front corner of the house. The 2-storey rear addition is in two sections: the northern half has a medium-pitched gable roof with a boxed cornice with returns. Windows match those in the original section. The main roof continues as a lower-pitched shed roof over the southern half of the rear addition. Behind that is a later 2-storey wing with a nearly flat roof and smaller windows.

HISTORICAL DESCRIPTION

S. M. Parker purchased this lot in 1874 (ACDB 69-206) and sold it in 1879 to the trustees of the following organizations: Mentor Lodge (formerly Fairfax Taylor Lodge) No. 1453 of United Order of Odd Fellows; the Grand Union Belles; Tabernacle No. 42; Jefferson Lodge No. 20 of Ancient Free & Accepted Masons (ACDB 84-363). Tax records show no improvements on the lot as late as 1875, but the house appears on the 1877 Gray Map. Mary F. Alexander (Mrs. D. D. Alexander) bought the house in 1885, but the deed was not recorded until several years later (City DB 8-62). After her death, her heirs sold it in 1898 to the Rev. R. C. Wuarles, pastor of the First Baptist Church (DB 10-46). He sold it in 1914 to William Lightfoot, owner of the Manhattan Pool Room 9DB 26-330). He deeded it to his daughter Glennie L. Murray Walker in 1941 (DB 105-495), but continued to live there for the rest of his life. Mrs. Walker divided it into two apartments in 1957 and uses it as rental property.

32-124 ✓

R-3

#506

39x140

201 6th NW

6304 Piney Branch Rd NW
Walth. 200"

105-495

Glennie L M Walker 1961 (marriage)

"

" Lightfoot Murray

W m. "

1-fam^{or 2}, 2.5, base, 8 rooms
conc. found., stucco walls, metal gable roof
apt in garage 1951
cheap work, "old"
converted to 2 apt 1957

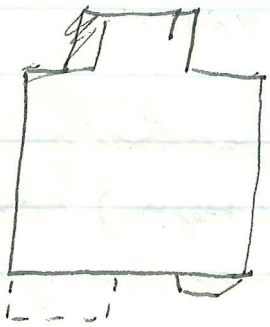

39
65
2910
2910
1068
1842

Sanborn —

1896 - looks narrower, porch across facade, no wing
~~or bay~~ (unless N portion not there)

1907 - same proportions as now

1877



1896



1907

1920

City Directories

- 1910-11 Rev. Robinson C. Quarles, pastor First Bap Ch, 201 6th NW
- 1914-15 Wm Lightfoot (proprietor Manhattan Pool Room) - 201 6th NW
- 1953 " "
- 1962 rented

- 105-495 Wm Lightfoot (wid) → Glennie Lightfoot Murray, gift
 3/12/1941 39'9" on 6th NW 147' west, 201 6th NW
 same as 26-330
 2 deeds of trust: 1934 & 1940
- 26-330 RC & Mary L Quarles → Wm Lightfoot #1600
 7/30/1914 39'9" on 6th NW 147'
 same as 10-46
- 10-46 Susie A. & Charles E. Maupin, ^{Annie B & James T Leitch,}
 11/1/1898 DW Alexander → RC Quarles for assumption of loan
 39'8" on 6th NW 147' W
 same as 8-62
 Mary F. Alexander dec. intestate leaving 3 heirs
- 8-62 Trustees of Mentor (formerly Fairfax Taylor) Lodge
 3/26/1885 No. 1453 of United Order of Odd Fellows;
 Trustees of the Grand Union Bells (at Chiville Va);
 " " Tabernacle No. 42; Trustees of Jefferson
 Lodge No 20 of Ancient Free & Accepted Masons
 → Mary F. Alexander (Mrs. D. D. Alexander)
 same as ACDB 84-363, 4/11/1879, for SM Parker
 39'8" on alley fr Main St to the Bee Home lot, x 140' back
 adj' Lewis & ^{Swuggs} lots
- ACDB SM & Marietta Parker → #210
 84-363 tract adj' lots of Wm Swuggs, MT Lewis, & W & Page,
 4/11/1879 fronting 39'8" on alley fr Main St to the Bee Home lot
 & ~~to~~ running 147' back to Page's lot
 same as 169-206

69-206 RF + E Liza H. Harris → JM Parker
10/12/1874 39'8" on st west of the Paston lot

205

201 6th NW

~~1875, 76, 77, 78~~ 5 M Parker $\frac{1}{4}$ or $\frac{1}{2}$ m.w. + - = 100 for R.F. Hood

1889 2nd David Alexander Howkins Hill + 350 = 600 Benj Kidd to Pay

1890 " " " " + 3500 = 6000 "

1891 2" " " Wide Hoop St + 350 = 600 "

1894 Alexander n.l.

1902 ^{N/W} 2nd Quarles n.l.

1887, ^{90, 91, 94} 4th Mrs Warner Alexander 5 side (C+O) Gospel Hill + 0 = 200

⁹⁵ 1896, 98, 99 ^{4th} Mary Alexander & chn Wide Hoop St 100 + 400 = 500 n.l. 1900

1902, 01 4th R.C. Quarles 201 6th St 100 + 400 = 500 for Mary Alexander & chn

1906, 08, 09, 10 " " " " 200 + " = 600

1911 " " " " " + 600 = 800

~~1887~~ 1887 Lodges n.l.

1886 Alexander n.l.

1888, 86, ^{84, 83} David Alexander (C) ^{1/2 m.w} - now extra - + 350 = 600

1881, 80, 78, ⁸² 5 M Parker 1/40 $\frac{1}{4}$ m.w. + 0 = ~~100~~

~~1884~~ " " " " + 350 = 450

1892 2nd ~~Mary~~ Alexander in front new add'n

1893 " Mary " n.l. ~~Wide Hoop St + 500 = 500~~

~~If anyone could find lat, he didn't know if there was a home.~~

Summary of property records for Mary Alexander

Summary

1875- 1882 ¹⁸⁸²	S M Parker	$\frac{1}{4}$ a $\frac{1}{2}$ m W	$100 + 0 = 100$ for R F Hoxie
1884	" "		" + 350 = 450

1875- 1891 ¹⁸⁹¹	David Alexander		$250 + 350 = 600$
---------------------------------------	-----------------	--	-------------------

1895-1899	Mary Alexander	- Wide Hoop. St.	$100 + 400 = 500$
-----------	----------------	------------------	-------------------

1901-1902	R. C. Quarles	- 201 6th St	" " " for Mary Alexander
-----------	---------------	--------------	--------------------------

1906-1910	" "	"	$200 + " = 600$
-----------	-----	---	-----------------

1911	" "	"	" + 600 = 800
------	-----	---	---------------

201 6th NW

1888 85, 82, 79
~~Alexander~~
David Alexander (c) ^{43/} - new entry - 748 + 350 = 600

summary

this house

other Alexander house

201 6th NW

2-5, 3 ≠ bays, single pile, w/ 2-5 rear wing, making it double pile

low found, (stuccoed) brick

lt moss green stucco, w/ white trim

steep gable roof, comp. shingles, proj eaves & cornice, boxed cornice, ^{w/ returns} pl frieze; steep cent gable w/ cornice returns centered on facade w/ circular air vent

center & N windows evenly spaced for 2 bays, 5 window sight in corner

conv-covered chim ^{N of center} ~~centered~~ to rear wall of main block

windows 2/2 w/ shorter 2nd (N end)



1-5 semi-act bay window in N bay of facade steep hip roof; comp shingles, boxed cornice, dentiled frieze, 2/2 + 1/1 windows

1-5 veranda covers rest of facade (1/2) steep hip roof, comp. shingles, pl frieze stuccoed battered piers on stuccoed pedestals

cent ent; glass door w/ 1-2 beveled sidelights & rest ^{transom} windows on N, not on S agst church

rear addn:

basement N $\frac{1}{2}$: med gable, boxed cornice w/ ^{windows} returns
S $\frac{1}{2}$: roof cont. \rightarrow rear as lower shed
behind S $\frac{1}{2}$: nearly flat roof, stuccoed
int end chim, windows smaller & 6/6

large sq ent hall SE

w/ 2-fl open stair w/ turned newels & balusters

