



VIRGINIA
HISTORIC LANDMARKS COMMISSION

File no. 104-70
Negative no(s). 5071(31)

SURVEY FORM

Historic name County/Town/City <u>Albermarle/Charlottesville</u> Street address or route number <u>16 Elliewood Ave.</u>	Common name
USGS Quad <u>Charlottesville West, Va</u> Original owner Original use Present owner Present owner address Present use <u>restaurant</u> Acreage	Date or period <u>1945</u> Architect/builder/craftsmen Source of name Source of date Stories <u>2 stories</u> Foundation and wall const'n Roof type <u>hip roof</u>

State condition of structure and environs good

State potential threats to structure
 Note any archaeological interest

Should be investigated for possible register potential? yes ___ no X

Architectural description (Note significant features of plan, structural system and interior and exterior decoration, taking care to point out aspects not visible or clear from photographs. Explain nature and period of all alterations and additions. List any outbuildings and their approximate ages, cemeteries, etc.)

Concrete block with brick trim; 3 bays. Colonial Revival. Box cornice. Entrance in south side of the building. Central bay has a large bay window (centre has 20 lights), the 2 side windows are 8/8 double sash. All other windows are 6/6 double sash.

Interior inspected? extensively remodeled

Historical significance (Chain of title; individuals, families, events, etc., associated with the property.)

(

--

Sources and bibliography

Published sources (Books, articles, etc., with bibliographic data.)

Primary sources (Manuscript documentary or graphic materials; give location.)

Names and addresses of persons interviewed

Plan (Indicate locations of rooms, doorways, windows, alterations, etc.)

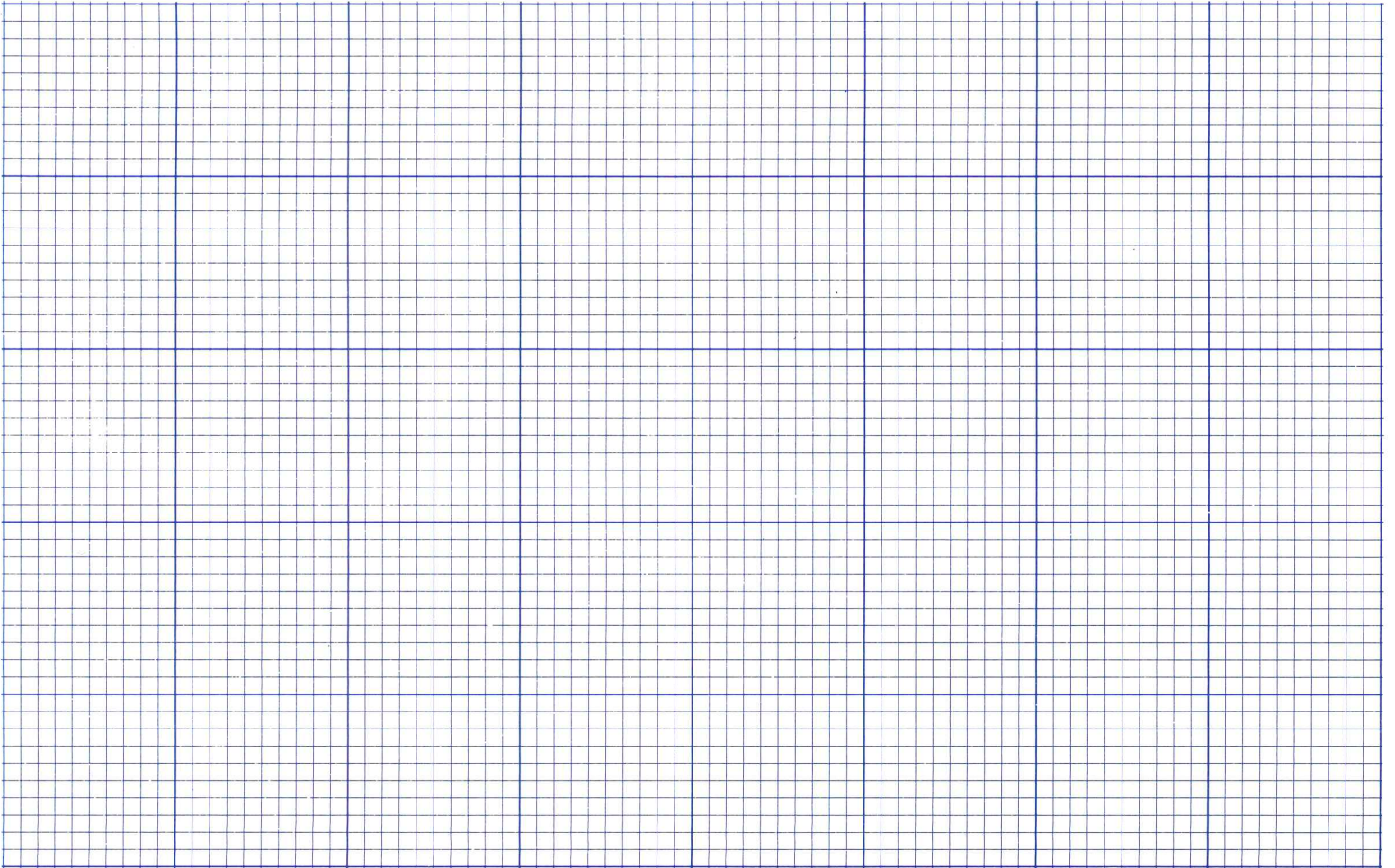

Site plan (Locate and identify outbuildings, dependencies and significant topographical features.)



Name, address and title of recorder

B. L. Boshen U. of VA Grad. Student

Date

3-7-80



**VIRGINIA
HISTORIC LANDMARKS COMMISSION
HISTORIC DISTRICT SURVEY FORM**

File No. 104-130
Negative no(s). 7234

Page 1 of 2

Street address 16 Elliewood Ave.
Town/City Charlottesville

Historic name _____ Common name _____

- Material
- wood frame (siding: weatherboard, shingle, aluminum, bricktex, _____)
 - brick (bond: Flemish, stretcher, _____-course American, _____)
 - stone (random rubble, random ashlar, coursed ashlar, _____)
 - log (siding: weatherboard, shingle, aluminum, bricktex, _____)
 - stucco
 - concrete block
 - enameled steel
 - other: _____
- cast iron
 - terra cotta
 - glass and metal

Number of Stories	Roof Type	Roof Material
<input type="checkbox"/> 1 <input type="checkbox"/> 2½ <input type="checkbox"/> 1½ <input type="checkbox"/> 3 <input checked="" type="checkbox"/> 2 <input type="checkbox"/> _____	<input type="checkbox"/> shed <input type="checkbox"/> mansard <input type="checkbox"/> gable <input type="checkbox"/> gambrel <input type="checkbox"/> pediment <input type="checkbox"/> parapet <input checked="" type="checkbox"/> hipped <input type="checkbox"/> flat <input type="checkbox"/> other: _____	<input type="checkbox"/> slate <input type="checkbox"/> tile <input type="checkbox"/> wood shingle <input type="checkbox"/> pressed tin <input checked="" type="checkbox"/> composition <input type="checkbox"/> not visible <input type="checkbox"/> standing seam metal <input type="checkbox"/> other: _____

Dormers	Number of bays — Main facade
<input checked="" type="checkbox"/> 0 <input type="checkbox"/> 3 <input type="checkbox"/> shed <input type="checkbox"/> hipped <input type="checkbox"/> 1 <input type="checkbox"/> 4 <input type="checkbox"/> gable <input type="checkbox"/> _____ <input type="checkbox"/> 2 <input type="checkbox"/> _____ <input type="checkbox"/> pedimented	<input type="checkbox"/> 1 <input type="checkbox"/> 4 <input type="checkbox"/> 7 <input type="checkbox"/> 2 <input type="checkbox"/> 5 <input type="checkbox"/> 8 <input checked="" type="checkbox"/> 3 <input type="checkbox"/> 6 <input type="checkbox"/> _____

Porch	Stories	Bays	General description
<input type="checkbox"/> yes <input checked="" type="checkbox"/> no	<input type="checkbox"/> 1 <input type="checkbox"/> 3 <input type="checkbox"/> 2 <input type="checkbox"/> _____	<input type="checkbox"/> 1 (center) <input type="checkbox"/> 2 <input type="checkbox"/> 4 <input type="checkbox"/> 1 (side) <input type="checkbox"/> 3 <input type="checkbox"/> _____	

Building type

- detached house garage government industrial
- detached town house farmhouse commercial (office) school
- row house apartment building commercial (store) church
- double house gas station railroad restaurant

Style/period Vernacular Date 1947 Architect/builder _____

Location and description of entrance Entrance (modern) is on the south side.



Miscellaneous descriptive information (plan, exterior and interior decoration, cornice/eave type, window type and trim, chimneys, additions, alterations)

Because of its basically Georgian form, this cinder-block house blends reasonably well with the older buildings on the street. Moreover, it stands well back from the street in a large shaded yard. The pergola was built in 1981 to serve outdoor diners.

Historical information

The restaurant Graffiti's was launched ca. 1980 and is a popular student watering hole, with live bands playing in the pergola on weekends.

Source Real Estate records; Sanborn maps

Surveyed by Jeff O'Dell, VHLC

Date 8-83



VIRGINIA HISTORIC LANDMARKS COMMISSION

HISTORIC DISTRICT SURVEY FORM

File No. 104-130
Negative no(s). 7233

Page 2 of 2

Street address **16 Elliewood Ave.**
Town/City **Charlottesville**

Historic name _____ Common name _____

- Material
- | | |
|--|--|
| <input type="checkbox"/> wood frame (siding: <input type="checkbox"/> weatherboard, <input type="checkbox"/> shingle, <input type="checkbox"/> aluminum, <input type="checkbox"/> bricktex, <input type="checkbox"/> _____)
<input type="checkbox"/> brick (bond: <input type="checkbox"/> Flemish, <input type="checkbox"/> stretcher, <input type="checkbox"/> ____-course American, <input type="checkbox"/> _____)
<input type="checkbox"/> stone (<input type="checkbox"/> random rubble, <input type="checkbox"/> random ashlar, <input type="checkbox"/> coursed ashlar, <input type="checkbox"/> _____)
<input type="checkbox"/> log (siding: <input type="checkbox"/> weatherboard, <input type="checkbox"/> shingle, <input type="checkbox"/> aluminum, <input type="checkbox"/> bricktex, <input type="checkbox"/> _____)
<input type="checkbox"/> stucco
<input type="checkbox"/> concrete block
<input type="checkbox"/> enameled steel
<input type="checkbox"/> other: _____ | <input type="checkbox"/> cast iron
<input type="checkbox"/> terra cotta
<input type="checkbox"/> glass and metal |
|--|--|

Number of Stories	Roof Type	Roof Material
<input type="checkbox"/> 1 <input type="checkbox"/> 2½ <input type="checkbox"/> 1½ <input type="checkbox"/> 3 <input type="checkbox"/> 2 <input type="checkbox"/> ____	<input type="checkbox"/> shed <input type="checkbox"/> mansard <input type="checkbox"/> gable <input type="checkbox"/> gambrel <input type="checkbox"/> pediment <input type="checkbox"/> parapet <input type="checkbox"/> hipped <input type="checkbox"/> flat <input type="checkbox"/> other: _____	<input type="checkbox"/> slate <input type="checkbox"/> tile <input type="checkbox"/> wood shingle <input type="checkbox"/> pressed tin <input type="checkbox"/> composition <input type="checkbox"/> not visible <input type="checkbox"/> standing seam metal <input type="checkbox"/> other _____

Dormers	Number of bays — Main facade
<input type="checkbox"/> 0 <input type="checkbox"/> 3 <input type="checkbox"/> shed <input type="checkbox"/> hipped <input type="checkbox"/> 1 <input type="checkbox"/> 4 <input type="checkbox"/> gable <input type="checkbox"/> _____ <input type="checkbox"/> 2 <input type="checkbox"/> ____ <input type="checkbox"/> pedimented	<input type="checkbox"/> 1 <input type="checkbox"/> 4 <input type="checkbox"/> 7 <input type="checkbox"/> 2 <input type="checkbox"/> 5 <input type="checkbox"/> 8 <input type="checkbox"/> 3 <input type="checkbox"/> 6 <input type="checkbox"/> ____

Porch	Stories	Bays	General description
<input type="checkbox"/> yes <input type="checkbox"/> no	<input type="checkbox"/> 1 <input type="checkbox"/> 3 <input type="checkbox"/> 2 <input type="checkbox"/> ____	<input type="checkbox"/> 1 (center) <input type="checkbox"/> 2 <input type="checkbox"/> 4 <input type="checkbox"/> 1 (side) <input type="checkbox"/> 3 <input type="checkbox"/> ____	

Building type

<input type="checkbox"/> detached house	<input type="checkbox"/> garage	<input type="checkbox"/> government	<input type="checkbox"/> industrial
<input type="checkbox"/> detached town house	<input type="checkbox"/> farmhouse	<input type="checkbox"/> commercial (office)	<input type="checkbox"/> school
<input type="checkbox"/> row house	<input type="checkbox"/> apartment building	<input type="checkbox"/> commercial (store)	<input type="checkbox"/> church
<input type="checkbox"/> double house	<input type="checkbox"/> gas station	<input type="checkbox"/> railroad	<input type="checkbox"/> _____

Style/period _____ Date _____ Architect/builder _____

Location and description of entrance _____

Miscellaneous descriptive information (plan, exterior and interior decoration, cornice/eave type, window type and trim, chimneys, additions, alterations)

Date 4-83 File No. 104-130

Name 16 Elliewood



Date _____

City of Charlottesville - Rugby Rd.-University Corner H.D.

DEPARTMENT OF HISTORIC RESOURCE
RECONNAISSANCE SURVEY FORM

DHR Identification Number: 104-0133-0040

Other DHR Number: 104-70

Property Date(s) 1945 ca

PROPERTY NAMES

Biltmore Grill

EXPLANATION

Current

County/Independent City: Charlottesville

State: Virginia

Magisterial District:

Tax Parcel: 9-97

USGS Quad Map Name: CHARLOTTESVILLE WEST

UTMs of Boundary:

Center UTM:

Restrict location and UTM data? N

ADDRESSES

Number	Thoroughfare Name	Explanation
16 -	Elliewood Avenue	Current

Vicinity: Town/Village/Hamlet: Charlottesville

Name of National Register Historic District:

Rugby Road-University Corner Historic District

Name of DHR Eligible Historic District:

Name of Local Historic District:

Physical Character of General Surroundings: City

Site Description/Notable Landscape Features:

On slightly elevated site, with brick terrace and pergola, used for dining;
brick-walled planting area in front yard.

Ownership: Private

NR Resource Type: Building

WUZITS

Seq. #	# of	Wuzit Types	Historic?
1.0	1	Commercial Building	Historic

TOTAL: 1

Historic: 1

Non-Historic: 0

PRIMARY RESOURCE EXTERIOR COMPONENT DESCRIPTION

Component	#	Comp Type/Form	Material	Material Treatment
Cornice	0	Boxed	Wood	
Porch	0	Enclosed	Wood	
Roof	0	Hipped	Asphalt	Shingle
Walls	0	Masonry	Concrete	Block
Window(s)	0	Sash, double-hung	Wood	Six-over-six
Chimney	1	Exterior side	Stone	

INDIVIDUAL RESOURCE INFORMATION

SEQUENCE NUMBER: 1.0 WUZIT: Restaurant

Primary Resource? Yes

Estimated Date of Construction: 1945 ca

Source of Date: Site Visit/Written

Architectural Style: Other

Description:

Four-square form with Colonial Revival features, building has three-bay front facade with full-width, enclosed front porch topped by hipped roof and fitted with plate glass windows shaded with canvas awnings. Inoperable blinds flank six-over-six, double-hung sash windows at the second floor. Large exterior side chimney of stone rises at the northeast side of the building.

Condition: Excellent

Threats to Resource: None Known

Additions/Alterations Description:

The interior of the building has been considerably altered (it probably served originally as a residence, before conversion for use as a restaurant).

An addition at the west corner rises two stories, with a gable roof and large, plate glass windows; of frame construction, it was built in the 1980s, and stands alongside the parking garage immediately southwest of this property. Also, a large pergola that stands south of the building was probably added in the late 1970s.

Number of Stories: 2.0

Interior Plan Type: Irregular

Accessed? Yes

Interior Description:

The first floor is divided into dining and food service areas - a large dining space extends full-width at the front of the building, with a stone fireplace at the northeast end. The room is wood-panelled, with a wood floor.

Relationship of Secondary Resources to Property:

None

DHR Historic Context: Commerce/Trade

Significance Statement:

This building, which may have originally been a dwelling, has Colonial Revival elements and retains a scale and form compatible with other historic buildings on Elliewood Avenue. It has functioned as a restaurant for at least 15 years, and primarily serves the University community.

Medium	Medium ID #	Frames	Date
B&W 35mm Photos	14642	5 - 6	3/ 2/1996
B&W 35mm Photos	14642	32 -	3/ 2/1996

BIBLIOGRAPHIC DATA

Sequence #: 1.0 Bibliographic Record Type: Survey, Other

Author:

Citation Abbreviation:

Virginia Historic Landmarks Commission (VHLC) Survey

Notes:

N.d., surveyor not named. VHDR Archives.

Sequence #: 1.1 Bibliographic Record Type: Survey, Other

Author: O'Dell, Jeffrey M.

Citation Abbreviation:

Virginia Historic Landmarks Commission (VHLC) Survey

Notes:

Sept. 1983. VDHR Archives.

Sequence #: 1.2 Bibliographic Record Type: Map

Author: Sanborn Map Company

Citation Abbreviation:

Sanborn Fire Insurance Maps, Charlottesville, VA

Notes:

Published by Sanborn Map Company, 1907, 1913, 1920, 1929, 1941.

University of Virginia Library Government Documents.

Sequence #: 1.3 Bibliographic Record Type: NRHP Form

Author: O'Dell, J.M., w/Charlottesville Community Development staff

Citation Abbreviation:

Rugby Road-University Corner Historic District NR Nomination

Notes:

1984. VDHR Archives.

CULTURAL RESOURCE MANAGEMENT EVENTS

Date: 3/ 2/1996

Cultural Resource Management Event: Reconnaissance Survey

Organization or Person: Smead, Susan E.

ID # Associated with Event:

CRM Event Notes or Comments:

MAILING ADDRESS

Honorif:

First : Anne E.

Last : Albright

Suffix :

Title :

Company:

Address: 3418 Cotswold Lane

City : Keswick

State: VA

Zip : 22947- Country: USA

Phone/extension:

Individual Category Codes:

Mailing Address Notes:

Surveyor's Notes:

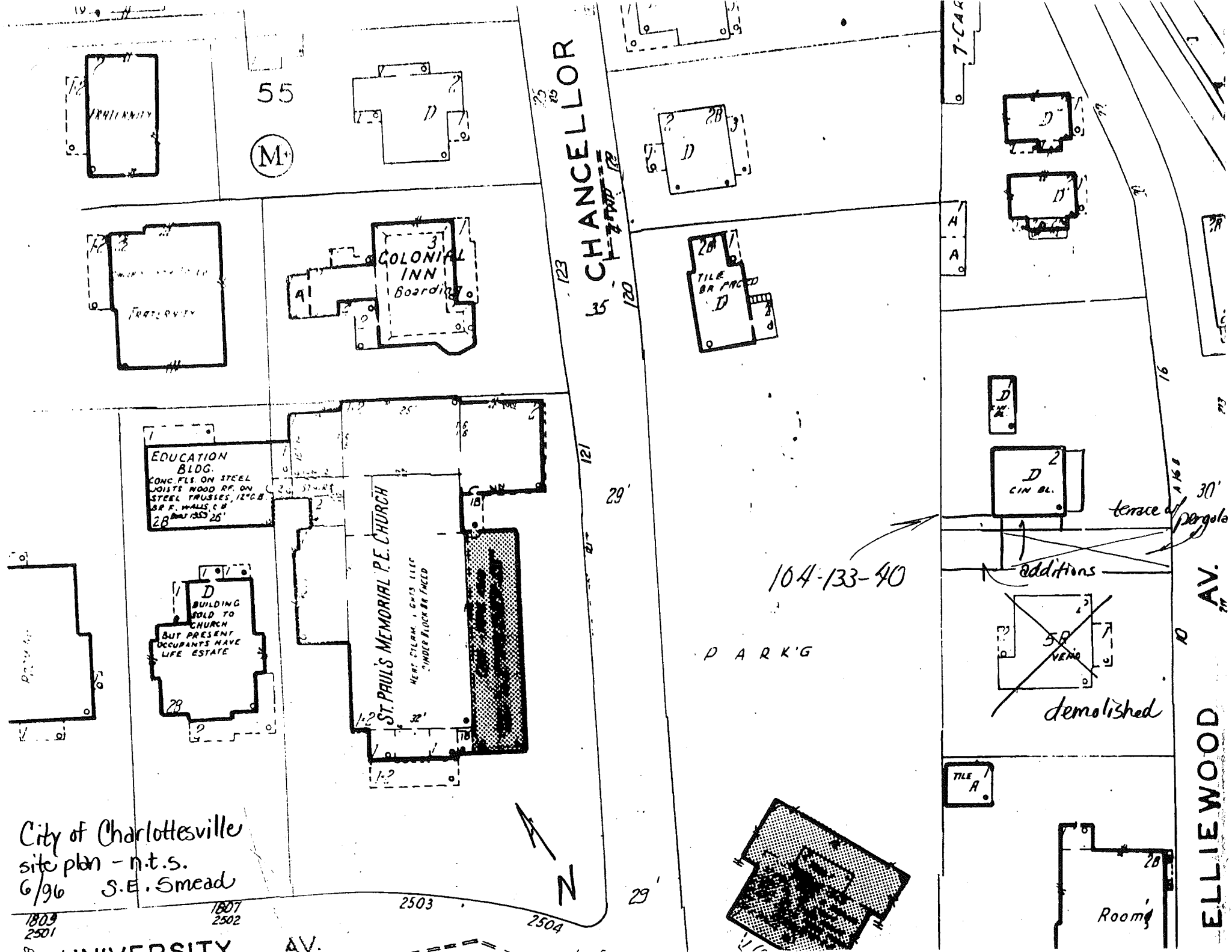

55

(M)

CHANCELLOR
123
120
121

7-CAR

A
A

ELLIEWOOD AV.

COLONIAL INN
Boarding

EDUCATION BLDG.
CONC. FL. ON STEEL JOISTS WOOD RF. ON STEEL TRUSSES, 12" CB BR F. WALLS, C & B 28

ST. PAUL'S MEMORIAL P.E. CHURCH
HEAT EXCH. 1 GP'S ILEC
INDOR BLOCK BR FACED

D BUILDING SOLD TO CHURCH BUT PRESENT OCCUPANTS HAVE LIFE ESTATE

TILE BR FACED
D

D CIN BL.

~~50 VERO~~

demolished

DARK

104-133-40

additions

terrace pergola

TILE A

Room

City of Charlottesville
site plan - n.t.s.
6/96 S.E. Smead

1807
2501

UNIVERSITY AV.

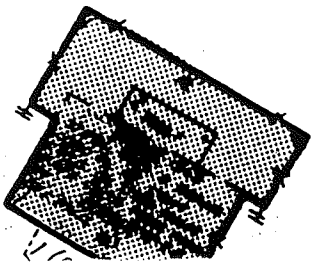

CITY OF CHARLOTTESVILLE

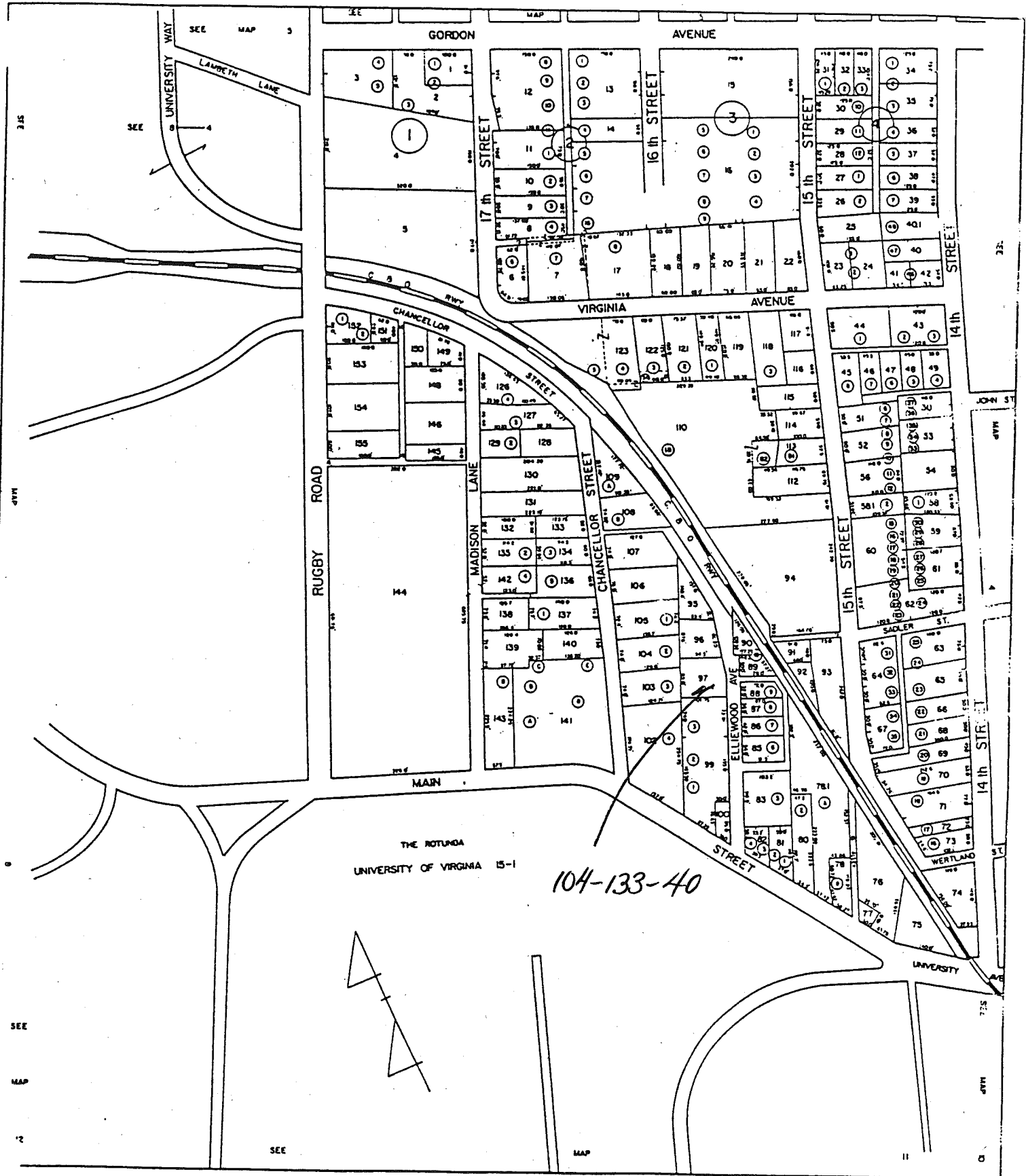

104-133-40

THE ROTUNDA
UNIVERSITY OF VIRGINIA 15-1

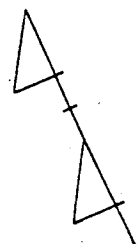

SCALE 1" = 100'

SECTION 9

9-97 ✓

#619

B-2

83798.4 (8423)

16 E Lincoln Ave.

Anne E Albright

Broke " "

Fidelity Corp

Knorr Turnbull est

" " -

all 9-96

309-12

113-215

54-208

Ely, W, Bruce

1943

\$2050

AG Carter, Dan O, Via

1926

buy P. Via

{ no mention of bldg
part of 54-208
(incl lot 500)
plat 113-217

2-5, base, 7 rooms

com. (rest.) - 1946

com blk found; CB walls; some shingle type

built 1947

2 fireplaces

1949 - new kitchen

1945, 46, 47 - ^{rest,} alterations

~~1944 rest, alterations~~

c. 1947

Bruce House



Sanborn: built bet 1929 & 1957

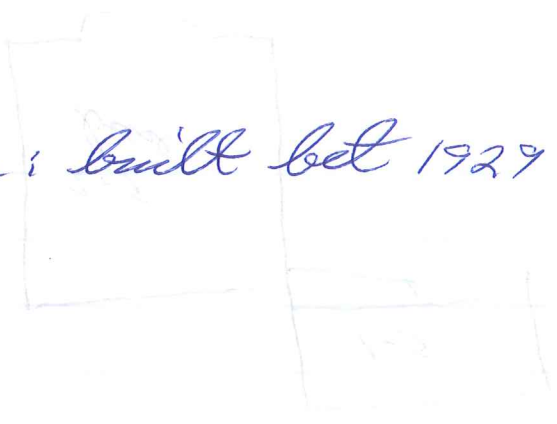

City Directories
 1953, ¹⁹⁶² E. Sig. B. Bruce - nurse
 1962 + Capt
 1985 K. L. Curtis's - restaurant
 1945 E. Sig. Bruce & #16 not listed

Tax

1946 4th E. Sig. A. Bruce 4, 5, & 6 Ellwood 1200 + 600 = 1800
 1947 " " " " 500 + 5500 = 7000

~~15~~¹⁶ Ellwood

2-5, 3-bay (both S & E facades)

low found, underblock walls (lt yellow)

truncated
med, hip roof, brick red, some singles, leaded cornice, pl frieze bay
hip-roofed lowered dormer on rear
massive stone set end chim on N end near front

wind 6/6, pl trim, lowered shutter on facade

cent bay facade (E): broad & shallow
semi-art bay, 8/8 side, 20-l first cent, metal
hip roof
~~supported~~

most openings closed

cent ent on S side w/ 4-l transom

basement ent under 3 bay facade

stained glass rear wind, leaded glass
wind front of 5el

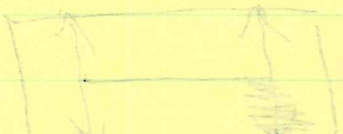

cottage

1-5, 2-bay, single pile
very low found, w/B walls (brick red)
H-shaped roof comp

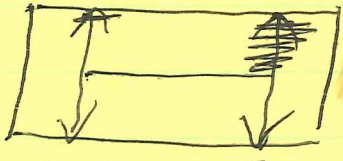

comp shingle
exposed rafter ends, pl bargeboard

6/6 w/ pl trim facade, 2/2 end
ent 5 bay facade
CB roof wing
in addition rear



Date 2/25/96 File No. 104-133-40

Name Biltmore Grill, 16 Elliewood Ave.

Town Charlottesville

County _____

Photographer S.F. Smead

Contents 3 exterior views

