



# VIRGINIA HISTORIC LANDMARKS COMMISSION

File no. 104-70
Negative no(s).

## SURVEY FORM

Historic name	Common name
County/Town/City <u>Albermarle/Charlottesville</u>	
Street address or route number <u>1-3 Elliewood Ave</u>	
USGS Quad <u>Charlottesville West, Va</u>	Date or period
Original owner	Architect/builder/craftsmen
Original use	
Present owner	Source of name
Present owner address	Source of date
	Stories
Present use	Foundation and wall const'n
Acreage	Roof type

State condition of structure and environs

State potential threats to structure  
Note any archaeological interest

Should be investigated for possible register potential?    yes \_\_\_ no \_\_\_

Architectural description (Note significant features of plan, structural system and interior and exterior decoration, taking care to point out aspects not visible or clear from photographs. Explain nature and period of all alterations and additions. List any outbuildings and their approximate ages, cemeteries, etc.)

Parking lot.

Interior inspected?

Historical significance (Chain of title; individuals, families, events, etc., associated with the property.)

Former site of R.D. Anderson House. Demolished in 1970, built 1886.



# VIRGINIA HISTORIC LANDMARKS COMMISSION

## HISTORIC DISTRICT SURVEY FORM

File No. 104-130
Negative no(s). 7297

Street address **1-3 Elliewood Ave.**  
 Town/City **Charlottesville**

Historic name \_\_\_\_\_ Common name **Unicaf parking lot**

- Material
- |  |  |
|--|--|
| <input type="checkbox"/> wood frame (siding: <input type="checkbox"/> weatherboard, <input type="checkbox"/> shingle, <input type="checkbox"/> aluminum, <input type="checkbox"/> bricktex, <input type="checkbox"/> _____ )<br><input type="checkbox"/> brick (bond: <input type="checkbox"/> Flemish, <input type="checkbox"/> stretcher, <input type="checkbox"/> ____-course American, <input type="checkbox"/> _____ )<br><input type="checkbox"/> stone ( <input type="checkbox"/> random rubble, <input type="checkbox"/> random ashlar, <input type="checkbox"/> coursed ashlar, <input type="checkbox"/> _____ )<br><input type="checkbox"/> log (siding: <input type="checkbox"/> weatherboard, <input type="checkbox"/> shingle, <input type="checkbox"/> aluminum, <input type="checkbox"/> bricktex, <input type="checkbox"/> _____ )<br><input type="checkbox"/> stucco<br><input type="checkbox"/> concrete block<br><input type="checkbox"/> enameled steel<br><input type="checkbox"/> other: _____ | <input type="checkbox"/> cast iron<br><input type="checkbox"/> terra cotta<br><input type="checkbox"/> glass and metal |
|--|--|

Number of Stories	Roof Type	Roof Material
<input type="checkbox"/> 1 <input type="checkbox"/> 2½ <input type="checkbox"/> 1½ <input type="checkbox"/> 3 <input type="checkbox"/> 2 <input type="checkbox"/> ____	<input type="checkbox"/> shed <input type="checkbox"/> mansard <input type="checkbox"/> gable <input type="checkbox"/> gambrel <input type="checkbox"/> pediment <input type="checkbox"/> parapet <input type="checkbox"/> hipped <input type="checkbox"/> flat <input type="checkbox"/> other: _____	<input type="checkbox"/> slate <input type="checkbox"/> tile <input type="checkbox"/> wood shingle <input type="checkbox"/> pressed tin <input type="checkbox"/> composition <input type="checkbox"/> not visible <input type="checkbox"/> standing seam metal <input type="checkbox"/> other _____

Dormers	Number of bays — Main facade							
<table style="width: 100%; border: none;"> <tr> <td style="width: 30%;"> <input type="checkbox"/> 0  <input type="checkbox"/> 1  <input type="checkbox"/> 2           </td> <td style="width: 30%;"> <input type="checkbox"/> 3  <input type="checkbox"/> 4  <input type="checkbox"/> ____           </td> <td style="width: 30%;"> <input type="checkbox"/> shed  <input type="checkbox"/> gable  <input type="checkbox"/> pedimented           </td> <td style="width: 10%;"> <input type="checkbox"/> hipped  <input type="checkbox"/> _____           </td> </tr> </table>	<input type="checkbox"/> 0 <input type="checkbox"/> 1 <input type="checkbox"/> 2	<input type="checkbox"/> 3 <input type="checkbox"/> 4 <input type="checkbox"/> ____	<input type="checkbox"/> shed <input type="checkbox"/> gable <input type="checkbox"/> pedimented	<input type="checkbox"/> hipped <input type="checkbox"/> _____	<table style="width: 100%; border: none;"> <tr> <td style="width: 30%;"> <input type="checkbox"/> 1  <input type="checkbox"/> 2  <input type="checkbox"/> 3           </td> <td style="width: 30%;"> <input type="checkbox"/> 4  <input type="checkbox"/> 5  <input type="checkbox"/> 6           </td> <td style="width: 30%;"> <input type="checkbox"/> 7  <input type="checkbox"/> 8  <input type="checkbox"/> ____           </td> </tr> </table>	<input type="checkbox"/> 1 <input type="checkbox"/> 2 <input type="checkbox"/> 3	<input type="checkbox"/> 4 <input type="checkbox"/> 5 <input type="checkbox"/> 6	<input type="checkbox"/> 7 <input type="checkbox"/> 8 <input type="checkbox"/> ____
<input type="checkbox"/> 0 <input type="checkbox"/> 1 <input type="checkbox"/> 2	<input type="checkbox"/> 3 <input type="checkbox"/> 4 <input type="checkbox"/> ____	<input type="checkbox"/> shed <input type="checkbox"/> gable <input type="checkbox"/> pedimented	<input type="checkbox"/> hipped <input type="checkbox"/> _____					
<input type="checkbox"/> 1 <input type="checkbox"/> 2 <input type="checkbox"/> 3	<input type="checkbox"/> 4 <input type="checkbox"/> 5 <input type="checkbox"/> 6	<input type="checkbox"/> 7 <input type="checkbox"/> 8 <input type="checkbox"/> ____						

Porch	Stories	Bays	General description
<input type="checkbox"/> yes <input type="checkbox"/> no	<input type="checkbox"/> 1 <input type="checkbox"/> 2 <input type="checkbox"/> 3 <input type="checkbox"/> ____	<input type="checkbox"/> 1 (center) <input type="checkbox"/> 1 (side) <input type="checkbox"/> 2 <input type="checkbox"/> 3 <input type="checkbox"/> 4 <input type="checkbox"/> ____	_____

- Building type
- |  |   |  |   |
|--|---|--|---|
| <input type="checkbox"/> detached house      | <input type="checkbox"/> garage             | <input type="checkbox"/> government          | <input type="checkbox"/> industrial         |
| <input type="checkbox"/> detached town house | <input type="checkbox"/> farmhouse          | <input type="checkbox"/> commercial (office) | <input type="checkbox"/> school             |
| <input type="checkbox"/> row house           | <input type="checkbox"/> apartment building | <input type="checkbox"/> commercial (store)  | <input type="checkbox"/> church             |
| <input type="checkbox"/> double house        | <input type="checkbox"/> gas station        | <input type="checkbox"/> railroad            | <input type="checkbox"/> <u>parking lot</u> |

Style/period \_\_\_\_\_ Date \_\_\_\_\_ Architect/builder \_\_\_\_\_

Location and description of entrance \_\_\_\_\_



Miscellaneous descriptive information (plan, exterior and interior decoration, cornice/eave type, window type and trim, chimneys, additions, alterations)

**Asphalt parking lot behind 1521-27 University Ave.**

Historical information

Source

Surveyed by **Jeff O'Dell, VHLC**

Date **9-83**

City of Charlottesville - Rugby Rd.-University Corner H.D.

DEPARTMENT OF HISTORIC RESOURCE  
RECONNAISSANCE SURVEY FORM

DHR Identification Number: 104-0133-0051

Other DHR Number: 104-70

Property Date(s) 1985 ca

## PROPERTY NAMES

Eljo's

## EXPLANATION

Current

County/Independent City: Charlottesville

State: Virginia

Magisterial District:

Tax Parcel: 9-83-3

USGS Quad Map Name: CHARLOTTESVILLE WEST

UTMs of Boundary:

Center UTM:

Restrict location and UTM data? N

## ADDRESSES

Number	Thoroughfare Name	Explanation
3 -	Elliewood Avenue	Current

Vicinity: Town/Village/Hamlet: Charlottesville

Name of National Register Historic District:

Rugby Road-University Corner Historic District

Name of DHR Eligible Historic District:

Name of Local Historic District:

Physical Character of General Surroundings: City

Site Description/Notable Landscape Features:

On level site with paved parking area to rear, accessed by driveway at northeast side of building; building abuts sidewalk.

Ownership: Private

NR Resource Type: Building

## WUZITS

Seq. #	# of	Wuzit Types	Historic?
1.0	1	Commercial Building	Non-historic

TOTAL: 1

Historic: 0

Non-Historic: 1

PRIMARY RESOURCE EXTERIOR COMPONENT DESCRIPTION

Component	#	Comp Type/Form	Material	Material Treatment
Cornice	0	Molded	Wood	
Roof	0	Not Visible		
Walls	0	Veneer	Brick	Common Bond
Window(s)	0	Plate Glass		
Entrance	0	Pedimented, 3-part	Wood	Neo-Traditional
Window(s)	0	Octagonal	Wood	

INDIVIDUAL RESOURCE INFORMATION

SEQUENCE NUMBER: 1.0

WUZIT: Commercial Building

Primary Resource? Yes

Estimated Date of Construction: 1985

Source of Date: Site Visit/Written

Architectural Style: Other

Description:

Commercial building, about ten years old, designed with modern form and details derived from Colonial Revival. Brick veneer walls, five-bay front facade, with end bays projecting slightly; two shallow bay display windows to each side of central entrance, each of wood, fronted with plate glass, and topped with concave hood; entrance is three-part, with square Doric pilasters edging display windows and door between, which has a pediment containing a clock above. Four octagonal windows without mullions open to the second floor above the first floor windows. A molded cornice about three feet below the top of the wall decorates the front facade. At the front corners of the building, projecting courses of brickwork every fifth course create the impression of corner quoins. The Colonial Revival-derived features do not extend to the other facades of the building.

Condition: Excellent

Threats to Resource: None Known

Additions/Alterations Description:

None

Number of Stories: 2.0

Interior Plan Type: Undivided Space (non-domestic)

Accessed? Yes

Interior Description:

Open display area takes up most of building's interior, with work spaces to rear.

Relationship of Secondary Resources to Property:

None

DHR Historic Context: Commerce/Trade

Significance Statement:

This building is only about ten years old, and does not contribute to the historic district. However, its brick walls and Colonial Revival-derived features attempt to blend with the appearance of the other large commercial buildings that adjoin it, Mincer's (Kenmore Building) at 1525-27 University Avenue and Arnette's (Stevens-Shepherd Building) at 1601 University Avenue. Eljo's is the newest commercial building on Elliewood Avenue, and stands on the site of the R.D. Anderson House, built in 1886 and demolished in 1970

(VHLC Survey). The Anderson House was built with its primary facade facing University Avenue, but its orientation was changed by the construction of the Kenmore Building (Mincer's) in the 1920s. By 1941, it was serving as a rooming house. Before the construction of Eljo's, the site contained a paved parking lot.

#### GRAPHIC DOCUMENTATION

Medium	Medium ID #	Frames	Date
B&W 35mm Photos	14642	26 - 29	3/ 2/1996

#### BIBLIOGRAPHIC DATA

Sequence #: 1.0 Bibliographic Record Type: Survey, Other

Author:

Citation Abbreviation:

Virginia Historic Landmarks Commission (VHLC) Survey

Notes:

N.d., surveyor not named. VHDR Archives.

Sequence #: 1.1 Bibliographic Record Type: Survey, Other

Author: O'Dell, Jeffrey M.

Citation Abbreviation:

Virginia Historic Landmarks Commission (VHLC) Survey

Notes:

Sept. 1983. VDHR Archives.

Sequence #: 1.2 Bibliographic Record Type: Map

Author: Sanborn Map Company

Citation Abbreviation:

Sanborn Fire Insurance Maps, Charlottesville, VA

Notes:

Published by Sanborn Map Company, 1907, 1913, 1920, 1929, 1941.  
University of Virginia Library Government Documents.

Sequence #: 1.3 Bibliographic Record Type: NRHP Form

Author: O'Dell, J.M., w/Charlottesville Community Development staff

Citation Abbreviation:

Rugby Road-University Corner Historic District NR Nomination

Notes:

1984. VDHR Archives.

#### CULTURAL RESOURCE MANAGEMENT EVENTS

Date: 3/ 2/1996

Cultural Resource Management Event: Reconnaissance Survey

Organization or Person: Smead, Susan E.

ID # Associated with Event: 104-133-51

CRM Event Notes or Comments:

#### MAILING ADDRESS

Honorif:

First : Charles

Last : Hyman

Suffix :

Title :

Company:

Address: 200 W. Forsyth St., #800

City : Jacksonville

State: FL

Zip : 32202- Country: USA

Phone/extension:

Individual Category Codes:

Mailing Address Notes:

Surveyor's Notes:

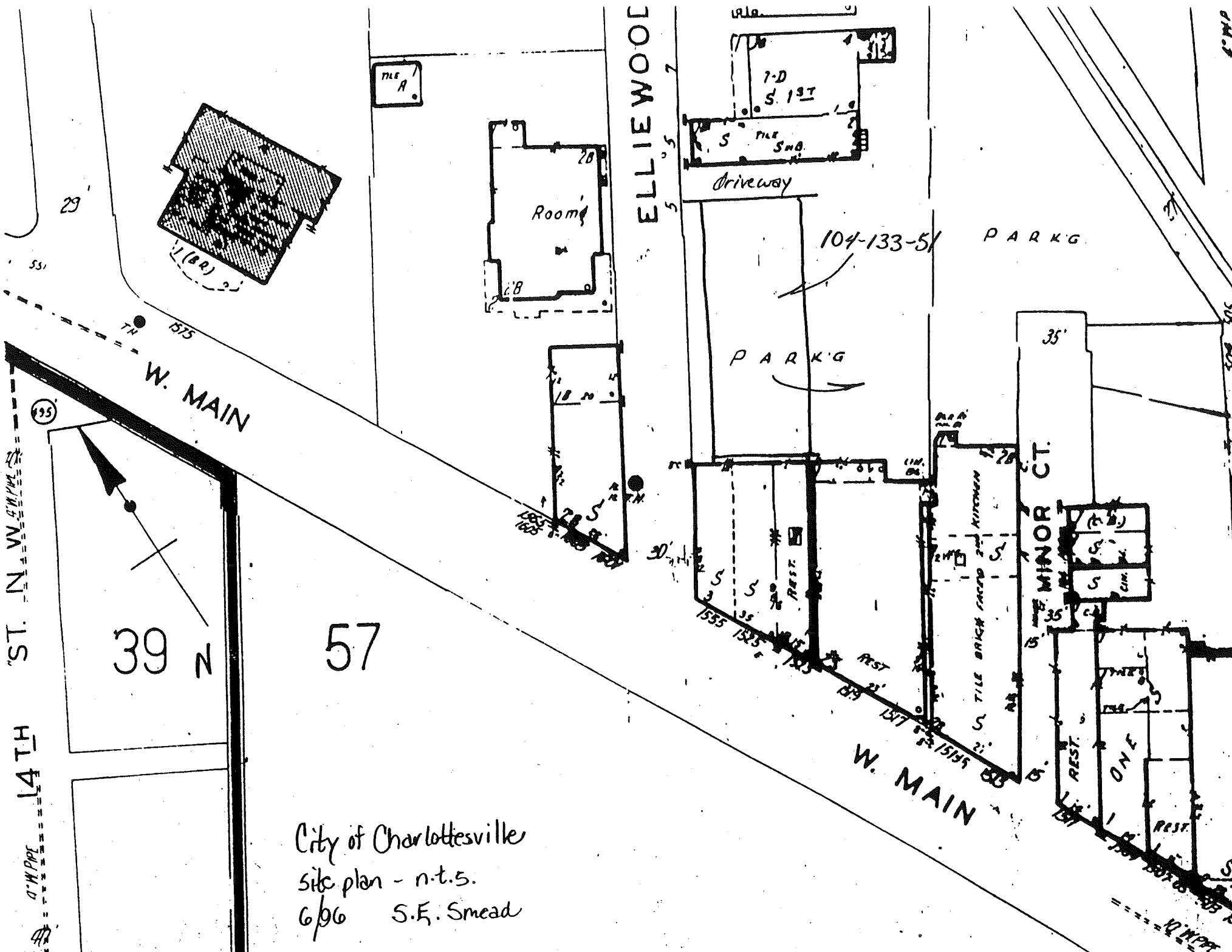

City of Charlottesville  
 Site plan - n.t.s.  
 6/96 S.E. Smead

CITY OF CHARLOTTESVILLE

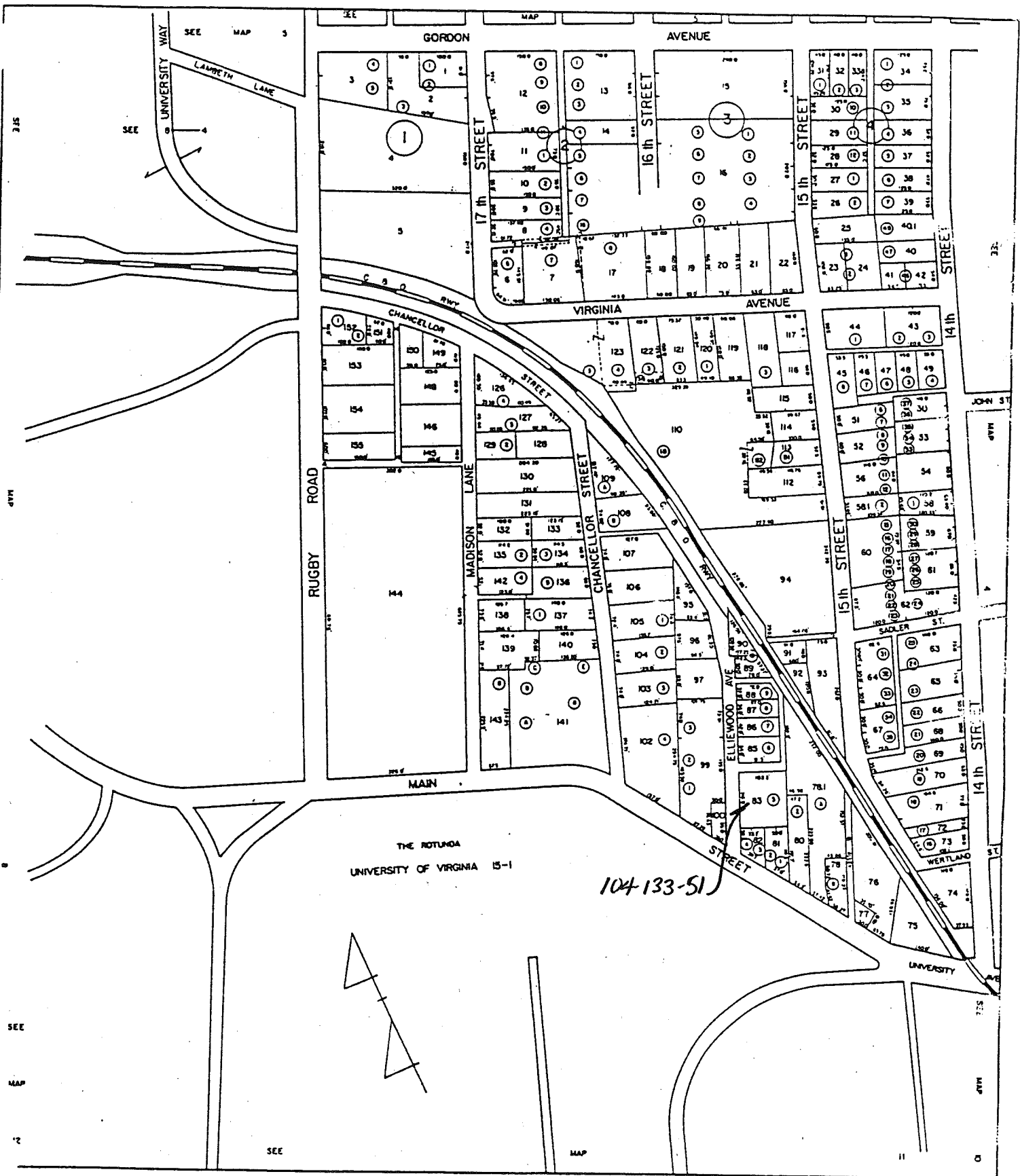

SCALE 1" = 100'

SECTION: 9



Date 3/2/96 File No. 104-133-51

Name Eljos, 3 Elliewood Ave.

Town Charlottesville

County \_\_\_\_\_

Photographer S.K. Smead

Contents 4 exterior views

