

Architectural And Historic Survey



Identification

STREET ADDRESS: 728 West Street
MAP & PARCEL: 31-255
CENSUS TRACT AND BLOCK:
PRESENT ZONING: R-2
ORIGINAL OWNER: Lillie F. Woods
ORIGINAL USE: Residence
PRESENT USE: Residence
PRESENT OWNER: Reginald R. & Hazel N. Moss
ADDRESS: 728 West Street
Charlottesville, Virginia 22901

HISTORIC NAME: Woods-Moss House
DATE / PERIOD: 1896
STYLE: Victorian Vernacular
HEIGHT (to cornice) OR STORIES: 1 storey
DIMENSIONS AND LAND AREA: 40' x 120' (4800 sq. ft.)
CONDITION: Good
SURVEYOR: Bibb
DATE OF SURVEY: Summer 1985
SOURCES: City/County Records
Reginald R. Moss

ARCHITECTURAL DESCRIPTION

Set on a low foundation, this white weatherboarded one-storey, 3-bay, double-pile house is dominated by a heavy, complex roof. The roof is a medium-pitched hip with steep gables over the side bays of the facade and centered over both side elevations. In the center of the facade, a steeper and somewhat taller gable extends out over the nearly flat roof of the veranda. There is a small 4-light casement window in that gable, while the others have pierced circular air vents. The roof is covered with silver-colored standing-seam metal. It does not now have any bargeboard or eaves trim, but it seems likely that there would have originally been some Victorian gingerbread on both the roof and the veranda. There are two interior capped chimneys. Windows are double-sash, 2-over-2 light, with plain trim. Those on the facade extend nearly from floor to ceiling and have black louvered shutters. A veranda covers most of the facade. It has a nearly flat hip roof covered with standing-seam metal, a plain frieze, chamfered posts with lacey sawn brackets set on brick pedestals, a new wrought iron balustrade, and a concrete floor at ground level. The entrance door in the center bay has been replaced with another window and a new door cut between it and the western bay. There is a series of shed-roofed rear additions.

HISTORICAL DESCRIPTION

Miss Lillie F. Woods purchased this lot in 1895 (City DB 7-399) and built the house the next year, according to tax records. E. R. Martin brought the house from her heirs in 1941 (DB 105-485) and sold it immediately to Owen J. & Hazel M. Duncan (DB 105-486). Mrs. Duncan's brother and sister-in-law bought the house from them in 1951 (DB 159-114) and have now lived there for 34 years.

Architectural And Historic Survey



Identification

| | |
|--|--|
| STREET ADDRESS: 728 West Street | HISTORIC NAME: Woods-Moss House |
| MAP & PARCEL: 31-255 | DATE / PERIOD: 1896 |
| CENSUS TRACT AND BLOCK: | STYLE: Victorian Vernacular |
| PRESENT ZONING: R-2 | HEIGHT (to cornice) OR STORIES: 1 storey |
| ORIGINAL OWNER: Lillie F. Woods | DIMENSIONS AND LAND AREA: 40' x 120' (4800 sq. ft.) |
| ORIGINAL USE: Residence | CONDITION: Good |
| PRESENT USE: Residence | SURVEYOR: Bibb |
| PRESENT OWNER: Reginald R. & Hazel N. Moss | DATE OF SURVEY: Summer 1985 |
| ADDRESS: 728 West Street Charlottesville, Virginia 22901 | SOURCES: City/County Records Reginald R. Moss |

ARCHITECTURAL DESCRIPTION

Set on a low foundation, this white weatherboarded one-storey, 3-bay, double-pile house is dominated by a heavy, complex roof. The roof is a medium-pitched hip with steep gables over the side bays of the facade and centered over both side elevations. In the center of the facade, a steeper and somewhat taller gable extends out over the nearly flat roof of the veranda. There is a small 4-light casement window in that gable, while the others have pierced circular air vents. The roof is covered with silver-colored standing-seam metal. It does not now have any bargeboard or eaves trim, but it seems likely that there would have originally been some Victorian gingerbread on both the roof and the veranda. There are two interior capped chimneys. Windows are double-sash, 2-over-2 light, with plain trim. Those on the facade extend nearly from floor to ceiling and have black louvered shutters. A veranda covers most of the facade. It has a nearly flat hip roof covered with standing-seam metal, a plain frieze, chamfered posts with lacey sawn brackets set on brick pedestals, a new wrought iron balustrade, and a concrete floor at ground level. The entrance door in the center bay has been replaced with another window and a new door cut between it and the western bay. There is a series of shed-roofed rear additions.

HISTORICAL DESCRIPTION

Miss Lillie F. Woods purchased this lot in 1895 (City DB 7-399) and built the house the next year, according to tax records. E. R. Martin brought the house from her heirs in 1941 (DB 105-485) and sold it immediately to Owen J. & Hazel M. Duncan (DB 105-486). Mrs. Duncan's brother and sister-in-law bought the house from them in 1951 (DB 159-114) and have now lived there for 34 years.

31-255 ✓ (subdiv; Judge JMW White)

40x120 (4800)
R-2

#579

159-114 (same add) 728 West St
Reginald R & Hazel N. Moss 1951 plat 4-12 partial conveyance
Owen Duncan, Jr

1-fam, 1-5, 1/2 base, 6 room, 1 B
conc blk, wood, metal gable
"old"

0 fireplaces
1968 - re-roofed

Woods - Moss House
built 1896

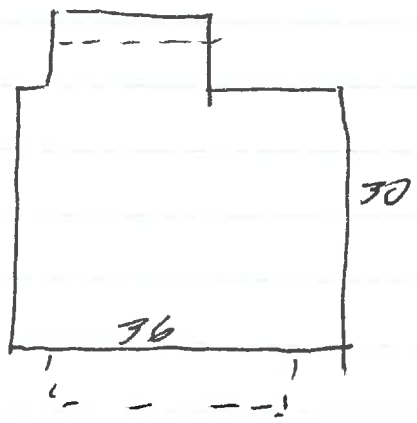

728 West St

159-114 Owen J Duncan, Jr, & wife Hazel M → Reginald R & Hazel N #7000
 7/28/1951 Moss side
 2 lots, 40' on West St
 # 2 & 3 on plat DB 4-12
 part of 105-486

105-486 ER & Mada B Martin → Owen J & Hazel M Duncan #3600
 3/5/1941 Lots 2, 3, & 4 of plat DB 4-12
 each 40' x 120'
 same as 105-485

105-485 Emma W & James S King, & Nannie Woods Thompson (w) →
 3/3/1941 ER Martin
 Lots 2, 3, & 4 ...
 Lot # 2 = 7-398, 1895, R S Woods ^{wife} → Lillie F. Woods, #200
 " # 3 = 20-28, 1906, " " → " " Blakely
 " # 4 = 15-89, 1904, " " → " " #200
 Lillie Woods Blakely dec. 1940 (WB 4-433) & left property
 to Emma W Wood King & Nannie Woods Thompson
 see also Chanvey Bk 12-389

WB 4-433 ~~part of~~ → 2 sisters

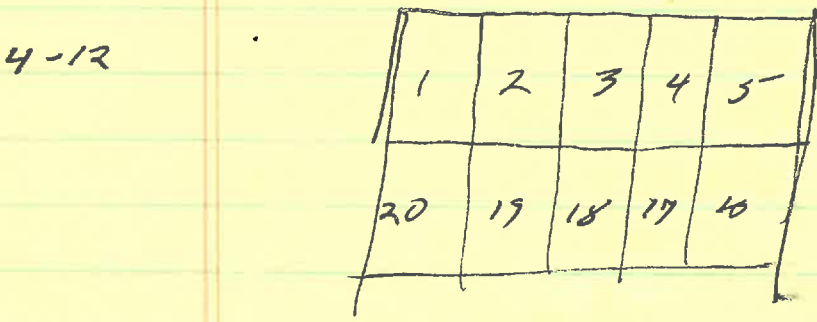

7-399

R S + Willie A Woods -> Lillie F Woods

\$200

9/9/1895

Lot 2.... " of property owned by sd Woods in rear of Judge J M White's former residence, the same being a portion of the Peter B. Wade addition "

1896

W

1896

4th

R S Woods

3 lots E sidewalk st

300 + 0 = 300

for J M White

1897

"

"

200 + 0 = 200

"

"

Miss Sallie F. Woods

x 2

"

100 + 500 = 600

for R S Woods \$500 for bldg

728 west

30+ yr there
bought for me

1 ~~1~~ 5, 3-bay, double side

low found.

white weatherboarding

steep gable roof, 55 m (silver), mod. eaves & verges, ∇
no cornice, no ~~corner beam~~ ^{bargeboard} etc, circular pierced vents
in gables

windows very tall (floor to ceiling), 2/2, pl trim on facade
black lowered shutters; normal length ^{ht} elsewhere

1-5 veranda of nearly flat 55 m ^{hip} ~~shed~~ roof ^{cover} most
of facade, pl frieze, chamfered posts now set on brick
pedestals w/ large sawn brackets, ground level con-
floor, new wrought iron bal

ent door moved for cent bay (& replaced w/ windows)
to bet cent & n bay

sq 4-l casement w/ shutters in cent gable over porch;
steeper than others on facade

2 int chim, capped

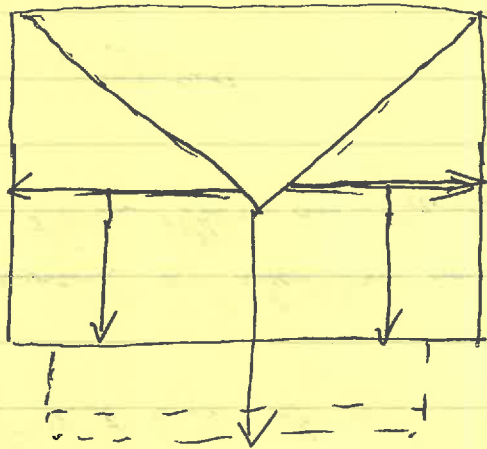

basic form; med hip w/ steep gables centered on each side
& over side bays of facade, plus steeper & somewhat
taller gable in center of facade extending out
over porch roof

series shed-roofed rear addition

