

january 27, 2012

from:

Kay Humes (owner)

and

Leslie McDonald (owner's representative)

434.906.0337

[axemax@mac.com](mailto:axemax@mac.com)

To:

Mary Joy Scala

Board of Architectural Review

Re:

Humes Residence

423 2<sup>nd</sup> st. NE.

Charlottesville, Va 22902

Replacing fire damaged porch on back (west) side of house.

The roof structure and copper roof from the existing porch will remain as well as the brick piers. We are not proposing to change the footprint of the porch 6' x 14'.

We propose to replace the porch deck, posts and stairs.

We would like to position the stair on the north side of the porch to provide privacy for bedroom window on the south side. We are proposing to build a code compliant stair and screened in porch. Please see attached sketches.

We were 2 days away from applying for a certificate of occupancy when the electrical fire destroyed the porch. If you need any additional information to help us expedite the process please let me know.

Thank you.

Sincerely,

Leslie McDonald



WEST ELEVATION



SOUTH ELEVATION

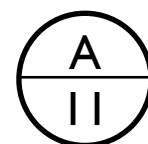

EXT. ELEVATIONS

NTS

**HUMES Residence\_ BUILD SET**

Kay & Pat Humes 4432 2nd St. NE Charlottesville, Va 22902

**12.07.2011  
REVISED**

**A11**

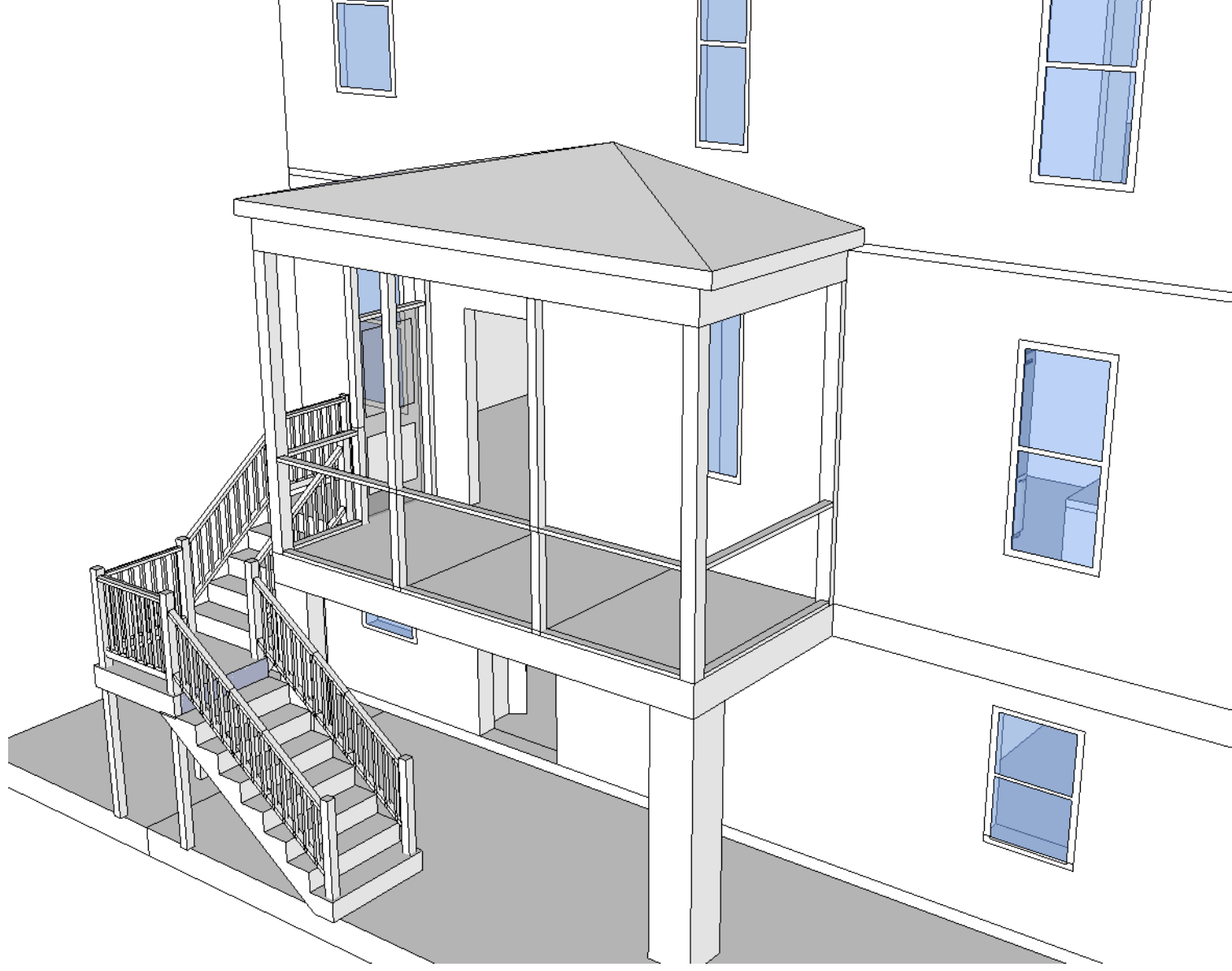

**HUMES Residence\_ BUILD SET**

Kay & Pat Humes 4432 2nd St. NE Charlottesville, Va 22902

**12.07.2011  
REVISED**









