

LSI ABOLITE® LED ANGLED REFLECTOR (AD)

Crossover®
LED LIGHTING TECHNOLOGY

US patents D598162 & D581585 & D581544 & 7697766 and US & Int'l. patents pending



Directional Optics

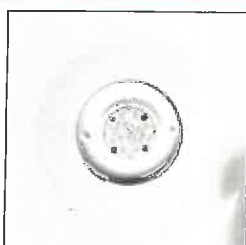

Symmetrical Optics

APPLICATIONS - Signage Lighting and Accent Lighting. Interior or Exterior.

PRODUCT HIGHLIGHTS

- **"Green" Energy-Saving** - Reduces greenhouse gas emissions, slashes operating costs, extends life and eliminates costly lamp disposal involving mercury waste.
- **Long Lasting Sparkle** - LED light beam contains no heat, and no UV, which means degradation in color or quality of the product under display is minimized.
- **Dramatically Lower Maintenance Costs** - 60,000-hour LED source extends life 3 to 5 times as compared to conventional HID sources, 30 times incandescent.
- **Integrated Power Supply** - Built into fixture allowing RLM to be connected directly to line voltage.

EXPECTED LIFE - Minimum 60,000 hours to 100,000 hours depending upon the ambient temperature of the installation location.

LEDS - Select high-brightness LEDs in Cool White (5000K nominal), Neutral White (4000K nominal), and Warm White (3500K nominal) color temperature. 70 CRI (nominal) CW. 80 CRI (nominal) NW and WW.

OPTIONAL DIRECTIONAL OPTICS - Allows field adjustment of the light beam for directional illumination of signage.

REFLECTOR - Heavy duty spun galvanized steel construction with polyester powder coat finish.

LIGHT OUTPUT - With an input power of 11 watts: DO - Optional Directional Optics (nominal) - Cool White - 970 lumen, Neutral White - 810 lumens and Warm White - 745 lumens. Symmetric Optics (nominal) - Cool White - 905 lumens, Neutral White - 760 lumens and Warm White - 700 lumens

MOUNTING - Fixed hub tapped for 3/4" NPT conduit. Pre-wired with 96" leads. Not designed for uplight applications.

ELECTRICAL - Integral, surge protected power supply operates on 120-240 VAC (50/60Hz) input; no external power supplies required.

DRIVER - State-of-the-art driver designed specifically for RLM fixtures provides unsurpassed system efficiency. Components are fully encased in potting material for moisture resistance. Driver complies with IEC and FCC standards.

OPERATING TEMPERATURE - -40°C to +50°C (-40°F to +122°F).

FINISH - Available in either architectural textured, high gloss or satin finish.

WARRANTY - LSI LED fixtures carry a limited 5-year warranty.

LISTING - Listed to U.S. and Canadian safety standards. Suitable for wet locations.

DIMENSIONS

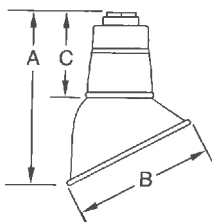

Prefix	Height (A)	Diameter (B)	Neck (C)	Weight (lbs./kg)
AD 100	10" (254mm)	7" (178mm)	5" (127mm)	2.0 (.9kg)
AD 150	11-1/2" (292mm)	9" (229mm)	5-1/4" (133mm)	2.0 (.9kg)
AD 200	13-1/2" (343mm)	11" (279mm)	5-1/2" (140mm)	2.5 (1.1kg)

Also available in traditional light sources

This product, or selected versions of this product, meet the standards listed below. Please consult factory for your specific requirements.

ARRA
Funding Compliant



LSI ABOLITE® LED ANGLED REFLECTOR (AD)



LUMINAIRE ORDERING INFORMATION

TYPICAL ORDER EXAMPLE: **AD 200 10 CW LED UE MSV LDS96 WL DO**

Prefix	# of LED's	Color Temperature	Light Source	Input Voltage	Reflector Color	Mounting	Options
AD 100' AD 150' AD 200'	10	CW - Cool White NW - Neutral White WW - Warm White	LED	120-240 ²	MSV-Metallic Silver GWT-Gloss White GBK-Gloss Black GRD-Gloss Red GPT-Textured Graphite RUS-Textured Rust SCP-Satin Copper STQ-Satin Turquoise SVG-Satin Verde Green	LDS96 WL - Factory prewired leads for use with stem or bracket mounting	DO - Directional Optics

1- Cordsets not available for AD Series.

2- Fixture will not operate on 277VAC (120-240 only).

CANOPY ORDERING INFORMATION (Accessories are field installed)	
Description	Order Number
3/4" (19mm) Tap Decorative Box Cover Aligner - Gloss White	BC600 3 GWT
3/4" (19mm) Tap Round Box Cover Aligner - Zinc	BC585 ZINC
3/4" (19mm) Tap Square Box Cover Aligner - Zinc	BC585SQ ZINC

- Standard BC600 finish is Gloss White Powder; other RLM colors available.

WIRE GUARD ORDERING INFORMATION (Accessories are field installed)	
Description	Order Number
7" (178mm) Convex Wire Guard - Metallic Silver	COG 7 MSV
9" (229mm) Convex Wire Guard - Metallic Silver	COG 9 MSV
11" (279mm) Convex Wire Guard - Metallic Silver	COG 11 MSV

- Standard finish is Metallic Silver Powder; other RLM colors available.

CONDUIT SYSTEM ORDERING INFORMATION (Accessories are field installed)	
Description	Order Number
3/4" x 3" (19mm x 76mm) Aluminum Stem - Gloss White	ST 3 3 GWT
3/4" x 6" (19mm x 152mm) Aluminum Stem - Gloss White	ST 6 3 GWT
3/4" x 12" (19mm x 305mm) Aluminum Stem - Gloss White	ST 12 3 GWT
3/4" x 18" (19mm x 457mm) Aluminum Stem - Gloss White	ST 18 3 GWT
3/4" x 24" (19mm x 609mm) Aluminum Stem - Gloss White	ST 24 3 GWT
3/4" x 36" (19mm x 913mm) Aluminum Stem - Gloss White	ST 36 3 GWT
3/4" x 48" (19mm x 1219mm) Aluminum Stem - Gloss White	ST 48 3 GWT
3/4" x 60" (19mm x 1524mm) Aluminum Stem - Gloss White	ST 60 3 GWT
3/4" x 72" (19mm x 1829mm) Aluminum Stem - Gloss White	ST 72 3 GWT
3/4" (19mm) Alum. Stem Coupler - Gloss White	COP 3 GWT

- Standard finish is Gloss White Powder; other RLM colors available.

GOOSE NECK BRACKET ORDERING INFORMATION (Accessories are field installed)	
Description	Order Number
3/4" (19mm) Aluminum Gooseneck Bracket - Gloss White	GB A 3 GWT
3/4" (19mm) Aluminum Gooseneck Bracket - Gloss White	GB B 3 GWT
3/4" (19mm) Aluminum Gooseneck Bracket - Gloss White	GB C 3 GWT
3/4" (19mm) Aluminum Gooseneck Bracket - Gloss White	GB D 3 GWT
3/4" (19mm) Aluminum Gooseneck Bracket - Gloss White	GB E 3 GWT
3/4" (19mm) Aluminum Gooseneck Bracket - Gloss White	GB F 3 GWT
3/4" (19mm) Aluminum Gooseneck Bracket - Gloss White	GB G 3 GWT
3/4" (19mm) Aluminum Gooseneck Bracket - Gloss White	GB H 3 GWT
3/4" (19mm) Aluminum Gooseneck Bracket - Gloss White	GB J 3 GWT
3/4" (19mm) Aluminum Gooseneck Bracket - Gloss White	GB K 3 GWT
3/4" (19mm) Aluminum Gooseneck Bracket - Gloss White	GB P 3 GWT
3/4" (19mm) Aluminum Gooseneck Bracket - Gloss White	GB U 3 GWT

WALL BRACKETS ORDERING INFORMATION (Accessories are field installed)	
Description	Order Number
Contemporary Wall Bracket - Medium - Gloss White	CWBM 1 GWT
Contemporary Wall Bracket - Long - Gloss White	CWBL 1 GWT
Nostalgic Aluminum Wall Scroll Bracket - Gloss White	DWB 1 GWT

BRACKETS

- See Indoor section for detail on bracket sizes and shapes.

- Standard finish is Gloss White Powder; colors available.

- Designed for mounting to recessed 4" (102mm) octagon box (by others).



Project Name _____ Fixture Type _____
Catalog # _____

07/29/14

© 2014
LSI INDUSTRIES INC.

LSI ABOLITE LIGHTING RLM ANGLED REFLECTOR



*Combining a nostalgic look with
today's lamp sources for
effective signage illumination.*



A Company with a Smart Vision

LSI ABOLITE LIGHTING RLM ANGLED REFLECTOR

CAST THE PERFECT HIGHLIGHT ON SIGNS, PRODUCT DISPLAYS, AND KEY ARCHITECTURAL FEATURES

Effective signage illumination is the primary objective of the LSI Abolite Angled Reflector (AD). While definitely a nostalgic luminaire, combining it with today's lamp sources provides the lighting designer with a major tool for addressing both illumination levels and energy requirements. By mounting the AD in combination with the A-style gooseneck on four foot centers, both interior and exterior signage can be illuminated with confidence.

- **Compact profile** with 3/4" threaded entry
- **Mounting** accomplished with rigid 3/4" conduit, or a variety of brackets and goosenecks
- **Three sizes** ranging from 7" to 11" in diameter make the AD a great choice when directional lighting is needed
- **Lamps available**
 - Compact Fluorescent, Pulse Start Metal Halide, Metal Halide and Incandescent
- **Finishes offered** include metallic silver, gloss white, gloss black, gloss red, textured graphite, textured rust, satin verde green, satin copper and satin turquoise

See data sheet for complete specifications – www.lsi-industries.com

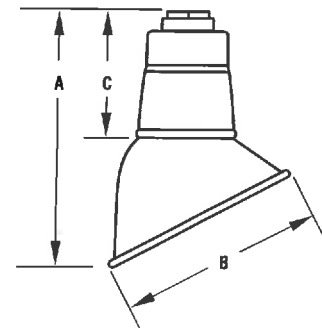

U.L. Listed for wet locations.



Also available in LED

Fixture	Height (A)	Width (B)	Neck (C)	Weight (lbs./kg)
AD 100	10" (254mm)	7" (178mm)	5" (127mm)	2.0 lbs. / .9kg
AD 150	11-1/2" (292mm)	9" (229mm)	5-1/4" (133mm)	2.0 lbs. / 1.1kg
AD 200	13-1/2" (343mm)	11" (279mm)	5-1/2" (140mm)	2.5 lbs. / 1.1kg



A Company with a *Smart Vision*

LSI LIGHTING SOLUTIONS PLUS

10000 Alliance Road ♦ Cincinnati, Ohio 45242 ♦ (513)793-3200 ♦ FAX (513)793-0147 ♦ www.lsi-industries.com

LSI ABOLITE GOOSENECK AND WALL BRACKETS

Brackets are finished in gloss white powder, other optional colors are available. All brackets suitable for use in wet locations, and mounts to recessed 4" octagon box (by others). Fixtures used in wet locations must be specified "WL" separately. To order, specify catalog number indicated.

NOTE: Brackets feature 3/4" stems which slip fit into wall plate (wall end is unthreaded). Conduit may be cut down (in the field by other) to shorten bracket length. CA5 wall plate included with all goosenecks.

GB A 3 GWT - 3/4" Single Reflector Gooseneck Wall Bracket. Features rigid conduit and cast wall plate which fits 4" octagonal box (by other). The bracket features a gloss white powder finish.

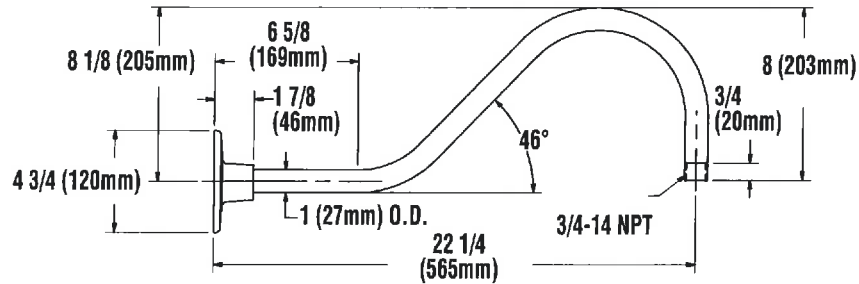

GB B 3 GWT - 3/4" Single Reflector Gooseneck Wall Bracket. Features rigid conduit and cast wall plate which fits 4" octagonal box (by other). The bracket features a gloss white powder finish.

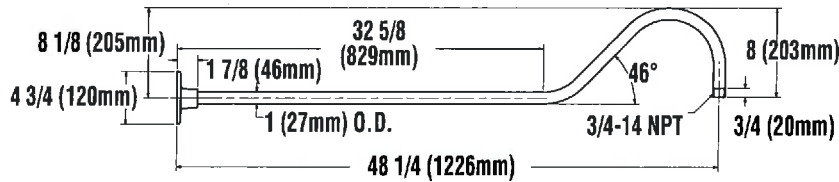

GB C 3 GWT - 3/4" Single Reflector Gooseneck Wall Bracket. Features rigid conduit and cast wall plate which fits 4" octagonal box (by other). The bracket features a gloss white powder finish.

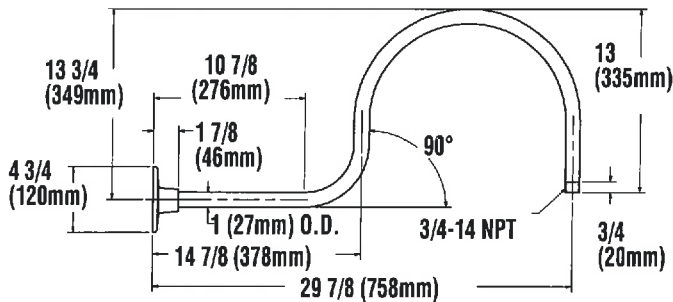

GB D 3 GWT - 3/4" Single Reflector Gooseneck Wall Bracket. Features rigid conduit and cast wall plate which fits 4" octagonal box (by other). The bracket features a gloss white powder finish.

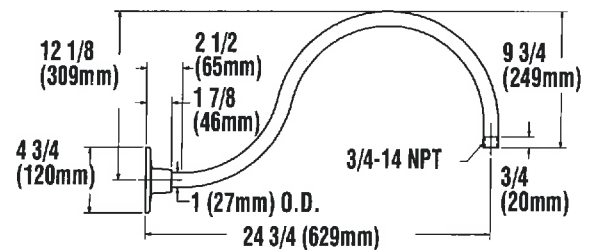

Project Name _____ Fixture Type _____
Catalog # _____



05/07/15
© 2015
LSI INDUSTRIES INC.

LSI ABOLITE GOOSENECK AND WALL BRACKETS

Brackets are finished in gloss white powder, other optional colors are available. All brackets suitable for use in wet locations, and mounts to recessed 4" octagon box (by others). Fixtures used in wet locations must be specified "WL" separately. To order, specify catalog number indicated.

NOTE: Brackets feature 3/4" stems which slip fit into wall plate (wall end is unthreaded). Conduit may be cut down (in the field by other) to shorten bracket length. CA5 wall plate included with all goosenecks.

GB E 3 GWT - 3/4" Single Reflector Gooseneck Wall Bracket. Features rigid conduit and cast wall plate which fits 4" octagonal box (by other). The bracket is designed to be mounted to a horizontal surface, but could also be mounted to a wall. The bracket features a gloss white powder finish.

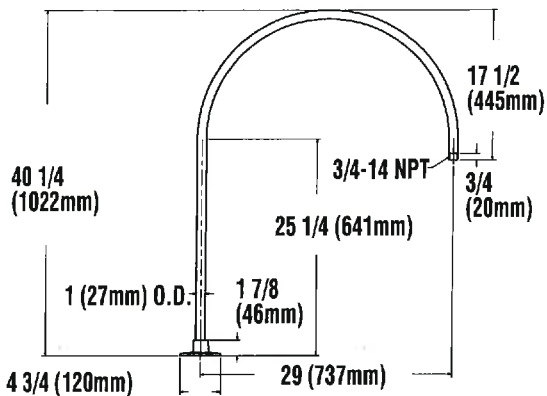

GB F 3 GWT - 3/4" Single Reflector Gooseneck Wall Bracket. Features rigid conduit and cast wall plate which fits 4" octagonal box (by other). The bracket features a gloss white powder finish.

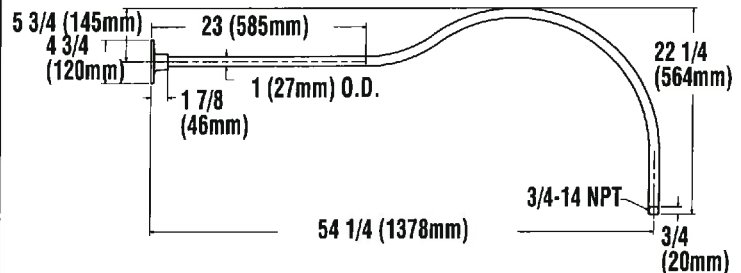

GB G 3 GWT - 3/4" Single Reflector Gooseneck Wall Bracket. Features rigid conduit and cast wall plate which fits 4" octagonal box (by other). The bracket features a gloss white powder finish.

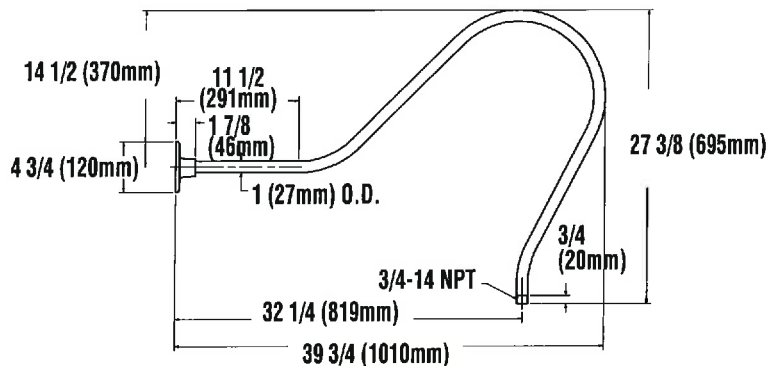

GB H 3 GWT - 3/4" Single Reflector Gooseneck Wall Bracket. Features rigid conduit and cast wall plate which fits 4" octagonal box (by other). The bracket features a gloss white powder finish.

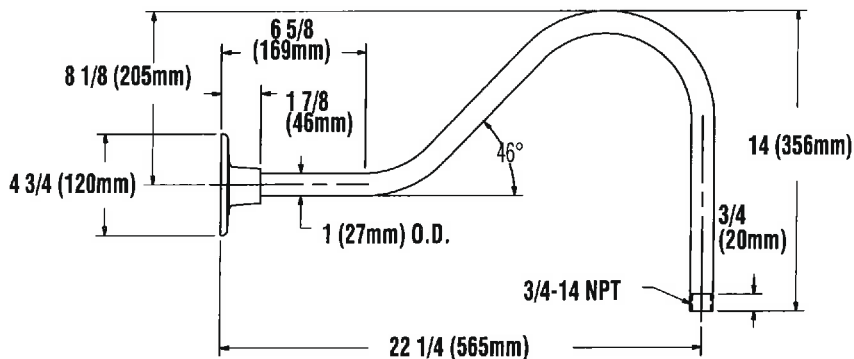

Project Name _____ Fixture Type _____
Catalog # _____

05/07/15

© 2015
LSI INDUSTRIES INC.

LSI ABOLITE GOOSENECK AND WALL BRACKETS

GB J 3 GWT - 3/4" Single Reflector Gooseneck Wall Bracket. Features rigid conduit and cast wall plate which fits 4" octagonal box (by other). The bracket features a gloss white powder finish.

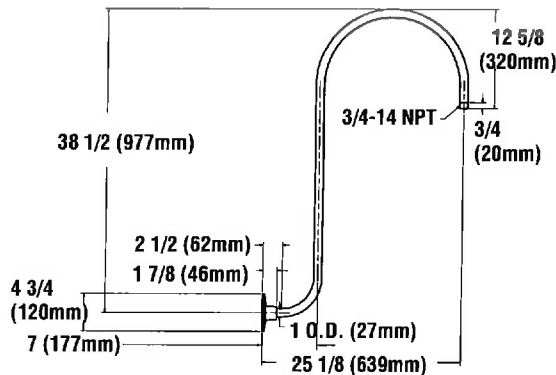

GB K 3 GWT - 3/4" Single Reflector Gooseneck Wall Bracket. Features rigid conduit and cast wall plate which fits 4" octagonal box (by other). The bracket features a gloss white powder finish.

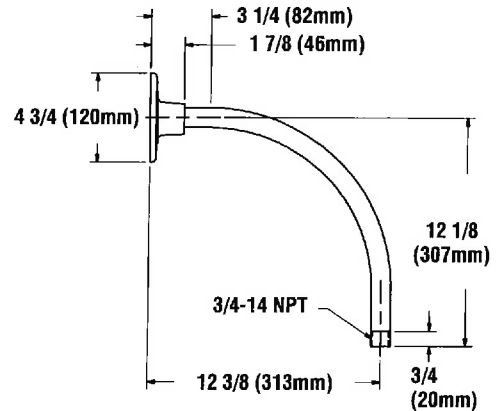

GB P 3 GWT - 3/4" Single Reflector Gooseneck Wall Bracket. Features rigid conduit and cast wall plate which fits 4" octagonal box (by other). The bracket features a gloss white powder finish.

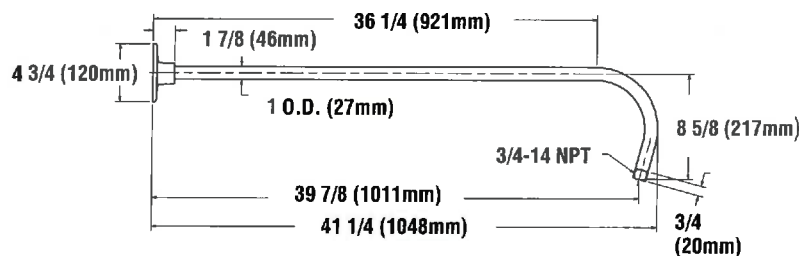

GB U 3 GWT - 3/4" Single Reflector Gooseneck Wall Bracket. Features rigid conduit and cast wall plate which fits 4" octagonal box (by other). The bracket features a gloss white powder finish.

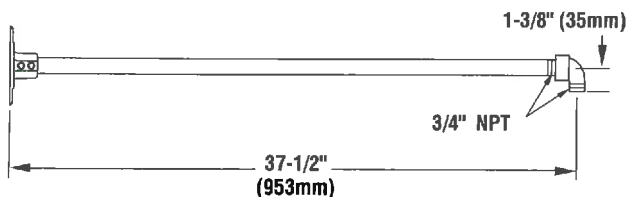

Replacement CA 5 - Gloss white powder finish (other colors available). Part number 102962GWT. Catalog description - Kit CA5 GB MTG CLR.

- Mounts to recessed 4" octagon box (by others).

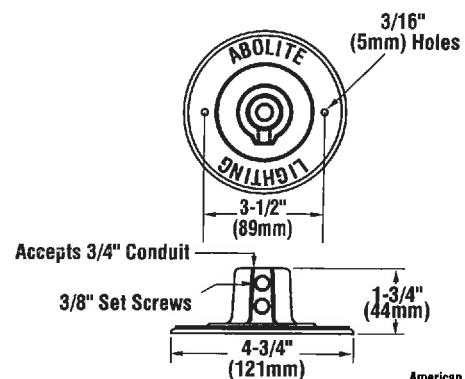

ARRA
Funding Compliant



Project Name _____ Fixture Type _____
Catalog # _____

05/07/15
© 2015
LSI INDUSTRIES INC.

LSI ABOLITE GOOSENECK AND WALL BRACKETS

CWBM 1 GWT and CWBL 1 GWT - Contemporary Wall Bracket with gloss white powder finish.

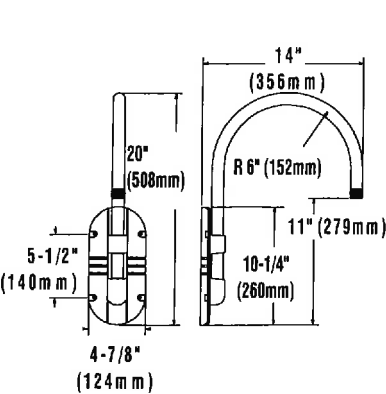

CWBM 1 GWT

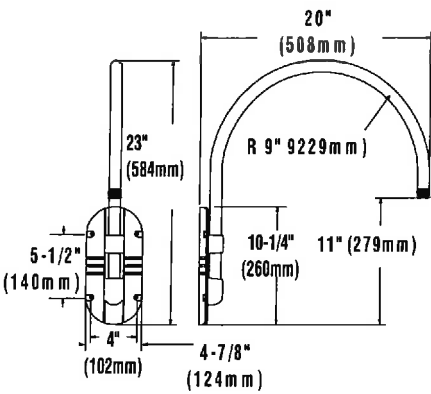

CWBL 1 GWT