

STREET ADDRESS: 114 Ninth Street, SW  
MAP & PARCEL: 30-6  
FILE NUMBER: 704  
PRESENT ZONING: B-3  
ORIGINAL OWNER:  
ORIGINAL USE: Automotive Shop  
PRESENT USE: Automotive Shop  
PRESENT OWNER: University Firestone, Inc.  
ADDRESS: 854 West Main Street  
Charlottesville, VA 22903

HISTORIC NAME:

DATE/PERIOD:

STYLE: No Identifiable Style

HEIGHT (to cornice) OR STORIES: One Story

DIMENSIONS AND LAND AREA: 50' x 96' (4,850 sq. ft.)

CONDITION: Fair

SURVEYOR: Bibb

DATE OF SURVEY: Spring 1995

SOURCES: City Records

Sanborn Map Co. - 1896, 1920, 1929-57

#### ARCHITECTURAL DESCRIPTION

*conceals* The walls of this tall one-story building are constructed of a cinderblock, painted *plain* gray. The front portion of the *western* northern side wall is faced with horizontal siding. A *plan* parapet *conceals* a flat roof. On the facade, there are a garage door, an industrial sash window (painted over), and an entrance door, with brick *surrounds* *surroundings* between them. There are four huge glass-brick windows on the southern elevation.

#### HISTORICAL DESCRIPTION

*G.* George & Ruth Gilmer purchased this lot in 1937 (City DB 93-13) and deeded it to their three children, Decca G. Frackelton, Betsy *C.* Tremain, and George Gilmer, Jr., in 1947 (DB 129-458). This building was erected sometime between 1929 and 1957 and has always been used as an annex to the Charlottesville Motors Building at 852-854 West Main Street. University Firestone, Inc. *U.* purchased both buildings in 1972 (DB 339-44).

The 1896 Sanborn Map shows a 1½ story cottage on this site that was gone by 1920.

30-6V

#704

50x76 = 4800

B-2

114 8th St (formerly 108)

854 W Main

339-44

Univ. Foxstone, Inc

1972

176-29

Dessa C. Frabellon, et al

George Gelmer

1-5

cinderblock walls, built-up steel roof, concrete  
are concrete  
"med" age

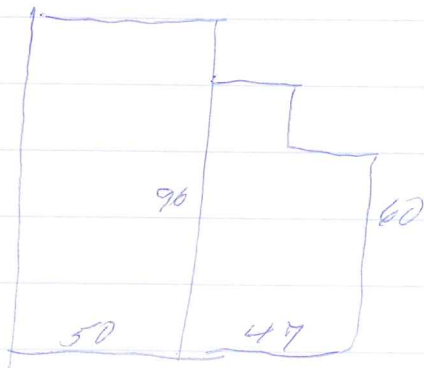

114 9th SW

Wall 1-5, CB, gray

pl parapet

garage door & ~~ind~~ ind wind (painted) on N & ent door bet,  
w/ back around

"WB" on front porch N & E

~~2 garage doors (infilled)~~

~~2 infilled ind wind on rear~~

4 huge glass brick wind S