

STREET ADDRESS: 853 West Main Street  
 MAP & PARCEL: 31-170  
 FILE NUMBER: 700  
 PRESENT ZONING: B-3  
 ORIGINAL OWNER: Safeway Stores, Inc.  
 ORIGINAL USE: Supermarket  
 PRESENT USE: Offices  
 PRESENT OWNER: Rivanna Partners Limited Partnership  
 ADDRESS: P. O. Box 7885  
 Charlottesville, VA 22906  
 HISTORIC NAME: West Main Street Safeway Building  
 DATE/PERIOD: 1969, 1988  
 STYLE:  
 HEIGHT (to cornice) OR STORIES: One Story  
 DIMENSIONS AND LAND AREA: 310' x 212' (1½ acres)  
 CONDITION: Good  
 SURVEYOR: Bibb  
 DATE OF SURVEY: Spring 1995  
 SOURCES: City Records  
 Sanborn Map Co. - 1896, 1920, 1929-57, 1965  
 Ch'ville City Directories  
 Immanuel Lutheran Church History

### ARCHITECTURAL DESCRIPTION

Built to house the Safeway Supermarket, this one-story brick building has been remodeled for use as an office building. It faces west, toward its parking lot. Brick is laid in stretcher bond with rusticated corner quoins. A concrete-capped parapet conceals a flat roof. The building is ten bays wide, with the bays separated by brick piers. There are large, segmentally arched, stuccoed niches in the end bays. They were designed to display the Safety logo. The next bay at the southern end is blank. In the other seven bays, multi-light display windows and glass doors have replaced the plate glass display windows. An arcaded gallery covers these seven bays. Wide rectangular brick pillars with moulded brick bases and a band of vertical stretchers defining a frieze support a brick parapet decorated with bands of vertical headers at the top and bottom. The gallery has a hipped roof covered with standing-seam metal. There is a loading deck wing with two warehouse doors at the rear of the northern elevation. A lower, 3-bay wing covers the southern elevation. There is a multi-light display window in each bay of the western facade. The central bay is recessed ~~in~~ <sup>an</sup> entrance loggia which originally had a door in each side. The southern door has been replaced with a window. On the southern elevation, there are two 2-light, fixed-sash windows ~~initiating~~ double-sash in each bay.

*imitating*

*its*

*deck*

*there is a*

*three*

newer

## HISTORICAL DESCRIPTION

Safeway Stores, Inc. began acquiring property here in 1952 (City DB 168-375, 168-378, 168-382, 173-89, 177-57). Three late 19th century houses, a 19th century wooden church building, and several wooden church buildings on West Main Street and four small workers' cottages on Short Street were demolished in 1954. The church building had been moved to 851 West Main Street in 1916 from a site across the street and to the east, near the railroad bridge. Originally a Presbyterian Church, it had been leased by Immanuel Lutheran Church since 1900 and purchased in 1908. The railroad had it moved to this lot in 1916, and a small manse was built at the rear of the lot. The congregation built a new church on Jefferson Park Avenue in 1953. The first Safety Store building was erected in 1954-55. It was located west of the present building and faced the street. The present building replaced it in 1969. After Safeway closed this store, Ninth and West Main Limited Partnership bought the property in 1985 (DB 467-695), transferred ownership to Rivanna Partners Limited Partnership in 1987 (DB 500-1719), remodeled the Safeway Building for use as offices, and erected a large new building.

west of it  
179 Safeway

## RECONNAISSANCE LEVEL SURVEY REPORT

DEPARTMENT OF HISTORIC RESOURCE  
RECONNAISSANCE SURVEY FORM*Reviewed by Margaret Peters*

DHR Identification Number: 104-0347

Other DHR Number: Property Date(s) 1970 ca

## PROPERTY NAMES

Republic Plaza Annex (853 W. Main St.)

## EXPLANATION

Address-Current

County/Independent City: Charlottesville

State: Virginia

Magisterial District: N/A

Tax Parcel: 31-170

USGS Quad Map Name: CHARLOTTESVILLE EAST

UTMs of Boundary:

Center UTM:

Restrict location and UTM data? N

## ADDRESSES

Number	Thoroughfare Name	Explanation
--------	-------------------	-------------

853 -	W. Main St.	
-------	-------------	--

Vicinity: Town/Village/Hamlet:

Name of National Register Historic District:

Name of DHR Eligible Historic District:

Name of Local Historic District:

Physical Character of General Surroundings: City

Site Description/Notable Landscape Features:

Built up. Building adjoins Republic Plaza.

Ownership: Private

NR Resource Type: Building

## WUZITS

Seq. #	# of	Wuzit Types	Historic?
1.0	1	Commercial Building	Non-historic

TOTAL: 1

Historic: 0

Non-Historic: 1

## PRIMARY RESOURCE EXTERIOR COMPONENT DESCRIPTION

Component	#	Comp Type/Form	Material	Material Treatment
Structural System	0	Masonry	Brick	Veneer
Roof	0	Flat	Asphalt	Built-up
Window(s)	0	Sash, double-hung	Metal	1/1

#### INDIVIDUAL RESOURCE INFORMATION

SEQUENCE NUMBER: 1.0 WUZIT: Commercial Building  
 Primary Resource? Yes  
 Estimated Date of Construction: 1970 ca  
 Source of Date: Site Visit  
 Architectural Style: No Style Listed  
 Description:  
 Utilitarian building with ground-hugging massing. Original and present front faces parking lot to west.  
 Condition: Good  
 Threats to Resource: None Known  
 Additions/Alterations Description:  
 Building appears to be ca. 1987 remodeling of an earlier commercial building, possibly a supermarket.  
 Number of Stories: 1.0  
 Interior Plan Type:  
 Accessed?

Interior Description:

Relationship of Secondary Resources to Property:

DHR Historic Context:

Significance Statement:  
 The building does not contribute to the historic character of West Main Street. The building may have been operated as a Safeway grocery store prior to a 1987-88 redevelopment project that resulted in the construction of Republic Plaza at 855 W. Main St.

#### GRAPHIC DOCUMENTATION

Medium	Medium ID #	Frames	Date
B&W 35mm Photos	14633	29 -	2/ /1996

#### BIBLIOGRAPHIC DATA

Sequence #: 1.0 Bibliographic Record Type: Newspaper  
 Author: Charlottesville Daily Progress  
 Citation Abbreviation:  
 October 17, 1987  
 Notes:

Date: 2/ /1996  
Cultural Resource Management Event: Reconnaissance Survey  
Organization or Person: J. Daniel Pezzoni, Preserv Consult  
ID # Associated with Event:  
CRM Event Notes or Comments:

MAILING ADDRESS

Honorif:  
First :  
Last :  
Suffix :  
Title :  
Company: Rivanna Partners LP

Address: PO Box 7885

City : Charlottesville State: VA  
Zip : 22906- Country: USA  
Phone/extension: - -

Individual Category Codes:

Mailing Address Notes:

Surveyor's Notes:

CITY OF CHARLOTTESVILLE

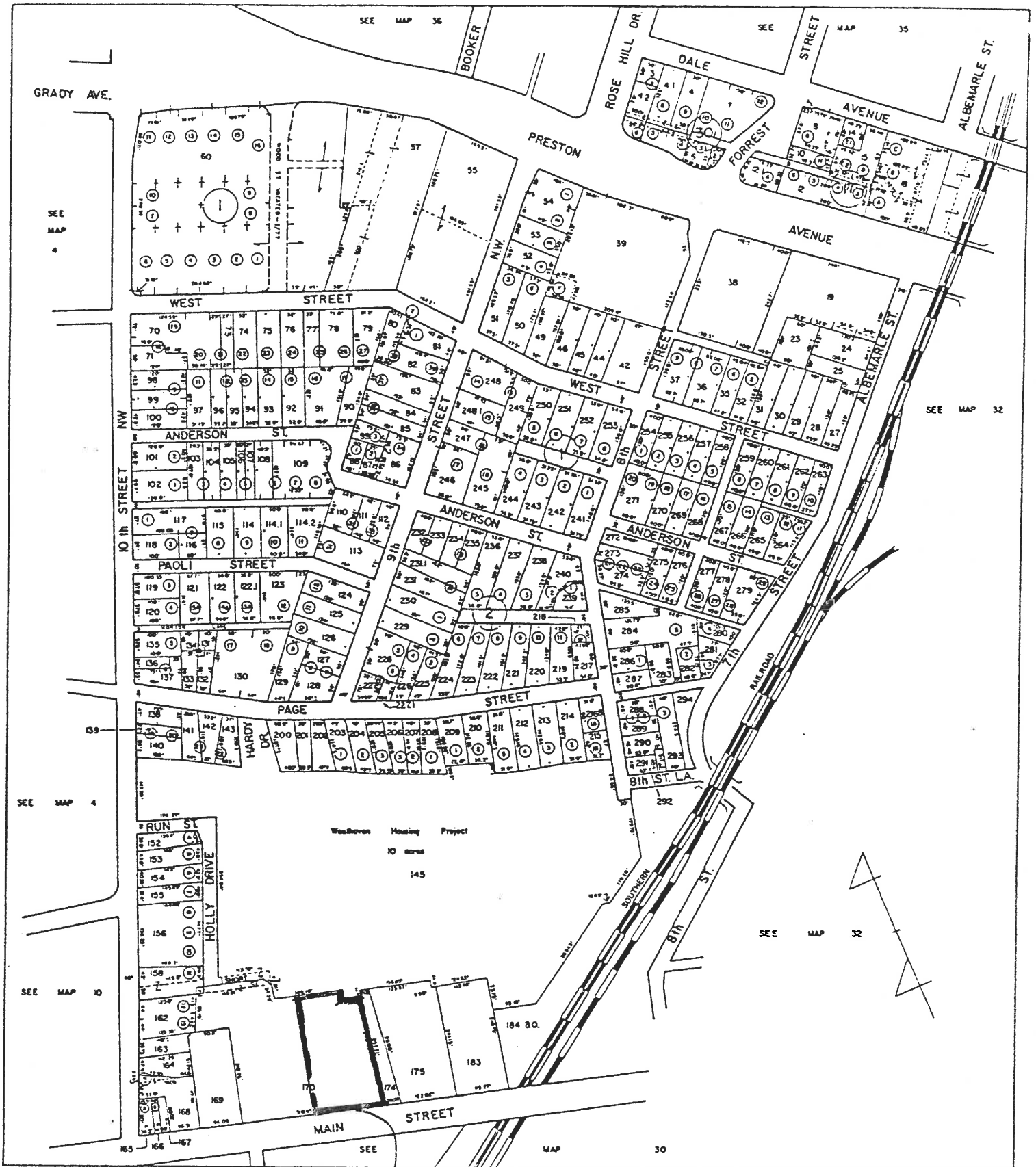

SCALE : 1" = 100'

104-347

SECTION 31

reconnaissance main screen 1 of 7

Where is data filed at DHR? \_\_\_\_\_  
 DHR Id. # \_\_\_\_\_ Property date(s) \_\_\_\_\_  
 Other DHR no. \_\_\_\_\_

Seq. # \_\_\_\_\_ Name \_\_\_\_\_ Property Names \_\_\_\_\_ Explanation \_\_\_\_\_  
Republic Plaza Annex?

Address	Alternate spelling	Former/current	Historic/location	Original
Address-current	Current	Function/location	Location	VLR listing
Alleged	Descriptive	Historic	NHL listing	
Alternate name	Former	Historic/current	NRHP listing	

County/Ind. City \_\_\_\_\_ Tax Parcel Number 31-170  
 State VA Virginia  
 Magis'l District \_\_\_\_\_  
 USGS Quad Map Name \_\_\_\_\_  
 Center UTM-Zone/East/North \_\_\_\_\_

reconnaissance main screen 2 of 7

Restrict Location and UTM data? \_\_\_\_\_

Seq. # \_\_\_\_\_ Name \_\_\_\_\_ Address \_\_\_\_\_ Explanation \_\_\_\_\_  
553 Thoroughfare Name

Sequence Number \_\_\_\_\_ Address Superfield Screen \_\_\_\_\_  
 Main Street Number \_\_\_\_\_ Address Explanation \_\_\_\_\_  
 Number Suffix \_\_\_\_\_ Alternate \_\_\_\_\_ Name Change \_\_\_\_\_  
 Street Name \_\_\_\_\_ Current \_\_\_\_\_ Number Change \_\_\_\_\_

Vicinity of: \_\_\_\_\_ Town/Village/Hamlet \_\_\_\_\_

Name of National Register Historic District \_\_\_\_\_

Name of VDH Historic District \_\_\_\_\_

Name of Local Historic District \_\_\_\_\_

reconnaissance main screen 3 of 7

Physical Character of General Surroundings \_\_\_\_\_  
 City \_\_\_\_\_ Hamlet \_\_\_\_\_ Rural \_\_\_\_\_ Suburban \_\_\_\_\_ Town \_\_\_\_\_ Village \_\_\_\_\_

Site Description/Notable Landscape Features \_\_\_\_\_  
built up, bus stop in front

Ownership \_\_\_\_\_ NR Resource Type \_\_\_\_\_  
 F Public-Federal P Private B Building S Site  
 L Public-Local S Public-State D District U Structure  
 O Object

Seq. # \_\_\_\_\_ # of \_\_\_\_\_ Wuzit Count \_\_\_\_\_ Historic? \_\_\_\_\_  
 Wuzit Types \_\_\_\_\_ Total \_\_\_\_\_  
 Historic \_\_\_\_\_ Non-Historic \_\_\_\_\_ Undetermined \_\_\_\_\_

Combine  
 this  
 w/ Republic Plaza  
 same address

reconnaissance main screen 4 of 7

Primary Resource Exterior Component Description

Component	#	Comp Type/Form	Material	Material Treatment
chimney(s)	-			
columns	-			
cornice	-			
dormer(s)	-			
foundation	NV			
porch	-			
roof	1	flat	asph	knit up
walls	1	brick	br ven	struted
windows	1	double	modern	1/1

Individual Resource Information

Seq. # \_\_\_\_\_ Wuzit \_\_\_\_\_ Primary? \_\_\_\_\_ Date Built \_\_\_\_\_

Individual Resource Superfield Screen

Sequence Number \_\_\_\_\_ Wuzit \_\_\_\_\_  
 Primary Resource? \_\_\_\_\_  
 Estimated Date of Construction \_\_\_\_\_ Source of Date \_\_\_\_\_  
 Architectural Style \_\_\_\_\_  

Art Deco	French Colonial	Late Gothic Revival	Prairie School
Beaux Arts	French Renaissance	Late Victorian	Pueblo
Bungalow/Craftsman	Georgian	Mid-19th C.	Queen Anne
Chicago	Gothic	Mission/Spanish	Renaissance
Classical Revival	Gothic Revival	Colonial Revival	Romanesque
Colonial	Greek Revival	Mixed (more than 3 styles from different periods)	Second Empire
Colonial Revival	Italian Renaissance	Modern Movement	Shingle Style
Commercial Style	Italian Villa	Modern	Skyscraper
Dutch Colonial	Italianate	No Style Listed	Spanish Colonial
Early Class. Rev.	Late 19th &	Octagon Mode	Stick/Eastlake
Early Republic	20th C. Revivals	Other	Tudor Revival
Exotic Revival	Late 19th & Early	Postmedieval English	
Federal	20th C. Amer. Movements		

Util'n bldg w/ front office wing, larger rear wing, saw awnings over wide on S elev.

Condition	Excellent	Good	Good-Fair	Poor	Remodeled
Demolished	Fair	Good-Excellent	N/A	Rebuilt	Ruinous
Deteriorated					

Threats to Resource \_\_\_\_\_  
 Demolition \_\_\_\_\_ Development \_\_\_\_\_ Neglect \_\_\_\_\_ None Known \_\_\_\_\_ Relocation \_\_\_\_\_ Trans. Expan. \_\_\_\_\_  
 Deterioration \_\_\_\_\_ Major Alteration \_\_\_\_\_ None \_\_\_\_\_ Public Util. Expan. \_\_\_\_\_ Structural Failure \_\_\_\_\_ Vacant \_\_\_\_\_

Additional/Alterations Description

rear wing  
 fr.  
 Rep Plaza  
 here

wing w/ fr. porch along w side facing pilot

Conditional Individual Resource Superfield Screen

Number of Stories: \_\_\_\_\_  
 Interior Plan Type: \_\_\_\_\_  
 Accessed? \_\_\_\_\_ If not, why not? \_\_\_\_\_  
 Denied \_\_\_\_\_ No Trespassing \_\_\_\_\_ Not Accessible \_\_\_\_\_  
 Interior Description: \_\_\_\_\_

Relationship of Secondary Resources: \_\_\_\_\_

*reconnaissance main screen 5 of 7*  
 Historic Context

DHR Historic Context(s):  
 Agriculture/Subsistence \_\_\_\_\_ Ethnicity/Immigration \_\_\_\_\_ Recreation/Arts \_\_\_\_\_  
 Architecture/Landscape Architecture/ \_\_\_\_\_ Funerary \_\_\_\_\_ Religion \_\_\_\_\_  
 Community Planning \_\_\_\_\_ Health Care \_\_\_\_\_ Settlement Patterns \_\_\_\_\_  
 Commerce/Trade \_\_\_\_\_ Industry/Processing/Extraction \_\_\_\_\_ Social \_\_\_\_\_  
 Domestic \_\_\_\_\_ Landscape \_\_\_\_\_ Traffic Engineering \_\_\_\_\_  
 Education \_\_\_\_\_ Military/Defense \_\_\_\_\_ Transportation \_\_\_\_\_  
 Other \_\_\_\_\_

Significance Statement: \_\_\_\_\_

*reconnaissance main screen 6 of 7*  
 Graphic Documentation

Medium*	Medium ID #	Frames	Date
2 x 2 B & W photos	B & W 35 mm photos	Historic photos	Slides
4 x 5 B & W photos	Color 35 mm photos	Measured drawings	

Bibliographic Data  
 Seq. # \_\_\_\_\_ Type \_\_\_\_\_ Citation \_\_\_\_\_

Bibliographic Superfield Screen  
 Sequence #: \_\_\_\_\_ Bibliographic Record Type: \_\_\_\_\_ Author: \_\_\_\_\_  
 Citation Abbreviation: \_\_\_\_\_

Notes: \_\_\_\_\_

Bibliographic Superfield Screen  
 Sequence #: \_\_\_\_\_ Bibliographic Record Type: \_\_\_\_\_ Author: \_\_\_\_\_  
 Citation Abbreviation: \_\_\_\_\_

Notes: \_\_\_\_\_

*reconnaissance main screen 7 of 7*  
 Cultural Resource Management Events  
 Agency/Individual

Date	CRM Event	Assoc. ID#
_____	_____	_____

CRM Event Superfield Screen  
 Date: \_\_\_\_\_ Cultural Resource Management Event: \_\_\_\_\_  
 Organization or Person: \_\_\_\_\_  
 ID# Associated with Event: \_\_\_\_\_

Notes or Comments

Mailing Address Superfield Screen  
 HONORIF: \_\_\_\_\_ Record Created: \_\_\_\_\_  
 FIRST: \_\_\_\_\_ Last Updated: \_\_\_\_\_  
 LAST: \_\_\_\_\_  
 SUFFIX: \_\_\_\_\_  
 TITLE: \_\_\_\_\_  
 COMPANY: \_\_\_\_\_ PHONE/EXTENSION: \_\_\_\_\_  
 ADDRESS: \_\_\_\_\_ STATE: \_\_\_\_\_  
 CITY: \_\_\_\_\_ COUNTRY: \_\_\_\_\_  
 ZIP: \_\_\_\_\_

Individual's Category Codes

Informant	Occupant	Owner	Specimens (owner of specimens)	Tenant
_____	_____	_____	_____	_____

Surveyor's Notes

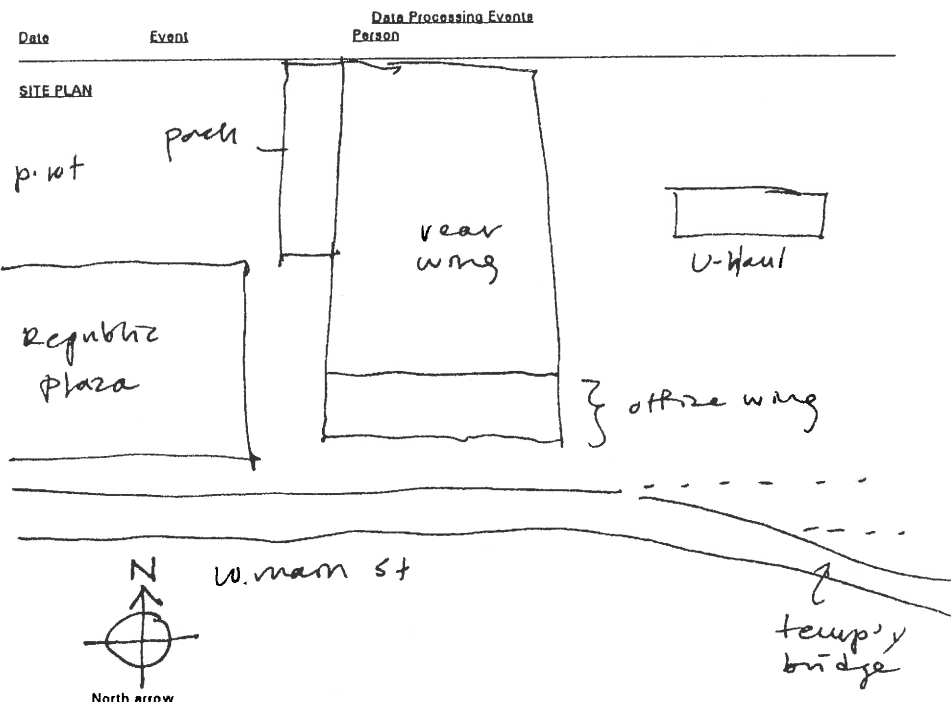

N.T.S.  
 Date: \_\_\_\_\_  
 SES - 2/96

Drawn by: \_\_\_\_\_  
 Agency: \_\_\_\_\_



31-170 ✓

# 900 & 901

310 x 212 = 87,599  
B-3

853 W. Main

500-179	Rivanna Partners, Ltd. <sup>*</sup> Handy	1987	plat 500-184-187
467-695	9th & West Main	" " <sup>*</sup> 1985	" 186-401 no plat
186-401	Metropolitan Life Ins. Co.	1953	"
	Safeway Stores, Inc.		

\* Chan Wm Hunt & Blake Hunt

Safeway - ~~1971~~ 1969

office  
new bldg - 1988  
3 1/2 - 5

~~exterior~~ brick found, brick covered walls, metal hipped roof

ABC store built <sup>1971</sup> ~~1972~~

Safeway - 1954-55

## City Directories

- 1953 ~~849~~ 849 - dwelling (owned & occupied by Annie L. Carter)  
851 - Immanuel Lutheran Church & manse  
853-855 - Cavalier Mtns - used cars  
861-863 - vacant bldg  
901 - Union Shell ser sta

Kurt Wassenger ?

Safeway property

all den 1954

parcel 31-170 1952 DB 168-378 plot 168-325 ✓ no bldg den

31-171 1952 168-382

861 & 863 W Main 2-5 brick dwelling w/ slate roof, old

853-855 " CB store bldg, old

31-172 1953

173-89

from Denmark Lutheran Ch

plot 173-90

851 W Main

1-5 frame dwelling

31-173 1954

177-57

849 W Main

2-5 frame dwelling w/ metal roof, old

31-160 1952

168-382

Short St

vacant?

panel 31-161

1952

168-375

906-912 Short St 1-5 dwelling, mid age

908

"

"

"

"

910

"

"

"

"

912

"

"

"

"

~~31-161~~

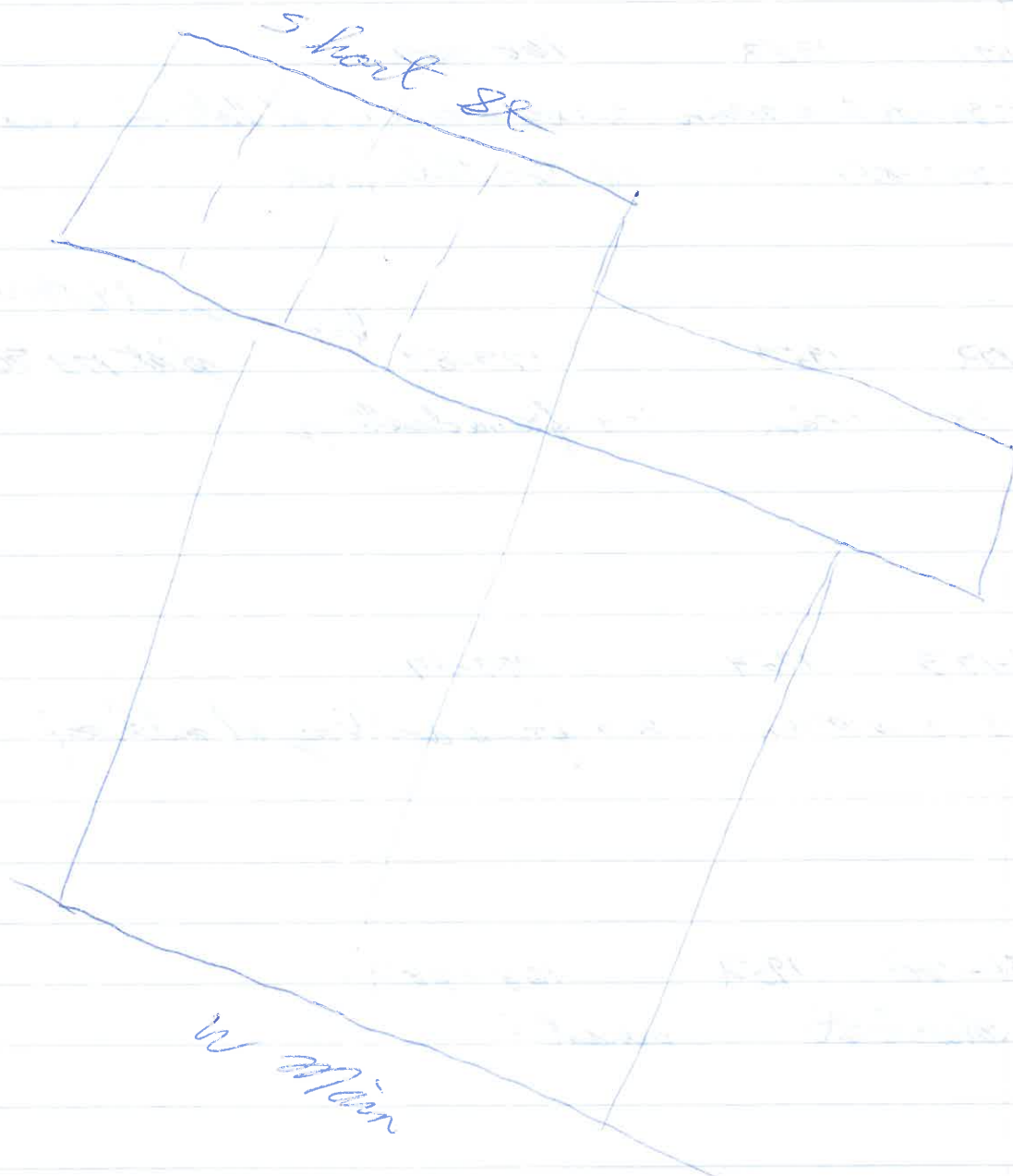

near  
ABC

## Safeway Bldg #53

1-5, stretch of rusticated brick corner quoins  
flat roof of conc-capped parapet  
loading dock wing of 2 warehouse doors at rear of N el  
face W

new arcade (?)

7 bays wide

wide brick pillores w/ moulded brick bases

band of vertical ~~headers~~ stretchers  $\frac{2}{3}$  way up  
brick ~~face~~ <sup>parapet</sup> over all, w/ band vert headers at top balcony  
5.5m hipped roof

10 bays wide up by brick piers

~~work~~ seg-headed arched stuccoed niches in end bays

2nd fr 5 blank

multi-light display end x glass doors replace  
plate glass in others

1-5 ABC addn on 5

W - 3 bays, ~~ent in~~ <sup>N side</sup> recessed cent bay, wind other 2 all

S - 5 bays; 3rd wind 1st 4, ~~door~~ <sup>door</sup> ~~use~~

#E. 6 blank

14633

Date 2.1996 File No. 104-347

Name Republic Plaza Annex

Town (853 W. Main St.)

County Charlottesville

Photographer Dan Peccori

Contents 1 ext. view

