

# Architectural And Historic Survey



## Identification

STREET ADDRESS: 410 Ridge Street  
 MAP & PARCEL: 28-156  
 CENSUS TRACT AND BLOCK:  
 PRESENT ZONING: R-3  
 ORIGINAL OWNER: J. Emmett Gleason  
 ORIGINAL USE: Residence  
 PRESENT USE: Day Care Center  
 PRESENT OWNER: Barrett Day Care Center, Inc.  
 ADDRESS: 410 Ridge Street  
 Charlottesville, Virginia

HISTORIC NAME: J. Emmett Gleason House  
 DATE / PERIOD: 1915  
 STYLE: Vernacular  
 HEIGHT (to cornice) OR STORIES: 2 storeys  
 DIMENSIONS AND LAND AREA: 50' x 175' (8750 sq. ft.)  
 CONDITION: Good  
 SURVEYOR: Bibb  
 DATE OF SURVEY: Spring 1984  
 SOURCES: City Records  
 Sanborn Map Co. - 1907, 1920  
 Mrs. J. Emmett Gleason (1979)

Cedric Washington  
 Mrs. Clara Johnson

## ARCHITECTURAL DESCRIPTION

The J. Emmett Gleason House combines Victorian massing with Colonial Revival detail, as do many houses built in the early years of the twentieth century. It is two storeys tall, two bays wide, and double pile, with a projecting pavilion at the rear of the north side of the house. The lot slopes steeply away from the street, and the house is set on a very high concrete foundation so that the basement is above ground on three sides, but the front yard has been filled in to the level of the water table. Wall construction is of brick laid in 7-course American bond. The house has a medium-pitched, L-shaped hip roof covered with slate. There are gables centered over the facade and the projecting pavilion. The roof has projecting eaves and verges, a boxed cornice with returns, and a plain frieze. There are two small interior end chimneys. The tall windows are segmental-arched, double-sash, 1-over-1 light, with wooden sills and moulded surrounds. Those at the second level are shorter, and the first storey window on the facade is wider. Basement windows are also segmental-arched, and some are half-sized hinged sash. A one-storey veranda covers the facade and extends along the north side as far as the projecting pavilion. It has a low-pitched hip roof covered with standing-seam metal with projecting eaves, boxed cornice, plain frieze, Tuscan columns, and a simple balustrade. A semi-elliptical-arched entrance is located in the north bay of the main block. The door has a single large pane of glass, and there are single-light sidelights and semi-elliptical transom. A 2-flight open stair with simple balustrade rises from the rear of the entrance hall in the center front of the house. The wall between the entrance hall and parlor extends only half way to the ceiling between square pillars. The brick fireplace in the parlor has a plain wooden mantel shelf. There is a built-in oak china press in the dining room. Access to the sun parlor from the dining room is by a pair of 10-light French doors. A nearly flat-roofed 2-storey complex of enclosed porches covers the rear of the main block. Two segmental-arched doors give access to an open porch at the basement level. The southern portion of the first storey level is a sun parlor enclosed with weatherboarding and 6-over-6 and 8-over-8 light windows. The rest of the first level of the back porch is open and has wooden piers and a solid wooden balustrade. The second storey is a sleeping porch enclosed with vertical siding and 8-over-8 light windows.

rear

## HISTORICAL DESCRIPTION

J. Emmett Gleason purchased this lot in 1915 (City DB 29-480) and built the house immediately, according to family and tax records. Mr. Gleason had been raised at 522 Ridge Street and was a partner with his father and brother in the firm of H. M. Gleason and Co. After living in this house for over a quarter century, the Gleasons sold it to Ross C. & Freda K. Garletts in 1943 (DB 115-206) and moved to the Abell-Gleason House on North First Street. In 1958 the Charlottesville & Albemarle Community Chest, Inc., bought the house for the Janie Porter Barrett Day Care Center (DB 205-116). Now the oldest day care center in the state, it was founded in 1935 and had occupied the Bethel Institutional Baptist Church building at 501 Commerce Street since the mid-1940's. Except for alterations made in 1958 to comply with the fire code - notably the addition of two fire escapes - the Gleason House remains essentially unchanged. The adjacent lot has always been vacant and has been owned by the owner of this house most of the time since 1936.

Additional Reference: City DB 371-210, 88-246, 120-254, 138-132.

*(These dashes should be longer. They look too much like hyphens.)*

# Architectural And Historic Survey

## Identification

<b>STREET ADDRESS:</b> 410 Ridge Street	<b>HISTORIC NAME:</b> J. Emmett Gleason House	
<b>MAP &amp; PARCEL:</b> 28-156	<b>DATE / PERIOD:</b> 1915	
<b>CENSUS TRACT AND BLOCK:</b>	<b>STYLE:</b> Vernacular	
<b>PRESENT ZONING:</b> R-3	<b>HEIGHT (to cornice) OR STORIES:</b> 2 storeys	
<b>ORIGINAL OWNER:</b> J. Emmett Gleason	<b>DIMENSIONS AND LAND AREA:</b> 50' x 175' (8750 sq. ft.)	
<b>ORIGINAL USE:</b> Residence	<b>CONDITION:</b> Good	
<b>PRESENT USE:</b> Day Care Center	<b>SURVEYOR:</b> Bibb	
<b>PRESENT OWNER:</b> Barrett Day Care Center, Inc.	<b>DATE OF SURVEY:</b> Spring 1984	
<b>ADDRESS:</b> 410 Ridge Street Charlottesville, Virginia	<b>SOURCES:</b> City Records Sanborn Map Co. - 1907, 1920 Mrs. J. Emmett Gleason (1979)	Ceadric Washington Mrs. Clara Johnson

## ARCHITECTURAL DESCRIPTION

The J. Emmett Gleason House combines Victorian massing with Colonial Revival detail, as do many houses built in the early years of the twentieth century. It is two storeys tall, two bays wide, and double pile, with a projecting pavilion at the rear of the north side of the house. The lot slopes steeply away from the street, and the house is set on a very high concrete foundation so that the basement is above ground on three sides, but the front yard has been filled in to the level of the water table. Wall construction is of brick laid in 7-course American bond. The house has a medium-pitched, L-shaped hip roof covered with slate. There are gables centered over the facade and the projecting pavilion. The roof has projecting eaves and verges, a boxed cornice with returns, and a plain frieze. There are two small interior end chimneys. The tall windows are segmental-arched, double-sash, 1-over-1 light, with wooden sills and moulded surrounds. Those at the second level are shorter, and the first storey window on the facade is wider. Basement windows are also segmental-arched, and some are half-sized hinged sash. A one-storey veranda covers the facade and extends along the north side as far as the projecting pavilion. It has a low-pitched hip roof covered with standing-seam metal with projecting eaves, boxed cornice, plain frieze, Tuscan columns, and a simple balustrade. A semi-elliptical-arched entrance is located in the north bay of the main block. The door has a single large pane of glass, and there are single-light sidelights and semi-elliptical transom. A 2-flight open stair with simple balustrade rises from the rear of the entrance hall in the center front of the house. The wall between the entrance hall and parlor extends only half way to the ceiling between square pillars. The brick fireplace in the parlor has a plain wooden mantel shelf. There is a built-in oak china press in the dining room. Access to the sun parlor from the dining room is by a pair of 10-light French doors. A nearly-flat-roofed 2-storey complex of enclosed porches covers the rear of the main block. Two segmental-arched doors give access to an open porch at the basement level. The southern portion of the first storey level is a sun parlor enclosed with weatherboarding and 6-over-6 and 8-over-8 light windows. The rest of the first level of the back porch is open and has wooden piers and a solid wooden balustrade. The second storey is a sleeping porch enclosed with vertical siding and 8-over-8 light windows.

## HISTORICAL DESCRIPTION

J. Emmett Gleason purchased this lot in 1915 (City DB 29-480) and built the house immediately, according to family and tax records. Mr. Gleason had been raised at 522 Ridge Street and was a partner with his father and brother in the firm of H. M. Gleason and Co. After living in this house for over a quarter century, the Gleasons sold it to Ross C. & Freda K. Garletts in 1943 (DB 115-206) and moved to the Abell-Gleason House on North First Street. In 1958 the Charlottesville & Albemarle Community Chest, Inc., bought the house for the Janie Porter Barrett Day Care Center (DB 205-116). Now the oldest day care center in the state, it was founded in 1935 and had occupied the Bethel Institutional Baptist Church building at 501 Commerce Street since the mid-1940's. Except for alterations made in 1958 to comply with the fire code - notably the addition of two fire escapes - the Gleason House remains essentially unchanged. The adjacent lot has always been vacant and has been owned by the owner of this house most of the time since 1936.

Additional Reference: City DB 371-210; 88-246, 120-254, 138-132.

## J. EMMETT GLEASON HOUSE



**STREET ADDRESS:** 410 Ridge Street  
**MAP & PARCEL:** 28-156  
**VDHR FILE NUMBER:** 104-25-13  
**CITY FILE NUMBER:** 509  
**PRESENT ZONING:** R-1A  
**ORIGINAL OWNER:** J. Emmett Gleason  
**ORIGINAL USE:** Residence  
**PRESENT USE:** Day Care Center  
**PRESENT OWNER:** Barrett Day Care Center, Inc.  
**ADDRESS:** 410 Ridge Street  
Charlottesville, VA 22902

**HISTORIC NAME:** J. Emmett Gleason House  
**DATE/PERIOD:** 1915  
**STYLE:** Vernacular  
**HEIGHT IN STORIES:** 2  
**DIMENSIONS AND LAND AREA:** 50' x 175' (8750 sq. ft.)  
**CONDITION:** Good  
**SURVEYOR:** Bibb  
**DATE OF SURVEY:** Spring 1984, Revised 1993  
**SOURCES:** City Records  
Sanborn Map Co. - 1907, 1920

# J. EMMETT GLEASON HOUSE

## ARCHITECTURAL DESCRIPTION

The J. Emmett Gleason House combines Victorian massing with Colonial Revival detail, as do many houses built in the early years of the twentieth century. It is two storeys tall, two bays wide, and double pile, with a projecting pavilion at the rear of the north side of the house. The lot slopes steeply away from the street, and the house is set on a very high concrete foundation so that the basement is above ground on three sides, but the front yard has been filled in to the level of the foundation. Wall construction is of brick laid in seven-course American bond. The house has a medium-pitched, L-shaped, hip roof covered with slate with additional gables centered over the facade and the projecting pavilion. The roof has projecting eaves and verges, a boxed cornice with returns, and a plain frieze. There are two small interior end chimneys. The tall windows are segmental-arched, double-sash, one-over-one light, with wooden sills and moulded surrounds. Those at the second level are shorter, and the first-storey window on the facade is wider. Basement windows are also segmental-arched, and some are half-sized hinged sash. A one-storey verandah shelters the facade and extends along the north side as far as the projecting pavilion. It has a low-pitched hip roof covered with standing-seam metal with projecting eaves, boxed cornice, plain frieze, Tuscan columns, and a simple balustrade. A semi-elliptical-arched entrance is located in the north bay of the main block. The door has a single large pane of glass, and there are single-light sidelights and semi-elliptical transom. A 2-flight open stair with simple balustrade rises from the rear of the entrance hall in the center front of the house. The wall between the entrance hall and parlor extends only half way to the ceiling between square pillars. The brick fireplace in the parlor has a plain wooden mantel shelf. There is a built-in oak china press in the dining room. A nearly flat-roofed two-storey complex of enclosed porches covers the rear of the main block. Two segmental-arched doors give access to an open porch at the basement level. The southern portion of the rear first-storey level is a sun parlor enclosed with weatherboarding and six-over-six and eight-over-eight light windows. A pair of ten-light French doors gives access to the sun parlor from the dining room. The rest of the first-storey level of the back porch is open and has wooden piers and a solid wooden balustrade. The rear second storey is a sleeping porch enclosed with vertical siding and eight-over-eight light windows.

## HISTORICAL DESCRIPTION

J. Emmett Gleason purchased this lot in 1915 (City DB 29-480) and built the house immediately, according to family and tax records. Mr. Gleason had been raised at 522 Ridge Street and was a partner with his father and brother in the firm of H.M. Gleason and Co. After living in this house for over a quarter century, the Gleasons sold it to Ross C. & Freda K. Garletts in 1943 (DB 115-206) and moved to the Abell-Gleason House on North First Street. In 1958 the Charlottesville & Albemarle Community Chest, Inc. bought the house for the Janie Porter Barrett Day Care Center (DB 205-116). Now the oldest day care center in the state, it was founded in 1935 and had occupied the Bethel Institute Baptist Church building at 501 Commerce Street since the mid-1940's. Except for alterations made in 1958 to comply with the fire code - notably the addition of two fire escapes - the Gleason House remains essentially unchanged. The adjacent lot has always been vacant and has been owned by the owner of this house most of the time since 1936.

Additional Reference: City DB 371-210; 88-246, 120-254, 138-132.

## STATEMENT OF SIGNIFICANCE

The J. Emmett Gleason House combines Victorian massing with Colonial Revival detail, as does Gleason's father's larger house at 522 Ridge Street. It is important to the streetscape and to the Ridge Street Historic District.

The Janie Porter Barrett Day Care Center has occupied this house for 35 years.

VDHR Reconnaissance Survey Form

VIRGINIA DEPARTMENT OF HISTORIC RESOURCES  
 PROPERTY SURVEY FORM  
 RECONNAISSANCE LEVEL

IDENTIFICATION INFORMATION

VDHR File # 104-0025-013

Property Name: Historic J. Emmett Gleason House

NR Property Category: Building  
 Wuzit: House

Tax Code: Section Parcel  
 =====  
 28 156

County/City: Charlottesville (City)

USGS Map: USGS Quad: Charlottesville East

ADDRESS/LOCATION INFORMATION

Address: 410 Ridge Street

Location:

Vicinity of: Municipality: ZIP: 22902

PROPERTY CLASSIFICATION INFORMATION

Property Boundaries:  
 Ownership: Private

RESOURCE COUNT -

#	Category	Contributing?	TOTAL:	
1	Building	Contributing	1	
			Contrib:	1
			Non-Contrib:	0

WUZIT COUNT -

#	Wuzit	Contributing?	TOTAL:	
1	House	Contributing	1	
			Contrib:	1
			Non-Contrib:	0

RESOURCE - GENERAL DESCRIPTIVE INFORMATION

Resource Level:  
 Estimated Construction Date: 1915  
 Source of Date: Tax Records  
 Physical Status: Existing  
 Condition: Good  
 Threat: None Known  
 Degree of Historic Integrity:  
 Association:  
 Design:  
 Feeling:  
 Location:  
 Materials:  
 Setting:  
 Workmanship:

PRIMARY RESOURCE RECONNAISSANCE DESCRIPTION

Architectural Style/Derivative: Vernacular

# of Stories: 2.0 # of Bays Wide: 2 # of Bays Deep: 4  
 Arch Config: Geo Config:  
 Footprint:

Component	#	Form/Treatment	Material	Matr'l Treatment
Chimneys		Interior End	Brick	
Foundation		Raised sides/rear	Concrete	
Porch		Wrap-around	Wood	Colonial Revival
Roof		Hipped	Slate	
Windows		double-hung sash	Wood	1-over-1

Brief Architectural Description of Primary Resource:

The J. Emmett Gleason House combines Victorian massing with Colonial Revival detail, as do many houses built in the early years of the twentieth century. It is two storeys tall, two bays wide, and double pile, with a projecting pavilion at the rear of the north side of the house. The lot slopes steeply away from the street, and the house is set on a very high concrete foundation so that the basement is above ground on three sides, but the front yard has been filled in to the level of the water table. Wall construction is of brick laid in seven-course American bond.

The house has a medium pitched, L-shaped hip roof covered with slate. There are gables centered over the facade and the projecting pavilion. The roof has projecting eaves and verges, a boxed cornice with returns, and a plain frieze. There are two small interior end chimneys. The tall windows are segmentally-arched, double-sash, one-over-one light, with wooden sills and moulded surrounds. Those at the second level are shorter, and the first storey window on the facade is wider. Basement windows are also segmental-arched, and some are half-sized hinged sash. A



one-storey verandah covers the facade and extends along the north side as far as the projecting pavilion. It has a low-pitched hip roof covered with standing-seam metal with projecting eaves, boxed cornice, plain frieze, Tuscan columns, and a simple balustrade. A semi-elliptical-arched entrance is located in the north bay of the main block. The door has a single large pane of glass, and there are single-light sidelights and semi-elliptical transom. A 2-flight open stair with simple balustrade rises from the rear of the entrance hall in the center front of the house. The wall between the entrance hall and parlor extends only half way to the ceiling between square pillars. The brick fireplace in the parlor has a plain wooden mantel shelf. There is a built-in oak china press in the dining room. A nearly roofed two-storey complex of enclosed porches covers the rear of the main block. Two segmentally arched doors give access to an open porch at the basement level. The southern portion of the first storey level is a sun parlor enclosed with weatherboarding and six-over-six and eight-over-eight light windows. A pair of ten-light French doors gives access to the sun parlor from the dining room. The rest of the first level of the back porch is open and has wooden piers and a solid wooden balustrade. The second storey is a sleeping porch enclosed with vertical siding and eight-over-eight light windows.

#### Brief Architectural Description of Additions and Alterations

Two fire escapes were added in 1958 to comply with the fire code, when the house became the Janie Porter Barrett Day Care Center.

#### Brief Architectural Description of Secondary Resources:

Potentially Contributes to Historic District:

Ridge Street Historic District

Potentially Associated with NR Multiple Property:

#### Architectural and Historical Summary:

##### HISTORICAL DESCRIPTION

J. Emmett Gleason purchased this lot in 1915 (City DB 29-480) and built the house immediately, according to family and tax records. Mr. Gleason had been raised at 522 Ridge Street and was a partner with his father and brother in the firm of H. M. Gleason and Co. After living in this house for over a quarter century, the Gleasons sold it to Ross C. & Freda K. Garletts in 1943 (DB 115-206) and moved to the Abell-Gleason House on North First Street. In 1958 the Charlottesville & Albemarle Community Chest, Inc. bought the house for the Janie Porter Barrett Day Care Center (DB 205-116). Now the oldest day care center in the state, it was founded in 1935 and had occupied the Bethel Institute Baptist Church building at 501 Commerce Street since the mid-1940s. Except for alterations made in 1958 to comply with the fire code - notably the addition of two fire escapes - the Gleason House remains essentially unchanged. The adjacent lot has always been vacant and has been owned by the owner of this house most of the time since 1936.

Additional Reference: City DB 371-210; 88-246, 120-254, 138-132.

SIGNIFICANCE & RELATION TO EVALUATION CRITERIA

The J. Emmett Gleason House combines Victorian massing with Colonial Revival detail, as does Gleason's father's larger house at 522 Ridge Street. It is important to the streetscape and to the Ridge Street Historic District. The Janie Porter Barrett Day Care Center has occupied this house for 35 years.

BIBLIOGRAPHY

Type of Record	Citation
City Records	Charlottesville City Deed Book
Map	Sanborn Map Company

PHOTOGRAPHIC/DRAWINGS DOCUMENTATION

MISSING DATA ELEMENT

Media	VDHR Neg #	Frames	Date
B&W 35mm photos	13470	13 - 15	1/ /1994

CRM MANAGEMENT EVENTS

MISSING DATA ELEMENT

CRM Event	Agency/Organization	Date
Survey	PAVA/Smead and City/Bibb	/ /1984
IPS data entry-PAVA (Smead)		



J. EMMETT GLEASON HOUSE  
410 RIDGE ST.

VDHR FILE NO. 104-25-13

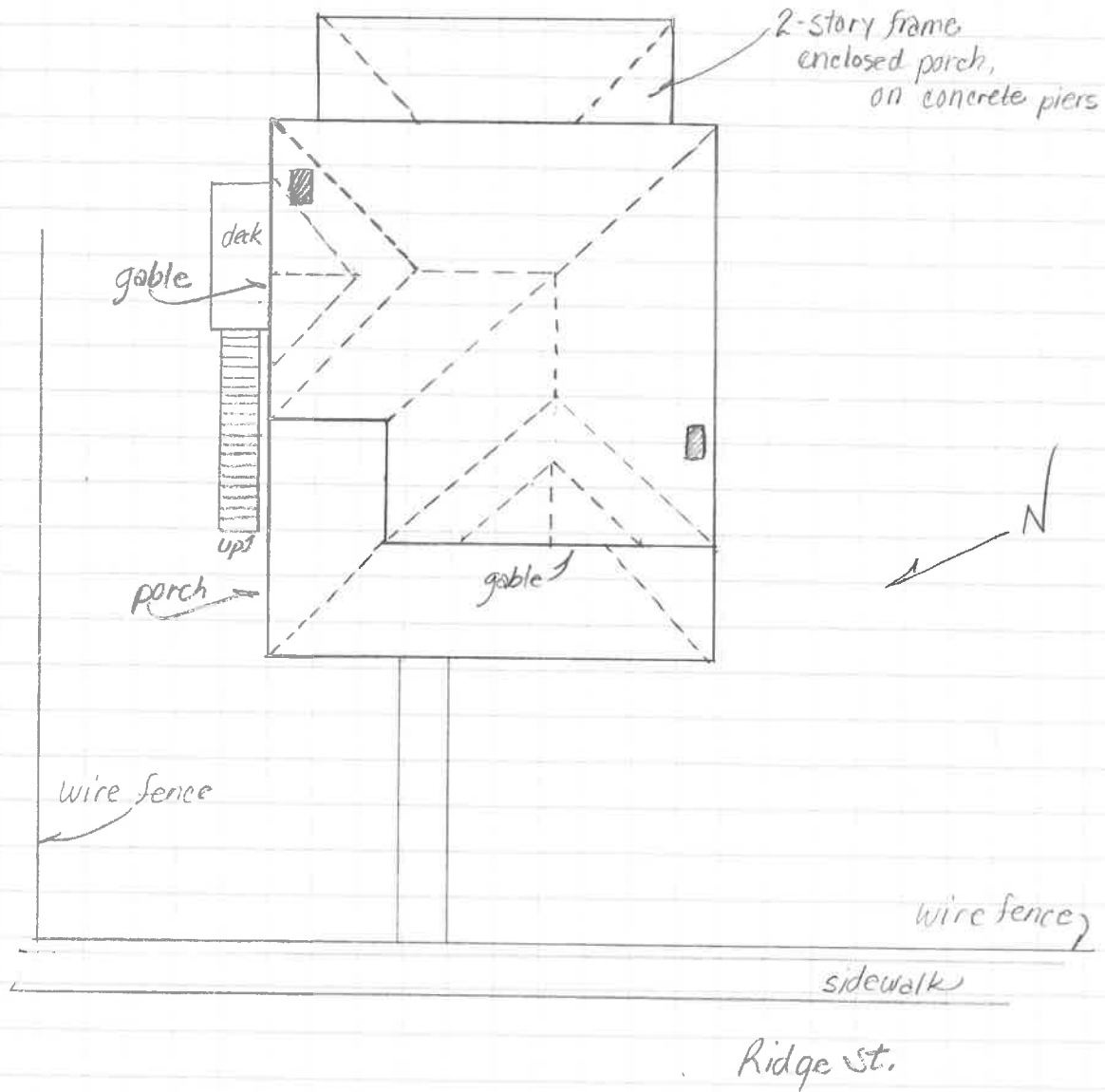

SUSAN E. SMEAD  
PRESERVATION ASSOCIATES OF VIRGINIA

JANUARY 1994

408 and 410 Ridge Street







Date Jan 1994 File No. 104-25-13  
Name J. EMMETT WEAVER HOUSE - 410 RIDGE ST.  
Town CHARLOTTESVILLE  
County \_\_\_\_\_  
Photographer ANN C. HUPPERT  
Contents 3 EXT. VIEWS  
\_\_\_\_\_  
\_\_\_\_\_