

# Architectural And Historic Survey



## Identification

STREET ADDRESS: 510 Ridge Street

MAP & PARCEL: 29-275

CENSUS TRACT AND BLOCK: 4-341

PRESENT ZONING: R-3

ORIGINAL OWNER: James M. Hodges

ORIGINAL USE: Residence

PRESENT USE: Rental Property (apartments)

PRESENT OWNER: Ronald Thompson

ADDRESS: 1932 Arlington Blvd.  
Charlottesville, VA

HISTORIC NAME: Hodges-Gleason House

DATE / PERIOD: 1857

STYLE: Greek Revival

HEIGHT (to cornice) OR STORIES: 2 Storeys

DIMENSIONS AND LAND AREA: 115' x 130' (14,950 sq. ft.)

CONDITION: Poor

SURVEYOR: \_\_\_\_\_/Bibb

DATE OF SURVEY: 1974 (revised 1980)

SOURCES: City/County Records

Alexander, Recollections of Early Ch'ville

## ARCHITECTURAL DESCRIPTION

This structure is a middle class interpretation of the larger high style town houses found at the Hughes House (Market Street) or the Abell-Gleason House (521 North First Street). As with the above mansions, the Hodges-Gleason House is decorated with pilasters applied to a two storey, three bay brick building. The scale of the house, which is only one room deep, is domestic rather than grand. The entrance porch is an example of later Victorian design and was undoubtedly added after the Civil War.

## HISTORICAL DESCRIPTION

John H. Bibb purchased a 2½-acre lot opposite his home of Ridge Street (Bibb-Wolfe House, 505 Ridge Street) for \$300 in 1852 (ACDB 50-270) and sold it to James M. Hodges in 1859 for \$500 (ACDB 58-340). On the same day, Hodges gave a deed of trust for \$2600 on this "house and lot nearly opposite the residence of E. M. Wolfe" to R. T. W. Duke, trustee for Helen S. Morris (Mrs. Wm. M. Morris) (ACDB 58-337 & 443). Tax records show that the house had been built in 1857. Thus, Hodges apparently built the house before receiving a deed to the lot. The house changed hands several times between 1862 and 1864 before being acquired by John T. Barksdale (ACDB 59-683, 60-285, 61-166). He sold it to Henry A. Darrow in 1868 (ACDB 63-160). James Alexander wrote in 1874 that Darrow's "pretty residence" had been built by Hodges and later owned by Morris. Thomas M. Farish bought the house in 1885 (ACDB 84-430) and sold it in 1887 to James E. Gleason, whose family owned it until 1946 (ACDB 88-370; City DB 77-388; 129-383). The house has had several owners since then and has been used as rental property, except for the years 1947-49 when it was owned and occupied by R...H. Marsh (DB 131-367, 143-102). Ronald Thompson bought it in 1973 (DB 352-60).

Additional References: City DB 217-232, 290-177, 348-270.

VDHR Reconnaissance Survey Form

VIRGINIA DEPARTMENT OF HISTORIC RESOURCES  
 PROPERTY SURVEY FORM  
 RECONNAISSANCE LEVEL

IDENTIFICATION INFORMATION

VDHR File # 104-0025-021

Property Name: Historic Hodges-Gleason House

NR Property Category: Building  
 Wuzit: House

Tax Code: Section Parcel  
 =====  
 29 275

County/City: Charlottesville (City)

USGS Map: USGS Quad: Charlottesville East

ADDRESS/LOCATION INFORMATION

Address: 510 Ridge Street

Location:

Vicinity of: Municipality: ZIP: 22901

PROPERTY CLASSIFICATION INFORMATION

Property Boundaries:  
 Ownership: Private

RESOURCE COUNT -

#	Category	Contributing?	TOTAL:	
1	Building	Contributing	1	
			Contrib:	1
			Non-Contrib:	0

WUZIT COUNT -

#	Wuzit	Contributing?	TOTAL:	
1	House	Contributing	1	
			Contrib:	1
			Non-Contrib:	0

RESOURCE - GENERAL DESCRIPTIVE INFORMATION

Resource Level:  
 Estimated Construction Date: 1857  
 Source of Date: Tax Records  
 Physical Status: Existing  
 Condition: Good  
 Threat: None Known  
 Degree of Historic Integrity:  
     Association:  
     Design:  
     Feeling:  
     Location:  
     Materials:  
     Setting:  
     Workmanship:

PRIMARY RESOURCE RECONNAISSANCE DESCRIPTION

Architectural Style/Derivative: Greek Revival

# of Stories: 2.0 # of Bays Wide: 3 # of Bays Deep: 1  
 Arch Config: Geo Config:  
 Footprint:

Component	#	Form/Treatment	Material	Matr'l Treatment
Chimneys		Interior End	Brick	
Foundation		English basement	Brick	Plastered
Porch		Front	Wood	1-story, 3-bay
Roof		low hipped	Metal	Standing seam
Windows		double-hung sash	Wood	6/6

Brief Architectural Description of Primary Resource:

This three-bay, single-pile, two-storey house on an English basement is a vernacular interpretation of the high style Greek Revival detached town house in the pilastered style. Walls are constructed of brick laid in eight-course American-with-Flemish bond. It has a low-pitched hipped roof covered with standing-seam metal with deeply projecting eaves, a boxed cornice, and a plain, deep frieze. There are two interior end chimneys. Windows are double-sash, 6-over-6 light, with architrave trim. Basement and second storey windows are shorter. The wide one-bay Victorian veranda was probably added around the turn of the century. It has a nearly flat hipped roof covered with standing seam metal. It has projecting eaves with a boxed cornice, chamfered posts with scroll brackets, and a Colonial Revival balustrade. The entrance in the central bay of the facade has paneled pilasters, 4-light sidelights over panels, a 3-light rectangular transom, and corner lights. Above the entrance, a second-storey window is flanked by paneled pilasters and narrow, sidelight-sized double-sash windows, and all three have paneled spandrels. A series of wooden

additions and enclosed porches covers the rear elevation. 1987: The rear additions were replaced in 1985 with a two-storey weatherboarded wing covering the northern two bays.

Brief Architectural Description of Additions and Alterations  
The porch probably dates from around the turn of the century.

Brief Architectural Description of Secondary Resources:

Potentially Contributes to Historic District:

Ridge Street Historic District

Potentially Associated with NR Multiple Property:

Architectural and Historical Summary:

#### HISTORICAL DESCRIPTION

John H. Bibb purchased a 2 1/2-acre lot opposite his home on Ridge Street (Bibb-Wolfe House, 505 Ridge Street) for \$300 in 1852 (ACDB 50-270) and sold it to James M. Hodges in 1859 for \$500 (ACDB 58-340). On the same day, Hodges gave a deed of trust for \$2600 on this "house and lot nearly opposite the residence of E. M. Wolfe" to R. T. W. Duke, trustee for Helen S. Morris (Mrs. Wm. M. Morris) (ACDB 58-337 & 443). Tax records show that the house had been built in 1857. Thus, Hodges apparently built the house before receiving a deed to the lot. The house changed hands several times between 1862 and 1864 before being acquired by John T. Barksdale (ACDB 59-683, 60-285, 61-166). He sold it to Henry A. Darrow in 1868 (ACDB 63-160). James Alexander wrote in 1874 that Darrow's "pretty residence" had been built by Hodges and later owned by Morris. Thomas M. Farish bought the house in 1885 (ACDB 84-430) and sold it in 1887 to James E. Gleason, whose family owned it until 1946 (ACDB 88-370; City 77-388; 129-383). The house has had several owners since then and has been used as rental property, except for the years 1947-49 when it was owned and occupied by James H. March (DB 131-367, 143-102). Ronald Thompson bought it in 1973 (DB 352-60).

Additional References: City DB 217-232, 290-177, 348-270.

1987: Walter D. and Barbara J. Pilkey bought the house in 1982 (DB 432-281) and sold it the next year to the Oakwood Land Trust (DB 439-404), which has rehabilitated it.

#### SIGNIFICANCE & RELATION TO EVALUATION CRITERIA

Built in 1857, the Hodges-Gleason House is an elegant vernacular version of the high style Greek Revival town house in the pilastered style. Its front entrance and the tri-partite window arrangement above are nicely detailed, as is the somewhat later Colonial Revival verandah. This house is one of the most important in the Ridge Street Historic District, and it has been individually designated as a local historic landmark.

BIBLIOGRAPHY

Type of Record	Citation
----------------	----------

City Records	Charlottesville City Deed Book
--------------	--------------------------------

County Records	Albemarle County Deed Books
----------------	-----------------------------

Book	Alexander, Recollections of Early Charlottesville
------	---

PHOTOGRAPHIC/DRAWINGS DOCUMENTATION

MISSING DATA ELEMENT

Media	VDHR Neg #	Frames	Date
B&W 35mm photos	13471	5 - 7	1/ /1994

CRM MANAGEMENT EVENTS

MISSING DATA ELEMENT

CRM Event	Agency/Organization	Date
Survey	PAVA/Smead and City/Bibb	/ /1974
IPS data entry-PAVA (Smead)		

HOLMES - GLEASON HOUSE,  
210 RIDGE ST.

VOHP FILE NO. 104-25-21

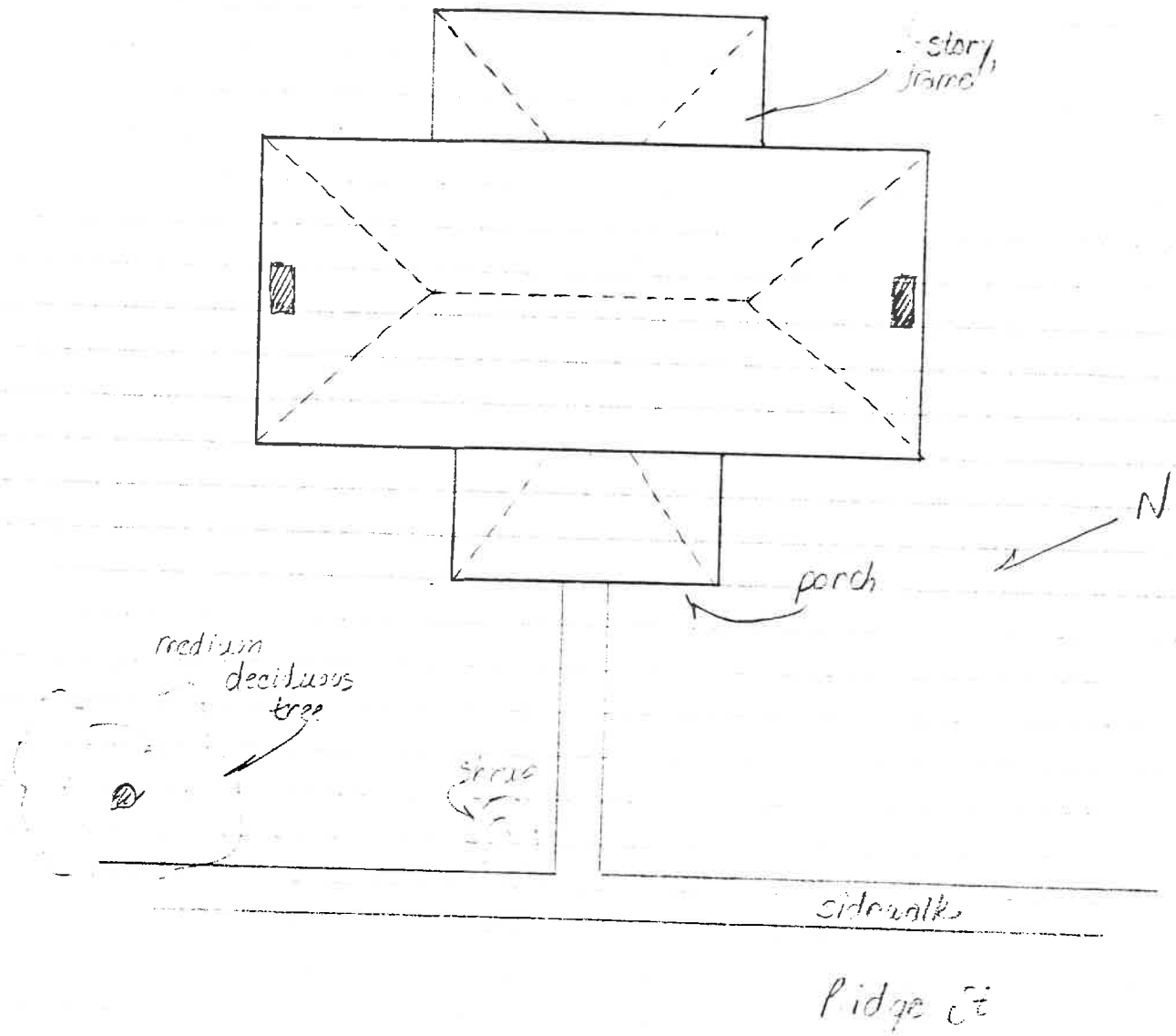

SUEAN E. SWEAD  
PRESERVATION ASSOCIATION OF VIRGINIA

JANUARY 1994

Street Address: 510 Ridge St.

Historic Name:

Map & Parcel: 29-275

Date/Period: 1855

Census Tract & Block:

Style:

Present Owner: Ronald Thompson

Height to Cornice:

Address: 1822 Arlington Blvd.

Height to Eaves:

Present Use:

Present Zoning:

Original Owner:

Land Area (sq. ft.): 115 x 130

Origin 1 Use: apts -

Assessed Value (land+imp)

110 + 1800 = 2910

3 bay pilastered - 60' 6" deep -

Random -

Scroll vict. chamfered post porch -

019 Side transit room deep -

pilaster in back

awful rear mess - shabby -

shallow roof - end chimneys -

Historic Description

Thompson 352-60 1973 - Don Buch  
 Frank Brown 1967 - 290-177  
 Lydia Hauptstark - 1960 217-332  
 Sakellariadis, Nick 145-102

~~57-175~~  
~~57-259~~  
~~56-8~~  
~~57-567~~  
~~57-284~~  
 378

Sakellariadis from R.H. Marsh 1949 \$8,600  
 Marsh from Harry George 1947 131-367 \$11,600  
 (lots 2, 4, 5, 6 129-384)  
 George from Cory A. May, et. of 1946 129-383 \$10,600  
 (lots 2, 4, 5, 6) Annie E. Gleason  
 Annie Gleason from G.F. Gleason estate 1932 77-~~388~~ 388  
 (People's Nat. Bank and  
 Annie Gleason executors)

Gleason - 2 tracts

- 1) from J.A. Kennon 1884 ACDB 84-219  
 7-8 acres (from H.A. Danow 1874 - Danow to Wood trust  
 1868 63-162)
- 2) TAFARSH 1887 ACDB 88-370  
 2.8 acres  
 Danow from R.H. Wood comm. 1885 84-430  
 A.G. Warwick from H.A. Danow 1872 69-357

Property on  
 S. side of the  
 street running from  
 Ridge to the Dow  
 Cemetery.

Danow from John Barksdale 1868 - house  
 opposite E.M. Wolf. 2+

Barksdale from ~~Nerby Danow~~  
 John Mansoni 1855 \$585

Nerby Danow 1855



# HODGES-GLEASON HOUSE

## ARCHITECTURAL DESCRIPTION

This three-bay, single-pile, two-storey house on an English basement is a vernacular interpretation of the high Greek Revival style. Walls are constructed of brick laid in eight-course American-with-Flemish bond. It has a low-pitched hipped roof covered with standing-seam metal with projecting eaves, a boxed cornice, and a plain, deep frieze. There are two interior end chimneys. Windows are double-sash, 6-over-6 light, with architrave trim. Basement and second-storey windows are shorter. The wide one-bay Victorian veranda was probably added around the turn of the century. It has a nearly flat hipped roof covered with standing-seam metal. It has projecting eaves with a boxed cornice, chamfered posts with scroll brackets, and a Colonial Revival balustrade. The entrance in the central bay of the facade has paneled pilasters, 4-light sidelights over panels, a 3-light rectangular transom, and corner lights. Above the entrance, a second-storey window is flanked by paneled pilasters and narrow, sidelight-sized double-sash windows, and all three have paneled spandrels. A series of wooden additions and enclosed porches covers the rear elevation.

1987: The rear additions were replaced in 1985 with a two-storey weatherboarded wing covering the northern two bays.

## HISTORICAL DESCRIPTION

John H. Bibb purchased a 2 1/2-acre lot opposite his home on Ridge Street (Bibb-Wolfe House, 505 Ridge Street) for \$300 in 1852 (ACDB 50-270) and sold it to James M. Hodges in 1859 for \$500 (ACDB 58-340). On the same day, Hodges gave a deed of trust for \$2600 on this "house and lot nearly opposite the residence of E. M. Wolfe" to R. T. W. Duke, trustee for Helen S. Morris (Mrs. Wm. M. Morris) (ACDB 58-337 & 443). Tax records show that the house had been built in 1857. Thus, Hodges apparently built the house before receiving a deed to the lot. The house changed hands several times between 1862 and 1864 before being acquired by John T. Barksdale (ACDB 59-683, 60-285, 61-166). He sold it to Henry A. Darrow in 1868 (ACDB 63-160). James Alexander wrote in 1874 that Darrow's "pretty residence" had been built by Hodges and later owned by Morris. Thomas M. Farish bought the house in 1885 (ACDB 84-430) and sold it in 1887 to James E. Gleason, whose family owned it until 1946 (ACDB 88-370; City 77-388; 129-383). The house has had several owners since then and has been used as rental property, except for the years 1947-49 when it was owned and occupied by James H. Marsh (DB 131-367, 143-102). Ronald Thompson bought it in 1973 (DB 352-60). Walter D. and Barbara J. Pilkey bought the house in 1982 (DB 432- 281) and sold it the next year to the Oakwood Land Trust (DB 439-404), which has rehabilitated it.

Additional References: City DB 217-232, 290-177, 348-270.

## STATEMENT OF SIGNIFICANCE

Built in 1857, the Hodges-Gleason House is an elegant vernacular version of the Greek Revival style. Its front entrance and the tri-partite window arrangement above are nicely detailed, as is the later Colonial Revival verandah. This house is one of the most important in the Ridge Street Historic District, and it has been individually designated as a local historic landmark.

HODGES - GLEASON HOUSE  
510 RIDGE ST.

VDHR FILE NO. 10A-25-21

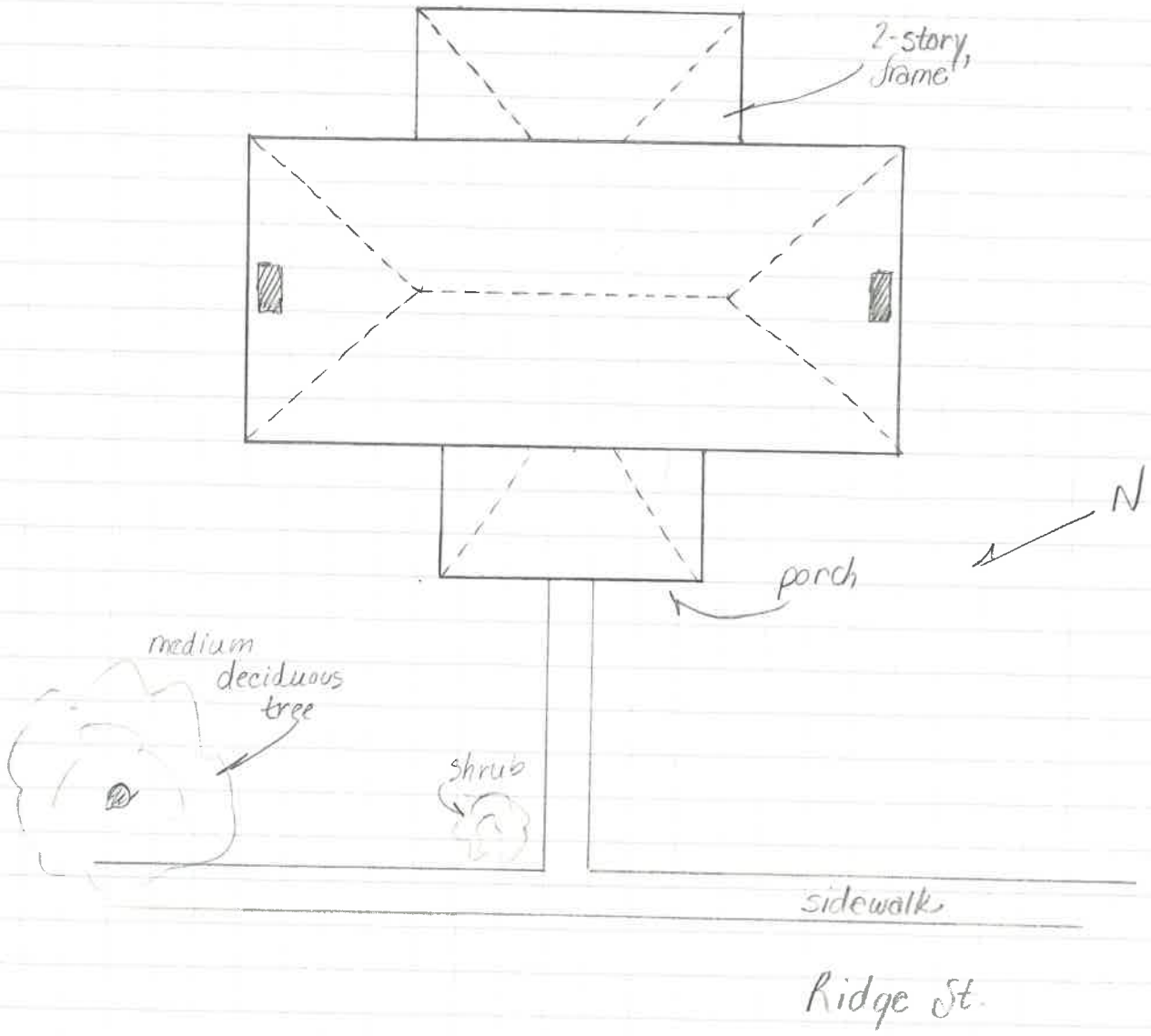

SUSAN E. SMEAD  
PRESERVATION ASSOCIATION OF VIRGINIA

JANUARY 1994

## HODGES-GLEASON HOUSE



<b>STREET ADDRESS:</b>	510 Ridge Street
<b>MAP &amp; PARCEL:</b>	29-275
<b>VDHR FILE NUMBER:</b>	104-25-21
<b>CITY FILE NUMBER:</b>	151
<b>PRESENT ZONING:</b>	R-3
<b>ORIGINAL OWNER:</b>	James M. Hodges
<b>ORIGINAL USE:</b>	Residence
<b>PRESENT USE:</b>	Rental Property (apartments)
<b>PRESENT OWNER:</b>	Carter Orbin F Trustee
<b>ADDRESS:</b>	1108 L. High Charlottesville, VA 22901
<b>ISTORIC NAME:</b>	Hodges-Gleason House
<b>DATE/PERIOD:</b>	1857, c. 1985
<b>STYLE:</b>	Greek Revival
<b>HEIGHT (TO CORNICE) OR STORIES:</b>	2 storeys
<b>DIMENSIONS AND LAND AREA:</b>	115' x 130' (14,950 sq. ft.)
<b>CONDITION:</b>	Good
<b>RECORDS BY:</b>	_____/Bibb
<b>DATE OF SURVEY:</b>	1974, 1987, Revised 1993
<b>SOURCES:</b>	City/County Records Alexander, <u>Recollections of Early Charlottesville</u>

STREET ADDRESS: 510 Ridge Street  
MAP & PARCEL: 29-275  
FILE NUMBER: 151  
PRESENT ZONING: R-3  
ORIGINAL OWNER: James M. Hodges  
ORIGINAL USE: Residence  
PRESENT USE: Rental Property (apartments)  
PRESENT OWNER: Ronald Thompson  
ADDRESS: 1932 Arlington Blvd.  
Charlottesville, VA  
HISTORIC NAME: Hodges-Gleason House  
DATE/PERIOD: 1857, c. 1985  
STYLE: Greek Revival  
HEIGHT (TO CORNICE) OR STORIES: 2 storeys  
DIMENSIONS AND LAND AREA: 115' x 130' (14,950 sq. ft.)  
CONDITION: Poor (1974)/Good (1987)  
SURVEYOR: \_\_\_\_\_/Bibb  
DATE OF SURVEY: 1974 (revised 1980 & 1987)  
SOURCES: City/County Records  
Alexander, Recollections of Early Charlottesville

#### ARCHITECTURAL DESCRIPTION

This three-bay, single-pile, two-storey house on an English basement is a vernacular interpretation of the high style Greek Revival detached town house in the pilastered style. Walls are constructed of brick laid in eight-course American-with-Flemish bond. It has a low-pitched hipped roof covered with standing-seam metal with deeply projecting eaves, a boxed cornice, and a plain, deep frieze. There are interior end chimneys. Windows are double-sash, 6-over-6 light, with architrave trim. Basement and second storey windows are shorter. The wide one-bay Victorian veranda was probably added around the turn of the century. It has a nearly flat hipped roof covered with standing-seam metal. It has projecting eaves with a boxed cornice, chamfered post with scroll brackets, and a Colonial Revival balustrade. The entrance in the central bay of the facade has paneled pilasters, 4-light sidelights over panels, a 3-light rectangular transom, and corner lights. Above the entrance, a second-storey window is flanked by paneled pilasters and narrow, sidelight-sized double-sash windows, and all three have paneled spandrels. A series of wooden additions and enclosed porches covers the rear elevation.

1987: The rear additions were replaced in 1985 with a two-storey weatherboarded wing covering the northern two bays.

#### HISTORICAL DESCRIPTION

John H. Bibb purchased a 2 1/2-acre lot opposite his home on Ridge Street (Bibb-Wolfe House, 505 Ridge Street) for \$300 in 1852 (ACDB 50-270) and sold it to James M. Hodges in 1859 for \$500 (ACDB 58-340). On the same day, Hodges gave a deed of trust for \$2600 on this "house and lot nearly opposite the residence of E. M. Wolfe" to R. T. W. Duke, trustee for Helen S. Morris (Mrs. Wm. M. Morris) (ACDB 58-337 & 443). Tax records show that the house had been built in 1857. Thus, Hodges apparently built the house before receiving a deed to the lot. The house changed hands several times between 1862 and 1864 before being acquired by John T. Barksdale (ACDB 59-683, 60-285, 61-166). He sold it to Henry A. Darrow in 1868 (ACDB 63-160). James Alexander wrote in 1874 that

Darrow's "pretty residence" had been built by Hodges and later owned by Morris. Thomas M. Farish bought the house in 1885 (ACDB 84-430) and sold it in 1887 to James E. Gleason, whose family owned it until 1946 (ACDB 88-370; City 77-388; 129-383). The house has had several owners since then and has been used as rental property, except for the years 1947-49 when it was owned and occupied by James H. Marsh (DB 131-367, 143-102). Ronald Thompson bought it in 1973 (DB 352-60).

Additional References: City DB 217-232, 290-177, 348-270.

The house was purchased by The Oakwood Land Trust in 1983 (DB 432-281, 439-404) and rehabilitated c. 1985.

510 Ridge Street



## 510 Ridge

1862	Wm M. Morris of Miss.	2 ac $\frac{1}{4}$ in 5	+ 2200 = 2450
1861	" " De	" "	" "
1859	John H. Bibb Hodges and	" "	+ 2000 = 2250
1856	John H. Bibb	2 ac $\frac{1}{2}$ in (A Card)	+ 0 = <del>1100</del> 1100
1857	" "	" $\frac{1}{4}$ in 5	" = 250
1858	" "	" " "	+ 2000 = 2250 \$2000 added for imp.

- John H. Bibb sold 505 Ridge property, 1852, so this is all re: 510 Ridge
- built 1857 by John H. Bibb +/or James M. Hodges
- Barksdale owned 1864-1868; 4 yr, doesn't qualify for name



63-162 <sup>2000 N</sup> Henry A. Dawson → John T. Barksdale  
5/1868 lot he bought for Barksdale  
"a certain house & lot... opp Wolfe"

66-420 / 1871 H A Dawson → A C Brackin  
69-181 / 1874 " "

70-174 1876 J T Barksdale → Henry Balg

57-409 1859 Wm M. Moravia → H A Dawson

49-165+169 Peterson → Wm Hodges → Bailey

70-174 John T. Barksdale → Henry Balg 4500  
6/1873 2 side Ridge opp Dr RB Dice's residence, 3/4 acre <sup>∴ 300 block gone now.</sup>  
same bought for Martin & Kellogg probably 300 or 302  
Bounded by: 108' Ridge, Wm S Brown 270, vacant  
(north of Brown lot) probably 302 or 306

66-420 H A Dawson → A C Brackin 510?  
7/1871 lot on Ridge, part of tract upon which Dawson's residence is located  
still 2 deeds of tract to be settled probably 500 or 506  
N corner of tract for Barksdale



Early Ch'ville

Landmarks

"opp Bibb-Wolfe house"

Deeds

Landmarks

John H. Bibb

John Wimmer

Robert Battle  
1852 ↓ 50-270 \$300

William Hodges (built)

John T. Barbadale (built)

John H. Bibb  
1859 ↓ 58-340 \$500  
James M. Hodges

William Menden

189  
A. W. Womack  
1864 ↓  
John T. Barbadale house

William Dawson

1855 ↓ 54-250  
1868 ↓  
1884 ↓ ~~58-337~~ ~~58-337~~  
J. E. Gleason

1885 ↓ 84-430  
Farish (Warwick)  
1887 ↓ 88-370  
J. E. Gleason

3

58-337 James M & Susan F Hodges → RTW Duke & Wm M & Helen S Moore

12/29/1859 \$2600 for 27000 to Hodges

deed of ~~trust~~ to Duke as trustee for Helen S Moore & her house & lot nearly opposite residence of E M Wolfe on Ridge St 2 or 1 wood 35 poles

54-250 John Mannoni → John T. Barksdale \$5-85  
11/1855 tract of 4 1/2 acres ~~for~~ bought for Barrett 1854

61-166 (9) AJ + Mary R Warwick → John T. Barksdale \$20,000  
3/22/1864 lot near town boundary

same as 7/10/1863 Wm R Coghill + James Ferguson → Warwick  
DB 60-285

"house + lot nearly opp residence of E M Wolfe on Ridge St"  
2 or 1 road 35 p

60-285 (8) Wm R + RE Coghill, + James + Sarah Ferguson → AJ Warwick \$6,650  
7/10/1863 same as 3/5/63 for Bailey

" " 2/27/1863 "

" " 1862 Wm Wm Mannoni by RTW Duke

"house + lot nearly opp res of E M Wolfe on Ridge St . . ."

59-683 (4) RTW Duke, trustee for Helen L Mannoni + chng under deed  
8/27/1863 of trust for James M. Hodges to her 12/1857  
Wm M Mannoni of 2nd part  
Chas E Bailey of 3rd part  
\$3000 → Mannoni

"house + lot nearly opp res of E M Wolfe on Ridge St . . ."

443 (3) James M + Susan F Hodges → RTW Duke →  
58-337 Wm M. + Helen S Mannoni

12/29/1859 "house + lot nearly opp . . ."

510 Ridge

11/15/66

11/9/1932 (21) James E. Bleason est -> Annie E. Bleason

dec 4/15/30 interstate

10 acres on east side Ridge St of dwelling houses

same as 1) A & D B 84-219, 1884, 4.8 ac for J A Kemmer

2) " 88-370, 1887, 2.8 ac. T M Farish et al

J E - H M Bleason alley 20-285

4003  
63-162 H

5/1868

63-160 (10) John T Bocksdale -> Henry A. Darrow \$3500

5/7/1868 land purchased for A J & Mary Warwick 3/1864

house & lot nearly opposite residence of E. M. Wolfe, 2 acres

88-370 (20) Thos M. Farish, & A J & M R Warwick -> James E. Bleason

9/19/1887 tract of bldgs, 2.8 ac

same as 84-430

84-430 (19) Darrow's land cont

2/1885 -> Thos M. Farish

2.8 ac

58-340 (2) John H. Bibb -> James M. Hodges \$500

12/29/1859 "lot on Ridge St" owned in front of E M Wolfe's residence

& containing 2 <sup>15</sup>/<sub>32</sub> acres"

same recently purchased for Robert Battles

50-270 (1) Robert & Mary Battles -> John H. Bibb \$300

2/1852 opp residence of John H. Bibb

adj Berry Nunn

same bought for Barrett 1847

2 ac 1 rood 35 poles



570 Ridge

353-60 Don E & Esther C Burch → Ronald H & <sup>Bobbie</sup> ~~Bobbie~~ Jean Thompson  
1973

348-370 Frank H & Alice M Brown → Burch  
1973

290-177 Lydia B & Adolphus Hailstock → Brown  
1967

217-232 Nick C & Tullan N Sabellaridis → Hailstock  
1959 lots 3, 4, 5, & 6 on plat 129-384

143-102 R. H. Marsh, wid → Sabellaridis  
1949

~~230~~ 131-367 Harvey A Jr & Josephine C George → R.H. & Lottie W Marsh  
1947

129-383 Cary L May & Per N B, exec of Annie E Gleason → George  
1946

# Survey

#151

## Identification

STREET ADDRESS: 510 Ridge Street  
MAP & PARCEL: 29-275  
CENSUS TRACT AND BLOCK: 4-341  
PRESENT ZONING: R-3  
ORIGINAL OWNER: James M. Hodges  
ORIGINAL USE: Residence  
PRESENT USE: Rental Property (apartments)  
PRESENT OWNER: Ronald Thompson  
ADDRESS: 1932 Arlington Blvd.  
Charlottesville, VA

HISTORIC NAME: Hodges-Gleason House  
DATE / PERIOD: 1857, ~~1857~~ c. 1985  
STYLE: Greek Revival  
HEIGHT (to cornice) OR STORIES: 2 Storeys  
DIMENSIONS AND LAND AREA: 115' x 130' (14,950 sq. ft.)  
CONDITION: Poor  
SURVEYOR: /Bibb  
DATE OF SURVEY: 1974 (revised 1980) ~~1980~~  
SOURCES: City/County Records  
Alexander, Recollections of Early Ch'ville

## ARCHITECTURAL DESCRIPTION

~~This structure is a middle class interpretation of the larger high style town houses found at the Hughes House (Market Street) or the Abell-Gleason House (521 North First Street). As with the above mansions, the Hodges-Gleason House is decorated with pilasters applied to a two storey, three bay brick building. The scale of the house, which is only one room deep, is domestic rather than grand. The entrance porch is an example of later Victorian design and was undoubtedly added after the Civil War.~~

## HISTORICAL DESCRIPTION

John H. Bibb purchased a 2½-acre lot opposite his home <sup>on</sup> of Ridge Street (Bibb-Wolfe House, 505 Ridge Street) for \$300 in 1852 (ACDB 50-270) and sold it to James M. Hodges in 1859 for \$500 (ACDB 58-340). On the same day, Hodges gave a deed of trust for \$2600 on this "house and lot nearly opposite the residence of E. M. Wolfe" to R. T. W. Duke, trustee for Helen S. Morris (Mrs. Wm. M. Morris) (ACDB 58-337 & 443). Tax records show that the house had been built in 1857. Thus, Hodges apparently built the house before receiving a deed to the lot. The house changed hands several times between 1862 and 1864 before being acquired by John T. Barksdale (ACDB 59-683, 60-285, 61-166). He sold it to Henry A. Darrow in 1868 (ACDB 63-160). James Alexander wrote in 1874 that Darrow's "pretty residence" had been built by Hodges and later owned by Morris. Thomas M. Farish bought the house in 1885 (ACDB 84-430) and sold it in 1887 to James E. Gleason, whose family owned it until 1946 (ACDB 88-370; City DB 77-388; 129-383). The house has had several owners since then and has been used as rental property, except for the years 1947-49 when it was owned and occupied by W. H. Marsh (DB 131-367, 143-102). Ronald Thompson bought it in 1973 (DB 352-60).

Additional References: City DB 217-232, 290-177, 348-270.

*(new paragraph)*

*The house was purchased by The Tabwood Land Trust in 1983 (DB 432-281, 439-404) & rehabilitated c. 1985*

510 Ridge

Arch Description

This 3-bay, ~~Double~~ single-pile, 2-storey house on an ~~English~~ English basement is a vernacular interpretation of the high style Greek Revival detached town house in the pilastered style. Walls are constructed of brick laid in 8-course American-with-Flemish bond.

It has a low-pitched hipped roof covered with standing-seam metal with deeply projecting eaves, a boxed cornice, & a plain, deep frieze. There are interior <sup>end chimneys</sup>. Windows are double-sash, 6-over-6 light, with architrave trim. Basement & second storey windows are shorter.

The entrance

The entrance in the center bay of the facade has paneled pilasters, 4-light sidelights over panels, a 3-light rectangular transom, & corner lights.

Above the entrance, a second-storey window is flanked by <sup>paneled pilasters &</sup> narrow, sidelight-sized double-sash windows, & all three have paneled spandrels.

A series of wooden additions & enclosed porches cover the rear elevation.

The wide one-bay <sup>Victorian</sup> ~~entrance~~ veranda was probably added around the turn of the century.

It has a nearly flat hipped roof covered with standing-seam metal. It has projecting eaves with a boxed cornice, chamfered posts with scroll brackets, & a Colonial Revival balustrade.



1987: The rear additions were replaced ~~with~~ in 1985-  
with a 2-storey weatherboarded wing covering the  
northern two bays.

210 1985

510 Ridge

2-5, 3-bay, single pile  
pilastered

Eng base (brick above cor) w/ front retaining wall for full  
water table; 5-c am-w/ - Flem

low 55m hie w/ <sup>deeply</sup> proj eaves, boxed cor, sl deep <sup>fringe</sup>

6/6, shorter 2nd <sup>4 base</sup> wch., base.

12/3 panels, pilasters w/ ~~at~~ panels bet doors <sup>4-l</sup>  
w/ sidelights/ panels, 3-l rest transom, corner lights

wide 1-5 1-bay porch  
nearly flat ~~low pitched~~ hie roof (metal)  
proj eaves, boxed cor, a frieze, wch  
chamfered posts w/ seal brackets  
Cal Rev bal

2-5 weatherboarded rear wing (2 N bays)  
prob replace incl patches

base. extends under <sup>front</sup> porch w/ 5 ent

3 apt

over sat; window flanked by narrow double-sash  
wind matching sidelights, panels under all 3  
paneled pilasters without capitals bet.

int end chim





Date JAN 1994 File No. 104-25-21  
Name HOPBES - GLEASON HOUSE, 510 RIDGE ST.  
Town CHARLOTTESVILLE,  
County \_\_\_\_\_  
Photographer ANN C. HUPPERT  
Contents 3 EXT. VIEWS

No. 510 RIDGE STREET  
Name BARKSDALE HOUSE  
Order 107  
Remarks \_\_\_\_\_  
Retouched \_\_\_\_\_  
Order Finished Aug. 1974  
Reorder \_\_\_\_\_

510 Ridge

348-270	Don E + Esther C <sup>Burch</sup> <del>Burch</del>	1973	plat 129-384
352-60	Ronald H + Bobbe Jean Thompson	"	"
432-287	Walter D. + Barbara F. Pelkey	1982	"
439-404	Oakwood Land Trust	1983	gift
"	"	"	"

