

WINSTON HOUSE



STREET ADDRESS:	516 Ridge Street
MAP & PARCEL:	29-273
VDHR FILE NUMBER:	104-25-25
CITY FILE NUMBER:	675
PRESENT ZONING:	R-3
ORIGINAL OWNER:	Verner R. and Elizabeth L. Winston
ORIGINAL USE:	Residence
PRESENT USE:	Rental Property (Residence)
PRESENT OWNER:	Josephine Reynolds and J. Garland Reynolds
ADDRESS:	1305 Florida Avenue NW Washington, D.C. 20009
HISTORIC NAME:	Winston House
DATE/PERIOD:	1959
STYLE:	Modern Minimal Traditional
HEIGHT IN STORIES:	one story
DIMENSIONS AND LAND AREA:	68' ave. x 180' ave. (15,170 sq. ft.)
CONDITION:	Excellent
SURVEYOR:	Bibb/Pres. Assoc. of VA (Smcad)
DATE OF SURVEY:	1993
SOURCES:	City Records Charlottesville City Directories

WINSTON HOUSE

ARCHITECTURAL DESCRIPTION

This one-story, four-bay, brick house, laid in running bond, exhibits the low profile of the Ranch-style, with reference to historically-derived elements. The house has an L-shaped plan with a composite-shingled roof that has intersecting gables, created by the juncture of a front-gabled section, projecting from the northeast side of the front facade, with the house's main block. A one-story, one-bay front porch, with a metal support at the corner and a metal railing, is located in the "L". The windows are horizontally-divided two-over-two double-hung wood sash, and there is a three-part window, formed from a picture window flanked by narrow horizontally-divided two-over-two sash, in the southwest end bay of the front facade. The roof edge has a minimal boxed cornice, the gables have narrow bargeboards, and there is a brick exterior end chimney. The windows have inoperable blinds. The house stands on a small sloped lot, fronted with a brick wall, and edged at the sides and rear with hurricane fencing.

HISTORICAL DESCRIPTION

Verner R. and Elizabeth L. Winston purchased this lot, formerly the side yard of the Burgess-Hawkins House at 518 Ridge Street, in 1958 (City DB 208-495, 215-309). Tax records show that they built the house the following year. A brick wall was added along the front of the lot in 1961, and the back porch was enlarged and enclosed in 1964. The house has remained in Mrs. Winston's family, passing first to her sister (WB 10-222) and then to two nieces (WB 21-99).

STATEMENT OF SIGNIFICANCE

The Winston House is significant as an example of a Modern Minimal Traditional house, but in scale and form it is not compatible with the earlier houses in the Historic District, and due to its date of construction it is a non-contributing resource.

WINSTON HOUSE
516 RIDGE ST.

VDHR FILE NO. 104-25-25

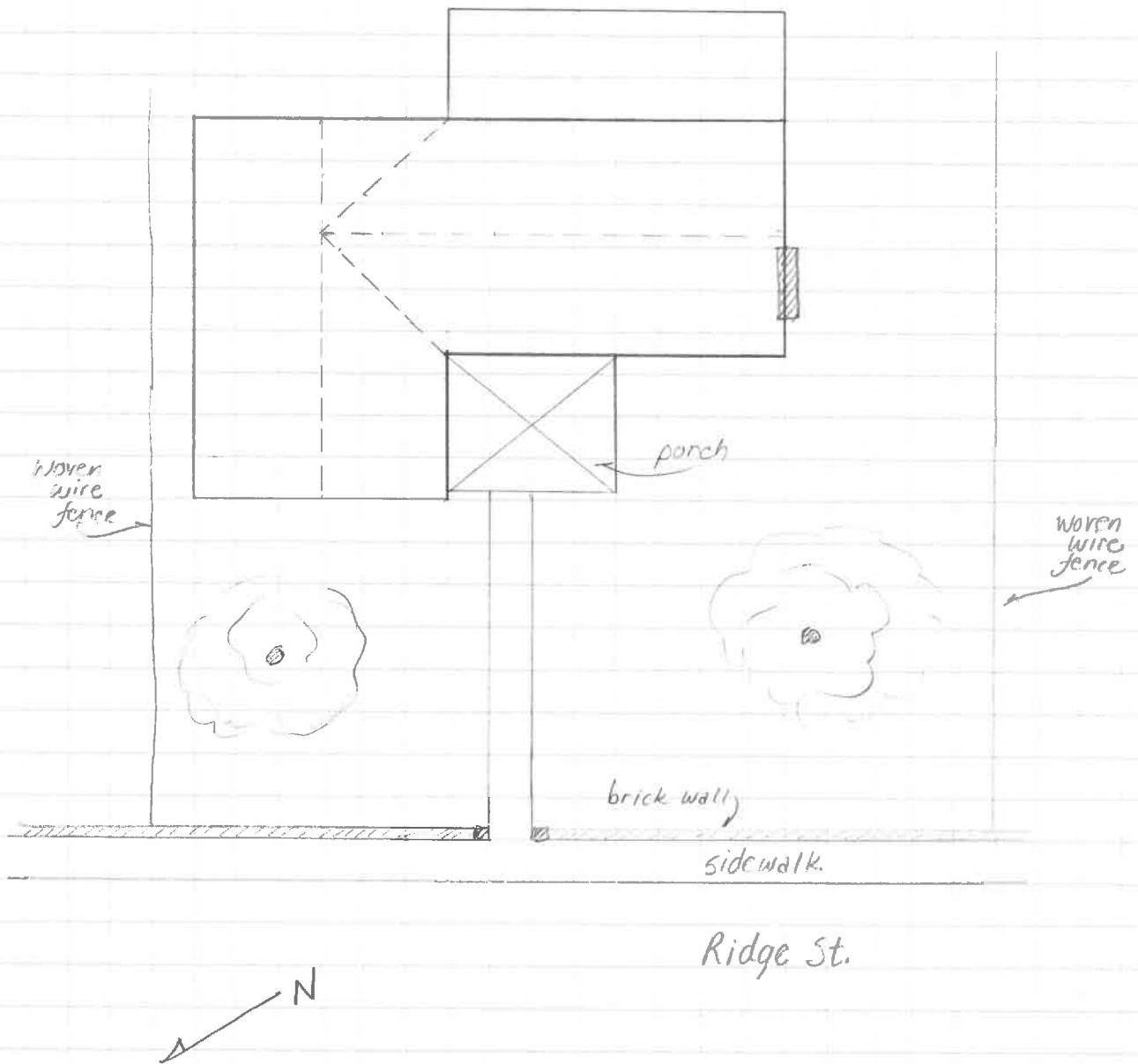

SUSAN E. SMEAD
PRESERVATION ASSOCIATES
OF VIRGINIA

JANUARY 1994

VDHR Reconnaissance Survey Form

VIRGINIA DEPARTMENT OF HISTORIC RESOURCES
 PROPERTY SURVEY FORM
 RECONNAISSANCE LEVEL

IDENTIFICATION INFORMATION

VDHR File # 104-0025-025

Property Name:
 Historic/Current Winston House

NR Property Category: Building
 Wuzit: House

Tax Code: Section Parcel
 =====
 .29 273

County/City: Charlottesville (City)

USGS Map: USGS Quad: Charlottesville East

ADDRESS/LOCATION INFORMATION

Address: 516 Ridge Street

Location:

Vicinity of: Municipality: ZIP: 22901

PROPERTY CLASSIFICATION INFORMATION

Property Boundaries:
 Ownership: Private

RESOURCE COUNT -

#	Category	Contributing?	TOTAL:	
1	Building	Non-contributing	1	
			Contrib:	0
			Non-Contrib:	1

WUZIT COUNT -

#	Wuzit	Contributing?	TOTAL:	
1	House	Non-contributing	1	
			Contrib:	0
			Non-Contrib:	1

RESOURCE - GENERAL DESCRIPTIVE INFORMATION
 =====

Resource Level:
 Estimated Construction Date: 1959
 Source of Date: Tax Records
 Physical Status: Existing
 Condition: Excellent
 Threat: None Known
 Degree of Historic Integrity:
 Association:
 Design:
 Feeling:
 Location:
 Materials:
 Setting:
 Workmanship:

PRIMARY RESOURCE RECONNAISSANCE DESCRIPTION
 =====

Architectural Style/Derivative: Modern Minimal Traditional

of Stories: 1.0 # of Bays Wide: 4 # of Bays Deep: 3
 Arch Config: Geo Config:
 Footprint:

Component	#	Form/Treatment	Material	Matr'l Treatment
Chimneys		Exterior end	Brick	
Foundation			Brick	
Porch		Front	Wood/metal	
Roof		Intersect. gables	Asphalt	Shingles
Windows		sash	Wood	horizontal 2/2

Brief Architectural Description of Primary Resource:

This one-story, four-bay, brick house, laid in running bond, is in the Modern Minimal Traditional Style, exhibiting the low profile of the Ranch Style, with reference to historically-derived elements. The house has an L-shaped plan with a composite-shingled roof that has intersecting gables, created by the juncture of a front-gabled section, projecting from the northeast side of the front facade, with the house's main block. A one-story, one-bay front porch, with a metal support at the corner and a metal railing, is located in the "L". The windows are horizontally-divided two-over-two double-hung wood sash, and there is a three-part window, formed from a picture window flanked by narrow horizontally-divided two-over-two sash, in the southwest end bay of the front facade. The roof edge has a minimal boxed cornice, the gables have narrow bargeboards, and there is a brick exterior end chimney. The windows have inoperable blinds. The house stands on a small sloped lot, fronted with a brick wall, and edged at the sides and rear with hurricane fencing.

Brief Architectural Description of Additions and Alterations
Back porch enlarged and enclosed, 1964; brick wall added
along front of lot, 1961.

Brief Architectural Description of Secondary Resources:

Potentially Contributes to Historic District:

Ridge Street Historic District

Potentially Associated with NR Multiple Property:

Architectural and Historical Summary:

Verner R. and Elizabeth L. Winston purchased this lot, formerly the side yard of the Burgess-Hawkins House at 518 Ridge Street, in 1958 (City DB 208-495, 215-309). Tax records show that they built the house the following year. A brick wall was added along the front of the lot in 1961, and the back porch was enlarged and enclosed in 1964. The house has remained in Mrs. Winston's family, passing first to her sister (WB 10-222) and then to two nieces (WB 21-99). The Winston House is significant as an example of a Modern Minimal Traditional house, but in scale and form it is not compatible with the earlier houses in the Historic District, and due to its date of construction it is a non-contributing resource.

BIBLIOGRAPHY

=====

Type of Record	Citation
----------------	----------

City Records

Charlottesville City Deed Books and Will Books

City Directory

Charlottesville City Directory

PHOTOGRAPHIC/DRAWINGS DOCUMENTATION

=====

MISSING DATA ELEMENT

Media	VDHR Neg #	Frames	Date
B&W 35mm photos	13467	28 - 29	11/26/1993

CRM MANAGEMENT EVENTS

=====

MISSING DATA ELEMENT

CRM Event

Agency/Organization

Date

Reconnaissance Survey

Smead, Susan and Bibb, Eugenia

11/26/1993



Date 11/26/93 File No. 104-25-25

Name Winston House, 516 Ridge Street

Town City of Charlottesville

County _____

Photographer Susan E. Smead

Contents 2 exteriors
