

## HARRIS-CARTER HOUSE



<b>STREET ADDRESS:</b>	712 Ridge Street
<b>MAP &amp; PARCEL:</b>	25-67
<b>VDHR FILE NUMBER:</b>	104-25-47
<b>CITY FILE NUMBER:</b>	689
<b>PRESENT ZONING:</b>	R-3
<b>ORIGINAL OWNER:</b>	H. G. Clark
<b>ORIGINAL USE:</b>	Residence
<b>PRESENT USE:</b>	Rental Property (Residence)
<b>PRESENT OWNER:</b>	Maryetta B. Harris
<b>ADDRESS:</b>	206 Fifth Street SW Charlottesville, VA
<b>HISTORIC NAME:</b>	Harris-Carter House
<b>DATE/PERIOD:</b>	1922
<b>STYLE:</b>	Four Square
<b>HEIGHT IN STORIES:</b>	two stories
<b>DIMENSIONS AND LAND AREA:</b>	67' x 162' (10,854 sq. ft.)
<b>CONDITION:</b>	Good
<b>SURVEYOR:</b>	Bibb/Pres. Assoc. of VA (Smead)
<b>DATE OF SURVEY:</b>	1993
<b>SOURCES:</b>	City/County Records Alexander, <u>Recollections of Early Charlottesville</u> Sanborn Map Co. - 1920, 1929 Charlottesville City Directories

# HARRIS-CARTER HOUSE

## ARCHITECTURAL DESCRIPTION

This 2-story, 3-bay, large frame four-square has subtle Prairie-style elements. It has a low hipped roof, clad with standing-seam metal, with deep eaves. There is a wide front dormer that also has a low hipped roof and deep eaves. Across the front facade is a three-bay, one-story porch with a low hipped roof, and large square stuccoed piers with simple caps. The centrally-placed entrance has a transom. The windows are four-over-one, eight-over-one, and one-over-one double-hung wood sash. To each side of the entrance are three-part windows consisting of eight-over-one double-hung sash flanked by four-over-one double-hung sash units, and there is a small paired window with two one-over-one double-hung sash units in the second floor over the entrance. A three-part window with one-over-one double-hung sash is in the dormer. There are three brick interior chimneys, with one that is larger than the others inside the northeast wall. The house has had its stucco walls covered with aluminum siding, and its foundation walls have been plastered over. It stands on an elevated lot fronted by a concrete retaining wall, and the yard contains pine trees and evergreen shrubs.

## HISTORICAL DESCRIPTION

This lot was a part of the old Albemarle Military Institute. A four-story building known as "the Flagg House", which was probably demolished c. 1913, stood in this vicinity. The steps leading up from the sidewalk south of the present house may have been associated with it. Barksdale Street was named for the Barksdale family who owned the Flagg House from 1879 to 1913 (ACDB 75-163; City DB 24-452). H. G. Clark purchased this lot in two sections in 1921 and 1922 (City DB 37-103 and 294). He built this house in 1922, according to tax records, and sold it the same year to Freda Kobre (DB 42-163). The Kobre family operated the Victory Shoe Store. They sold the house in 1925 (DB 50-464), but bought it back in 1943 (DB 114-393). James and Irma B. Carter bought the house from Tillie Kobre Miller in 1957 (WB 7-26; DB 114-393, 198-101). They covered the stuccoed walls with aluminum siding and enclosed the back porch in 1964. Maryetta B. Harris bought the house from their heirs in 1987 and uses it as rental property (WB 27-7, 29-752; DB 490-35, 515-263). Additional References: City DB 52-105, 90-263, 114-310.

## STATEMENT OF SIGNIFICANCE

The Harris-Carter House is significant as an example of a large, well-built four-square with characteristics of the Prairie style. Its integrity has been somewhat compromised by the aluminum siding that covers the stucco walls, but the house retains its other important original features, and in scale and style it is compatible with the other contributing residences in the Ridge Street Historic District.

HARRIS-CARTER HOUSE  
712 RIDGE ST.

VDHR FILE NO. 104-25-47

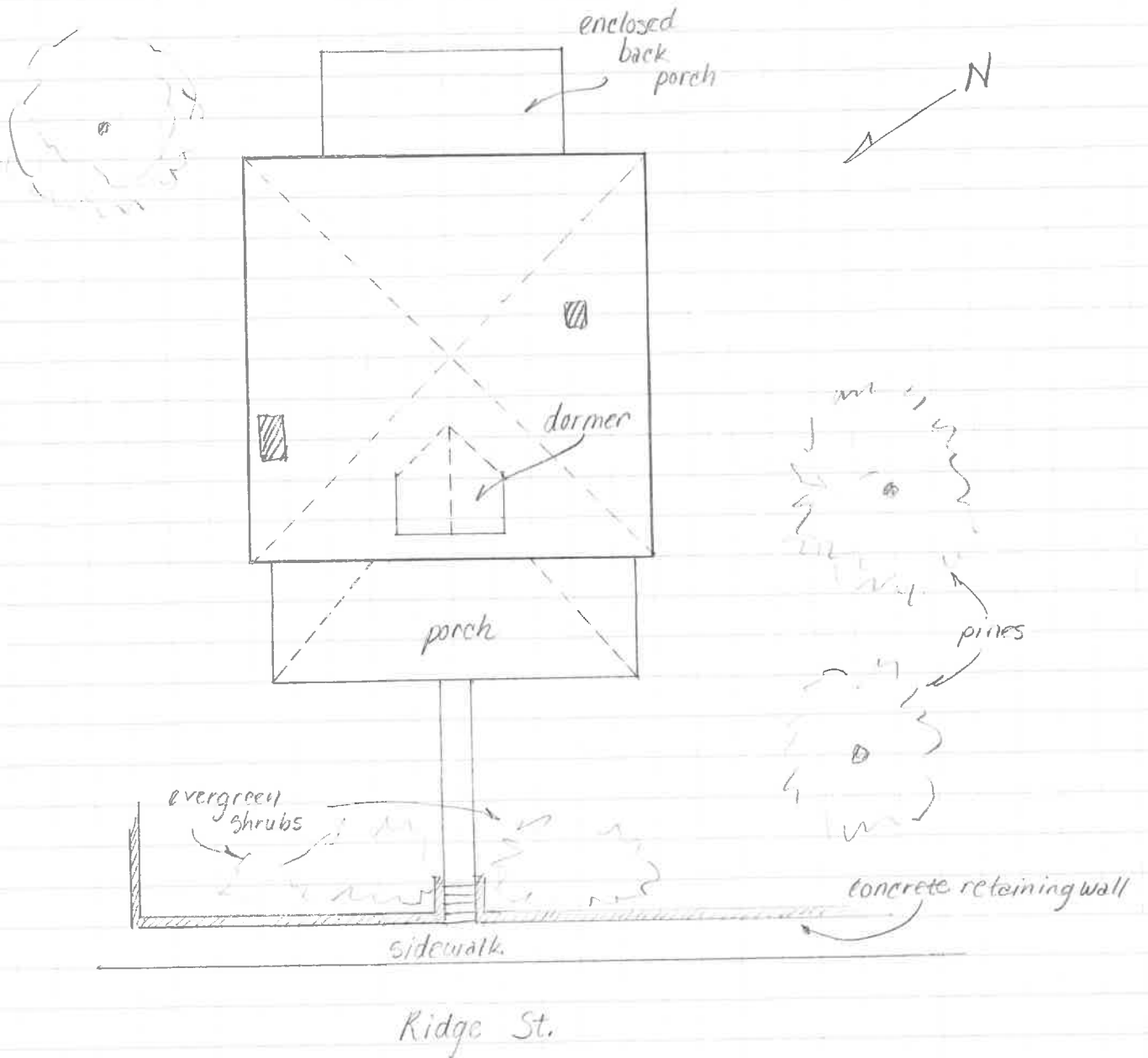

SUSAN E. SMEAD  
PRESERVATION ASSOCIATES  
OF VIRGINIA

JANUARY 1994

VDHR Reconnaissance Survey Form

VIRGINIA DEPARTMENT OF HISTORIC RESOURCES  
PROPERTY SURVEY FORM  
RECONNAISSANCE LEVEL

IDENTIFICATION INFORMATION

VDHR File # 104-0025-047

Property Name:  
Historic/Current                      Harris-Carter House

NR Property Category: Building  
Wuzit: House

Tax Code:    Section    Parcel  
=====

25      67

County/City: Charlottesville (City)

USGS Map:                              USGS Quad: Charlottesville East

ADDRESS/LOCATION INFORMATION

Address: 712                              Ridge Street

Location:

Vicinity of:              Municipality:    ZIP: 22901

PROPERTY CLASSIFICATION INFORMATION

Property Boundaries:  
Ownership: Private

RESOURCE COUNT -

#	Category	Contributing?	
1	Building	Contributing	TOTAL: 1
			Contrib: 1
			Non-Contrib: 0

WUZIT COUNT -

#	Wuzit	Contributing?	
1	House	Contributing	TOTAL: 1
			Contrib: 1
			Non-Contrib: 0

RESOURCE - GENERAL DESCRIPTIVE INFORMATION

=====

Resource Level:
Estimated Construction Date: 1922
Source of Date: Tax Records
Physical Status: Existing
Condition: Good
Threat: None Known
Degree of Historic Integrity:
Association:
Design:
Feeling:
Location:
Materials:
Setting:
Workmanship:

PRIMARY RESOURCE RECONNAISSANCE DESCRIPTION

=====

Architectural Style/Derivative: Four Square
# of Stories: 2.0 # of Bays Wide: 3 # of Bays Deep: 3
Arch Config: Geo Config:
Footprint:

Table with 5 columns: Component, #, Form/Treatment, Material, Matr'l Treatment. Rows include Chimneys, Dormers, Foundation, Porch, Roof, and Windows.

Brief Architectural Description of Primary Resource:
This two-story, three-bay, large frame Four Square has subtle Prairie-Style elements. It has a low hipped roof, clad with standing seam metal, with deep eaves. There is a wide front dormer that also has a low hipped roof and deep eaves. Across the front facade is a three-bay, one-story porch with a low hipped roof, and large square stuccoed piers with simple caps. The centrally-placed entrance has a transom. The windows are four-over-one, eight-over-one, and one-over-one double-hung wood sash. To each side of the entrance are three-part windows consisting of eight-over-one double-hung sash flanked by four-over-one double hung sash units, and there is a small paired window with two one-over-one double-hung sash units in the second floor over the entrance. A three-part window with one-over-one double-hung sash is in the dormer. There are three brick interior chimneys, with one that is larger than the others inside the northeast wall. The house has had its stucco walls covered with aluminum siding, and its foundation walls

have been plastered over. It stands on an elevated lot fronted by a concrete retaining wall, and the yard contains pine trees and evergreen shrubs.

Brief Architectural Description of Additions and Alterations  
The stucco walls were covered with aluminum siding and the back porch was enclosed in 1964.

Brief Architectural Description of Secondary Resources:

Potentially Contributes to Historic District:

Ridge Street Historic District

Potentially Associated with NR Multiple Property:

Architectural and Historical Summary:

This lot was a part of the old Albemarle Military Institute.

A four-story building known as "the Flagg House", which was probably demolished c. 1913, stood in this vicinity. The steps leading up from the sidewalk south of the present house may have been associated with it. Barksdale Street was named for the Barksdale family who owned the Flagg House from 1879 to 1913 (ACDB 75-163; City DB 24-452). H. G. Clark purchased this lot in two sections in 1921 and 1922 (City DB 37-103 and 294). He built this house in 1922, according to tax records, and sold it the same year to Freda Kobre (DB 42-163). The Kobre family operated the Victory Shoe Store. They sold the house in 1925 (DB 50-464), but bought it back in 1943 (DB 114-393). James and Irma B. Carter bought the house from Tillie Kobre Miller in 1957 (WB 7-26; DB 114-393, 198-101). They covered the stuccoed walls with aluminum siding and enclosed the back porch in 1964.

Maryetta B. Harris bought the house from their heirs in 1987 and uses it as rental property (WB 27-7, 29-752; DB 490-35, 515-263). Additional References: City DB 52-105, 90-263, 114-310. The Harris-Carter House is significant as an example of a large, well-built Four Square with characteristics of the Prairie Style. Its integrity has been somewhat compromised by the aluminum siding that covers the stucco walls, but the house retains its other important original features, and in scale and style it is compatible with the other contributing residences in the Ridge Street Historic District.

## BIBLIOGRAPHY

=====

Type of Record                      Citation

-----

City Records

Charlottesville City Deed Books and Will Books

County Records

Albemarle County Deed Books

Book

Alexander, Recollections of Early Charlottesville

Map  
Sanborn Map Company

City Directory  
Charlottesville City Directory

PHOTOGRAPHIC/DRAWINGS DOCUMENTATION

=====

MISSING DATA ELEMENT

Media	VDHR Neg #	Frames	Date
B&W 35mm photos	13466	30 - 32	11/23/1993

CRM MANAGEMENT EVENTS

=====

MISSING DATA ELEMENT

CRM Event	Agency/Organization	Date
Reconnaissance Survey	Smead, Susan and Bibb, Eugenia	11/23/1993

5-67 ✓

#689 R-3  
67x162

712 Ridge St  
5th St SW

75-265	Maryetta B. Harris	1988	conversion
190-35	" "	1987	
1B 29-252	Robert L. Carter	1986	
1B 27-7	James L "	1983	
198-101 } 114-393 }	James & Irma B "	1957	
1B 7-26	Tillie Miller		
	Isaac Kobee		

162  
767  

---

1134  
972  

---

10854

2-5, 1/2 B, 1-fam, 8 rooms  
brick found, alum. over stairs, metal steps  
are const  
1964 - alum siding + encl rear porch

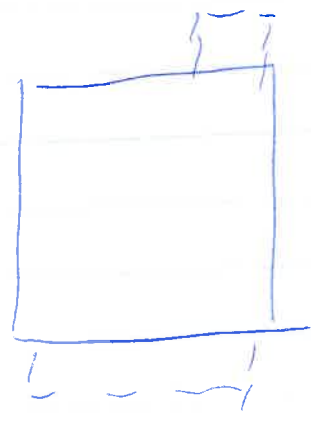



City Dir

1953 Bernard + Tillie Miller (Victory Shoe Store)  
2 apt

1962, 190<sup>285</sup> James L Carter

712 Ridge

14-393 Shen. Life Ins Co, Inc -> Freda & Isaac Kobre \$5,800  
1/16/1943 712 Ridge St  
same

14-310 Bertha & Felix Lepchitz -> Shen Life Ins Co \$5,500  
1/14/1943 712 Ridge St  
same as 90-263

10-263  
1/28/1936 M M & Ida D Henson -> Bertha Lepchitz  
69' lot on E side Ridge, w/ imp't  
same as 52-105

12-105 Ida Dora Henson -> her husband, M M Henson  
1/10/1925 69' lot  
same as 50-464

10-464 Freda & I. Kobre -> Ida Dora Henson gift  
1/22/1935 69' lot on E side Ridge St  
same as 42-163, fr HB Clark 1922  
Henson to assume loan (DB 47-236, 1924)

12-163 HB & Lucille Owen Clarke -> Freda Kobre (non Isaac Kobre) \$9,650  
1/1/1922 69' lot on E side Ridge St

72' S of - the old Flagg property, now owned by  
B E Wheeler  
north of HB Sparks -> IF Jones 1920 (35-263)

consists of 2 lots:

a) 37-103, fr J Emmett Cleason, 1920

b) 37-294, fr 2 F & Lucy F Jones, 1921

1923, 24, 25	Freda Kobre	712 Ridge	$600 + 3600 = 4200$	for Clarke
1926	"	"	"	"
1926	H M Henson	"	$1100 + " = 4700$	for Kobre
1921	H & Clark	52 x 14 E side Ridge	$500 + 0 = 500$	for Emmett Bleason Bld added
1922	H E "	60 x 270 " "	$600 + 3600 = 4200$	for R F Jones

HARRIS-CARTER HOUSE  
712 RIDGE ST.

ORDER NO. 104-25-47

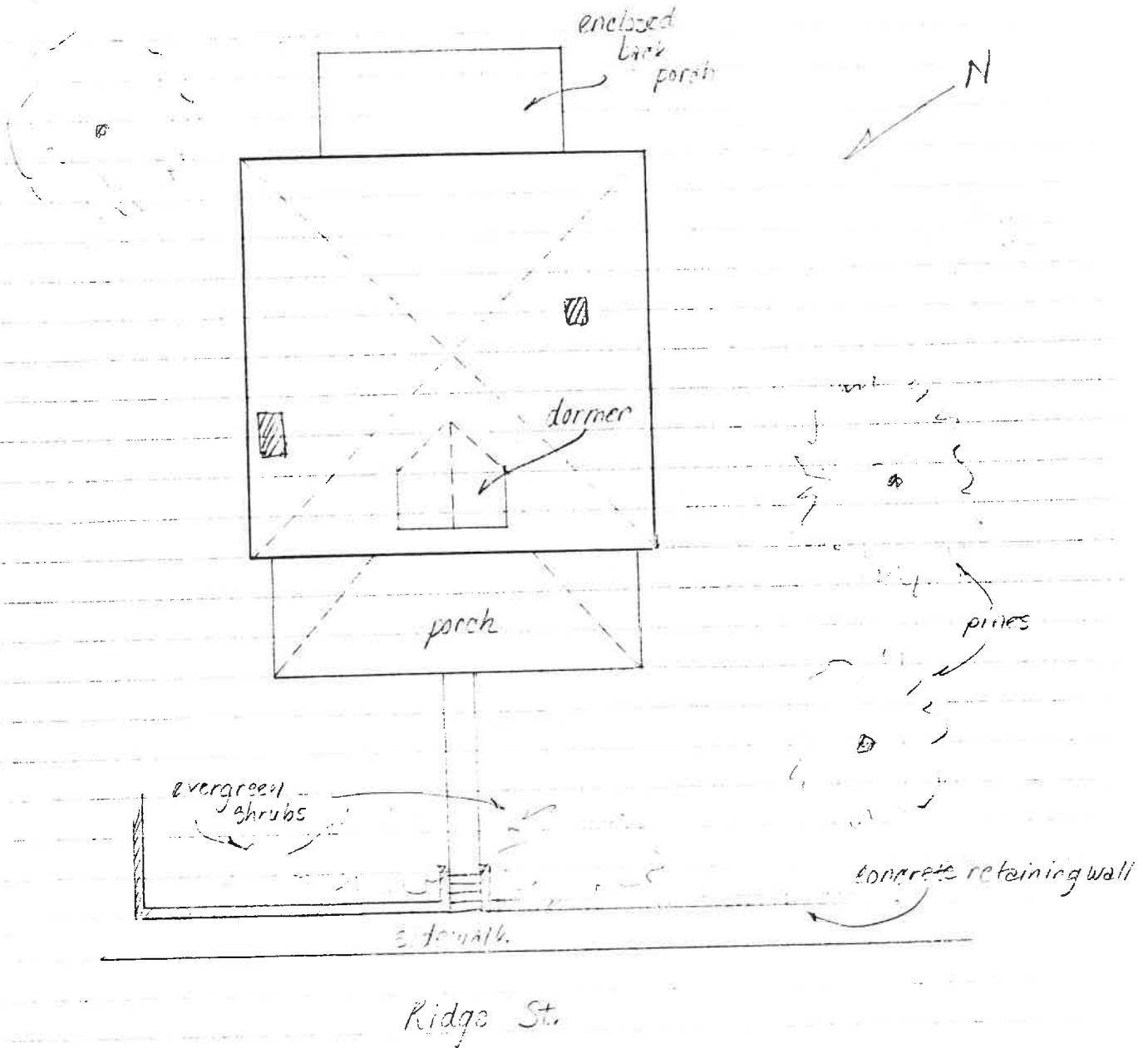

SUSAN R. SMENO  
PRESERVATION ASSOCIATES  
OF VIRGINIA

JANUARY 1992



Date 11/23/93 File No. 104-25-47

Name 712 Ridge St.

Town City of Charlottesville

County \_\_\_\_\_

Photographer Susan E. Smead

Contents 3 exterior

\_\_\_\_\_  
\_\_\_\_\_