

CULTURAL RESOURCE MANAGEMENT EVENTS

Date: / /1996

Cultural Resource Management Event: Reconnaissance Survey

Organization or Person: J. Daniel Pezzoni, Preservation Con

ID # Associated with Event:

CRM Event Notes or Comments:

MAILING ADDRESS

Honorif:

First : Peggy, C. Martin &

Last : Vest

Suffix :

Title :

Company:

Address: 815 Page St.

City : Charlottesville

State: VA

Zip : 22903- Country: USA

Phone/extension: 804-296-1736

Individual Category Codes:

Mailing Address Notes:

Surveyor's Notes:

Component	#	Comp Type/Form	Material	Material Treatment
Structural System	0	Frame	Aluminum	
Roof	0	Gable: side	Metal	Standing Seam
Window(s)	0	Sash, double-hung	Wood	2/2
Roof	0	1-story	Wood	Wrap-around

INDIVIDUAL RESOURCE INFORMATION

SEQUENCE NUMBER: 1.0 WUZIT: Single Dwelling

Primary Resource? Yes

Estimated Date of Construction: 1900 ca

Source of Date: Site Visit

Architectural Style: Late Victorian

Description:

House with standard two-story two-room-deep form but odd three-bay fenestration pattern on front elevation. Other features include a center gable, a two-story ell, a brick flue, and a porch supported mostly by round columns but also a few turned posts.

Condition: Good

Threats to Resource: None Known

Additions/Alterations Description:

One-story rear wings appear added.

Number of Stories: 2.0

Interior Plan Type:

Accessed?

Interior Description:

Relationship of Secondary Resources to Property:

DHR Historic Context: Architecture/Community Planning
Domestic

Significance Statement:

The building contributes to the historic character of Ridge Street. In 1947 the house was occupied by Mrs. Lucy McC. Hoddinott and Jesse R. McCauley.

GRAPHIC DOCUMENTATION

Medium	Medium ID #	Frames	Date
B&W 35mm Photos	14629	5 - 6	3/ /1996
B&W 35mm Photos		-	/ /1996

BIBLIOGRAPHIC DATA

Sequence #: 1.0 Bibliographic Record Type: Book

Author: Hill Directory Co.

Citation Abbreviation:

Hill's Charlottesville City Directory, 1947-48

Notes:

RECONNAISSANCE LEVEL SURVEY REPORT

DEPARTMENT OF HISTORIC RESOURCE
RECONNAISSANCE SURVEY FORM

Reviewed by Margaret Peters

DHR Identification Number: 104-0275

Other DHR Number: Property Date(s) 1900 ca

PROPERTY NAMES	EXPLANATION
Hoddinott-McCauley House (754 Ridge St.)	Historic/Location

County/Independent City: Charlottesville
 State: Virginia
 Magisterial District: N/A Tax Parcel: 25-84

USGS Quad Map Name: CHARLOTTESVILLE EAST

UTMs of Boundary:
Center UTM:

Restrict location and UTM data? N

ADDRESSES

Number	Thoroughfare Name	Explanation
754 -	Ridge St.	

Vicinity: Town/Village/Hamlet:

Name of National Register Historic District:

Name of DHR Eligible Historic District:

Name of Local Historic District:

Physical Character of General Surroundings: City

Site Description/Notable Landscape Features:
Residential, stone retaining wall along sidewalk.

Ownership: Private NR Resource Type: Building

WUZITS

Seq. #	# of	Wuzit Types	Historic?
1.0	1	Single Dwelling	Historic

TOTAL: 1
 Historic: 1
 Non-Historic: 0

PRIMARY RESOURCE EXTERIOR COMPONENT DESCRIPTION

104-275

CITY OF CHARLOTTESVILLE



SCALE 1" = 100'

reconnaissance main screen 1 of 7

Where is data filed at DHR? _____
 DHR Idem. # _____ Property date(s) _____
 Other DHR no. _____

Seq. # 1 Name Hoddinoff Hs Property Name(s) _____ Explanation* _____

Address	Alternate spelling	Former/current	Historic/location	Original
Address-current	Current	Function/location	Location	VLR listing
Alleged	Descriptive	Historic	NHL listing	
Alternate name	Former	Historic/current	NRHP listing	

County/And. City _____ Tax Parcel Number 25-84
 State VA Virginia
 Magle'l District _____
 USGS Quad Map Name _____ UTM's of Boundary 1 1
 Center UTM-Zone/East/North 1 1

reconnaissance main screen 2 of 7

Restrict Location and UTM date? _____
 # Suffix 754 Thoroughfare Name W 25th St Address _____ Explanation _____

Address Superfield Screen _____
 Address Explanation _____
 Sequence Number _____
 Main Street Number _____
 Number Suffix _____
 Street Name _____

Vicinity of: _____ Town/Village/Hamlet _____

Name of National Register Historic District _____

Name of VDHR Eligible Historic District _____

Name of Local Historic District _____

reconnaissance main screen 3 of 7

Physical Character of General Surroundings _____
 City _____ Hamlet _____ Rural _____ Suburban _____ Town _____ Village _____

Site Description/Notable Landscape Features
Rest. stone set wall

Ownership _____ NR Resource Type _____
 F Public-Federal P Private B Building S Site
 L Public-Local S Public-State D District U Structure
 O Object

Seq. #	# of	Wuzit Count	Wuzit Types	Historic?	Total
					Historic
					Non Historic
					Undetermined

reconnaissance main screen 4 of 7
 Primary Resource Exterior Component Description

Component (number(s))	#	Comp. Type/Form	Material	Material Treatment
column				
cornice				
door(s)				
foundation	<u>NO</u>			
porch	<u>1</u>	<u>1-5 wrap</u>	<u>wd metal</u>	<u>21. 25. 11. 20. 25</u>
roof		<u>gable (side)</u>	<u>metal</u>	<u>5. 5.</u>
walls		<u>2 1/2</u>	<u>alum</u>	<u>w/d</u>
windows		<u>2 1/2</u>	<u>w/d</u>	<u>2/2</u>

Individual Resource Information

Seq. # Wuzit Primary? _____ Date Built _____

Individual Resource Superfield Screen

Sequence Number _____ Wuzit _____
 Primary Resource? _____
 Estimated Date of Construction _____ Source of Data _____

Architectural Style	French Colonial	Late Gothic Revival	Prairie School
Art Deco	French Renaissance	Late Victorian	Pueblo
Beaux Arts	Georgian	Mid-19th C.	Queen Anne
Bungalow/Craftsman	Gothic	Mission/Spanish	Renaissance
Chicago	Gothic Revival	Colonial Revival	Romanesque
Classical Revival	Greek Revival	Mixed (more than 3 styles from different periods)	Second Empire
Colonial	International Style	Modern Movement	Shingle Style
Colonial Revival	Italian Renaissance	Moderne	Skyscraper
Commercial Style	Italian Villa	No Style Listed	Spanish Colonial
Dutch Colonial	Italianate	Octagon Mode	Stick/Eastlake
Early Class. Rev.	Late 19th & 20th C. Revivals	Other	Tudor Revival
Early Republic	Late 19th & Early 20th C. Amer. Movements	Postmedieval English	
Exotic Revival			
Federal			

Description

covered gable porch mostly intact, rest sq cr
turned posts br. pine
2-3 cut + 1-3 rear wings

Condition	Excellent	Good	Good-Fair	Poor	Renovated
Demolished	Fair	Good Excellent	N/A	Rebuilt	Humus

Threats to Resource	Development	Neglect	None Known	Relocation	Trans. Expan.
Demolition	Major Alteration	None	Public Util. Expan.	Structural Failure	Vacant

Additions/Alterations Description

1947; Hoddinoff² McCanley WHT

Number of Stories 2 Conditional Individual Resource Superfield Screen
 Interior Plan Type _____
 Accessed? _____ If not, why not? _____
 Denied No Trespassing Not Accessible

Interior Description _____

 Relationship of Secondary Resources _____

reconnaissance main screen 5 of 7
 Historic Context

DIR Historic Context(s): Agriculture/Subsistence Architecture/Landscape Architecture/ Community Planning Commerce/Trade Domestic Education	Ethnicity/Immigration Funerary Health Care Industry/Processing/Extraction Landscape Military/Defense	Recreation/Arts Religion Settlement Patterns Social Traffic Engineering Transportation Other
Significance Statement _____		

reconnaissance main screen 6 of 7
 Graphic Documentation

Medium#	Medium ID #	Frames	Date
1	2 x 2 B & W photos 4 x 5 B & W photos	B & W 35 mm photos Color 35 mm photos	Historic photos Measured drawings
			Slides

Bibliographic Data

Seq. # _____ Type _____ Citation _____

Bibliographic Superfield Screen

Sequence #: _____ Bibliographic Record Type: _____ Author: _____
 Citation Abbreviation: _____

Notes: _____

Bibliographic Superfield Screen

Sequence #: _____ Bibliographic Record Type: _____ Author: _____
 Citation Abbreviation: _____

Notes: _____

reconnaissance main screen 7 of 7
 Cultural Resource Management Events
 Agency/Individual

Date CRM Event Assoc. ID# _____

CRM Event Superfield Screen

Date: _____ Cultural Resource Management Event: _____
 Organization or Person: _____
 ID# Associated with Event: _____

Notes or Comments

Mailing Address Superfield Screen

HONORIF: _____ Record Created: _____
 FIRST: _____ Last Updated: _____
 LAST: _____
 SUFFIX: _____
 TITLE: _____
 COMPANY: _____ PHONE/EXTENSION: _____
 ADDRESS: _____ STATE: _____
 CITY: _____ COUNTRY: _____
 ZIP: _____

Individual's Category Codes

Informant	Occupant	Owner	Specimens (owner of specimens)	Tenant
_____	_____	_____	_____	_____

Notes _____

Surveyor's Notes

Date Processing Events
 Person

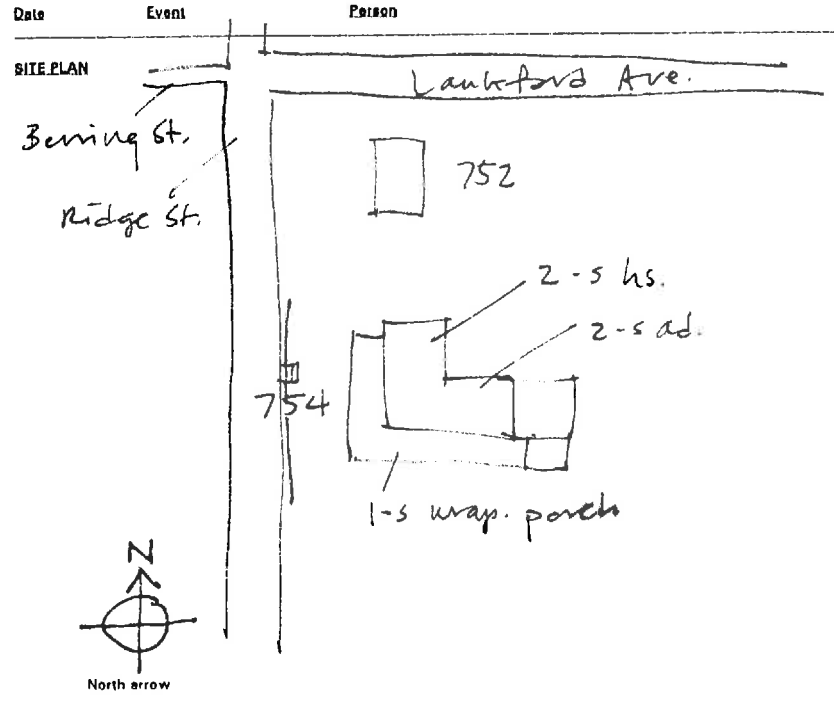

N.T.S.
 Date: _____ Drawn by: _____
 SES - 2/96 Agency: _____



14629

Date 3.1996 File No. 104-275

Name Hodginott
House (754 Ridge St.)

Town _____

County Charlottesville

Photographer Dan Pezzoni

Contents 2 ext. views

