

Sequence #: 1.0 Bibliographic Record Type: Oral History  
Author: Updike, Waddell  
Citation Abbreviation:  
Interview, Charlottesville, VA, May 1996  
Notes:

Sequence #: 2.0 Bibliographic Record Type: Oral History  
Author: Reaves, Mrs. Booker  
Citation Abbreviation:  
Interview, Charlottesville, VA, May 1996  
Notes:

Sequence #: 3.0 Bibliographic Record Type: Oral History  
Author: Woodfolk, Theresa  
Citation Abbreviation:  
Interview, Charlottesville, VA, May 1996  
Notes:

#### CULTURAL RESOURCE MANAGEMENT EVENTS

Date: / /1996  
Cultural Resource Management Event: Reconnaissance Survey  
Organization or Person: J. Daniel Pezzoni, Preservation Con  
ID # Associated with Event:  
CRM Event Notes or Comments:

#### MAILING ADDRESS

Honorif:  
First : James L. & Elizabeth  
Last : Woodfolk  
Suffix :  
Title :  
Company:

Address: 755 Ridge St.

City : Charlottesville State: VA  
Zip : 22901- Country: USA  
Phone/extension: 804-295-1816

Individual Category Codes:

Mailing Address Notes:

Surveyor's Notes:

PRIMARY RESOURCE EXTERIOR COMPONENT DESCRIPTION

Component	#	Comp Type/Form	Material	Material Treatment
Structural System	0			Stucco
Roof	0	Hipped	Asphalt	Shingle
Window(s)	0	Sash, double-hung	Wood	6/1
Dormer	4	Hipped		Stucco

INDIVIDUAL RESOURCE INFORMATION

SEQUENCE NUMBER: 1.0 WUZIT: Single Dwelling

Primary Resource? Yes

Estimated Date of Construction: 1905

Source of Date: Oral History

Architectural Style: Bungalow/Craftsman

Description:

House is an early example of Craftsman styling in Charlottesville; its unusual architectural character may have something to do with the fact it was built for a German family. The pebbledash stucco exterior is said to utilize pebbles from France. Other features include a pedimented stoop over the front entry (which has sidelights), an arcaded one-story side porch, and shaped rafter tails.

Condition: Good

Threats to Resource: None Known

Additions/Alterations Description:

Number of Stories: 1.5

Interior Plan Type:

Accessed?

Interior Description:

Relationship of Secondary Resources to Property:

DHR Historic Context: Architecture/Community Planning  
Domestic

Significance Statement:

The building contributes to the historic character of Ridge Street. The house was built for a German tailor by the name of Cook, who may have had a shop on Main Street downtown. A Mr. Curry (father of Madeline Curry) helped with the construction. Mr. and Mrs. Booker Reaves purchased the property in 1945. The house represents an early and imaginative example of Craftsman architecture in Charlottesville.

GRAPHIC DOCUMENTATION

Medium	Medium ID #	Frames	Date
B&W 35mm Photos	14629	14 -	3/ /1996
B&W 35mm Photos	14629	16 - 22	3/ /1996

BIBLIOGRAPHIC DATA

RECONNAISSANCE LEVEL SURVEY REPORT

DEPARTMENT OF HISTORIC RESOURCE  
RECONNAISSANCE SURVEY FORM

*Reviewed by Margaret Peters*

DHR Identification Number: 104-0278

Other DHR Number: Property Date(s) 1905

PROPERTY NAMES	EXPLANATION
Cook-Reaves House (755 Ridge St.)	Historic/Location

County/Independent City: Charlottesville  
 State: Virginia  
 Magisterial District: N/A Tax Parcel: 25-38

USGS Quad Map Name: CHARLOTTESVILLE EAST

UTMs of Boundary:  
Center UTM:

Restrict location and UTM data? N

ADDRESSES

Number	Thoroughfare Name	Explanation
755 -	Ridge St.	

Vicinity: Town/Village/Hamlet:

Name of National Register Historic District:

Name of DHR Eligible Historic District:

Name of Local Historic District:

Physical Character of General Surroundings: City

Site Description/Notable Landscape Features:  
Residential, early or original cast-iron fence along sidewalk, yard thickly planted with evergreens.

Ownership: Private NR Resource Type: Building

WUZITS

Seq. #	# of	Wuzit Types	Historic?
1.0	1	Single Dwelling	Historic

TOTAL: 1  
 Historic: 1  
 Non-Historic: 0

PARCEL I.D. 25 - 38. PROPERTY ADDRESS 755 RIDGE STREET  
NEIGHBORHOOD NUMBER 9 LEGAL DESCRIPTION LOT

\*\*\* OWNER INFORMATION \*\*\*

NAME WOODFOLK JAMES L & ELIZABETH L  
ADDRESS 755 RIDGE STREET  
CHARLOTTESVILLE, VA 22902

\*\*\* DEED INFORMATION \*\*\*

BOOK 320  
PAGE 568  
TAXABLE

\*\*\*\*\* MISCELLANEOUS INFORMATION \*\*\*\*\*

PROP CLASS ONE FAMILY	LIVING AREA	2964	LOT AREA SQ.FT.	18750
ZONING R3	PERIMETER	159	LOT AVERAGE WIDTH	100
OVLP. ZONE	DWELLING UNITS	1	LOT AVERAGE DEPTH	200
LAND USE 1101	CENSUS TRACT	401128	PROPERTY - ACRES	.430
EQ. BD. YR	EQ. BD. ACT.		PICTURE	NO

\*\*\*\*\* PRIMARY STRUCTURE \*\*\*\*\*

YEAR BUILT 1925	EFF YEAR 1952	CONSTRUCTION	STUCCO WOOD FRAME
GRADE AVERAGE	PCT. ADJ. 0	STORIES	2.0
TYPE STANDARD UNIT		BASEMENT	YES ATTIC NO
CONDITION FAIR		AREA SQ. FT.	674

PLEASE ENTER IN YOUR INFORMATION THEN PRESS enter OR PRESS f7 TO EXIT.

[ ]

104-278

CITY OF CHARLOTTESVILLE



SCALE : 1" = 100'

**Conditional Individual Resource Superfield Screen**

Number of Stories: \_\_\_\_\_  
 Interior Plan Type: \_\_\_\_\_  
 Accessed?: \_\_\_\_\_

If not, why not? \_\_\_\_\_  
 Denied \_\_\_\_\_ No Trespassing \_\_\_\_\_ Not Accessible \_\_\_\_\_

Interior Description \_\_\_\_\_  
 \_\_\_\_\_  
 \_\_\_\_\_

Relationship of Secondary Resources \_\_\_\_\_  
 \_\_\_\_\_  
 \_\_\_\_\_

**reconnaissance main screen 5 of 7**  
 Historic Context

DHR Historic Context(s):

Agriculture/Subsistence	Ethnicity/Immigration	Recreation/Arts
Architecture/Landscape Architecture/Community Planning	Funerary	Religion
Commerce/Trade	Health Care	Settlement Patterns
Domestic	Industry/Processing/Extraction	Social
Education	Landscape	Traffic Engineering
	Military/Defense	Transportation
		Other

Significance Statement \_\_\_\_\_  
 \_\_\_\_\_

**reconnaissance main screen 6 of 7**  
 Graphic Documentation

Medium*	Medium ID #	Graphic Documentation Frames	Date
2 x 2 B & W photos	B & W 35 mm photos	Historic photos	Slides
4 x 5 B & W photos	Color 35 mm photos	Measured drawings	

**Bibliographic Data**

Seq. # \_\_\_\_\_ Type \_\_\_\_\_ Citation \_\_\_\_\_

**Bibliographic Superfield Screen**

Sequence #: \_\_\_\_\_ Bibliographic Record Type: \_\_\_\_\_ Author: \_\_\_\_\_  
 Citation Abbreviation: \_\_\_\_\_ Notes: \_\_\_\_\_

**Bibliographic Superfield Screen**

Sequence #: \_\_\_\_\_ Bibliographic Record Type: \_\_\_\_\_ Author: \_\_\_\_\_  
 Citation Abbreviation: \_\_\_\_\_ Notes: \_\_\_\_\_

**reconnaissance main screen 7 of 7**  
 Cultural Resource Management Events

Date	CRM Event	Agency/Individual	Assoc. ID#

**CRM Event Superfield Screen**

Date: \_\_\_\_\_ Cultural Resource Management Event: \_\_\_\_\_  
 Organization or Person: \_\_\_\_\_  
 ID# Associated with Event: \_\_\_\_\_

**Notes or Comments**

**Mailing Address Superfield Screen**

HONORIF: \_\_\_\_\_ Record Created: \_\_\_\_\_  
 FIRST: \_\_\_\_\_ Last Updated: \_\_\_\_\_  
 LAST: \_\_\_\_\_  
 SUFFIX: \_\_\_\_\_  
 TITLE: \_\_\_\_\_  
 COMPANY: \_\_\_\_\_  
 ADDRESS: \_\_\_\_\_  
 CITY: \_\_\_\_\_  
 ZIP: \_\_\_\_\_

PHONE/EXTENSION: \_\_\_\_\_  
 STATE: \_\_\_\_\_  
 COUNTRY: \_\_\_\_\_

**Individual's Category Codes**

Informant	Occupant	Owner	Specimens (owner of specimens)	Tenant
-----------	----------	-------	--------------------------------	--------

Notes \_\_\_\_\_

**Surveyor's Notes**

**Data Processing Events**

Date	Event	Person

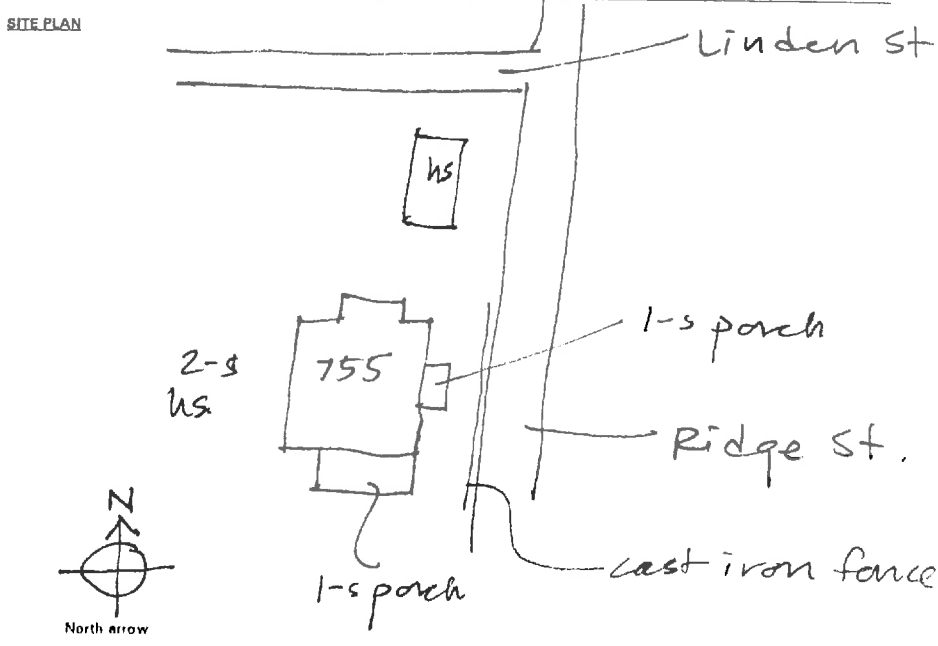

N.T.S.  
 Date: \_\_\_\_\_  
 SES - 2/96

Drawn by: \_\_\_\_\_  
 Agency: \_\_\_\_\_

W. Update:  
 replaced a frame house w/ the present  
 my grandpa not involved

reconnaissance main screen 1 of 2

Where is data filed at DHR? \_\_\_\_\_  
 DHR Id. # \_\_\_\_\_ Property date(s) \_\_\_\_\_  
 Other DHR no. \_\_\_\_\_

Seq. # 1 Name Reaves House Explanation \* \_\_\_\_\_  
 Property Names \_\_\_\_\_

Address	Alternate spelling	Former/current	Historic/location	Original
Address: current	Current	Function/location	Location	VLR listing
Alleged	Descriptive	Historic	NHL listing	
Alternate name	Former	Historic/current	NRHP listing	

Tax Parcel Number # 25-38

County/and City \_\_\_\_\_  
 State VA Virginia \_\_\_\_\_  
 Magis'l District \_\_\_\_\_  
 USGS Quad Map Name \_\_\_\_\_  
 Center UTM-Zone/East/North \_\_\_\_\_

UTMs of Boundary \_\_\_\_\_

reconnaissance main screen 2 of 2

Restrict Location and UTM data? \_\_\_\_\_  
 Addresses \_\_\_\_\_

# 1 Suffix 755 Thoroughfare Name Bridge Explanation \_\_\_\_\_  
 Address Superfield Screen \_\_\_\_\_

Sequence Number	Address Explanation	Alternate Current	Name Change Number Change
Main Street Number _____			
Number Suffix _____			
Street Name _____			

Vicinity of: \_\_\_\_\_ Town/Village/Hamlet \_\_\_\_\_

Name of National Register Historic District \_\_\_\_\_

Name of VDHR Eligible Historic District \_\_\_\_\_

Name of Local Historic District \_\_\_\_\_

reconnaissance main screen 3 of 2

Physical Character of General Surroundings \_\_\_\_\_  
 City \_\_\_\_\_ Hamlet \_\_\_\_\_ Rural \_\_\_\_\_ Suburban \_\_\_\_\_ Town \_\_\_\_\_ Village \_\_\_\_\_

Site Description/Notable Landscape Features

Ownership \_\_\_\_\_ NR Resource Type \_\_\_\_\_  
 F Public-Federal P Private B Building S Site  
 L Public-Local S Public-State D District U Structure  
 O Object

Seq. #	# of	Wuzit Count	Wuzit Types	Historic?*	Total
					Historic
					Non-Historic

Theresa Woodfolk 5.16.96: moved to Kitty Hawk NC  
 Built 1905 by same Germans we used to have photos  
 pebbledash - pebbles fr. France  
 builders: Mr. Curry  
 Miss Mabeline Curry's father helped build it.  
 we've been here 26 yrs.  
 Mr. & Mrs. Booker Reaves - Buckh. Rd.

Component	Comp. Type/Form	Material	Material Treatment
shutters(s)			
columns			
carvings			
door(s)			
foundation			
porch			
roof			
walls			
windows			

Individual Resource Information  
 Seq. # Wuzit Primary? \_\_\_\_\_ Date Built \_\_\_\_\_

Individual Resource Superfield Screen  
 Sequence Number \_\_\_\_\_ Wuzit \_\_\_\_\_  
 Primary Resource? \_\_\_\_\_ Source of Date \_\_\_\_\_  
 Estimated Date of Construction \_\_\_\_\_

Architectural Style	French Colonial	Late Gothic Revival	Prairie School
Art Deco	French Renaissance	Late Victorian	Pueblo
Beaux Arts	Georgian	Mid-19th C.	Queen Anne
Bungalow/Craftsman	Gothic	Mission/Spanish	Renaissance
Chicago	Gothic Revival	Colonial Revival	Romanesque
Classical Revival	Greek Revival	Mixed (more than 3 styles from different periods)	Second Empire
Colonial	International Style	Modern Movement	Shingle Style
Colonial Revival	Italian Renaissance	Moderno	Skyscraper
Commercial Style	Italian Villa	No Style Listed	Spanish Colonial
Dutch Colonial	Italianate	Octagon Mode	Stick/Eastlake
Early Class. Rev.	Late 19th & 20th C. Revivals	Other	Tudor Revival
Early Republic	Late 19th & Early 20th C. Amer. Movements	Postmedieval English	
Exotic Revival			
Federal			

Condition	Excellent	Good	Good-Fair	Poor	Remodeled
Demolished	Fair	Good-Excellent	N/A	Rebuilt	Ruinous
Deteriorated					

Threats to Resource	Development	Neglect	None Known	Relocation	Trans. Expan.
Demolition	Major Alteration	None	Public Util. Expan.	Structural Failure	Vacant
Deterioration					

Additions/Alterations Description

\_\_\_\_\_

fence orig'l  
 tailor wkd on main st.  
 Waddell Update 5.16  
 Cool, German we bt. H Fr. in 1945



14629

Date 3.1996 File No. 104-278

Name Reaves House (755 Ridge St.)

Town \_\_\_\_\_

County Charlottesville

Photographer Dan Pezzoni

Contents 6 ext. views

\_\_\_\_\_  
\_\_\_\_\_