

PARCEL I.D. 25 - 85. PROPERTY ADDRESS 764 RIDGE STREET
NEIGHBORHOOD NUMBER 9 LEGAL DESCRIPTION LOT

*** OWNER INFORMATION ***

NAME SANDALIS JOHN & MICHELLE
ADDRESS 308 DOVER RD
CHARLOTTESVILLE, VA 22901

*** DEED INFORMATION ***

BOOK 662
PAGE 680
TAXABLE

***** MISCELLANEOUS INFORMATION *****

| | | | | |
|-----------------------|----------------|----------|-------------------|------|
| PROP CLASS ONE FAMILY | LIVING AREA | 1860 | LOT AREA SQ.FT. | 7100 |
| ZONING R3 | PERIMETER | 141 | LOT AVERAGE WIDTH | 40 |
| OVLP. ZONE | DWELLING UNITS | 1 | LOT AVERAGE DEPTH | 177 |
| LAND USE 1101 | CENSUS TRACT | 401133 | PROPERTY - ACRES | .163 |
| EQ. BD. YR 1995 | EQ. BD. ACT. | DECREASE | PICTURE | YES |

***** PRIMARY STRUCTURE *****

| | | | |
|--------------------|---------------|--------------|-------------|
| YEAR BUILT 1925 | EFF YEAR 1961 | CONSTRUCTION | WOOD FRAME |
| GRADE AVERAGE | PCT. ADJ. 20 | STORIES | 2.0 |
| TYPE STANDARD UNIT | | BASEMENT | NO ATTIC NO |
| CONDITION AVERAGE | | AREA SQ. FT. | 930 |

PLEASE ENTER IN YOUR INFORMATION THEN PRESS enter OR PRESS f7 TO EXIT.

[]

RECONNAISSANCE LEVEL SURVEY REPORT

DEPARTMENT OF HISTORIC RESOURCE
RECONNAISSANCE SURVEY FORM*Reviewed by Margaret Peters*

DHR Identification Number: 104-0276

Other DHR Number: Property Date(s) 1900 ca

PROPERTY NAMES

Nichols House (764 Ridge St.)

EXPLANATION

Historic/Location

County/Independent City: Charlottesville

State: Virginia

Magisterial District: N/A

Tax Parcel: 25-85

USGS Quad Map Name: CHARLOTTESVILLE EAST

UTMs of Boundary:

Center UTM:

Restrict location and UTM data? N

ADDRESSES

| Number | Thoroughfare Name | Explanation |
|--------|-------------------|-------------|
| 764 - | Ridge St. | |

Vicinity: Town/Village/Hamlet:

Name of National Register Historic District:

Name of DHR Eligible Historic District:

Name of Local Historic District:

Physical Character of General Surroundings: City

Site Description/Notable Landscape Features:

Residential, maples and white pines in yard, concrete-block retaining wall along sidewalk, unpaved driveway.

Ownership: Private

NR Resource Type: Building

WUZITS

| Seq. # | # of | Wuzit Types | Historic? |
|--------|------|-----------------|--------------|
| 1.0 | 1 | Single Dwelling | Historic |
| 2.0 | 1 | Garage | Undetermined |

| | | |
|---------------|---|--|
| TOTAL: | 2 | |
| Historic: | 1 | |
| Non-Historic: | 0 | |

PRIMARY RESOURCE EXTERIOR COMPONENT DESCRIPTION

| Component | # | Comp Type/Form | Material | Material Treatment |
|-------------------|---|-------------------|----------|--------------------|
| Structural System | 0 | Frame | Wood | T1-11 |
| Roof | 0 | Gable: side | Metal | Standing Seam |
| Window(s) | 0 | Sash, double-hung | Wood | 2/2 |
| Porch | 0 | 1-story, 2-bay | Wood | Posts (turned) |
| Foundation | 0 | Masonry | Stone | Coursed Rubble |

INDIVIDUAL RESOURCE INFORMATION

SEQUENCE NUMBER: 1.0

WUZIT: Single Dwelling

Primary Resource? Yes

Estimated Date of Construction: 1900 ca

Source of Date: Site Visit

Architectural Style: Late Victorian

Description:

Much-altered dwelling with center gable, two-bay front elevation, front entry with sidelights, and a two-story ell.

Condition: Good-Fair

Threats to Resource: None Known

Additions/Alterations Description:

Number of Stories: 2.0

Interior Plan Type:

Accessed?

Interior Description:

Relationship of Secondary Resources to Property:

At the end of the driveway behind the house stands a one-story two-bay garage with a gable-front roof and corrugated metal siding.

DHR Historic Context: Architecture/Community Planning
Domestic

Significance Statement:

The building contributes to the historic character of Ridge Street. It appears to have been occupied by Percy Nichols in 1947. Rehabilitation work was in progress at the time of survey.

GRAPHIC DOCUMENTATION

| Medium | Medium ID # | Frames | Date |
|-----------------|-------------|--------|----------|
| B&W 35mm Photos | 14629 | 7 - 9 | 3/ /1996 |
| B&W 35mm Photos | | - | / /1996 |

BIBLIOGRAPHIC DATA

Sequence #: 1.0 Bibliographic Record Type: Book

Author: Hill Directory Co.

Citation Abbreviation:

Hill's Charlottesville City Directory, 1947-48
Notes:

CULTURAL RESOURCE MANAGEMENT EVENTS

Date: / /1996

Cultural Resource Management Event: Reconnaissance Survey
Organization or Person: J. Daniel Pezzoni, Preservation Con
ID # Associated with Event:
CRM Event Notes or Comments:

MAILING ADDRESS

Honorif:

First : John & Michelle

Last : Sandalis

Suffix :

Title :

Company:

Address: PO Box 6186

City : Charlottesville

State: VA

Zip : 22906- Country: USA

Phone/extension: 804-296-2344

Individual Category Codes:

Mailing Address Notes:

Surveyor's Notes:

CITY OF CHARLOTTESVILLE



SCALE : 1" = 100'

Conditional Individual Resource Superfield Screen

Number of Stories _____
 Interior Plan Type _____
 Accessed? _____
 If not, why not?
 Denied _____ No Trespassing _____ Not Accessible _____
 Interior Description _____

Relationship of Secondary Resources
 Record is 1-s 2-story frame gar w/ galv roof + corrug metal siding

reconnaissance main screen 5 of 7
 Historic Context

- | | | |
|--------------------------------------|--------------------------------|---------------------|
| DHR Historic Contexts: | Ethnicity/Immigration | Recreation/Arts |
| Agriculture/Subsistence | Funerary | Religion |
| Architecture/Landscape Architecture/ | Health Care | Settlement Patterns |
| Community Planning | Industry/Processing/Extraction | Social |
| Commerce/Trade | Landscape | Traffic Engineering |
| Domestic | Military/Defense | Transportation |
| Education | | Other |

Significance Statement

reconnaissance main screen 6 of 7
 Graphic Documentation

| Medium | Medium ID # | Frames | Date |
|--------------------|--------------------|-------------------|--------|
| 2 x 2 B & W photos | B & W 35 mm photos | Historic photos | Slides |
| 4 x 5 B & W photos | Color 35 mm photos | Measured drawings | |

Bibliographic Data
 Seq. # _____ Type _____ Citation _____

Bibliographic Superfield Screen
 Sequence #: _____ Bibliographic Record Type: _____ Author: _____
 Citation Abbreviation: _____
 Notes: _____

Bibliographic Superfield Screen
 Sequence #: _____ Bibliographic Record Type: _____ Author: _____
 Citation Abbreviation: _____
 Notes: _____

reconnaissance main screen 7 of 7
 Cultural Resource Management Events

| Date | CBM Event | Agency/Individual | Assoc. ID# |
|-----------------------------|-------------------------------------|-------------------|------------|
| CBM Event Superfield Screen | | | |
| Date: | Cultural Resource Management Event: | | |
| Organization or Person: | | | |
| ID# Associated with Event: | | | |

Notes or Comments

Mailing Address Superfield Screen
 Record Created: _____
 Last Updated: _____
 HONORIF: _____
 FIRST: _____
 LAST: _____
 SUFFIX: _____
 TITLE: _____
 COMPANY: _____
 ADDRESS: _____
 CITY: _____
 ZIP: _____
 PHONE/EXTENSION: _____
 STATE: _____
 COUNTRY: _____
 Individual's Category Codes

| Informant | Occupant | Owner | Specimens (owner of specimens) | Tenant |
|-----------|----------|-------|--------------------------------|--------|
| Notes | | | | |

Surveyor's Notes

Data Processing Events
 Person

SITE PLAN

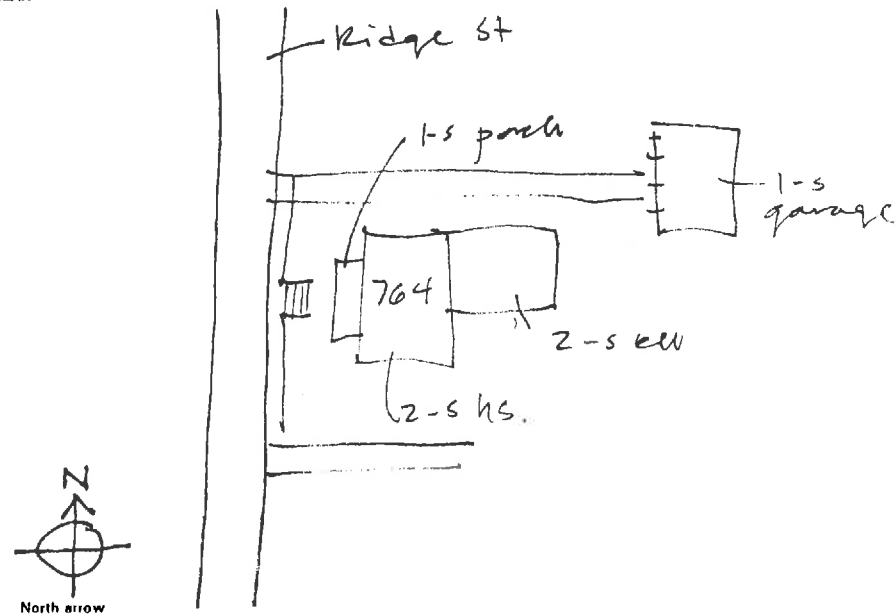

N.T.S.
 Date: _____
 SES - 2/96

Drawn by: _____
 Agency: _____

376

reconnaissance main screen 1 of 7

Where is data filed at DHR? _____
 DHR Ident. # _____ Property date(s) _____
 Other DHR no. _____

Seq. # 1 Name Nickels Hts Explanation* _____
 Property Name _____

| Address | Alternate spelling | Former/current Function/location | Historic/location Location | Original VLR listing |
|-----------------|--------------------|----------------------------------|----------------------------|----------------------|
| Address-current | Current | Function/location | Location | VLR listing |
| Alleged | Descriptive | Historic | NHL listing | |
| Alternate name | Former | Historic/current | NRHP listing | |

County/Ind. City _____ Tax Parcel Number 25-85
 State VA Virginia
 Mgmt'l District _____
 USGS Quad Map Name _____ UTM's of Boundary 1 1
 Center UTM-Zone/East/North _____

reconnaissance main screen 2 of 7

Restrict Location and UTM data? _____
 # 1 Suffix 4 Thoroughfare Name _____ Address _____ Explanation _____

Sequence Number _____ Address Superfield Screen _____
 Main Street Number _____ Address Explanation _____
 Number Suffix _____ Alternate _____ Name Change _____
 Street Name _____ Number Change _____

Vicinity of: _____ Town/Village/Hamlet _____

Name of National Register Historic District _____

Name of VDHR Eligible Historic District _____

Name of Local Historic District _____

reconnaissance main screen 3 of 7

Physical Character of General Surroundings _____
 City _____ Hamlet _____ Rural _____ Suburban _____ Town _____ Village _____

Site Description/Notable Landscape Features _____
resil, conc bl ret wall at st low hgt,
maple + wht. pine

Ownership _____ NR Resource Type _____
 F Public-Federal P Private B Building S Site
 L Public-Local S Public-State D District U Structure
 O Object

| Seq. # | # of | Wuzit Count | Wuzit Types | Historic? |
|--------|------|-------------|-------------|-----------|
| | | | | |
| | | | | |

Total _____
 Historic _____
 Non-Historic _____

reconnaissance main screen 4 of 7

Primary Resource Exterior Component Description

| Component | Color Type/Finish | Material | Material Treatment |
|------------|-----------------------|--------------|---------------------|
| chimney(s) | | | |
| columns | | | |
| cornice | | | |
| door(s) | | | |
| foundation | <u>concr. 1-5 3-7</u> | <u>stone</u> | <u>not possible</u> |
| porch | | <u>wd</u> | <u>7-2</u> |
| roof | <u>gable (side)</u> | <u>met</u> | <u>5-8</u> |
| walls | <u>1-1</u> | <u>met</u> | <u>7-11</u> |
| windows | <u>1-1</u> | <u>wd</u> | <u>2-2</u> |

Individual Resource Information

Seq. # Wuzit Primary? _____ Date Built _____

Individual Resource Superfield Screen

Sequence Number _____ Wuzit _____
 Primary Resource? _____ Source of Date _____
 Estimated Date of Construction _____
 Architectural Style _____

| Art Deco | French Colonial | Late Gothic Revival | Prairie School |
|--------------------|---|---|------------------|
| Beaux Arts | French Renaissance | Late Victorian | Pueblo |
| Bungalow/Craftsman | Georgian | Mid-19th C. | Queen Anne |
| Chicago | Gothic | Mission/Spanish | Renaissance |
| Classical Revival | Gothic Revival | Colonial Revival | Romanesque |
| Colonial | Greek Revival | Mixed (more than 3 styles from different periods) | Second Empire |
| Colonial Revival | International Style | Modern Movement | Shingle Style |
| Commercial Style | Italian Renaissance | Moderne | Skyscraper |
| Dutch Colonial | Italian Villa | No Style Listed | Spanish Colonial |
| Early Class. Rev. | Italianate | Octagon Mode | Stick/Eastlake |
| Early Republic | Late 19th & 20th C. Revivals | Other | Tudor Revival |
| Exotic Revival | Late 19th & Early 20th C. Amer. Movements | Postmedieval English | |
| Federal | | | |

Description _____
well built, small city gable
cutting w/ side Hts
2-6 etc

| Condition | Excellent | Good | Good-Fair | Poor | Renovated |
|------------|-----------|----------------|-----------|---------|-----------|
| Demolished | Fair | Good-Excellent | N/A | Rebuilt | Ruinous |

| Threats to Resource | Development | Neglect | None Known | Relocation | Trans. Expan. |
|---------------------|------------------|---------|---------------------|--------------------|---------------|
| Demolition | Major Alteration | None | Public Util. Expan. | Structural Failure | Vacant |

Additional/Alterations Description

owner: John Dallas
 ↑

1947: Heddenott, Lucy McG., Mrs.
McCauley, Jesse R.

occupants



14629

Date 3, 1996 File No. 104-276

Name Nichols House (764 Ridge St.)

Town _____

County Charlottesville

Photographer Dan Pezzoni

Contents 3 ext. views
