

RECONNAISSANCE LEVEL SURVEY REPORT

DEPARTMENT OF HISTORIC RESOURCE
RECONNAISSANCE SURVEY FORM

Reviewed by Margaret Peters

DHR Identification Number: 104-0279

Other DHR Number: Property Date(s) 1900 ca

PROPERTY NAMES	EXPLANATION
Carrington House (768 Ridge St.)	Historic/Location

County/Independent City: Charlottesville
 State: Virginia
 Magisterial District: N/A Tax Parcel: 25-87

USGS Quad Map Name: CHARLOTTESVILLE EAST

UTMs of Boundary:
Center UTM:

Restrict location and UTM data? N

ADDRESSES

Number	Thoroughfare Name	Explanation
768 -	Ridge St.	

Vicinity: Town/Village/Hamlet:

Name of National Register Historic District:

Name of DHR Eligible Historic District:

Name of Local Historic District:

Physical Character of General Surroundings: City

Site Description/Notable Landscape Features:
Residential, maples and yews in yard, brick retaining wall along sidewalk.

Ownership: Private NR Resource Type: Building

WUZITS

Seq. #	# of	Wuzit Types	Historic?
1.0	1	Single Dwelling	Historic

TOTAL: 1
 Historic: 1
 Non-Historic: 0

PRIMARY RESOURCE EXTERIOR COMPONENT DESCRIPTION

Component	#	Comp Type/Form	Material	Material Treatment
Structural System	0	Frame	Aluminum	
Roof	0	gable: front&side	Metal	Standing Seam
Window(s)	0	Sash, double-hung	Wood	2/2
Roof	0	1-story, 5-bay	Wood	Posts (square)
Foundation	0	Masonry	Brick	Not visible

INDIVIDUAL RESOURCE INFORMATION

SEQUENCE NUMBER: 1.0 WUZIT: Single Dwelling
 Primary Resource? Yes
 Estimated Date of Construction: 1900 ca
 Source of Date: Site Visit
 Architectural Style: Late Victorian
 Description:
 T-plan house with brick flue, back porch, cornice returns, front entry with sidelights and transom, and vestiges of turned posts on the front porch.

Condition: Good
 Threats to Resource: None Known

Additions/Alterations Description:
 Rear deck.

Number of Stories: 2.0
 Interior Plan Type:
 Accessed?

Interior Description:

Relationship of Secondary Resources to Property:

DHR Historic Context: Architecture/Community Planning
 Domestic

Significance Statement:
 The building contributes to the historic character of Ridge Street. Thompson F. Carrington owned the house in 1947; George and Leetha Carrington owned it in the 1970s.

GRAPHIC DOCUMENTATION

Medium	Medium ID #	Frames	Date
B&W 35mm Photos	14629	23 - 25	3/ /1996
B&W 35mm Photos		-	/ /1996

BIBLIOGRAPHIC DATA

Sequence #: 1.0 Bibliographic Record Type: Book
 Author: Hill Directory Co.
 Citation Abbreviation:
 Hill's Charlottesville City Directory, 1947-48
 Notes:

Sequence #: 2.0 Bibliographic Record Type: Oral History
Author: Poindexter, Willard
Citation Abbreviation:
Interview, Charlottesville, VA, March 1996.
Notes:

CULTURAL RESOURCE MANAGEMENT EVENTS

Date: / /1996
Cultural Resource Management Event: Reconnaissance Survey
Organization or Person: J. Daniel Pezzoni, Preservation Con
ID # Associated with Event:
CRM Event Notes or Comments:

MAILING ADDRESS

Honorif:
First : Annie W. & Willard C
Last : Poindexter
Suffix :
Title :
Company:

Address: 768 Ridge St.

City : Charlottesville State: VA
Zip : 22901- Country: USA
Phone/extension:

Individual Category Codes:

Mailing Address Notes:

Surveyor's Notes:

PARCEL I.D. 25 - 87. PROPERTY ADDRESS 768 RIDGE STREET
NEIGHBORHOOD NUMBER 9 LEGAL DESCRIPTION LOT

*** OWNER INFORMATION ***

*** DEED INFORMATION ***

NAME POINDEXTER ANNIE W & WILLARD C
ADDRESS 768 RIDGE STREET
CHARLOTTESVILLE, VA 22902

BOOK 340
PAGE 283
TAXABLE

***** MISCELLANEOUS INFORMATION *****

PROP CLASS ONE FAMILY	LIVING AREA	1732	LOT AREA SQ.FT.	35000
ZONING R3	PERIMETER	162	LOT AVERAGE WIDTH	60
OVLP. ZONE	DWELLING UNITS	1	LOT AVERAGE DEPTH	400
LAND USE 1101	CENSUS TRACT	401133	PROPERTY - ACRES	.803
EQ. BD. YR	EQ. BD. ACT.		PICTURE	NO

***** PRIMARY STRUCTURE *****

YEAR BUILT 1925	EFF YEAR 1947	CONSTRUCTION	ALUMINUM SIDING
GRADE AVERAGE	PCT. ADJ. 15	STORIES	2.0
TYPE STANDARD UNIT		BASEMENT	NO ATTIC NO
CONDITION FAIR		AREA SQ. FT.	802

[]

PLEASE ENTER IN YOUR INFORMATION THEN PRESS enter OR PRESS f7 TO EXIT.

CITY OF CHARLOTTESVILLE



SCALE : 1" = 100'

79

reconnaissance main screen 1 of 7

Where is data filed at DHR? _____
 DHR Idm. # _____ Property date(s) _____
 Other DHR no. _____

Property Name: Carrington HS Explanation: _____

Address: _____ Alternate spelling: _____ Former/current Function/location: _____ Historic/location: _____ Original VLR listing: _____
 Address-current: _____ Current: _____ Function/location: _____ Location: _____ VLR listing: _____
 Alleged: _____ Descriptive: _____ Historic: _____ NHL listing: _____
 Alternate name: _____ Former: _____ Historic/current: _____ NRHP listing: _____

County/Ind. City: _____ Tax Parcel Number: 25-87
 State: VA Virginia
 Magis'l District: _____
 USGS Quad Map Name: _____ UTM's of Boundary: 1 1
 Center UTM-Zone/East/North: 1 1

reconnaissance main screen 2 of 7

Restrict Location and UTM data? _____

768 # Suffix High Thoroughfare Name _____
 Address: _____ Explanation: _____

Address Superfield Screen: _____
 Address Explanation: _____

Sequence Number: _____
 Main Street Number: _____ Alternate: _____ Name Change: _____
 Number Suffix: _____ Current: _____ Number Change: _____
 Street Name: _____

Vicinity of: _____ Town/Village/Hamlet: _____

Name of National Register Historic District: _____
 Name of VDH Historic District: _____
 Name of Local Historic District: _____

reconnaissance main screen 3 of 7

Physical Character of General Surroundings: _____
 City _____ Hamlet _____ Rural _____ Suburban _____ Town _____ Village _____

Site Description/Notable Landscape Features: res'l, w/ vet walk, maple, yews

Ownership: _____ NR Resource Type: _____
 F Public-Federal _____ P Private _____ B Building _____ S Site _____
 L Public-Local _____ B Public-State _____ D District _____ U Structure _____
 O Object _____

Wuzil Count: _____ Total: _____
 Wuzil Types: _____ Historic: _____
 Historic? _____ Non-Historic: _____
 Undetermined: _____

reconnaissance main screen 4 of 7

Component	Material	Material Treatment
columns		
cornice		
door(s)		
foundation		
porch		
roof		
walls		
windows		

1 main br. no
1 T-S-b w/d sign dt. 5
1 gach (side + fr) w/d weird
fr alum. weird
d bte w/d zic

Individual Resource Information

Seq. #	Wuzil	Primary?	Date Built
Sequence Number			
Primary Resource?			
Estimated Date of Construction			Source of Date
Architectural Style			
Art Deco	French Colonial	Late Gothic Revival	Prairie School
Beaux Arts	French Renaissance	Late Victorian	Pueblo
Bungalow/Craftsman	Georgian	Mid-19th C.	Queen Anne
Chicago	Gothic	Mission/Spanish	Renaissance
Classical Revival	Gothic Revival	Colonial Revival	Romanesque
Colonial	Greek Revival	Mixed (more than 3 styles from different periods)	Second Empire
Colonial Revival	International Style		Shingle Style
Commercial Style	Italian Renaissance	Modern Movement	Skyscraper
Dutch Colonial	Italian Villa	Moderno	Spanish Colonial
Early Class. Rev.	Italianate	No Style Listed	Stick/Eastlake
Early Republic	Late 19th & 20th C. Revivals	Octagon Mode	Tudor Revival
Exotic Revival	Late 19th & Early 20th C. Amer. Movements	Other	
Federal		Postmedieval English	

Description: T-plan sev'l + rd pits suggest earlier porch w/ diff config., also sq. bats
corn vet. s
back porch. br fluc

Condition	Demolished	Deteriorated	Excellent	Fair	Good	Good Excellent	Good Fair	N/A	Poor	Rebuilt	Remodeled	Ruinous
Threats to Resource	Demolition	Deterioration	Development	Major Alteration	Neglect	None	None Known	Public Util. Expan.	Relocation	Structural Failure	Trans. Expan.	Vacant
Additions/Alterations	Description											
	<u>rear deck</u>											

George Leetha Carrington.
mother bought it 20 yrs ago fr. -
1 Walter Mr. Poindexter
2 C.
don't know what they did
we've remodeled twice.

1947: Thompson T. "Carrington"

Number of Stories 2 Conditional Individual Resource Superfield Screen
 Interior Plan Type _____
 Accessed? _____ If not, why not? _____
 Denied No Trespassing Not Accessible
 Interior Classification _____

 Relationship of Secondary Resources _____

reconnaissance main screen 6 of 7
 Historic Context

DHR Historic Context(s): Agriculture/Subsistence Architecture/Landscape Architecture/ Community Planning Commerce/Trade Domestic Education	Ethnicity/Immigration Funerary Health Care Industry/Processing/Extraction Landscape Military/Defense	Recreation/Arts Religion Settlement Patterns Social Traffic Engineering Transportation Other
--	---	--

Significance Statement _____

reconnaissance main screen 6 of 7
 Graphic Documentation

Medium	Medium ID #	Frames	Date
2 x 2 B & W photos 4 x 5 B & W photos	B & W 35 mm photos Color 35 mm photos	Historic photos Measured drawings	Slides

Bibliographic Data

Seq. #	Type	Citation
--------	------	----------

Bibliographic Superfield Screen

Sequence #: _____ Bibliographic Record Type: _____ Author: _____
 Citation Abbreviation: _____
 Notes: _____

Bibliographic Superfield Screen

Sequence #: _____ Bibliographic Record Type: _____ Author: _____
 Citation Abbreviation: _____
 Notes: _____

reconnaissance main screen 7 of 7
 Cultural Resource Management Events

Date	CRM Event	Agency/Individual	Assoc. ID#
CRM Event Superfield Screen			
Date: _____	Cultural Resource Management Event: _____		
Organization or Person: _____			
ID# Associated with Event: _____			

Mailing Address Superfield Screen
 HONORIF: _____ Record Created: _____
 FIRST: _____ Last Updated: _____
 LAST: _____
 SUFFIX: _____
 TITLE: _____
 COMPANY: _____ PHONE/EXTENSION: _____
 ADDRESS: _____ STATE: _____
 CITY: _____ COUNTRY: _____
 ZIP: _____

Individual's Category Codes

Informant	Occupant	Owner	Specimens (owner of specimens)	Tenant
Notes				

Surveyor's Notes

Date	Event	Data Processing Events Person
------	-------	----------------------------------

SITE PLAN

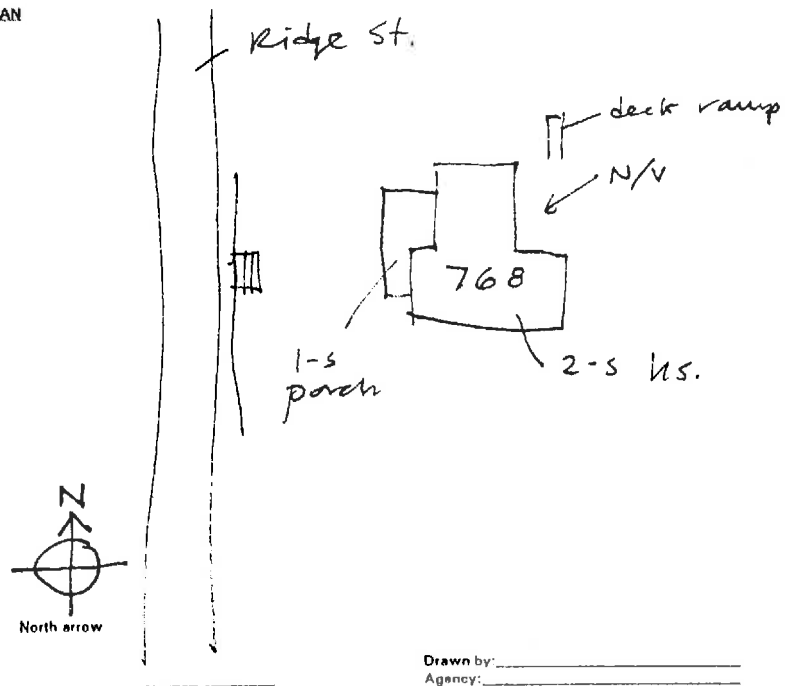

N.T.S.
 Date: _____
 SES: 2/96

Drawn by: _____
 Agency: _____



14629

Date 3.1996

File No. 104-279

Name Carrington House
(768 Ridge St.)

Town _____

County Charlotteville

Photographer Dan Pezani

Contents 3 ext. views
