

MAILING ADDRESS

Honorif:  
First : Ann E.  
Last : Beauford  
Suffix :  
Title :  
Company:

Address: 804 Concord Ave.

City : Charlottesville State: VA  
Zip : 22903- Country: USA  
Phone/extension: 804-977-3057

Individual Category Codes:

Mailing Address Notes:

Surveyor's Notes:

Component	#	Comp Type/Form	Material	Material Treatment
Structural System	0	Frame	Wood	Stucco
Roof	0	Hipped	Asphalt	Shingle
Window(s)	0	Sash, double-hung	Wood	1/1
Porch	0	1-story, 2-bay	Wood	Classical
Dormer	1	Hipped	Asphalt	Shingle

#### INDIVIDUAL RESOURCE INFORMATION

SEQUENCE NUMBER: 1.0 WUZIT: Single Dwelling  
 Primary Resource? Yes  
 Estimated Date of Construction: 1920 ca  
 Source of Date: Site Visit  
 Architectural Style: Bungalow/Craftsman  
 Description:  
 Foursquare form, Craftsman roof, exposed rafter tails, brick flue, 1-story back porch.

Condition: Good-Fair  
 Threats to Resource: None Known

Additions/Alterations Description:

Number of Stories: 2.0  
 Interior Plan Type:  
 Accessed?

Interior Description:

Relationship of Secondary Resources to Property:

DHR Historic Context: Architecture/Community Planning  
 Domestic

Significance Statement:  
 The building contributes to the historic character of Ridge Street.

#### GRAPHIC DOCUMENTATION

Medium	Medium ID #	Frames	Date
B&W 35mm Photos	14799	10 - 11	5/ /1996
B&W 35mm Photos		-	/ /1996

#### BIBLIOGRAPHIC DATA

#### CULTURAL RESOURCE MANAGEMENT EVENTS

Date: / /1996  
 Cultural Resource Management Event: Reconnaissance Survey  
 Organization or Person: J. Daniel Pezzoni, Preservation Con  
 ID # Associated with Event:  
 CRM Event Notes or Comments:

RECONNAISSANCE LEVEL SURVEY REPORT

DEPARTMENT OF HISTORIC RESOURCE  
RECONNAISSANCE SURVEY FORM

*Reviewed by Margaret Peters*

DHR Identification Number: 104-0351

Other DHR Number: Property Date(s) 1920 ca

PROPERTY NAMES	EXPLANATION
House (774 Ridge St.)	Function/Location

County/Independent City: Charlottesville  
State: Virginia  
Magisterial District: N/A

Tax Parcel: 25-89

USGS Quad Map Name: CHARLOTTESVILLE EAST

UTMs of Boundary:  
Center UTM:

Restrict location and UTM data? N

ADDRESSES

Number	Thoroughfare Name	Explanation
774 -	Ridge St.	

Vicinity: Town/Village/Hamlet:

Name of National Register Historic District:

Name of DHR Eligible Historic District:

Name of Local Historic District:

Physical Character of General Surroundings: City

Site Description/Notable Landscape Features:  
Residential, landscaped yard, concrete-block retaining wall along sidewalk.

Ownership: Private NR Resource Type: Building

WUZITS

Seq. #	# of	Wuzit Types	Historic?
1.0	1	Single Dwelling	Historic

TOTAL:	1
Historic:	1
Non-Historic:	0

PRIMARY RESOURCE EXTERIOR COMPONENT DESCRIPTION

PARCEL I.D. 25 - 89. PROPERTY ADDRESS 774 RIDGE STREET  
NEIGHBORHOOD NUMBER 9 LEGAL DESCRIPTION PT LOT

\*\*\* OWNER INFORMATION \*\*\*

\*\*\* DEED INFORMATION \*\*\*

NAME BEAUFORD ANN E  
ADDRESS 804 CONCORD AVE  
CHARLOTTESVILLE, VA 22903

BOOK 461  
PAGE 691  
TAXABLE

\*\*\*\*\* MISCELLANEOUS INFORMATION \*\*\*\*\*

PROP CLASS ONE FAMILY	LIVING AREA	1108	LOT AREA SQ.FT.	5053
ZONING R3	PERIMETER	96	LOT AVERAGE WIDTH	25
OVLP. ZONE	DWELLING UNITS	1	LOT AVERAGE DEPTH	175
LAND USE 1101	CENSUS TRACT	401133	PROPERTY - ACRES	.116
EQ. BD. YR	EQ. BD. ACT.		PICTURE	YES

\*\*\*\*\* PRIMARY STRUCTURE \*\*\*\*\*

YEAR BUILT 1925	EFF YEAR 1947	CONSTRUCTION	STUCCO WOOD FRAME
GRADE AVERAGE	PCT. ADJ. 20	STORIES	2.0
TYPE STANDARD UNIT		BASEMENT	NO ATTIC NO
CONDITION AVERAGE		AREA SQ. FT.	554

PLEASE ENTER IN YOUR INFORMATION THEN PRESS enter OR PRESS f7 TO EXIT.

[ ]

Number of Stories 2 Conditional Individual Resource Superfield Screen  
 Interior Plan Type \_\_\_\_\_  
 Accessed? \_\_\_\_\_

If not, why not?  
 Denied No Trespassing Not Accessible

Interior Description  
 \_\_\_\_\_  
 \_\_\_\_\_  
 \_\_\_\_\_

Relationship of Secondary Resources  
 \_\_\_\_\_  
 \_\_\_\_\_

recognition main screen 6 of 7  
 Historic Context

- |   |                                |                     |
|---|--------------------------------|---------------------|
| DHR Historic Context(s):                                | Ethnicity/Immigration          | Recreation/Arts     |
| Agriculture/Subsistence                                 | Funerary                       | Religion            |
| Architecture/Landscape Architectural/Community Planning | Health Care                    | Settlement Patterns |
| Commerce/Trade  | Industry/Processing/Extraction | Social              |
| Domestic  | Landscape                      | Traffic Engineering |
| Education   | Military/Defense               | Transportation      |
|   |                                | Other               |
- Significance Statement  
 \_\_\_\_\_  
 \_\_\_\_\_

recognition main screen 6 of 7  
 Graphic Documentation

Medium*	Medium ID #	Frame	Date
* 2 x 2 B & W photos 4 x 5 B & W photos	B & W 35 mm photos Color 35 mm photos	Historic photos Measured drawings	Slides

Seq. #	Type	Bibliographic Data Citation

Bibliographic Superfield Screen  
 Sequence #: \_\_\_\_\_ Bibliographic Record Type: \_\_\_\_\_ Author: \_\_\_\_\_  
 Citation Abbreviation: \_\_\_\_\_  
 Notes: \_\_\_\_\_

Bibliographic Superfield Screen  
 Sequence #: \_\_\_\_\_ Bibliographic Record Type: \_\_\_\_\_ Author: \_\_\_\_\_  
 Citation Abbreviation: \_\_\_\_\_  
 Notes: \_\_\_\_\_

Date	CRM Event	Cultural Resource Management Event Agency/Individual	Assoc. ID#

CRM Event Superfield Screen  
 Date: \_\_\_\_\_ Cultural Resource Management Event:  
 Organization or Person: \_\_\_\_\_  
 ID# Associated with Event: \_\_\_\_\_

Notes or Comments

Mailing Address Superfield Screen  
 Record Created: \_\_\_\_\_  
 Last Updated: \_\_\_\_\_

HONORIF: \_\_\_\_\_  
 FIRST: \_\_\_\_\_  
 LAST: \_\_\_\_\_  
 SUFFIX: \_\_\_\_\_  
 TITLE: \_\_\_\_\_  
 COMPANY: \_\_\_\_\_  
 ADDRESS: \_\_\_\_\_  
 CITY: \_\_\_\_\_  
 ZIP: \_\_\_\_\_

PHONE/EXTENSION:  
 STATE: \_\_\_\_\_  
 COUNTRY: \_\_\_\_\_

Individual's Category Codes  
 Informant Occupant Owner Specimens (owner of specimens) Tenant  
 Notes

Surveyor's Notes  
 \_\_\_\_\_  
 \_\_\_\_\_

Date	Event	Data Processing Events Person

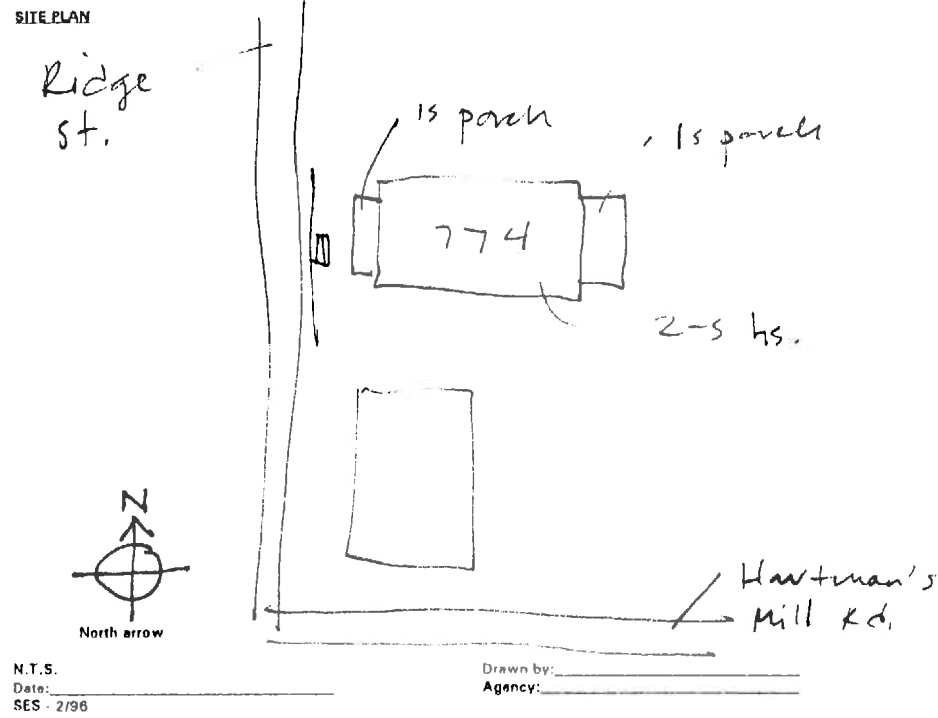

351

reconnaissance main screen 1 of 7

Where is data filed at DHR? \_\_\_\_\_  
 DHR Idem # \_\_\_\_\_ Property date(s) \_\_\_\_\_  
 Other DHR no. \_\_\_\_\_  
 Property Name(s) \_\_\_\_\_  
 Seq # \_\_\_\_\_ Name HS Explanation\* \_\_\_\_\_

Address	Alternate spelling	Former/current	Historic/location	Original
Address-current	Current	Function/location	Location	VLR listing
Alleged	Descriptive	Historic	NHL listing	
Alternate name	Former	Historic/current	NRHP listing	
				25-89

County/Ind. City \_\_\_\_\_ Tax Parcel Number \_\_\_\_\_  
 State VA Virginia \_\_\_\_\_  
 Maga'l District \_\_\_\_\_  
 USGS Quad Map Name \_\_\_\_\_ UTMs of Boundary \_\_\_\_\_  
 Center UTM - Zone/East/North \_\_\_\_\_

reconnaissance main screen 2 of 7

Restrict Location and UTM data? \_\_\_\_\_

#	# Suffix	Thoroughfare Name	Address	Explanation
	774	Ridge		

Address Superfield Screen \_\_\_\_\_  
 Address Explanation \_\_\_\_\_  
 Sequence Number \_\_\_\_\_  
 Main Street Number \_\_\_\_\_  
 Number Suffix \_\_\_\_\_  
 Street Name \_\_\_\_\_  
 Alternate \_\_\_\_\_ Name Change \_\_\_\_\_  
 Current \_\_\_\_\_ Number Change \_\_\_\_\_

Neighborhood/Village/Hamlet \_\_\_\_\_  
 Name of National Register Historic District \_\_\_\_\_  
 Name of YDHR Eligible Historic District \_\_\_\_\_  
 Name of Local Historic District \_\_\_\_\_

reconnaissance main screen 3 of 7

Physical Character of General Surroundings \_\_\_\_\_  
 City \_\_\_\_\_ Hamlet \_\_\_\_\_ Rural \_\_\_\_\_ Suburban \_\_\_\_\_ Town \_\_\_\_\_ Village \_\_\_\_\_

Site Description/Notable Landscape Features \_\_\_\_\_  
Resil, conc br set wall

Ownership \_\_\_\_\_ NR Resource Type \_\_\_\_\_  
 F Public-Federal \_\_\_\_\_ P Private \_\_\_\_\_  
 L Public-Local \_\_\_\_\_ S Public-State \_\_\_\_\_  
 B Building \_\_\_\_\_ S Site \_\_\_\_\_  
 D District \_\_\_\_\_ U Structure \_\_\_\_\_  
 O Object \_\_\_\_\_

Seq #	# of	Wuzit Count	Wuzit Types	Historic?*	Total

\* Historic Non Historic Undetermined

Component	#	Comp. Type/Form	Material	Material Treatment
chimney(s)				
columns				
cornice	1	hip	ash p	staining
dormer(s)				
foundation	NV	1-5 2-6	wd	discol
porch		hip pr	ash p	staining
roof		6/6	stucco	veg texture
walls			wd	
windows				

Individual Resource Information

Seq #	Wuzit	Primary?	Date Built

Individual Resource Superfield Screen \_\_\_\_\_  
 Sequence Number \_\_\_\_\_ Wuzit \_\_\_\_\_  
 Primary Resource? \_\_\_\_\_  
 Estimated Date of Construction \_\_\_\_\_ Source of Data \_\_\_\_\_  
 Architectural Style \_\_\_\_\_

Art Deco	French Colonial	Late Gothic Revival	Prairie School
Beaux Arts	French Renaissance	Late Victorian	Pueblo
Bungalow/Craftsman	Georgian	Mid-19th C.	Queen Anne
Chicago	Gothic	Mission/Spanish	Renaissance
Classical Revival	Gothic Revival	Colonial Revival	Romanesque
Colonial	Greek Revival	Mixed (more than 3 styles from different periods)	Second Empire
Colonial Revival	International Style		Shingle Style
Commercial Style	Italian Renaissance	Modern Movement	Skyscraper
Dutch Colonial	Italian Villa	Moderno	Spanish Colonial
Early Class. Rev.	Italianate	No Style Listed	Stick/Eastlake
Early Republic	Late 19th & 20th C. Revivals	Octagon Mode	Tudor Revival
Exotic Revival	Late 19th & Early 20th C. Amer. Movements	Other	
Federal		Postmedieval English	

panels hip rt br piers w conc br  
 in fill, expd raft ends  
 1-5 back porch br blue

Condition	Excellent	Good	Good-Fair	Poor	Remodeled
Damished	Fair	Good-Excellent	N/A	Rebuilt	Ruinous

Threats to Resource \_\_\_\_\_  
 Demolition \_\_\_\_\_ Development \_\_\_\_\_ Neglect \_\_\_\_\_ None Known \_\_\_\_\_ Relocation \_\_\_\_\_ Trans. Expan. \_\_\_\_\_  
 Deterioration \_\_\_\_\_ Major Alteration \_\_\_\_\_ None \_\_\_\_\_ Public Util. Expan. \_\_\_\_\_ Structural Failure \_\_\_\_\_ Vacant \_\_\_\_\_

Additions/Alterations Description

\_\_\_\_\_

\_\_\_\_\_

104-351

CITY OF CHARLOTTESVILLE



SCALE : 1" = 100'

SECTION 25



14799

Date 5.1996 File No. 104-351

Name House (774 Ridge St.)

Town \_\_\_\_\_

County Charlotteville

Photographer Dan Reznick

Contents 2 ext. views

\_\_\_\_\_  
\_\_\_\_\_  
\_\_\_\_\_