

CULTURAL RESOURCE MANAGEMENT EVENTS

Date: / /1996

Cultural Resource Management Event: Reconnaissance Survey

Organization or Person: J. Daniel Pezzoni, Preservation Con

ID # Associated with Event:

CRM Event Notes or Comments:

MAILING ADDRESS

Honorif:

First : James R. & Elizabeth

Last : Gohaner

Suffix :

Title :

Company:

Address: 803 Ridge St.

City : Charlottesville

State: VA

Zip : 22901- Country: USA

Phone/extension:

Individual Category Codes:

Mailing Address Notes:

Surveyor's Notes:

RECONNAISSANCE LEVEL SURVEY REPORT

DEPARTMENT OF HISTORIC RESOURCE
RECONNAISSANCE SURVEY FORM

Reviewed by Margaret Peters

DHR Identification Number: 104-0355

Other DHR Number:

Property Date(s) 1944

PROPERTY NAMES
House (803 Ridge St.)

EXPLANATION
Function/Location

County/Independent City: Charlottesville
State: Virginia
Magisterial District: N/A

Tax Parcel: 25-26

USGS Quad Map Name: CHARLOTTESVILLE EAST

UTMs of Boundary:
Center UTM:

Restrict location and UTM data? N

ADDRESSES

Number	Thoroughfare Name	Explanation
803 -	Ridge St.	

Vicinity: Town/Village/Hamlet:

Name of National Register Historic District:

Name of DHR Eligible Historic District:

Name of Local Historic District:

Physical Character of General Surroundings: City

Site Description/Notable Landscape Features:
Residential, landscaped yard, decorative concrete-block wall along sidewalk with pebble coping and piers flanking walk and driveway entrance.

Ownership: Private NR Resource Type: Building

WUZITS

Seq. #	# of	Wuzit Types	Historic?
1.0	1	Single Dwelling	Historic

TOTAL: 1
 Historic: 1
 Non-Historic: 0

PRIMARY RESOURCE EXTERIOR COMPONENT DESCRIPTION

Component	#	Comp Type/Form	Material	Material Treatment
Structural System	0	Masonry	Concrete	Block
Roof	0	Gable: side	Asphalt	Shingle
Window(s)	0	Sash, double-hung	Wood	6/6
Porch	0	1-story, 3-bay	Brick	Pier
Foundation	0	Masonry	Concrete	Block

INDIVIDUAL RESOURCE INFORMATION

SEQUENCE NUMBER: 1.0
 Primary Resource? Yes
 Estimated Date of Construction: 1944
 Source of Date: Local Records
 Architectural Style: No Style Listed
 Description:
 Light parging over walls, center supports of porch combine brick piers with slender metal poles, concrete-block flue.

WUZIT: Single Dwelling

Condition: Good
 Threats to Resource: None Known

Additions/Alterations Description:
 Rear deck.

Number of Stories: 1.0
 Interior Plan Type:
 Accessed?

Interior Description:

Relationship of Secondary Resources to Property:

DHR Historic Context: Architecture/Community Planning
 Domestic

Significance Statement:
 The building contributes to the historic character of Ridge Street. Its concrete-block construction probably reflects its war-time date of construction.

GRAPHIC DOCUMENTATION

Medium	Medium ID #	Frames	Date
B&W 35mm Photos	14799	19 - 20	5/ /1996
B&W 35mm Photos		-	/ /1996

BIBLIOGRAPHIC DATA

Sequence #: 1.0 Bibliographic Record Type: Local Records
 Author: City of Charlottesville
 Citation Abbreviation:
 Tax parcel data base
 Notes:

PARCEL I.D. 25 - 26. PROPERTY ADDRESS 803 RIDGE STREET
NEIGHBORHOOD NUMBER 9 LEGAL DESCRIPTION LOT 2

*** OWNER INFORMATION ***

NAME GOHANER JAMES R & ELIZABETH L
ADDRESS 803 RIDGE STREET
CHARLOTTESVILLE, VA 22902

*** DEED INFORMATION ***

BOOK 130
PAGE 474
TAXABLE

***** MISCELLANEOUS INFORMATION *****

PROP CLASS ONE FAMILY	LIVING AREA	685	LOT AREA SQ.FT.	7500
ZONING 1A	PERIMETER	105	LOT AVERAGE WIDTH	50
OVLP. ZONE	DWELLING UNITS	1	LOT AVERAGE DEPTH	150
LAND USE 1101	CENSUS TRACT	401128	PROPERTY - ACRES	.172
EQ. BD. YR	EQ. BD. ACT.		PICTURE	NO

***** PRIMARY STRUCTURE *****

YEAR BUILT 1944	EFF YEAR 1971	CONSTRUCTION	CONCRETE BLOCK
GRADE AVERAGE	PCT. ADJ. 10	STORIES	1.0
TYPE STANDARD UNIT		BASEMENT	YES ATTIC NO
CONDITION AVERAGE		AREA SQ. FT.	685

[]

PLEASE ENTER IN YOUR INFORMATION THEN PRESS enter OR PRESS f7 TO EXIT.

Number of Stories 1 Conditional Individual Resource Superfield Screen
 Interior Plan Type _____
 Accessed? _____ If not, why not? _____
 Denied No Trespassing Not Accessible
 Interior Description _____

Relationship of Secondary Resources _____

 reconnaissance main screen 5 of 7
 Historic Context

DHR Historic Context(s):
 Agriculture/Subsistence Ethnicity/Immigration Recreation/Arts
 Architecture/Landscape Architecture/ Funerary Religion
 Community Planning Health Care Settlement Patterns
 Commerce/Trade Industry/Processing/Extraction Social
 Domestic Landscape Traffic Engineering
 Education Military/Defense Transportation
 Other

Significance Statement _____

reconnaissance main screen 6 of 7
 Graphical Documentation

Medium*	Medium ID #	Frame	Date
2 x 2 B & W photos	B & W 35 mm photos	Historic photos	Slides
4 x 5 B & W photos	Color 35 mm photos	Measured drawings	

Bibliographic Data
 Seq. # _____ Type _____ Citation _____

Bibliographic Superfield Screen
 Sequence #: _____ Bibliographic Record Type: _____ Author: _____
 Citation Abbreviation: _____ Notes: _____

Bibliographic Superfield Screen
 Sequence #: _____ Bibliographic Record Type: _____ Author: _____
 Citation Abbreviation: _____ Notes: _____

reconnaissance main screen 7 of 7
 Cultural Resource Management Events
 Agency/Individual Assoc. ID# _____
 CBM Event Superfield Screen
 Date: _____ Cultural Resource Management Event: _____
 Organization or Person: _____
 ID# Associated with Event: _____

Notes or Comments

Mailing Address Superfield Screen
 HONORIF: _____ Record Created: _____
 FIRST: _____ Last Updated: _____
 LAST: _____
 SUFFIX: _____
 TITLE: _____
 COMPANY: _____ PHONE/EXTENSION: _____
 ADDRESS: _____ STATE: _____
 CITY: _____ COUNTRY: _____
 ZIP: _____
 Individual's Category Codes
 Informant Occupant Owner Specimens (owner of specimens) Tenant
 Notes

Surveyor's Notes _____

Date Processing Events
 Date Event Person

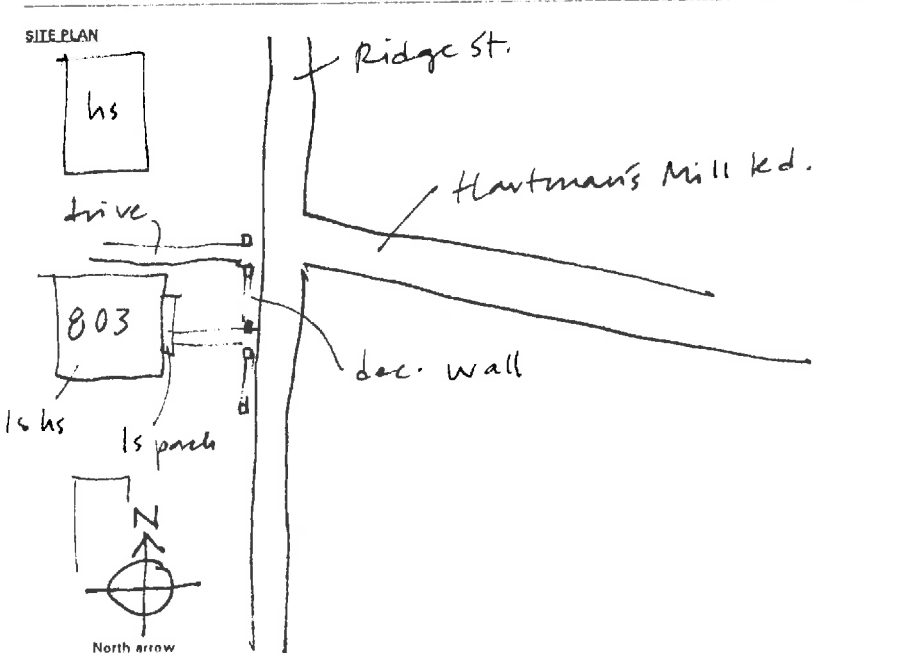

N.T.S.
 Date: _____
 SES - 2/96
 Drawn by: _____
 Agency: _____

355

reconnaissance main screen 1 of 2

Where is data tied at DIRM? _____
 DIRM iden. # _____ Property details _____
 Other DIRM no. _____

Seq. #	Name	Property Names	Explanation*
--------	------	----------------	--------------

Address	Alternate spelling	Former/current	Historic/location	Original
Address-current	Current	Function/location	Location	VLR listing
Alternate name	Former	Historic	NHL listing	
		Historic/current	NRHP listing	

County/ind. City _____ Tax Parcel Number 25-26
 State VA Virginia
 Magis'l District _____
 USGS Quad Map Name _____ UTM's of Boundary 1 1
 Center UTM-Zone/East/North _____

reconnaissance main screen 2 of 2

Restrict Location and UTM data? _____
 # 1 Suffix Thoroughfare Name 803 Ridge Address _____ Explanation _____

Sequence Number	Address Superfield Screen	Address Explanation	Alternate	Name Change
Main Street Number			Current	Number Change
Number Suffix				
Street Name				

Vicinity of: _____ Town/Village/Hamlet _____

Name of National Register Historic District _____

Name of VDHR Eligible Historic District _____

Name of Local Historic District _____

reconnaissance main screen 3 of 2

Physical Character of General Surroundings
 City _____ Hamlet _____ Rural _____ Suburban _____ Town _____ Village _____

Site Description/Notable Landscape Features
loc. ~~and~~ concrete bl. wall along walk w/ rock coping,
walk + driveway piers 15x20 ft yd

Ownership _____ NR Resource Type _____
 F Public-Federal P Private B Building S Site
 L Public-Local S Public-State D District U Structure
 O Object

Seq. #	# of	Worth Count	Worth Types	Historic?*	Total
					Historic
					Non-Historic
*		Historic	Non-Historic	Undetermined	

reconnaissance main screen 4 of 2

Primary Resource? Exterior Component Description

Component	Material	Material Treatment
columns		
cornice		
door(s)		
foundation	<u>concr</u>	<u>bl</u>
porch	<u>1-1/2" x 1-1/2" (sdc) br</u>	<u>staining</u>
roof	<u>gla</u>	<u>bl.</u>
walls	<u>concr</u>	<u>bl.</u>
windows	<u>tile</u>	<u>bl.</u>

Individual Resource Information

Seq. #	Worth	Primary?	Date Built
--------	-------	----------	------------

Individual Resource Superfield Screen

Sequence Number _____ Worth _____
 Primary Resource? _____
 Estimated Date of Construction _____ Source of Date _____

Architectural Style	French Colonial	Late Gothic Revival	Prairie School
Art Deco	French Renaissance	Late Victorian	Public
Beaux Arts	Georgian	Mid-19th C.	Queen Anne
Bungalow/Craftsman	Gothic	Mission/Spanish	Renaissance
Chicago	Gothic Revival	Colonial Revival	Romantic
Classical Revival	Greek Revival	Mixed (more than 3 styles from different periods)	Second Empire
Colonial	International Style	Modern Movement	Shingle Style
Colonial Revival	Italian Renaissance	Modern	Skyscraper
Commercial Style	Italianate	No Style Listed	Spanish Colonial
Dutch Colonial	Early Class. Rev.	Octagon Mode	Stick/Eastlake
Early Class. Rev.	Late 19th & 20th C. Revivals	Other	Tudor Revival
Early Republic	Late 19th & Early 20th C. Amer. Movements	Postmedieval English	
Exotic Revival			
Federal			

pared conc bl. walls metal poles, conc bl. piers
bl. masonry
concrete

Condition	Excellent	Good	Good-Fair	Poor	Remodeled
Demolished	Fair	Good	Good-Excellent	Rebuilt	Ruinous
Deteriorated			N/A		

Threats to Resource	Development	Neglect	None Known	Relocation	Trans. Expan.
Demolition	Major Alteration	None	Public Util. Expan.	Structural Failure	Vacant
Deterioration					

Additional/Alterations Description

CITY OF CHARLOTTESVILLE





14799

Date 5.19.96 File No. 104-355

Name House (803 Ridge St.)

Town _____

County Charlotteville

Photographer Dan Pezzoni

Contents 2 ext. views
