

RECONNAISSANCE LEVEL SURVEY REPORT

DEPARTMENT OF HISTORIC RESOURCE  
RECONNAISSANCE SURVEY FORM

*Reviewed by Margaret Peters*

DHR Identification Number: 104-0283

Other DHR Number: Property Date(s) 1979

PROPERTY NAMES	EXPLANATION
House (824 Ridge St.)	Function/Location

County/Independent City: Charlottesville  
 State: Virginia  
 Magisterial District: N/A Tax Parcel: 25-104

USGS Quad Map Name: CHARLOTTESVILLE EAST

UTMs of Boundary:  
Center UTM:

Restrict location and UTM data? N

ADDRESSES

Number	Thoroughfare Name	Explanation
824 -	Ridge St.	

Vicinity: Town/Village/Hamlet:

Name of National Register Historic District:

Name of DHR Eligible Historic District:

Name of Local Historic District:

Physical Character of General Surroundings: City

Site Description/Notable Landscape Features:  
Residential.

Ownership: Private NR Resource Type: Building

WUZITS

Seq. #	# of	Wuzit Types	Historic?
1.0	1	Single Dwelling	Non-historic

TOTAL: 1  
 Historic: 0  
 Non-Historic: 1

PRIMARY RESOURCE EXTERIOR COMPONENT DESCRIPTION

Component	#	Comp Type/Form	Material	Material Treatment
Structural System	0	Frame	Wood	Weatherboard
Roof	0	Gable: side	Asphalt	Shingle
Window(s)	0	Sash, double-hung	Metal	2/2
Foundation	0	Masonry	Concrete	Block

INDIVIDUAL RESOURCE INFORMATION

SEQUENCE NUMBER: 1.0 WUZIT: Single Dwelling  
 Primary Resource? Yes  
 Estimated Date of Construction: 1979  
 Source of Date: Local Records  
 Architectural Style: Modern Movement  
 Description:  
 Ranch form, T1-11 on gable ends, small concrete-block front stoop, picture window, rear deck.

Condition: Good  
 Threats to Resource: None Known

Additions/Alterations Description:

Number of Stories: 1.0  
 Interior Plan Type:  
 Accessed?

Interior Description:

Relationship of Secondary Resources to Property:

DHR Historic Context: Architecture/Community Planning  
 Domestic

Significance Statement:  
 The building does not contribute to the historic character of Ridge Street.

GRAPHIC DOCUMENTATION

Medium	Medium ID #	Frames	Date
B&W 35mm Photos	14629	32 - 33	3/ /1996
B&W 35mm Photos		-	/ /1996

BIBLIOGRAPHIC DATA

Sequence #: 1.0 Bibliographic Record Type: Local Records  
 Author: City of Charlottesville  
 Citation Abbreviation:  
 Tax parcel data base  
 Notes:

CULTURAL RESOURCE MANAGEMENT EVENTS

Date: / /1996

Cultural Resource Management Event: Reconnaissance Survey  
Organization or Person: J. Daniel Pezzoni, Preservation Con  
ID # Associated with Event:  
CRM Event Notes or Comments:

MAILING ADDRESS

Honorif:  
First : Andre A.  
Last : Lewis  
Suffix :  
Title :  
Company:

Address: 824 Ridge St.

City : Charlottesville State: VA  
Zip : 22902- Country: USA  
Phone/extension:

Individual Category Codes:

Mailing Address Notes:

Surveyor's Notes:

CITY OF CHARLOTTESVILLE



SCALE : 1" = 100'

283

Where is data filed at DHR? reconnaissance main screen 1 of 2  
 DHR Idem # \_\_\_\_\_ Property date(s) \_\_\_\_\_  
 Other DHR no. \_\_\_\_\_

Seq. # HS Name \_\_\_\_\_ Property Names \_\_\_\_\_ Explanation\* \_\_\_\_\_

Address	Alternate spelling	Former/current	Historic/location	Original
Address-current	Current	Function/location	Location	VLR listing
Alleged	Descriptive	Historic	NHL listing	
Alternate name	Former	Historic/current	NRHP listing	

County/Ind. City \_\_\_\_\_ Tax Parcel Number 25-104  
 State VA Virginia  
 Major District \_\_\_\_\_  
 USGS Quad Map Name \_\_\_\_\_ UTM's of Boundary \_\_\_\_\_  
 Center UTM-Zone/East/North \_\_\_\_\_

Restrict Location and UTM data? reconnaissance main screen 2 of 2

#	# Suffix, Thoroughfare Name	Address	Explanation
	<u>824</u>	<u>Bridge</u>	

Address Superfield Screen \_\_\_\_\_  
 Address Explanation \_\_\_\_\_  
 Alternate \_\_\_\_\_ Name Change \_\_\_\_\_  
 Current \_\_\_\_\_ Number Change \_\_\_\_\_

Vicinity of: \_\_\_\_\_ Town/Village/Hamlet \_\_\_\_\_

Name of National Register Historic District \_\_\_\_\_  
 Name of VDHR Eligible Historic District \_\_\_\_\_  
 Name of Local Historic District \_\_\_\_\_

Physical Character of General Surroundings reconnaissance main screen 3 of 2  
 City \_\_\_\_\_ Hamlet \_\_\_\_\_ Rural \_\_\_\_\_ Suburban \_\_\_\_\_ Town \_\_\_\_\_ Village \_\_\_\_\_

Site Description/Notable Landscape Features ves

Ownership \_\_\_\_\_ NR Resource Type \_\_\_\_\_  
 F Public-Federal P Private B Building S Site  
 L Public-Local S Public-State D District U Structure  
 O Object

Seq. #	# of	Wuzit Count	Wuzit Types	Historic*

Total \_\_\_\_\_  
 Historic \_\_\_\_\_  
 Non-Historic \_\_\_\_\_

Component	Material	Material Treatment
chimney/fl		
columns		
cornice		
dormer(s)		
foundation	<u>concr</u>	<u>concr</u>
porch		
roof	<u>gab (side)</u>	<u>asph</u>
walls	<u>fr</u>	<u>mac brick (?)</u>
windows	<u>double</u>	<u>brick</u>

Seq. # \_\_\_\_\_ Wuzit \_\_\_\_\_ Individual Resource Information  
 Primary? \_\_\_\_\_ Date Built \_\_\_\_\_

Sequence Number	Wuzit	Source of Date
Primary Resource?		
Estimated Date of Construction		
Architectural Style		
Art Deco	French Colonial	Late Gothic Revival
Beaux Arts	French Renaissance	Late Victorian
Bungalow/Craftsman	Georgian	Mid-19th C.
Chicago	Gothic	Mission/Spanish
Classical Revival	Gothic Revival	Colonial Revival
Colonial	Greek Revival	Mixed (more than 3 styles
Colonial Revival	International Style	from different periods)
Commercial Style	Italian Renaissance	Modern Movement
Dutch Colonial	Italian Villa	Moderns
Early Class. Rev.	Italianate	No Style Listed
Early Republic	Late 19th &	Octagon Mode
Exotic Revival	20th C. Revivals	Other
Federal	Late 19th & Early	Postmedieval English
	20th C. Amer.	
	Movements	

ca. 1750? picture window  
conc. front stoop, rear deck

Condition	Excellent	Good	Good-Fair	Poor	Rehabilitated
Demolished	Fair	Good-Excellent	N/A	Rebuilt	Removes
Deteriorated					

Threats to Resource \_\_\_\_\_  
 Demolition Development Neglect None Known Relocation Trans. Expan.  
 Deterioration Major Alteration None Public Util. Expan. Structural Failure Vacant

Additions/Alterations Description 2  
H-11 siding on gab ends

Number of Stories \_\_\_\_\_ / **Conditional Individual Resource Superfield Screen**

Interior Plan Type \_\_\_\_\_  
 Accessed? \_\_\_\_\_

If not, why not?  
 Denied \_\_\_\_\_ No Trespassing \_\_\_\_\_ Not Accessible \_\_\_\_\_

**Interior Description**

\_\_\_\_\_

\_\_\_\_\_

**Relationship of Secondary Resources**

\_\_\_\_\_

**reconnaissance main screen 6 of 7**  
**Historic Context**

DHR Historic Context(s): Agriculture/Subsistence Architecture/Landscape Architecture/ Community Planning Commerce/Trade Domestic Education	Ethnicity/Immigration Funerary Health Care Industry/Processing/Extraction Landscape Military/Defense	Recreation/Arts Religion Settlement Patterns Social Traffic Engineering Transportation Other
--	---	--

**Significance Statement**

\_\_\_\_\_

**reconnaissance main screen 6 of 7**  
**Graphic Documentation**

Medium#	Medium ID #	Frame#	Date
2 x 2 B & W photos	B & W 35 mm photos	Historic photos	Slides
4 x 5 B & W photos	Color 35 mm photos	Measured drawings	

**Bibliographic Data**

Seq. # \_\_\_\_\_ Type \_\_\_\_\_ Citation \_\_\_\_\_

**Bibliographic Superfield Screen**

Sequence #: \_\_\_\_\_ Bibliographic Record Type: \_\_\_\_\_ Author: \_\_\_\_\_  
 Citation Abbreviation: \_\_\_\_\_

Notes: \_\_\_\_\_

**Bibliographic Superfield Screen**

Sequence #: \_\_\_\_\_ Bibliographic Record Type: \_\_\_\_\_ Author: \_\_\_\_\_  
 Citation Abbreviation: \_\_\_\_\_

Notes: \_\_\_\_\_

**reconnaissance main screen 7 of 7**  
**Cultural Resource Management Events**  
**Agency/Individual**

Date	CRM Event	Assoc. ID#
_____	_____	_____

**CRM Event Superfield Screen**

Date: \_\_\_\_\_ Cultural Resource Management Event: \_\_\_\_\_  
 Organization or Person: \_\_\_\_\_  
 ID# Associated with Event: \_\_\_\_\_

**Notes or Comments**

**Mailing Address Superfield Screen**

HONORIF: \_\_\_\_\_ Record Created: \_\_\_\_\_  
 FIRST: \_\_\_\_\_ LAST Updated: \_\_\_\_\_  
 LAST: \_\_\_\_\_  
 SUFFIX: \_\_\_\_\_  
 TITLE: \_\_\_\_\_  
 COMPANY: \_\_\_\_\_ PHONE/EXTENSION: \_\_\_\_\_  
 ADDRESS: \_\_\_\_\_ STATE: \_\_\_\_\_  
 CITY: \_\_\_\_\_ COUNTRY: \_\_\_\_\_  
 ZIP: \_\_\_\_\_

**Individual's Category Codes**

Informant	Occupant	Owner	Specimens (owner of specimens)	Tenant
-----------	----------	-------	--------------------------------	--------

**Notes**

**Surveyor's Notes**

\_\_\_\_\_

**Data Processing Events**

Date	Event	Person
------	-------	--------

**SITE PLAN**

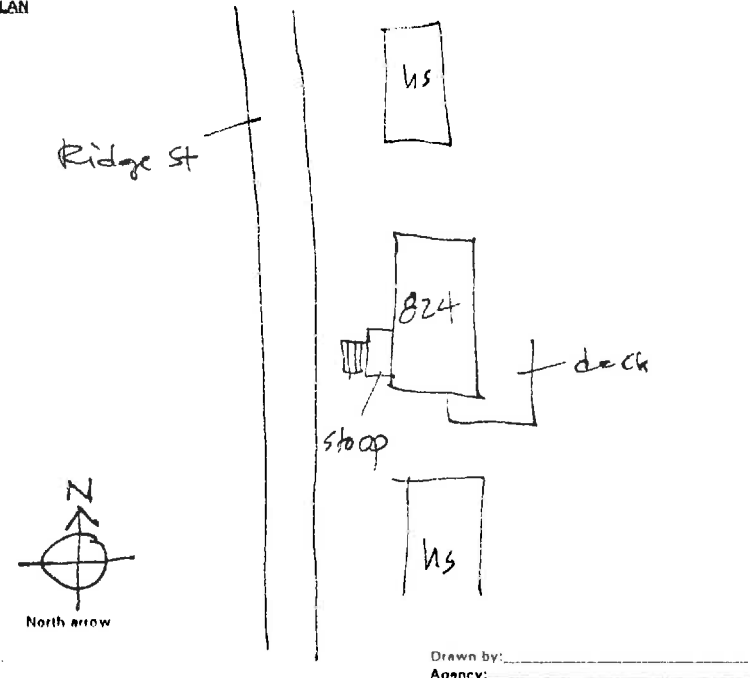

N.T.S.  
 Date: \_\_\_\_\_  
 SES: 2/98

Drawn by: \_\_\_\_\_  
 Agency: \_\_\_\_\_



14629

Date 3, 1996 File No. 104-283

Name House (824 Ridge St.)

Town \_\_\_\_\_

County Charlottesville

Photographer Dan Pezzoni

Contents 2 ext. views

\_\_\_\_\_  
\_\_\_\_\_