

RECONNAISSANCE LEVEL SURVEY REPORT

DEPARTMENT OF HISTORIC RESOURCE
RECONNAISSANCE SURVEY FORM

Reviewed by Margaret Peters

DHR Identification Number: 104-0285

Other DHR Number:

Property Date(s) 1920

PROPERTY NAMES

Wrenn House (832 Ridge St.)

EXPLANATION

Historic/Location

County/Independent City: Charlottesville

State: Virginia

Magisterial District: N/A

Tax Parcel: 25-107

USGS Quad Map Name: CHARLOTTESVILLE EAST

UTMs of Boundary:

Center UTM:

Restrict location and UTM data? N

ADDRESSES

Number

Thoroughfare Name

Explanation

832 -

Ridge St.

Vicinity:

Town/Village/Hamlet:

Name of National Register Historic District:

Name of DHR Eligible Historic District:

Name of Local Historic District:

Physical Character of General Surroundings: City

Site Description/Notable Landscape Features:

Residential, hedge along south property line.

Ownership: Private

NR Resource Type: Building

WUZITS

Seq. #

of

Wuzit Types

Historic?

1.0

1

Single Dwelling

Historic

2.0

1

Shed

Non-historic

3.0

1

Other

Non-historic

TOTAL: 3

Historic: 1

Non-Historic: 2

PRIMARY RESOURCE EXTERIOR COMPONENT DESCRIPTION

Component	#	Comp Type/Form	Material	Material Treatment
Structural System	0	Frame	Vinyl	
Roof	0	Hipped	Asphalt	Shingle
Window(s)	0	Sash, double-hung	Wood	6/1
Porch	0	1-story, 5-bay	Brick	Pier
Foundation	0	Masonry	Stone	Pier
Chimney	1	Interior	Metal	

INDIVIDUAL RESOURCE INFORMATION

SEQUENCE NUMBER: 1.0

WUZIT: Single Dwelling

Primary Resource? Yes

Estimated Date of Construction: 1920

Source of Date: Local Records

Architectural Style: No Style Listed

Description:

House has boxy, two- or three-room-deep form, small gable with rectangular louvered vent on front, shaped rafter tails.

Condition: Good

Threats to Resource: None Known

Additions/Alterations Description:

Porch is a later reworking with round wood colonnettes above brick piers and with brick lattice infill between piers. Other later features include aluminum awnings over the south elevation windows and infill between the foundation piers.

Number of Stories: 1.0

Interior Plan Type:

Accessed?

Interior Description:

Relationship of Secondary Resources to Property:

Behind the house stands small gabled shed that appears to be modern but may be a reworking of an earlier building. On the north side is a small modern pergola.

DHR Historic Context: Architecture/Community Planning
Domestic

Significance Statement:

The building contributes to the historic character of Ridge Street. According to local tax records, the house was built in 1920. Its original owner was apparently Tom Wrenn.

GRAPHIC DOCUMENTATION

Medium	Medium ID #	Frames	Date
B&W 35mm Photos	14629	36 - 37	3/ /1996
B&W 35mm Photos	14630	17 - 18	3/ /1996
	14820	34	6 1996

BIBLIOGRAPHIC DATA

Sequence #: 1.0 Bibliographic Record Type: Local Records
Author: City of Charlottesville
Citation Abbreviation:
Tax parcel data base
Notes:

Sequence #: 2.0 Bibliographic Record Type: Oral History
Author: Ross, John
Citation Abbreviation:
Interview, Charlottesville, VA, March 1996.
Notes:

CULTURAL RESOURCE MANAGEMENT EVENTS

Date: / /1996
Cultural Resource Management Event: Reconnaissance Survey
Organization or Person: J. Daniel Pezzoni, Preservation Con
ID # Associated with Event:
CRM Event Notes or Comments:

MAILING ADDRESS

Honorif:
First : Ayuko C.
Last : Yotsukura
Suffix :
Title :
Company:

Address: 832 Ridge St.

City : Charlottesville State: VA
Zip : 22901- Country: USA
Phone/extension: 804-296-1034

Individual Category Codes:

Mailing Address Notes:

Surveyor's Notes:

PARCEL I.D. 25 -107, PROPERTY ADDRESS 832 RIDGE STREET
NEIGHBORHOOD NUMBER 9 LEGAL DESCRIPTION LOT

*** OWNER INFORMATION ***

NAME YOTSUKURA AYUKO C
ADDRESS 832 RIDGE STREET
CHARLOTTESVILLE, VA 22902

*** DEED INFORMATION ***

BOOK 546
PAGE 420
TAXABLE

***** MISCELLANEOUS INFORMATION *****

PROP CLASS ONE FAMILY	LIVING AREA	1262	LOT AREA SQ.FT.	23985
ZONING 1A	PERIMETER	142	LOT AVERAGE WIDTH	65
OVLP. ZONE	DWELLING UNITS	1	LOT AVERAGE DEPTH	369
LAND USE 1101	CENSUS TRACT	401128	PROPERTY - ACRES	.551
EQ. BD. YR 1989	EQ. BD. ACT.	AFFIRM	PICTURE	YES

***** PRIMARY STRUCTURE *****

YEAR BUILT 1920	EFF YEAR 1969	CONSTRUCTION	ALUMINUM SIDING
GRADE AVERAGE	PCT. ADJ. 20	STO	

[]

CITY OF CHARLOTTEVILLE



104 - 285

Number of Stories 1 Conditional Individual Resource Superfield Screen
 Interior Plan Type _____
 Accessed? _____ If not, why not? _____
 Denied _____ No Trespassing _____ Not Accessible _____
 Interior Description _____

Basement is small altered gabled shed
 Relationship of Secondary Resources _____

reconnaissance main screen 5 of 7
 Historic Context

- DHR Historic Context(s):
- | | | |
|--------------------------------------|--------------------------------|---------------------|
| Agriculture/Substance | Ethnicity/Immigration | Recreation/Arts |
| Architecture/Landscape Architectural | Funerary | Religion |
| Community Planning | Health Care | Settlement Patterns |
| Commerce/Trade | Industry/Processing/Extraction | Social |
| Domestic | Landscape | Traffic Engineering |
| Education | Military/Defense | Transportation |
| | | Other |

Significance Statement

reconnaissance main screen 6 of 7
 Graphic Documentation

Medium*	Medium ID #	Graphic Documentation	Date
2 x 2 B & W photos	B & W 35 mm photos	Historic photos	Slides
4 x 5 B & W photos	Color 35 mm photos	Measured drawings	

Bibliographic Data

Seq. # _____ Type _____ Citation _____

Bibliographic Superfield Screen

Sequence #: _____ Bibliographic Record Type: _____ Author: _____
 Citation Abbreviation: _____

Notes:

Bibliographic Superfield Screen

Sequence #: _____ Bibliographic Record Type: _____ Author: _____
 Citation Abbreviation: _____

Notes:

reconnaissance main screen 7 of 7
 Cultural Resource Management Events

Date _____ CRM Event _____ Assoc. ID# _____
 Agency/Individual _____

CRM Event Superfield Screen

Date: _____ Cultural Resource Management Event: _____
 Organization or Person: _____
 ID# Associated with Event: _____

Notes or Comments

Mailing Address Superfield Screen

HONORIF: _____ Record Created: _____
 FIRST: _____ Last Updated: _____
 LAST: _____
 SUFFIX: _____
 TITLE: _____
 COMPANY: _____ PHONE/EXTENSION: _____
 ADDRESS: _____ STATE: _____
 CITY: _____ COUNTRY: _____
 ZIP: _____ Individual's Category Code _____

Informant _____ Occupant _____ Owner _____ Specimens (owner of specimens) _____ Tenant _____
 Notes _____

Survivor's Notes

Date _____ Event _____ Data Processing Events Person _____

SITE PLAN

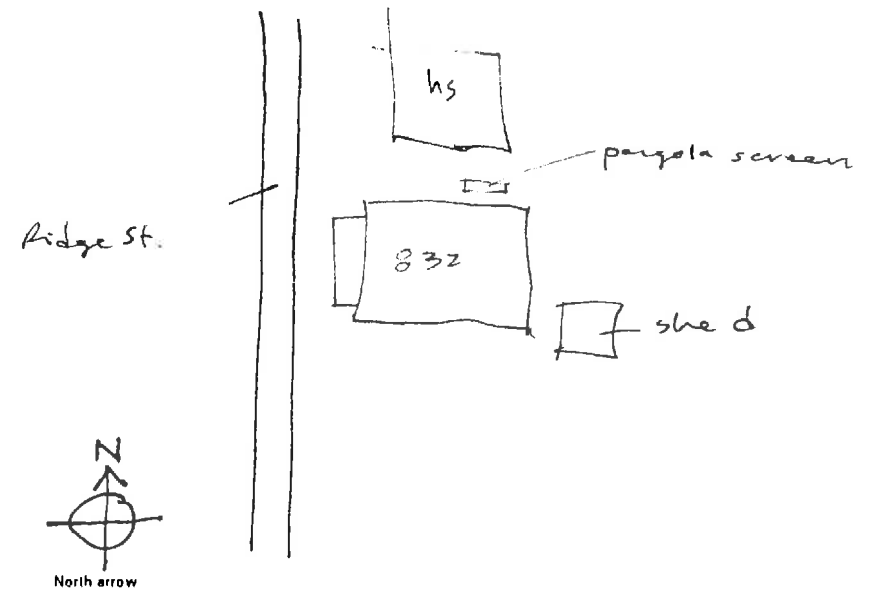

N.T.S.
 Date: _____
 SES - 2/98

Drawn by: _____
 Agency: _____

reconnaissance main screen 1 of 1

Where is data filed at DHR? _____
 DHR Idem. # _____ Property date(s) 1920
 Other DHR no. _____
 Property Name(s) _____
 Name WRENN, Tom, HS. Explanation* _____

Address _____ Alternate spelling _____ Former/current _____ Historic/Location _____ Original _____
 Address-current _____ Current _____ Function/location _____ Location _____ VLR listing _____
 Alleged _____ Descriptive _____ Historic _____ NHL listing _____
 Alternate name _____ Former _____ Historic/current _____ NRHP listing _____
 County/Ind. City _____ Tax Parcel Number 25-107
 State VA Virginia
 Magis'l District _____
 USGS Quad Map Name _____ UTM's of Boundary 1 1
 Center UTM-Zone/East/North 1 1

reconnaissance main screen 2 of 1

Restrict Location and UTM data? _____
 Address _____
 # 832 Suffix Bridge Thoroughfare Name _____ Explanation _____
 Address Superfield Screen _____
 Address Explanation _____
 Sequence Number _____ Alternate _____ Name Change _____
 Main Street Number _____ Current _____ Number Change _____
 Number Suffix _____
 Street Name _____
 Vicinity of: _____ Town/Village/Hamlet _____

Name of National Register Historic District _____
 Name of VDH Historic District _____
 Name of Local Historic District _____

reconnaissance main screen 3 of 1

Physical Character of General Surroundings _____
 City _____ Hamlet _____ Rural _____ Suburban _____ Town _____ Village _____

Site Description/Notable Landscape Features
road, hedge along S prop line, pergola on N side

Ownership _____ NR Resource Type _____
 F Public-Federal _____ P Private _____ B Building _____ S Site _____
 L Public-Local _____ S Public-State _____ D District _____ U Structure _____
 O Object _____

Wurt Count _____
 Wurt Types _____ Historic? h
 # 43 _____
shed _____
 # _____
 * Historic Non-Historic Undetermined

reconnaissance main screen 1 of 1
 Primary Resource Exterior Component Description

Component	Count	Color/Type/Finish	Material	Material Treatment
chimney(s)	1	brk	brk	paint
columns				
cornice				
door(s)				
foundation		plaster infill	stone	paint
porch		1-5 5-bay	br	paint
roof		hip	asph	shingles
walls		pl	stucco	white
windows		double	wd	sh

Individual Resource Information

Seq. # Wurt Primary? _____ Date Built _____
 Individual Resource Superfield Screen _____
 Sequence Number _____
 Primary Resource? _____
 Estimated Date of Construction _____ Source of Date _____
 Architectural Style _____

Art Deco	French Colonial	Late Gothic Revival	Prairie School
Beaux Arts	French Renaissance	Late Victorian	Pueblo
Bungalow/Craftsman	Georgian	Mid-19th C.	Queen Anne
Chicago	Gothic	Mission/Spanish	Renaissance
Classical Revival	Gothic Revival	Colonial Revival	Romanesque
Colonial	Greek Revival	Mixed (more than 3 styles from different periods)	Second Empire
Colonial Revival	International Style	Modern Movement	Shingle Style
Commercial Style	Italian Renaissance	Modern Movement	Skyscraper
Dutch Colonial	Italian Villa	Modern	Spanish Colonial
Early Class. Rev.	Italianate	No Style Listed	Stick/Eastlake
Early Republic	Late 19th & Early 20th C. Revivals	Octagon Mode	Tudor Revival
Exotic Revival	Late 19th & Early 20th C. Amer. Movements	Other	
Federal		Postmedieval English	

Description
porch has hip roof, br. posts w/ lattice br infill w/ + slender wd. columns
pl w/ small front gable + exp'd vertical tails
aluminum awning over 3 side windows

Condition	Excellent	Good	Good-Fair	Poor	Remodeled
Demolished	Fair	Good Excellent	N/A	Rebuilt	Ruinous

Treats to Resource
 Demolition _____ Development _____ Neglect _____ None Known _____ Relocation _____ Trans. Expan. _____
 Deterioration _____ Major Alteration _____ None _____ Public Util. Expan. _____ Structural Failure _____ Vacant _____

Additions/Alterations Description



14629
14630
14820

Date 3.1996 File No. 104-285

Name Tom Wrenn House

Town (832 Ridge St.)

County Charlotteville

Photographer Dan Perzoni

Contents 5 ext. views
