

PARCEL I.D. 25 -113. PROPERTY ADDRESS 880 RIDGE STREET
NEIGHBORHOOD NUMBER 9 LEGAL DESCRIPTION LOT

*** OWNER INFORMATION ***

NAME GOHANNA GEORGE H JR
ADDRESS 931 CHARLTON AVENUE
CHARLOTTESVILLE, VA 22903

*** DEED INFORMATION ***

BOOK 216
PAGE 327
TAXABLE

***** MISCELLANEOUS INFORMATION *****

PROP CLASS ONE FAMILY	LIVING AREA	1223	LOT AREA SQ.FT.	5400
ZONING 1A	PERIMETER	131	LOT AVERAGE WIDTH	40
OVLP. ZONE	DWELLING UNITS	1	LOT AVERAGE DEPTH	110
LAND USE 1101	CENSUS TRACT	401128	PROPERTY - ACRES	.124
EQ. BD. YR	EQ. BD. ACT.		PICTURE	NO

***** PRIMARY STRUCTURE *****

YEAR BUILT 1930	EFF YEAR 1946	CONSTRUCTION	STUCCO WOOD FRAME
GRADE AVERAGE	PCT. ADJ. 4	STORIES	2.0
TYPE STANDARD UNIT		BASEMENT	NO ATTIC NO
CONDITION FAIR		AREA SQ. FT.	526

PLEASE ENTER IN YOUR INFORMATION THEN PRESS enter OR PRESS f7 TO EXIT.

[]

RECONNAISSANCE LEVEL SURVEY REPORT

DEPARTMENT OF HISTORIC RESOURCE
RECONNAISSANCE SURVEY FORM

Reviewed by Margaret Peters

DHR Identification Number: 104-0294

Other DHR Number: Property Date(s) 1900 ca

PROPERTY NAMES	EXPLANATION
Barbour House (880 Ridge St.)	Historic/Location

County/Independent City: Charlottesville
 State: Virginia
 Magisterial District: N/A Tax Parcel: 25-113

USGS Quad Map Name: CHARLOTTESVILLE EAST

UTMs of Boundary:
Center UTM:

Restrict location and UTM data? N

ADDRESSES

Number	Thoroughfare Name	Explanation
880 -	Ridge St.	

Vicinity: Town/Village/Hamlet:

Name of National Register Historic District:

Name of DHR Eligible Historic District:

Name of Local Historic District:

Physical Character of General Surroundings: City

Site Description/Notable Landscape Features:
Residential, a retaining wall formerly bordered the sidewalk; its now gone, but stone piers capped by concrete balls still flank the entrance to the driveway.

Ownership: Private NR Resource Type: Building

WUZITS

Seq. #	# of	Wuzit Types	Historic?
1.0	1	Single Dwelling	Historic

TOTAL: 1
 Historic: 1
 Non-Historic: 0

PRIMARY RESOURCE EXTERIOR COMPONENT DESCRIPTION

Component	#	Comp Type/Form	Material	Material Treatment
Structural System	0	Frame	Wood	Stucco
Roof	0	Gable: side	Metal	Standing Seam
Window(s)	0	Sash, double-hung	Wood	6/6
Porch	0	1-story	Stucco	Screened
Foundation	0	Masonry	Brick	Not visible

INDIVIDUAL RESOURCE INFORMATION

SEQUENCE NUMBER: 1.0 WUZIT: Single Dwelling

Primary Resource? Yes

Estimated Date of Construction: 1900 ca

Source of Date: Site Visit

Architectural Style: Late Victorian

Description:

House is similar in form and appearance to its neighbor at 878 Ridge St. Pierced circular vent in center front gable, shaped rafter tails in gables and eaves, 1- and 2-story rear wings, brick flues, back porch.

Condition: Good

Threats to Resource: None Known

Additions/Alterations Description:

Number of Stories: 2.0

Interior Plan Type:

Accessed?

Interior Description:

Relationship of Secondary Resources to Property:

DHR Historic Context: Architecture/Community Planning
Domestic

Significance Statement:

The building contributes to the historic character of Ridge Street. According to the present occupant, an Andrew Barbour used to own the house. Mary E. Barbour is listed as the occupant in 1947.

GRAPHIC DOCUMENTATION

Medium	Medium ID #	Frames	Date
B&W 35mm Photos	14630	22 -	3/ /1996
B&W 35mm Photos	14630	26 - 27	3/ /1996

BIBLIOGRAPHIC DATA

Sequence #: 1.0 Bibliographic Record Type: Book

Author: Hill Directory Co.

Citation Abbreviation:

Hill's Charlottesville City Directory, 1947-48
Notes:

CULTURAL RESOURCE MANAGEMENT EVENTS

Date: / /1996

Cultural Resource Management Event: Reconnaissance Survey
Organization or Person: J. Daniel Pezzoni, Preservation Con
ID # Associated with Event:
CRM Event Notes or Comments:

MAILING ADDRESS

Honorif:

First : George H., Jr.

Last : Gohanna

Suffix :

Title :

Company:

Address: 931 Charlton Ave.

City : Charlottesville

State: VA

Zip : 22901- Country: USA

Phone/extension: 804-293-5982

Individual Category Codes:

Mailing Address Notes:

Surveyor's Notes:

CITY OF CHARLOTTESVILLE



SCALE : 1" = 100'

104-294

SECTION 25

Number of Stories _____
 Interior Plan Type _____
 Accessed? _____

Conditional Individual Resource Superfield Screen

If not, why not? _____
 Denied _____ No Trespassing _____ Not Accessible _____
 Interior Description _____

Relationship of Secondary Resources _____

reconnaissance main screen 6 of 7
 Historic Context

DHR Historic Context(s):

Agriculture/Subsistence	Ethnicity/Immigration	Recreation/Arts
Architecture/Landscape Architectural	Funerary	Religion
Community Planning	Health Care	Settlement Patterns
Commerce/Trade	Industry/Processing/Extraction	Social
Domestic	Landscape	Traffic Engineering
Education	Military/Defense	Transportation
		Other

Significance Statement _____

reconnaissance main screen 8 of 7
 Graphic Documentation

Medium*	Medium ID #	Frames	Date
2 x 2 B & W photos	B & W 35 mm photos	Historic photos	Slides
4 x 5 B & W photos	Color 35 mm photos	Measured drawings	

Bibliographic Data

Seq. # _____ Type _____ Citation _____

Bibliographic Superfield Screen

Sequence #: _____ Bibliographic Record Type: _____ Author: _____
 Citation Abbreviation: _____
 Notes: _____

Bibliographic Superfield Screen

Sequence #: _____ Bibliographic Record Type: _____ Author: _____
 Citation Abbreviation: _____
 Notes: _____

reconnaissance main screen 7 of 7
 Cultural Resource Management Events
 Agency/Individual

Date _____ CRM Event _____ Assoc. ID# _____

CRM Event Superfield Screen

Date _____ Cultural Resource Management Event: _____
 Organization or Person: _____
 ID# Associated with Event: _____

Notes or Comments

Mailing Address Superfield Screen

HONORIF: _____ Record Created: _____
 FIRST: _____ Last Updated: _____
 LAST: _____
 SUFFIX: _____
 TITLE: _____
 COMPANY: _____
 ADDRESS: _____
 CITY: _____
 ZIP: _____

PHONE/EXTENSION: _____
 STATE: _____
 COUNTRY: _____

Individual's Category Codes

Informant	Occupant	Owner	Specimens (owner of specimens)	Tenant	Notes

Surveyor's Notes

Date _____ Event _____ Data Processing Events Person _____

SITE PLAN

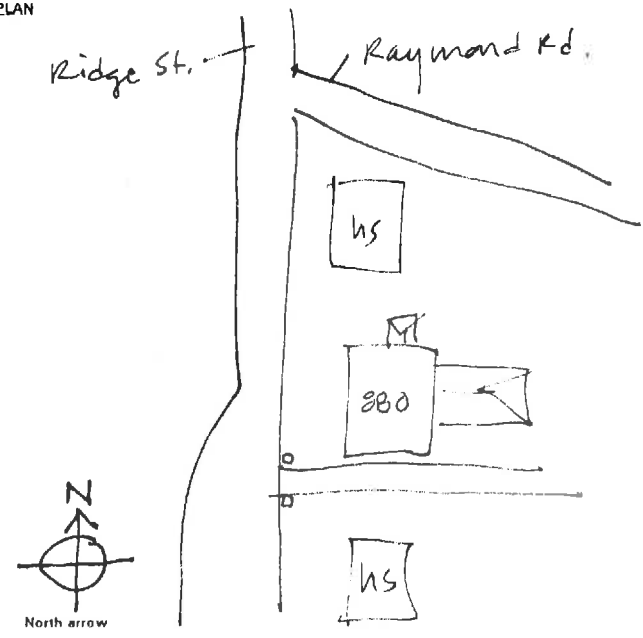

N.T.S.
 Date: _____ Drawn by: _____
 SES 2/98 Agency: _____

194

reconnaissance main screen 1 of 7

Where is data filed at OHR? _____
 DHR Idem. # _____ Property date(s) _____
 Other DHR no. _____
 Andrew + _____ Property Name(s) _____
 Mary Barber HS _____ Explanation * _____

Address	Alternate spelling	Former/current	Historic/location	Original
Address-current	Current	Function/location	Location	VLR listing
Alleged	Descriptive	Historic	NHL listing	
Alternate name	Former	Historic/current	NRHP listing	

County/Ind. City _____ Tax Parcel Number 25-113
 State VA Virginia
 Mags'l District _____
 USGS Quad Map Name _____ UTM's of Boundary 1 1 1
 Center UTM-Zone/East/North _____

reconnaissance main screen 2 of 7

Restrict Location and UTM data? _____

#	Address	Explanation
1	<u># Sulfite Thoroughfare Name</u> <u>800 Ridge</u>	

Address Superfield Screen _____
 Address Explanation _____

Sequence Number	Alternate	Name Change
Main Street Number	Current	Number Change
Number Suffix		
Street Name		

Vicinity of: _____ Town/Village/Hamlet _____

Name of National Register Historic District _____
 Name of VDH Historic District _____
 Name of Local Historic District _____

reconnaissance main screen 3 of 7

Physical Character of General Surroundings _____
 City _____ Hamlet _____ Rural _____ Suburban _____ Town _____ Village _____

Site Description/Notable Landscape Features
wall gone but stone piers w/ balls flank driveway
car

Ownership _____ NR Resource Type _____
 F Public-Federal P Private B Building S Site
 L Public-Local S Public-State D District U Structure
 O Object

Seq. #	Vol	Walls Count	Walls Types	Historic?*	Total
					Historic
					Non-Historic

* Historic Non-Historic Undetermined

Component	#	Comp. Type/Form	Material	Material Treatment
chimneys				
columns				
cornice				
door(s)				
foundation		<u>concr</u>	<u>br</u>	<u>NV</u>
porch		<u>13 no base</u>	<u>struc</u>	<u>so.s.</u>
roof		<u>gib (sides)</u>	<u>met</u>	
walls		<u>br</u>	<u>struc</u>	<u>6/6</u>
windows		<u>6/6</u>	<u>wd</u>	

Individual Resource Information

Seq. #	Visual	Primary?	Date Built

Individual Resource Superfield Screen

Sequence Number	Primary Resource?	Estimated Date of Construction	Source of Date

Architectural Style	French Colonial	Late Gothic Revival	Prairie School
Art Deco	French Renaissance	Late Victorian	Pueblo
Beaux Arts	Georgian	Mid-19th C.	Queen Anne
Bungalow/Craftsman	Gothic	Mission/Spanish	Renaissance
Chicago	Gothic Revival	Colonial Revival	Romanesque
Classical Revival	Greek Revival	Mixed (more than 3 styles from different periods)	Second Empire
Colonial	International Style	Modern Movement	Single Style
Colonial Revival	Italian Renaissance	Modernisme	Skyscraper
Commercial Style	Italian Villa	No Style Listed	Spanish Colonial
Dutch Colonial	Italianate	Octagon Mode	Stick/Eastlake
Early Class. Rev.	Late 19th & 20th C. Revivals	Other	Tudor Revival
Early Republic	Late 19th & Early 20th C. Amer. Movements	Postmedieval English	
Exotic Revival			
Federal			

Description

Pierced circular vent & dec water tanks in front gable
in fr. + back side
1-5 top side + rear wing forward front part
similar in form to 878 Ridge

Condition	Demolished	Deteriorated	Excellent	Fair	Good	Good-Excellent	Good-Fair	N/A	Poor	Rebuilt	Remodeled	Ruinous

Threats to Resource _____
 Demolition Development Neglect None Known Relocation Trans. Expan.
 Deterioration Major Alteration None Public Util. Expan. Structural Failure Vacant

Additions/Alterations Description

occupant: Andrew Barber used to own hs.



14630

Date 3. 1976 File No. 104-294
Name Andrew and Mary Barbouk House
Town (880 Ridge St.)
County Charlottesville
Photographer Dan Perzoni
Contents 3 ext. views