

PARCEL I.D. 25 -114. PROPERTY ADDRESS 884 RIDGE STREET  
NEIGHBORHOOD NUMBER 9 LEGAL DESCRIPTION LOT

\*\*\* OWNER INFORMATION \*\*\*

\*\*\* DEED INFORMATION \*\*\*

NAME SELLERS JOSEPH  
ADDRESS 884 RIDGE STREET  
CHARLOTTESVILLE, VA 22902

BOOK  
PAGE  
TAXABLE

\*\*\*\*\* MISCELLANEOUS INFORMATION \*\*\*\*\*

PROP CLASS ONE FAMILY	LIVING AREA	1572	LOT AREA SQ.FT.	5280
ZONING 1A	PERIMETER	113	LOT AVERAGE WIDTH	53
OVLP. ZONE	DWELLING UNITS	1	LOT AVERAGE DEPTH	110
LAND USE 1101	CENSUS TRACT	401128	PROPERTY - ACRES	.120
EQ. BD. YR	EQ. BD. ACT.		PICTURE	NO

\*\*\*\*\* PRIMARY STRUCTURE \*\*\*\*\*

YEAR BUILT 1920	EFF YEAR 1956	CONSTRUCTION	ALUMINUM SIDING
GRADE AVERAGE	PCT. ADJ. 5-	STORIES	2.0
TYPE STANDARD UNIT		BASEMENT	NO ATTIC NO
CONDITION AVERAGE		AREA SQ. FT.	786

PLEASE ENTER IN YOUR INFORMATION THEN PRESS enter OR PRESS f7 TO EXIT.

[ ]

## RECONNAISSANCE LEVEL SURVEY REPORT

DEPARTMENT OF HISTORIC RESOURCE  
RECONNAISSANCE SURVEY FORM

Reviewed by Margaret Peters

DHR Identification Number: 104-0295

Other DHR Number: Property Date(s) 1900 ca

PROPERTY NAMES	EXPLANATION
Sellers House (884 Ridge St.)	Historic/Location

County/Independent City: Charlottesville

State: Virginia

Magisterial District: N/A

Tax Parcel: 25-114

USGS Quad Map Name: CHARLOTTESVILLE EAST

UTMs of Boundary:

Center UTM:

Restrict location and UTM data? N

## ADDRESSES

Number	Thoroughfare Name	Explanation
884 -	Ridge St.	

Vicinity: Town/Village/Hamlet:

Name of National Register Historic District:

Name of DHR Eligible Historic District:

Name of Local Historic District:

Physical Character of General Surroundings: City

Site Description/Notable Landscape Features:

Residential, landscaped yard, stone retaining wall along sidewalk.

Ownership: Private

NR Resource Type: Building

## WUZITS

Seq. #	# of	Wuzit Types	Historic?
1.0	1	Single Dwelling	Historic
2.0	1	Shed	Non-historic

TOTAL:	2		
Historic:	1		
Non-Historic:	1		

PRIMARY RESOURCE EXTERIOR COMPONENT DESCRIPTION

Component	#	Comp Type/Form	Material	Material Treatment
Structural System	0	Frame	Vinyl	
Porch	0	1-story, 3-bay	Wood	Posts (square)
Window(s)	0	Sash, double-hung	Wood	6/6
Roof	0	Gable: side	Asphalt	Shingle
Foundation	0	Masonry		Not visible

INDIVIDUAL RESOURCE INFORMATION

SEQUENCE NUMBER: 1.0 WUZIT: Single Dwelling  
 Primary Resource? Yes  
 Estimated Date of Construction: 1900 ca  
 Source of Date: Site Visit  
 Architectural Style: Late Victorian  
 Description:  
 Standard two-story one-room-deep form, center front gable, chamfered porch posts on vinyl-clad pedestals, brick flue.  
 Condition: Good  
 Threats to Resource: None Known  
 Additions/Alterations Description:  
 Large two-story shed addition across rear, smaller one-story shed addition to rear (glassed-in porch?).  
 Number of Stories: 2.0  
 Interior Plan Type:  
 Accessed?  
 Interior Description:  
 Relationship of Secondary Resources to Property:  
 Small gabled shed to rear.  
 DHR Historic Context: Architecture/Community Planning  
 Domestic

Significance Statement:  
 The building contributes to the historic character of Ridge Street. Anna and Joseph Sellers owned this house in the 1920s, when they added the front porch and made other changes. Joseph worked for Judge Lyons of Park Ave.; the judge helped the Sellers' purchase this property. This house and the Burks House (881 Ridge) were the last houses on the street in the 1920s; beyond were pastures owned by B. E. Wheeler. This house and its neighbors form a historic nucleus at the southern end of the original "Ridge Street Extension."

GRAPHIC DOCUMENTATION

Medium	Medium ID #	Frames	Date
B&W 35mm Photos	14630	28 - 29	3/ /1996
B&W 35mm Photos	14630	21 -	3/ /1996

BIBLIOGRAPHIC DATA

Sequence #: 1.0 Bibliographic Record Type: Book  
Author: Preservation Piedmont  
Citation Abbreviation:  
Ridge Street Oral History Project  
Notes:

Sequence #: 2.0 Bibliographic Record Type: Local Records  
Author: City of Charlottesville  
Citation Abbreviation:  
Land Records  
Notes:

CULTURAL RESOURCE MANAGEMENT EVENTS

Date: / /1996  
Cultural Resource Management Event: Reconnaissance Survey  
Organization or Person: J. Daniel Pezzoni, Preservation Con  
ID # Associated with Event:  
CRM Event Notes or Comments:

MAILING ADDRESS

Honorif:  
First : Joseph  
Last : Sellers  
Suffix :  
Title :  
Company:

Address: 884 Ridge St.

City : Charlottesville State: VA  
Zip : 22901- Country: USA  
Phone/extension: 804-296-7047

Individual Category Codes:

Mailing Address Notes:

Surveyor's Notes:

CITY OF CHARLOTTESVILLE



SCALE : 1" = 100'

104-295

SECTION 25

Component #	Comp Type/Form	Material	Material Treatment
chimney(s)			
columns			
cornice			
dormer(s)			
foundation	concrete	MS	stucco
porch	1-3 3-6	wd	stucco
roof	gab (side)	asph	stucco
walls	Asph		stucco
windows	Asph		stucco

295

Where is data filed at DHR? \_\_\_\_\_  
 DHR Ident. # \_\_\_\_\_ Property date(s) \_\_\_\_\_  
 Other DHR no. \_\_\_\_\_

Property Names  
 Seq. # Name Explanation  
 1 Joseph + Anna Sellers HS

Address	Alternate spelling	Former/current	Historic/location	Original
Address-current	Current	Function/location	Location	VLR listing
Alleged	Descriptive	Historic	NHL listing	
Alternate name	Former	Historic/current	NRHP listing	

County/Ind. City \_\_\_\_\_ Tax Parcel Number 25-114  
 State VA Yanona  
 Mappa's District \_\_\_\_\_  
 USGS Quad Map Name \_\_\_\_\_  
 Center UTM-Zone/East/North \_\_\_\_\_

Restrict Location and UTM data? \_\_\_\_\_

#	# Suffix	Thoroughfare Name	Address	Explanation
	804	ridge		

Address Superfield Screen  
 Address Explanation  
 Alternate Name Change  
 Current Number Change

Vicinity of: \_\_\_\_\_ Town/Village/Tenist \_\_\_\_\_

Name of National Register Historic District \_\_\_\_\_  
 Name of VDH Eligible Historic District \_\_\_\_\_  
 Name of Local Historic District \_\_\_\_\_

Physical Character of General Surroundings  
 City \_\_\_\_\_ Hamlet \_\_\_\_\_ Rural \_\_\_\_\_ Suburban \_\_\_\_\_ Town \_\_\_\_\_ Village \_\_\_\_\_

Site Description/Notable Landscape Features  
res't. with a ramped yard, some brick wall on wall

Ownership \_\_\_\_\_ NR Resource Type \_\_\_\_\_  
 F Public-Federal P Private B Building S Site  
 L Public-Local S Public-State D District U Structure  
 O Object

Seq. #	# of	Wuzit Count	Wuzit Types	Historic?	Total
	1	1	1	H	1
	1	1	1	N	1

Individual Resource Information

Seq. # Wuzit Primary? Date Built

Individual Resource Superfield Screen  
 Sequence Number \_\_\_\_\_  
 Primary Resource? \_\_\_\_\_  
 Estimated Date of Construction \_\_\_\_\_  
 Architectural Style \_\_\_\_\_

Art Deco	French Colonial	Late Gothic Revival	Prairie School
Beaux Arts	French Renaissance	(Late Victorian)	Pueblo
Bungalow/Craftsman	Georgian	Mid-19th C.	Queen Anne
Chicago	Gothic	Mission/Spanish	Renaissance
Classical Revival	Gothic Revival	Colonial Revival	Romantic
Colonial	Greek Revival	Mixed (more than 3 styles from different periods)	Second Empire
Colonial Revival	International Style	Modern Movement	Shingle Style
Commercial Style	Italian Renaissance	Modern	Skyscraper
Dutch Colonial	Italian Villa	No Style Listed	Spanish Colonial
Early Class. Rev.	Italianate	Octagon Mode	Stick/Eastlake
Early Republic	Late 19th & 20th C. Revivals	Other	Tudor Revival
Exotic Revival	Late 19th & Early 20th C. Amer. Movements	Postmedieval English	
Federal			

Description  
front gable, a/cun shutters  
channeled porch posts on vinyl ped 2x6's  
br flue

Condition	Excellent	Good	Good Fair	Poor	Restored
Damaged	Fair	Good Excellent	N/A	Rebuilt	Ruinous

Threats to Resource  
 Demolition Development Neglect None Known Relocation Trans. Expan.  
 Deterioration Major Alteration None Public Util. Expan. Structural Failure Vacant

Additions/Alterations Description

2' shed near rd

Number of Stories 2 Conditional Individual Resource Superfield Screen  
 Interior Plan Type \_\_\_\_\_  
 Accessed? \_\_\_\_\_ If not, why not? \_\_\_\_\_ Denied \_\_\_\_\_ No Trespassing \_\_\_\_\_ Not Accessible \_\_\_\_\_  
 Interior Description \_\_\_\_\_  
 \_\_\_\_\_  
 \_\_\_\_\_  
 Relationship of Secondary Resources \_\_\_\_\_  
 \_\_\_\_\_

reconnaissance main screen 6 of 7  
 Historic Context

DHR Historic Context(s): Agriculture/Subsistence Architecture/Landscape Architecture/ Community Planning Commerce/Trade Domestic Education	Ethnicity/Immigration Funerary Health Care Industry/Processing/Extraction Landscape Military/Defense	Recreation/Arts Religion Settlement Patterns Social Traffic Engineering Transportation Other
Significance Statement _____ _____		

reconnaissance main screen 6 of 7  
 Graphic Documentation

Medium*	Medium ID #	Frames	Date
2 x 2 B & W photos	B & W 35 mm photos	Historic photos	Slides
4 x 5 B & W photos	Color 35 mm photos	Measured drawings	

Bibliographic Data

Seq. # \_\_\_\_\_ Type \_\_\_\_\_ Citation \_\_\_\_\_

Bibliographic Superfield Screen

Sequence #: \_\_\_\_\_ Bibliographic Record Type: \_\_\_\_\_ Author: \_\_\_\_\_

Citation Abbreviation: \_\_\_\_\_

Notes: \_\_\_\_\_

Bibliographic Superfield Screen

Sequence #: \_\_\_\_\_ Bibliographic Record Type: \_\_\_\_\_ Author: \_\_\_\_\_

Citation Abbreviation: \_\_\_\_\_

Notes: \_\_\_\_\_

reconnaissance main screen 7 of 7  
 Cultural Resource Management Events  
 Agency/Individual

Date CRM Event \_\_\_\_\_ Assoc. ID# \_\_\_\_\_

CRM Event Superfield Screen

Date: \_\_\_\_\_ Cultural Resource Management Event: \_\_\_\_\_

Organization or Person: \_\_\_\_\_

ID# Associated with Event: \_\_\_\_\_

Notes or Comments

Mailing Address Superfield Screen

HONORIF: \_\_\_\_\_ Record Created: \_\_\_\_\_  
 FIRST: \_\_\_\_\_ Last Updated: \_\_\_\_\_  
 LAST: \_\_\_\_\_  
 SUFFIX: \_\_\_\_\_  
 TITLE: \_\_\_\_\_  
 COMPANY: \_\_\_\_\_ PHONE/EXTENSION: \_\_\_\_\_  
 ADDRESS: \_\_\_\_\_ STATE: \_\_\_\_\_  
 CITY: \_\_\_\_\_ COUNTRY: \_\_\_\_\_  
 ZIP: \_\_\_\_\_ Individual's Category Code: \_\_\_\_\_

Informant	Occupant	Owner	Specimens (owner of specimens)	Tenant
Notes				

Surveyor's Notes

Date	Event	Date Processing Events Person
------	-------	-------------------------------

SITE PLAN

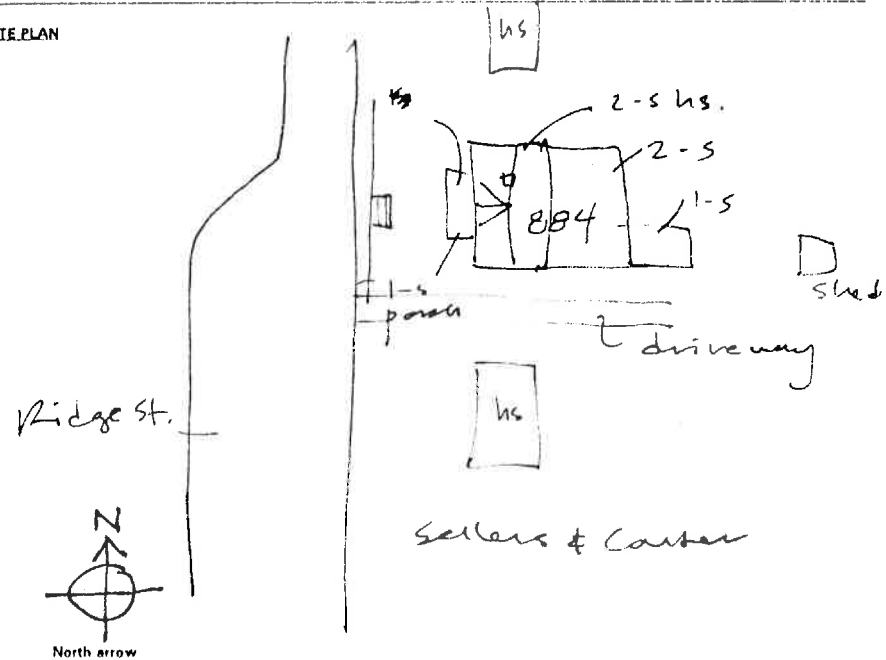

N.T.S.

Date: \_\_\_\_\_

SES - 2/98

Drawn by: \_\_\_\_\_

Agency: \_\_\_\_\_



14630

Date 3.1996 File No. 104-295

Name Joseph + Anna Sellers House

Town (884 Ridge St.)

County Charlottesville

Photographer Dan Pezzoni

Contents 3 ext. views