

# Architectural And Historic Survey



## Identification

<b>STREET ADDRESS:</b>	928 Rugby Road	<b>HISTORIC NAME:</b>	Robert H. Webb House
<b>MAP &amp; PARCEL:</b>	3-139	<b>DATE / PERIOD:</b>	1922, 1978
<b>CENSUS TRACT AND BLOCK:</b>		<b>STYLE:</b>	Colonial Revival
<b>PRESENT ZONING:</b>	R-1	<b>HEIGHT (to cornice) OR STORIES:</b>	2½ storeys
<b>ORIGINAL OWNER:</b>	Robert H. Webb	<b>DIMENSIONS AND LAND AREA:</b>	160' x 289.56' (53,555 sq.ft.)
<b>ORIGINAL USE:</b>	Residence	<b>CONDITION:</b>	Good
<b>PRESENT USE:</b>	Residence	<b>SURVEYOR:</b>	Bibb
<b>PRESENT OWNER:</b>	Eric M. & Bertie D. Heiner	<b>DATE OF SURVEY:</b>	Summer 1983
<b>ADDRESS:</b>	928 Rugby Road	<b>SOURCES:</b>	City/County Records
	Charlottesville, Virginia 22903		Eric M. Heiner
			Bradbury Drawings

## ARCHITECTURAL DESCRIPTION

This handsome Colonial Revival house is two storeys tall, three bays wide, and single pile, with an original 2-storey rear wing covering the south bay. The slope of the land is such that, while the foundation is low at the front, the basement is above ground at the rear. Walls and foundation are constructed of brick laid in 5-course American bond. There is a projecting 3-course stringcourse, but no water table. The house has a steep gable roof covered with slate, with close eaves and verges and boxed cornice with returns, decorated with a Greek fret. There are two interior end chimneys with caps and stringcourses. Windows are double-sash, 8-over-8 light, with wooden sills, moulded surrounds, and louvered shutters. They are somewhat shorter at the second level. A circular-headed window with Gothic tracery centered on the rear elevation lights the stair landing. Attic windows in the gable ends are 4-over-4 light. There are three pedimented gabled dormers on the facade with slate walls, fluted pilasters, and small 6-over-6 light windows. Centered on the rear elevation is a large shed-roofed, slate-walled dormer with three pairs of 3-light casement windows with plain trim. A one-storey, flat-roofed, semi-circular Tuscan portico with a simple roof balustrade covers the central bay of the facade. The entablature has dentil moulding. The entrance has recessed sidelights over panels, transom, and corner lights. A one-storey flat-roofed sun parlor covers the north end of the house. It has 6-over-6 light windows with transoms and paneled spandrels. There are coupled pilasters with inset panels between the bays. The one-storey rear wing is original and matches the main block in most details, except that the cornice lacks the Greek fret band. There is an interior end chimney on the north side and a tripartite window at the first level of the rear elevation. At the basement level, a pair of wide 15-light French doors flanked by 4-over-4 light windows fill in a former garage door opening. Adjacent to this original wing, a one-storey wing covers the center bay of the rear elevation. It has a flat roof with a simple balustrade. There is also a tiny gable-roofed side entrance wing centered on the south end of the house. It no longer serves that function since its rear porch was enclosed. Another side entrance is located just anterior to it in the main block. The interior follows the central hall plan. Windows and doors have entablatures and corner blocks with bullseyes. The 2-flight, open-well stair has turned balusters and newels and decorated rail.

## HISTORICAL DESCRIPTION

Robert H. & Blanche Miller Webb purchased a block of lots in Preston Heights in 1916 and 1923 (ACDB 162-305, City DB 40-323). Tax records show that this house was built in 1922. It was designed by Eugene Bradbury. Mr. Webb was Professor of Greek at the University. He died in 1952 (City WB 7-108), and in 1978 Mrs. Webb sold the house to Eric M. & Bertie D. Heiner (DB 392-688).

Additional References: City DB 392-686.

3-139✓

#487 R-1 160 x 289.56 (53,535)

### 928 Rugby Road

PO Box 219  
 392-688 Eric M & Bertie D Heiner 1978 plat 392-688  
 + B. Webb, M. Webb  
 YNB et al, tr (webb) 1963  
 487-108 Per NB " " " 1952  
 Robt H Webb, trustee

2 1/2, 1-3, base, 9 rooms  
 brick found. & walls, slate gable roof  
 5 fireplaces, 3 stacks  
 built 1923, expensive const  
 renovated 1978

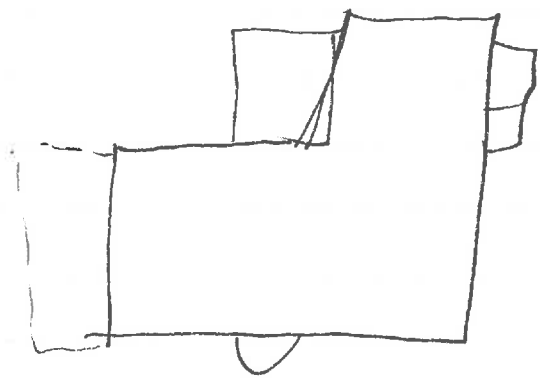

158.82' x 237' lot at rear sold 1978 (392-689)

928 Rugby Road

392-~~688~~<sup>685</sup> Blanche M. Webb, wid; & VNB, trustee, under will of Robt. Hemming Webb

5/26/1978

~~Eric M & Bertie D. Heimer~~

~~Lucius H. Bracey, Jr & Chas. Polgin, Jr, trustee for Cabell~~

→ Eric M & Bertie D. Heimer

lot 161.08' on Rugby; Lot A on plat 392-686  
part of property for <sup>W. Allan & Hazel B</sup> Perkins: ACDB 162-305, 1916

City DB 40-323, 1922

392-688 sale of lot in rear

40-323 W. Allan & H B Perkins → Robt H & Blanche M. Webb \$1000

6/1/1922

lot to rear of ACDB 162-305, X 1, 2, 7, 8 of Block 29,  
Preston Heights, plat ACDB 97-346

ACDB

162-305 W. Allan & Hazelhurst B. Perkins → R H & Blanche Miller Webb

4/18/1916

160' on Rugby x 265' back, lots 9, 10, 2, 3, & part 11 & 4, 50.30  
part of ACDB 160-220, 1915, Geo Walker → W. Allan Perkins  
right to run sewer across Perkins property

Tax

1923

Robt & Blanche Webb

160' x 265' (many lots)

Bld added  
for WA Perkins

$1400 + 12,600 = 14,000$

1923

no water table? ✓  
basement windows  
entrance  
side ent. porch

928 Rugby

cent ent hall - chair rail, doors have cornice & freeze,  
corner blocks w/ bullseye; 2-fl open well stair w/  
turned bal, dec. rail

✓ 2-5, 3-bay, <sup>single</sup> ~~double~~ pile  
low found, 5-c am

5-c am bond, stringcourse = 3 proj courses

✓ steep gable roof, slate, boxed cornice, <sup>w/ returns</sup> w/ brick frieze  
close saw & woods  
2 int end chim, cap & stringcourse

✓ windows 8/8 w/ moulded trim & wooden sills, lowered shutters,  
shorter 2nd

3 <sup>pedimented</sup> gabled dormers on facade  
slate walls, fluted pilasters, 6/6 windows definitely smaller

1-5 semi-circular flat-roofed portico covers central bay  
of facade; brick floor; 4 Tuscan columns, entab w/  
dentil moulding, simple roof bal

1-5 sun parlor covers E end  
flat roof, <sup>coupled</sup> pilasters w/ inset panels bet bays,  
6/6 windows w/ transom & paneled grandcase,  
concrete floor  
could have been opening  
entab w/ dentils

large shed-roofed, slate-walled dormer center rear  
w/ 3 pr 3-l casement, pl trim

orig 2-story rear wing covers W bay; cornice lacks ped  
bipartite window groups 1st level rear  
pr wide 15-l Fr door flanked by no 4/4 windows  
at <sup>rear</sup> basement level in garage door <sup>opening</sup> now filled in w/ wb  
int end chin E side

1-5 rear wing w/ deck on flat roof covers center bay rear;  
pl frieze; <sup>triple</sup> roof bal

circ-headed window w/ Collier tracery on stair landing

pr 4/4 attic

1-5 gabled wing w



ent kitchen

porch behind end wb, flat roof

~~front end~~ no ent, ent in front of it

appear orig

porch front

