

Scala, Mary Joy

From: Scala, Mary Joy
Sent: Thursday, October 08, 2015 2:45 PM
To: 'Clark Gathright'
Cc: 'Trent Lawhorn'
Subject: RE: West Main Residence Inn - sidewalk grades

Clark, I have heard from four BAR members who are generally positive, and I think those are the only comments I can expect. With this email I am signing off on the knee wall as proposed. You may proceed.

Mary Joy Scala, AICP

Preservation and Design Planner
City of Charlottesville
Department of Neighborhood Development Services
City Hall – 610 East Market Street
P.O. Box 911
Charlottesville, VA 22902
Ph 434.970.3130 FAX 434.970.3359
scala@charlottesville.org

From: Clark Gathright [mailto:cgathright@dgarchs.com]
Sent: Thursday, October 08, 2015 9:45 AM
To: Scala, Mary Joy
Cc: 'Trent Lawhorn'
Subject: RE: West Main Residence Inn - sidewalk grades

Mary Joy:

The bollards and chains are still part of the plan and are there for ABC purposes.

The drain layout revision is a result of the City directed grade changes, but by the time the wall idea was considered, the drain had already been placed in concrete. We've added additional drains in the Plaza area as well.

Clark Gathright

100 10th Street NE, Suite 200
Charlottesville, VA 22902
434.971.8848

From: Scala, Mary Joy [mailto:scala@charlottesville.org]
Sent: Thursday, October 08, 2015 8:45 AM
To: Clark Gathright
Cc: 'Trent Lawhorn'
Subject: FW: West Main Residence Inn - sidewalk grades

I have heard from three – need a couple more to give you approval. Can you respond to Tim's questions?

Mary Joy Scala, AICP

Preservation and Design Planner
City of Charlottesville
Department of Neighborhood Development Services
City Hall – 610 East Market Street
P.O. Box 911
Charlottesville, VA 22902
Ph 434.970.3130 FAX 434.970.3359
scala@charlottesville.org

From: Tim Mohr [<mailto:tmohr@tmdarch.com>]
Sent: Thursday, October 08, 2015 6:28 AM
To: Scala, Mary Joy; BAR
Subject: RE: West Main Residence Inn - sidewalk grades

The knee wall as described is fine with me – am unclear though regarding the bollards and chain indicated in the plan drawing – is that still happening? I assume they have to do something along those lines to meet ABC laws. Is there a revised layout in the making for that – drain layout also appears to be substantially changed.

Best,

Tim

TIM MOHR AIA
LEED BD+C

t o d d + m o h r
D E S I G N

1112 PARK STREET CHARLOTTESVILLE VIRGINIA 22901
434 971 4631
16 WOODSIDE WAY PO BOX 668 CASTINE MAINE 04421
207 326 5047

tmohr@tmdarch.com

From: Scala, Mary Joy [<mailto:scala@charlottesville.org>]
Sent: Wednesday, October 07, 2015 2:35 PM
To: BAR <BAR@charlottesville.org>
Subject: West Main Residence Inn - sidewalk grades

Clark Gathright is requesting for the Marriott Hotel on West Main Street the addition of a section of knee wall in front of the courtyard, about 11 feet long and 2 feet high. His email is below. Any issues?

Trent Lawhorn at Trident Construction added: The modifications were requested on site by Eric Morris last week when we had the curb formed up and getting ready to pour. He talked to Marty (Silman) about it as well. They do not want to allow water coming off of the City sidewalk to flow onto the site, and the only way we can achieve that and leave at least a 4" curb was to introduce some sort of wall for a short period.

Mary Joy Scala, AICP
Preservation and Design Planner
City of Charlottesville
Department of Neighborhood Development Services
City Hall – 610 East Market Street
P.O. Box 911
Charlottesville, VA 22902

Ph 434.970.3130 FAX 434.970.3359
scala@charlottesville.org

From: Clark Gathright [<mailto:cgathright@dgarchs.com>]
Sent: Wednesday, October 07, 2015 11:54 AM
To: Scala, Mary Joy
Cc: Trent Lawhorn
Subject: West Main Residence Inn - sidewalk grades

Mary Joy:

The City's engineers have directed the contractor to raise the curb elevations along West Main, which is creating some grade issues with the finish floor elevation. In particular, the door in the plaza, very near the City sidewalk, is about 5" below the revised grade (see attached knee wall plan).

To resolve this we plan to provide a knee wall extending off the building corner, roughly 2 ft high and 11 ft long. The knee wall will be Arriscraft with a cap as shown in the attached fire pit details, and will course out with the building coursing.

Let me know if this is acceptable.

Thanks,

Clark Gathright

100 10th Street NE, Suite 200
Charlottesville, VA 22902
434.971.8848

10/2/15

Residence Inn

14"

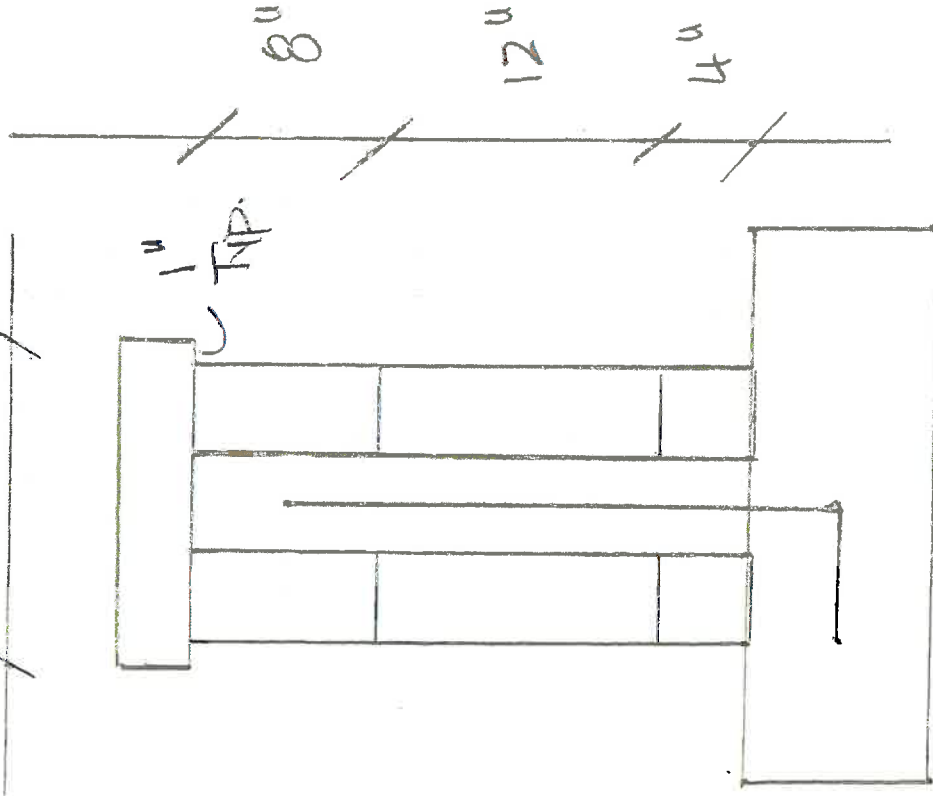

Knee wall

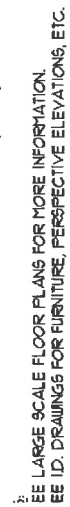

SCALE: 1/4"=1'-0"