

Property Information

Property Names

Name Explanation	Name
Function/Location	House, 507 12th Street NW
Historic	House, 507 Twelve 1/2 Street

Property Evaluation Status

Property Addresses

Current - 507 12th Street NW
 Former - 507 Twelve 1/2 Street NW

County/Independent City(s): Charlottesville (Ind. City)
Incorporated Town(s): *No Data*
Zip Code(s): 22903
Magisterial District(s): *No Data*
Tax Parcel(s): *No Data*
USGS Quad(s): CHARLOTTESVILLE EAST

Additional Property Information

Architecture Setting: Urban
Acreage: *No Data*

Site Description:

January 2020: This two-story house is located on the west side of 12th Street NW, halfway between Gordon and Grady Avenues. The property is bounded by a chain link fence, with box hedges along the southeast portion of the northeast fence. There are several trees near the rear of the lot and a shed in the west corner. This property consists of a house and a shed.

Surveyor Assessment:

January 2020: According to the Charlottesville City Property Records, this house was constructed in 1920 (City of Charlottesville GIS Viewer 2020). This property has also had the address of 409 12th Street NW. The house is first depicted on the 1920 Sanborn Maps as a two-story rectangular dwelling with a one-story, open front porch, and a partial-width, one-story, rear wing. By 1929, an open porch was added on the southwest elevation of the rear wing. The house retains this footprint today. Sanborn Maps also depict an outbuilding that was demolished by 1968. The current shed was built c. 2016 (Sanborn Map Company 1920; Sanborn Map Company 1929; Sanborn Map Company 1950; NETR 1968; City of Charlottesville GIS Viewer 2020). This property was owned by the Brookins family for several decades, including Alice, Robert, and Charles (Hill Directory Co. 1931; Hill Directory Co. 1940; Hill Directory Co. 1950).

This property retains good integrity of location and setting. The integrity of design, materials, and workmanship has been slightly compromised by replacement siding. The property retains good integrity of feeling and association. Overall, this property retains good integrity.

This property is recommended as not individually eligible for listing in the NRHP due to a lack of historical significance. However, it is located in the potential 10th & Page Historic District, which is recommended as potentially eligible for listing in the NRHP. Further study is recommended to determine if the 10th & Page Historic District is eligible for listing in the NRHP under Criterion A in the areas of Ethnic Heritage, Community Planning and Development, and Social History, and under Criterion C in the area of Architecture. This property includes one contributing primary resource and one non-contributing secondary resource.

Surveyor Recommendation: Recommended Not Eligible

Ownership

Ownership Category	Ownership Entity
Private	<i>No Data</i>

Primary Resource Information

Resource Category: Domestic
Resource Type: Single Dwelling
NR Resource Type: Building
Date of Construction: 1920
Date Source: Local Records
Historic Time Period: World War I to World War II (1917 - 1945)
Historic Context(s): Architecture/Community Planning, Domestic

Other ID Number: *No Data*
Architectural Style: Vernacular
Form: *No Data*
Number of Stories: 2.0
Condition: Good
Threats to Resource: None Known

Architectural Description:

Architecture Summary: This house is a frame, 2 story, 2 bay, structure with a gable roof, and a front porch with a shed roof and turned posts.

February 1991

January 2020: This two-story house rests on a concrete foundation, is clad in aluminum siding, and has a cross gable roof that is covered with asphalt shingles. There is an interior brick chimney on the northeast roof slope. There is a one-story, full-width, open porch on the southeast-facing facade. The porch has a wood floor, turned wood columns, wood latticework railings, and a hipped roof. The main entranceway is at the southwest end of the porch, which is accessed by concrete steps with wood railings. There is a wood handicapped accessible ramp at the northeast end. The northwest elevation features a one-story, front gable wing. At the southwest end of the wing, there is an open one-story porch wing; it has a shed roof and is supported by turned wood columns. Most of the windows have operable wood shutters. Visible fenestration consists of two-over-two, double-hung, wood windows with metal storm windows; an arched wood stained glass window; and a single-leaf wood door with a metal and glass storm door.

Exterior Components

Component	Component Type	Material	Material Treatment
Windows	Sash, Double-Hung	Wood	2/2
Roof	Gable	Asphalt	<i>No Data</i>
Structural System and Exterior Treatment	Frame	Aluminum	Siding
Porch	1-story, 3-bay	Wood	Posts, Turned
Chimneys	Interior Slope	Brick	Stuccoed/Parged
Foundation	Solid/Continuous	Concrete	Stuccoed/Parged

Secondary Resource Information

Secondary Resource #1

Resource Category: Domestic
Resource Type: Shed
NR Resource Type: Building
Date of Construction: ca 2016
Date Source: Map
Historic Time Period: Post Cold War (1992 - Present)
Historic Context(s): Domestic
Other ID Number: *No Data*
Architectural Style: No discernible style
Form: *No Data*
Number of Stories: 1.0
Condition: Good
Threats to Resource: None Known

Architectural Description:

January 2020: There is a one-story shed to the northwest of the house. It is clad in wood siding and has a shed roof with asphalt shingles. It has an open porch along the southeast elevation with square wood columns and arched brackets. The porch has a wood deck that rests on wood posts. Visible fenestration consists of six-light, wood awning windows.

Exterior Components

Component	Component Type	Material	Material Treatment
Porch	1-Story Full-Width	Wood	Square
Structural System and Exterior Treatment	Wood Frame	Wood	Siding
Windows	Hopper/Awning	Wood	<i>No Data</i>
Roof	Shed	Asphalt	<i>No Data</i>

Historic District Information

Historic District Name: 10th & Page Historic District
Local Historic District Name: *No Data*
Historic District Significance: *No Data*

CRM Events

Event Type: Survey:Phase I/Reconnaissance

Project Review File Number: *No Data*
Investigator: Erin Que
Organization/Company: The 106 Group Ltd.
Photographic Media: Digital
Survey Date: 2/5/2020
Dhr Library Report Number: *No Data*

Project Staff/Notes:

Erin Que, Principal Investigator and Sr. Architectural Historian
Holly Good, Architectural Historian
Saleh Miller, Sr. Architectural Historian

Project Bibliographic Information:

City of Charlottesville GIS Viewer
2020 Property Record. Electronic document, <http://gisweb.charlottesville.org/GisViewer/>, accessed January 27, 2020.

Hill Directory Co.
1931, 1940, 1950, 1959 Hill's Charlottesville City Directory. Hill Directory Co., Inc., Publishers, Richmond, Virginia.

National Environmental Title Research, LLC [NETR]
1963-2016 Historical Aerial Photograph, Charlottesville Independent City, Virginia. Electronic document, <http://historicaerials.com/>, accessed March 19, 2020.

Neighborhood Development Services
2012-2016 The 10th and Page Historic Survey. On file at the City of Charlottesville Neighborhood Development Services, Charlottesville, Virginia.

Sanborn Map Company
1907, 1913, 1920, 1929, 1950 Fire Insurance Map of Charlottesville, Virginia. Sanborn Map Company, New York, New York.

United States Geological Survey [USGS]
1994-2019 Historical Aerial Photograph, Charlottesville Independent City, Virginia. Electronic document, accessed on Google Earth, February 20, 2020.

Event Type: Survey:Windshield

Project Review File Number: *No Data*
Investigator: City of Charlottesville
Organization/Company: City of Charlottesville
Photographic Media: Film
Survey Date: 2/1/1991
Dhr Library Report Number: *No Data*

Project Staff/Notes:

No Data

Bibliographic Information

Bibliography:

No Data

Property Notes:

No Data

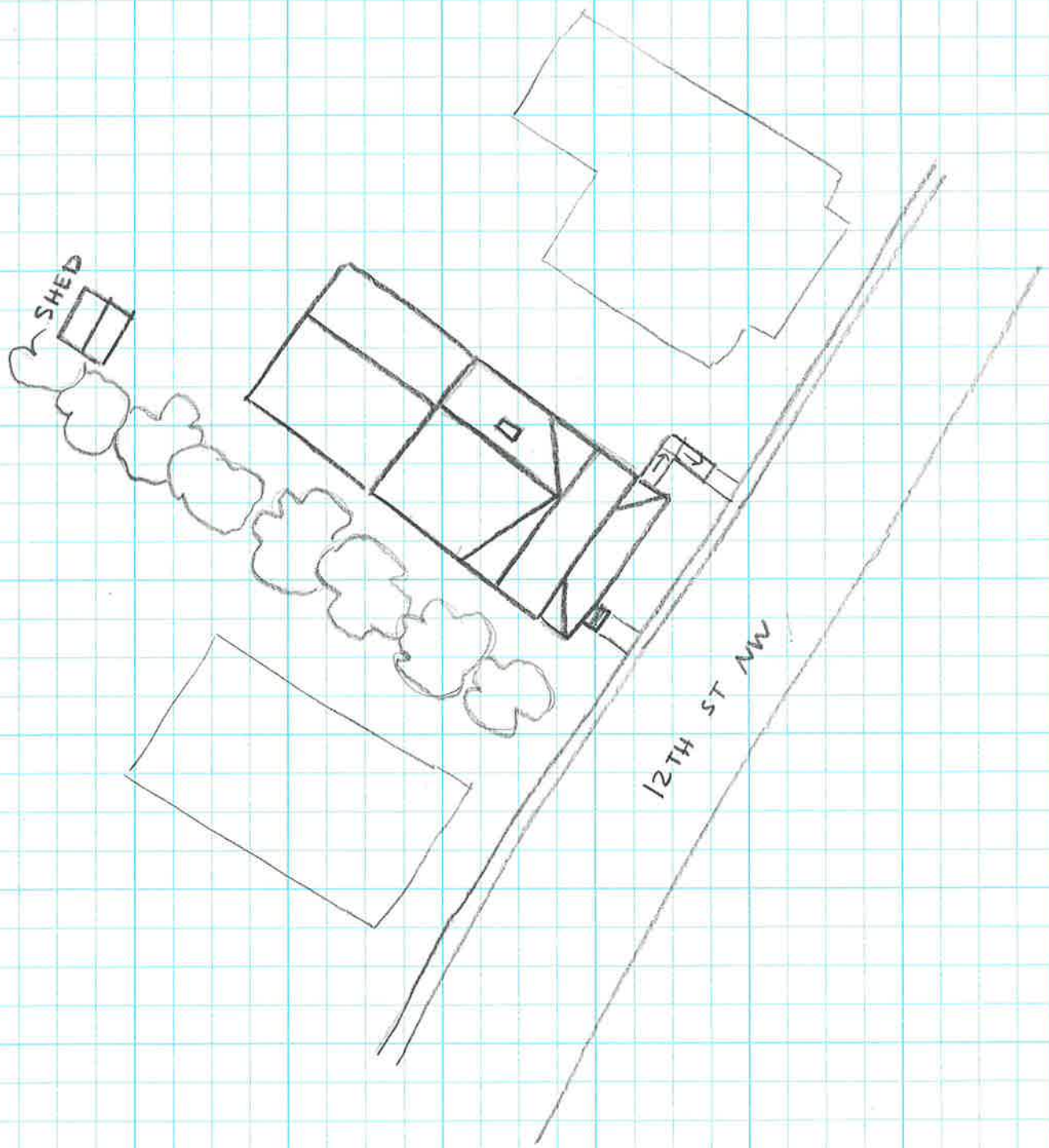

↑ N

HOUSE

104-0222

507 12th ST NW

SURVEY DATE 1/28/2020

NOT TO SCALE