

### Property Information

#### Property Names

Name Explanation	Name
Function/Location	House, 314 10th Street NW

#### Property Evaluation Status

#### Property Addresses

Current - 314 10th Street NW

County/Independent City(s):	Charlottesville (Ind. City)
Incorporated Town(s):	No Data
Zip Code(s):	22903
Magisterial District(s):	No Data
Tax Parcel(s):	No Data
USGS Quad(s):	CHARLOTTESVILLE EAST

### Additional Property Information

Architecture Setting: Urban

Acreage: No Data

#### Site Description:

January 2020: This two-story house is located on the east side of 10th Street NW at the southern corner of 10th Street NW and Paoli Street. There are box hedges on the northeast property line and near the house, and concrete block piers on either side of the entrance walkway. The rear (southeast) of the property is surrounded by an improvised wood pallet fence and features a large multi-car concrete parking pad. This property consists of a house and a shed, a detached deck, and an open, wooden structure in the rear.

#### Surveyor Assessment:

January 2020: This property was built in 1925 according to the City of Charlottesville Property Records (City of Charlottesville GIS Viewer 2020). However, this property first appears on the 1920 Sanborn Map, meaning it was potentially built before 1925, with a prominent secondary resource in the northeast corner of the property, and does not change between that map and the one published in 1950 (Sanborn Map Company 1920; Sanborn Map Company 1929; Sanborn Map Company 1950). That secondary resource does not exist today and, according to aerial photographs, was demolished before 1994 (USGS 1994). Similarly, the footprint of the house does not change from 1920 to today (Sanborn Map Company 1920).

This property retains excellent integrity of location and setting. The integrity of design, materials, and workmanship have been mildly compromised through changes in siding, a rear addition, and the loss of accessory buildings. This property retains excellent integrity of feeling and association. Overall, this property retains good integrity.

This property is recommended as not individually eligible for listing in the NRHP due to a lack of historical significance. However, it is located in the potential 10th & Page Historic District, which is recommended as potentially eligible for listing in the NRHP. Further study is recommended to determine if the 10th & Page Historic District is eligible for listing in the NRHP under Criterion A in the areas of Ethnic Heritage, Community Planning and Development, and Social History, and under Criterion C in the area of Architecture. This property includes one contributing primary resource and one non-contributing secondary resource.

Surveyor Recommendation: Recommended Not Eligible

#### Ownership

Ownership Category	Ownership Entity
Private	No Data

### Primary Resource Information

Resource Category:	Domestic
Resource Type:	Single Dwelling
NR Resource Type:	Building
Date of Construction:	ca 1920
Date Source:	Map
Historic Time Period:	World War I to World War II (1917 - 1945)
Historic Context(s):	Domestic
Other ID Number:	No Data
Architectural Style:	Vernacular

**Form:** *No Data*  
**Number of Stories:** 2.0  
**Condition:** Good  
**Threats to Resource:** None Known

**Architectural Description:**

January 2020: This two-story house sits on a stuccoed foundation, is clad in stucco, and has a hip-on-hip roof. The front (northwest) facade features a full-width, one-story, open porch with a hipped roof that is supported by metal filigree columns with curved metal railings. The main entrance to this house is on the north end of this facade. The rear (southeast) elevation features a partial-width, one-story, shed-roof wing clad in aluminum siding. There is a secondary entrance in this wing on the northeast side, accessed via concrete steps with metal railings. There is a large wood deck on this elevation as well, detached from the house. Visible fenestration includes six-over-six, double-hung, vinyl windows; six-light fixed windows; single-leaf wood doors with nine lights; and a metal storm door.

**Exterior Components**

Component	Component Type	Material	Material Treatment
Foundation	Solid/Continuous	Stucco	Not Visible
Porch	1-Story Full-Width	Metal	Cast Metal Supports
Structural System and Exterior Treatment	Wood Frame	Unknown	Stuccoed
Windows	Double-hung	Vinyl	<i>No Data</i>
Roof	Hipped	Asphalt	<i>No Data</i>

**Secondary Resource Information**

**Secondary Resource #1**

**Resource Category:** Domestic  
**Resource Type:** Shed  
**NR Resource Type:** Building  
**Date of Construction:** ca 2013  
**Date Source:** Map  
**Historic Time Period:** Post Cold War (1992 - Present)  
**Historic Context(s):** Domestic  
**Other ID Number:** *No Data*  
**Architectural Style:** No discernible style  
**Form:** *No Data*  
**Number of Stories:** 1.0  
**Condition:** Fair  
**Threats to Resource:** None Known

**Architectural Description:**

January 2020: There is a one-story shed to the southeast of the house. This shed is clad in vinyl siding and has a side-gabled roof covered in asphalt shingles. Visible fenestration includes four-over-four, double-hung, vinyl windows with fixed wood shutters; and wood swing doors.

**Exterior Components**

Component	Component Type	Material	Material Treatment
Structural System and Exterior Treatment	Wood Frame	Vinyl	Siding
Windows	Double-hung	Vinyl	<i>No Data</i>
Roof	Side Gable	Asphalt	<i>No Data</i>

**Historic District Information**

**Historic District Name:** *No Data*  
**Local Historic District Name:** *No Data*  
**Historic District Significance:** *No Data*

## CRM Events

### Event Type: Survey:Phase I/Reconnaissance

**Project Review File Number:** *No Data*  
**Investigator:** Erin Que  
**Organization/Company:** The 106 Group Ltd.  
**Photographic Media:** Digital  
**Survey Date:** 2/5/2020  
**Dhr Library Report Number:** *No Data*

**Project Staff/Notes:**

Erin Que, Principal Investigator and Sr. Architectural Historian  
Holly Good, Architectural Historian  
Saleh Miller, Sr. Architectural Historian

**Project Bibliographic Information:**

City of Charlottesville GIS Viewer  
2020 Property Record. Electronic document, <http://gisweb.charlottesville.org/GisViewer/>, accessed January 27, 2020.

Hill Directory Co.  
1931, 1940, 1950, 1959 Hill's Charlottesville City Directory. Hill Directory Co., Inc., Publishers, Richmond, Virginia.

National Environmental Title Research, LLC [NETR]  
1963-2016 Historical Aerial Photograph, Charlottesville Independent City, Virginia. Electronic document, <http://historicaerials.com/>, accessed March 19, 2020.

Neighborhood Development Services  
2012-2016 The 10th and Page Historic Survey. On file at the City of Charlottesville Neighborhood Development Services, Charlottesville, Virginia.

Sanborn Map Company  
1907, 1913, 1920, 1929, 1950 Fire Insurance Map of Charlottesville, Virginia. Sanborn Map Company, New York, New York.

United States Geological Survey [USGS]  
1994-2019 Historical Aerial Photograph, Charlottesville Independent City, Virginia. Electronic document, accessed on Google Earth, February 20, 2020.

## Bibliographic Information

**Bibliography:**

*No Data*

**Property Notes:**

*No Data*

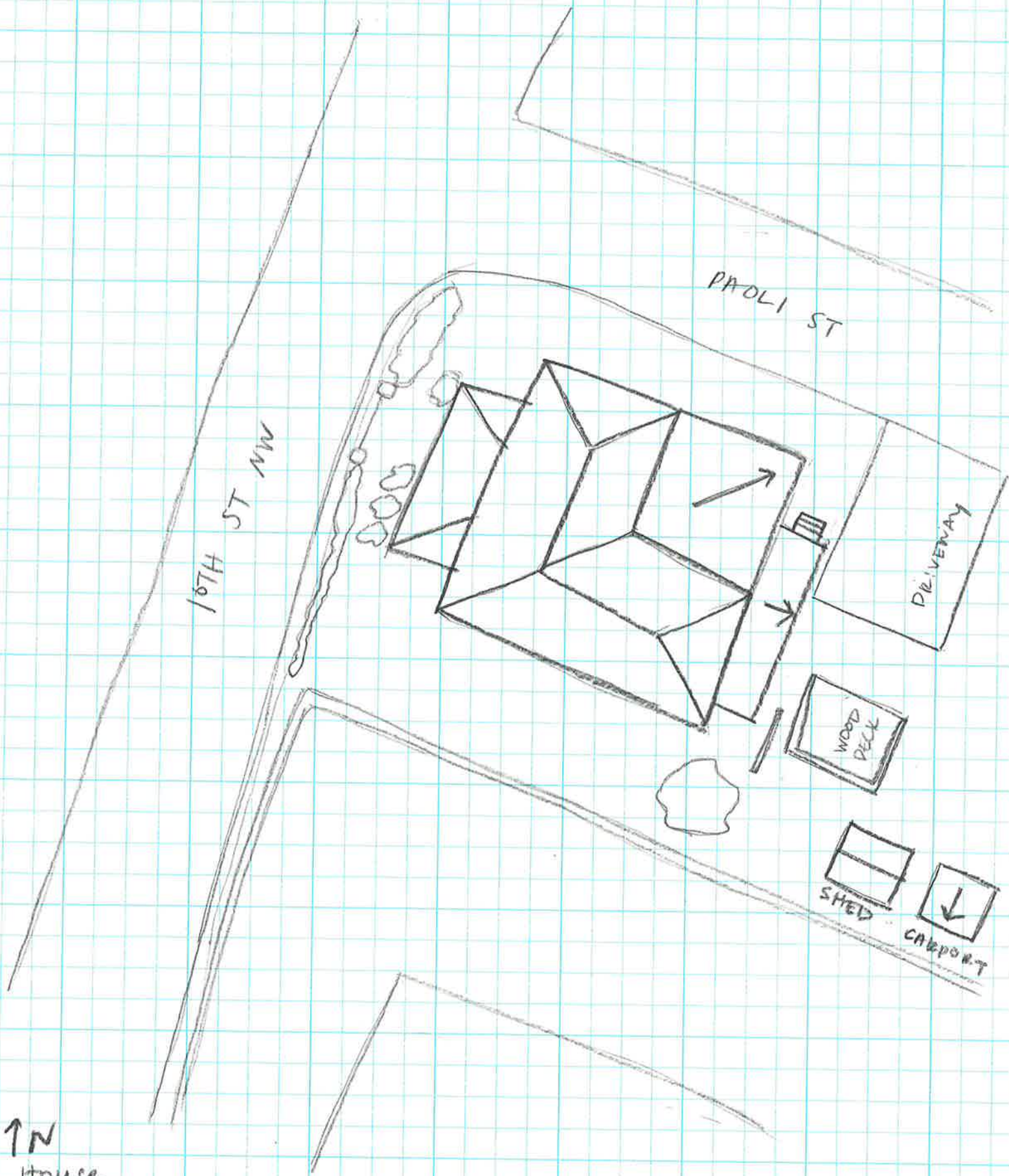

↑ N  
House  
104-5630  
3/4 10th St NW  
Survey Date 1/30/20  
NOT to Scale