

Property Information

Property Names

Name Explanation	Name
Function/Location	House, 418 10th Street NW

Property Evaluation Status

Property Addresses

Current - 418 10th Street NW

County/Independent City(s):	Charlottesville (Ind. City)
Incorporated Town(s):	No Data
Zip Code(s):	22903
Magisterial District(s):	No Data
Tax Parcel(s):	No Data
USGS Quad(s):	CHARLOTTESVILLE EAST

Additional Property Information

Architecture Setting: Urban

Acreage: No Data

Site Description:

2016: This property was surveyed in 2012-2016 by City of Charlottesville Neighborhood Development Services. The front of the lot has a concrete walkway leading from the sidewalk to the central entrance. A privet hedge lines the front yard and there is a large gravel parking lot to the north side of the house which is shared with 416 10th Street NW. It appears at one point an alley ran behind this property but it is no longer function due to overgrowth of trees and shrubs.

Surveyor Assessment:

2016: Ownership History

John West sold the property to James T. Coles on Feb. 22, 1890(County 93 – 68). Ida Coles (widow of James T.) and her son Bernard R. Coles (and his wife Beatrice Coles) sold the land to Roy H. Lee in 1920(City 37 – 130). The Lee family owned the home until 1977 (City 386-65).

Social History

For over fifty years, one African American family lived and worked in the house. Roy H. Lee, a janitor, lived in the house while single from 1922-1926. Around 1927, he married Anna B. Lee and she moved into the home. The couple and their children lived in the home together until Roy's death in 1940. Anna continued to live in the home and work as a domestic servant until through the 1960s.

Statement of Significance

This house was owned by the Lee family for over fifty years. The house is well-preserved with original wood windows. At one point John West owned the property.

2020: This property is located in the potential 10th & Page Historic District, which is recommended as potentially eligible for listing in the NRHP. Further study is recommended to determine if the 10th & Page Historic District is eligible for listing in the NRHP under Criterion A in the areas of Ethnic Heritage, Community Planning and Development, and Social History, and under Criterion C in the area of Architecture. This property includes one contributing primary resource.

Surveyor Recommendation: Recommended Not Eligible

Ownership

Ownership Category	Ownership Entity
Private	No Data

Primary Resource Information

Resource Category:	Domestic
Resource Type:	Single Dwelling
NR Resource Type:	Building
Date of Construction:	ca 1922
Date Source:	Local Records
Historic Time Period:	World War I to World War II (1917 - 1945)
Historic Context(s):	Domestic
Other ID Number:	No Data

Architectural Style: Vernacular
Form: *No Data*
Number of Stories: 1.0
Condition: Good
Threats to Resource: None Known

Architectural Description:

2016: This three-bay, one-story, frame house was built around 1922. In 1962, the house was clad in aluminum siding and there was another major rehabilitation in 1980. The current dwelling has front-facing gable standing seam metal roof with overhanging eaves and exposed rafter ends. Across the façade is a three-bay corrugated metal awning. There is a two-bay, one-story gable-roof rear addition with another shed-roof, one-story two-bay addition added to it. The front-facing windows are 6/6 wood sash.

Exterior Components

Component	Component Type	Material	Material Treatment
Porch	Overhang/Awning	Metal	Not Visible
Structural System and Exterior Treatment	Wood Frame	Aluminum	Siding
Roof	Front Gable	Metal	<i>No Data</i>
Windows	Double-hung	Wood	<i>No Data</i>

Secondary Resource Information

Historic District Information

Historic District Name: *No Data*
Local Historic District Name: *No Data*
Historic District Significance: *No Data*

CRM Events

Event Type: Survey:Phase I/Reconnaissance

Project Review File Number: *No Data*
Investigator: Erin Que
Organization/Company: The 106 Group Ltd.
Photographic Media: Digital
Survey Date: 2/5/2020
Dhr Library Report Number: *No Data*

Project Staff/Notes:

Erin Que, Principal Investigator and Sr. Architectural Historian
Holly Good, Architectural Historian
Saleh Miller, Sr. Architectural Historian

Project Bibliographic Information:

City of Charlottesville GIS Viewer
2020 Property Record. Electronic document, <http://gisweb.charlottesville.org/GisViewer/>, accessed January 27, 2020.

Hill Directory Co.
1931, 1940, 1950, 1959 Hill's Charlottesville City Directory. Hill Directory Co., Inc., Publishers, Richmond, Virginia.

National Environmental Title Research, LLC [NETR]
1963-2016 Historical Aerial Photograph, Charlottesville Independent City, Virginia. Electronic document, <http://historicaerials.com/>, accessed March 19, 2020.

Neighborhood Development Services
2012-2016 The 10th and Page Historic Survey. On file at the City of Charlottesville Neighborhood Development Services, Charlottesville, Virginia.

Sanborn Map Company

1907, 1913, 1920, 1929, 1950 Fire Insurance Map of Charlottesville, Virginia. Sanborn Map Company, New York, New York.

United States Geological Survey [USGS]
1994-2019 Historical Aerial Photograph, Charlottesville Independent City, Virginia. Electronic document, accessed on Google Earth, February 20, 2020.

Bibliographic Information

Bibliography:

No Data

Property Notes:

No Data

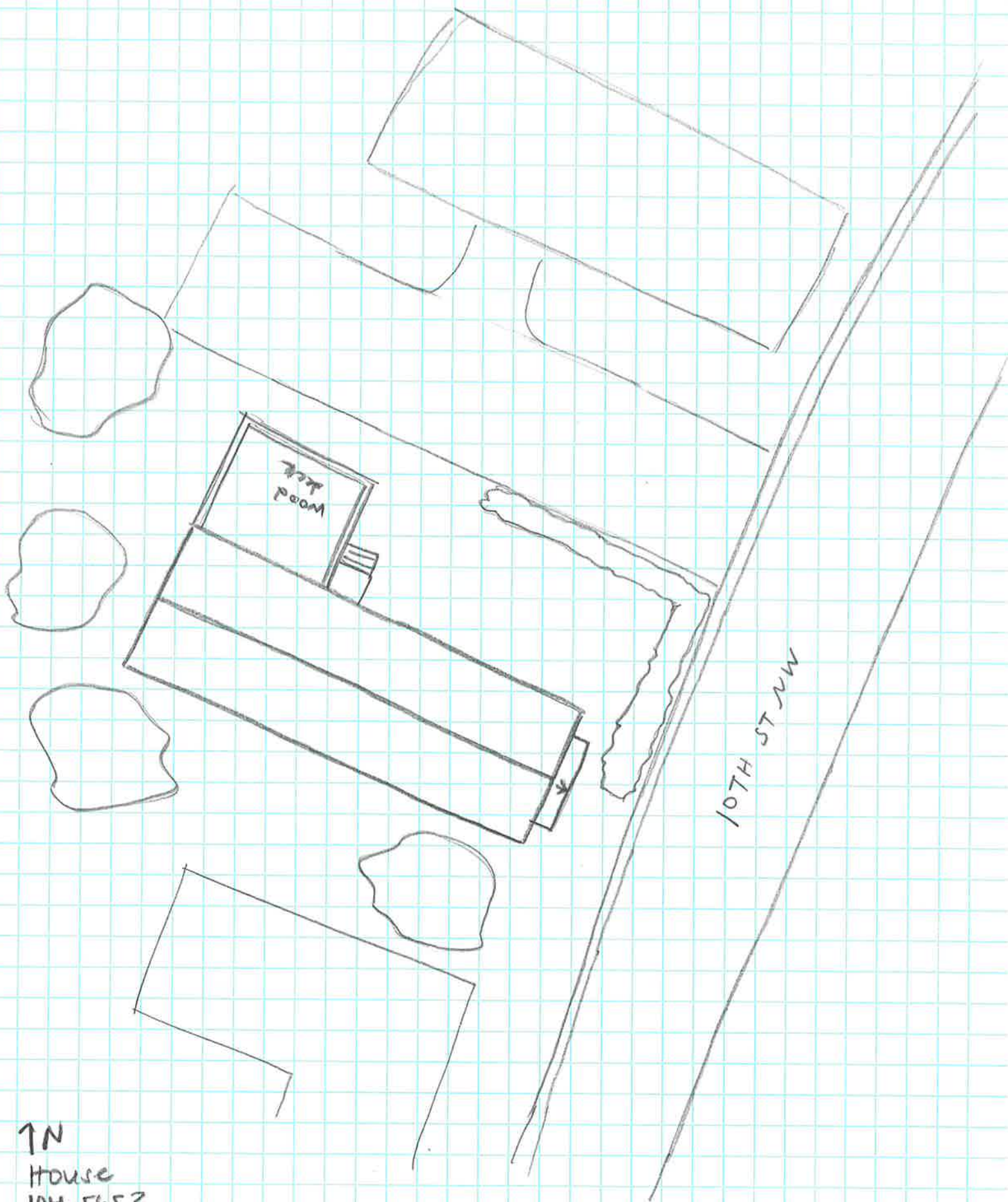

↑ N
House
104-5653
418 10th St NW
Survey Date 2/1/20
Not to Scale