

Property Information

Property Names

Name Explanation	Name
Function/Location	House, 310 10 1/2 Street NW

Property Evaluation Status

Property Addresses

Current - 310 10 1/2 Street NW

County/Independent City(s):	Charlottesville (Ind. City)
Incorporated Town(s):	No Data
Zip Code(s):	22903
Magisterial District(s):	No Data
Tax Parcel(s):	No Data
USGS Quad(s):	CHARLOTTESVILLE EAST

Additional Property Information

Architecture Setting: Urban

Acres: No Data

Site Description:

2016: This property was surveyed in 2012-2016 by City of Charlottesville Neighborhood Development Services. The front of the lot has a concrete walkway leading from the sidewalk to the central entrance. Hedge plantings line the porch area and separate this lot from the neighboring house to the north. There is a concrete block wall between the sidewalk and the front yard.

January 2020: There is a one-story shed in the rear of the lot.

Surveyor Assessment:

2016: Ownership History
Odwaz Puller and Jo Lane Stern sold the property to John West on July 20, 1904(City 16 – 46). Mollie Henderson bought the land in 1916(City 28 – 259). Eliza L. Anderson and George B. Anderson owned the property during the 1950s and 1960s (City 137 – 476).

Social History

Several African American families have lived in this home through the years. From 1914 until 1931, Mollie Henderson, a laundress, owned and resided in the house. The house was rented in the mid-1930s until 1940 by Andrew Walker, a laborer, and his wife Maggie Walker. William Cabell, an employee at Charlottesville Motors, and his wife Amy Cabell lived there for five years beginning in 1940. Walter Kelley, a plasterer, and his wife Rachel Kelley rented the home from 1945 until 1950. George D. Anderson, an orderly at the UVA Hospital rented the house from 1950 through the mid-1960s.

Statement of Significance

The property was once owned by John West and the original homeowner was a single woman (a widow?), Mollie Henderson. Most of the original material has been replaced.

2020: This property is located in the potential 10th & Page Historic District, which is recommended as potentially eligible for listing in the NRHP. Further study is recommended to determine if the 10th & Page Historic District is eligible for listing in the NRHP under Criterion A in the areas of Ethnic Heritage, Community Planning and Development, and Social History, and under Criterion C in the area of Architecture. This property includes one contributing primary resource and one non-contributing secondary resource.

Surveyor Recommendation: Recommended Not Eligible

Ownership

Ownership Category	Ownership Entity
Private	No Data

Primary Resource Information

Resource Category:	Domestic
Resource Type:	Single Dwelling
NR Resource Type:	Building
Date of Construction:	ca 1914
Date Source:	Local Records
Historic Time Period:	Reconstruction and Growth (1866 - 1916)

Historic Context(s): Domestic
Other ID Number: *No Data*
Architectural Style: Vernacular
Form: *No Data*
Number of Stories: 1.0
Condition: Good
Threats to Resource: None Known

Architectural Description:

2016: This three-bay, one-story, frame and stucco house with aluminum siding was built around 1914. The current dwelling has a hipped asphalt shingle roof and a pair of central interior brick chimney. Across the façade is a three-bay, shed roof porch with a parged concrete foundation, and turned wood posts. The front-facing windows are 1/1 vinyl sash type.

Exterior Components

Component	Component Type	Material	Material Treatment
Structural System and Exterior Treatment	Wood Frame	Aluminum	Siding
Chimneys	Interior Central	Brick	Stuccoed/Parged
Porch	1-Story Full-Width	Wood	Posts
Roof	Hipped	Asphalt	<i>No Data</i>
Windows	Double-hung	Vinyl	<i>No Data</i>

Secondary Resource Information

Secondary Resource #1

Resource Category: Domestic
Resource Type: Shed
NR Resource Type: Building
Date of Construction: ca 1994
Date Source: Map
Historic Time Period: Post Cold War (1992 - Present)
Historic Context(s): Domestic
Other ID Number: *No Data*
Architectural Style: No discernible style
Form: *No Data*
Number of Stories: 1.0
Condition: Fair
Threats to Resource: None Known

Architectural Description:

January 2020: There is a one-story shed in the rear of the lot.

Historic District Information

Historic District Name: *No Data*
Local Historic District Name: *No Data*
Historic District Significance: *No Data*

CRM Events

Event Type: Survey:Phase I/Reconnaissance

Project Review File Number: *No Data*

Investigator: Erin Que
Organization/Company: The 106 Group Ltd.
Photographic Media: Digital
Survey Date: 2/5/2020
Dhr Library Report Number: *No Data*

Project Staff/Notes:

Erin Que, Principal Investigator and Sr. Architectural Historian
Holly Good, Architectural Historian
Saleh Miller, Sr. Architectural Historian

Project Bibliographic Information:

City of Charlottesville GIS Viewer
2020 Property Record. Electronic document, <http://gisweb.charlottesville.org/GisViewer/>, accessed January 27, 2020.

Hill Directory Co.
1931, 1940, 1950, 1959 Hill's Charlottesville City Directory. Hill Directory Co., Inc., Publishers, Richmond, Virginia.

National Environmental Title Research, LLC [NETR]
1963-2016 Historical Aerial Photograph, Charlottesville Independent City, Virginia. Electronic document, <http://historicaerials.com/>, accessed March 19, 2020.

Neighborhood Development Services
2012-2016 The 10th and Page Historic Survey. On file at the City of Charlottesville Neighborhood Development Services, Charlottesville, Virginia.

Sanborn Map Company
1907, 1913, 1920, 1929, 1950 Fire Insurance Map of Charlottesville, Virginia. Sanborn Map Company, New York, New York.

United States Geological Survey [USGS]
1994-2019 Historical Aerial Photograph, Charlottesville Independent City, Virginia. Electronic document, accessed on Google Earth, February 20, 2020.

Bibliographic Information

Bibliography:

No Data

Property Notes:

No Data

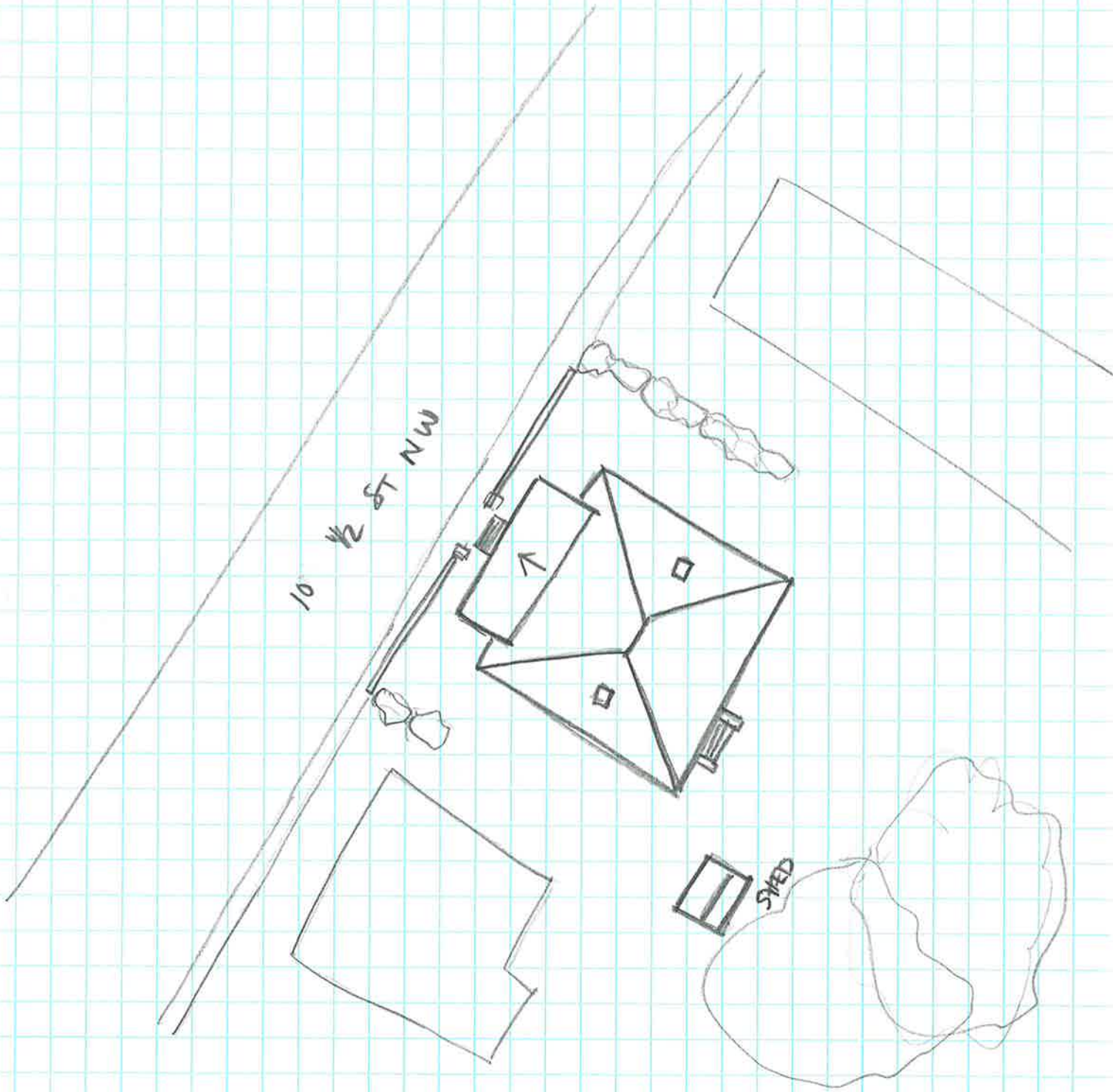

↑N

HOUSE

104-5661

310 10 1/2 ST NW

SURVEY DATE 2/1/2020

NOT TO SCALE