

Property Information

Property Names

Name Explanation Function/Location	Name House, 325 10 1/2 Street NW
--	--

Property Evaluation Status

Property Addresses

Current - 325 10 1/2 Street NW

County/Independent City(s):	Charlottesville (Ind. City)
Incorporated Town(s):	No Data
Zip Code(s):	22903
Magisterial District(s):	No Data
Tax Parcel(s):	No Data
USGS Quad(s):	CHARLOTTESVILLE EAST

Additional Property Information

Architecture Setting: Urban

Acreeage: No Data

Site Description:

2016: This property was surveyed in 2012-2016 by City of Charlottesville Neighborhood Development Services. The front of the lot has a concrete walkway leading from the sidewalk to the entrance. A wood picket fence surrounds the front yard.

Surveyor Assessment:

2016: Ownership History
Julian Corbett sold the property to Isaac J. Bell and Joseph B. Lightfoot on Dec. 28, 1916(City 29 – 432). Mary Watts Holmes purchased the land on May 24, 1918(City 31 – 433). Mary Watts Holmes willed the land to Julia Holmes Ledbetter on July 21, 1930 (with the clause that Mary be able to use the property for “the remainder of her natural life”) (City 70 – 125). James Marshall purchased the property in 1965 and the Marshall family continued to own the house until 2006.

Social History
African American laundress Mary Watts Holmes lived in the house from 1923 until 1964 along with her daughter Julia Holmes Ledbetter and her daughter’s family.

Statement of Significance
This home was owned and occupied by a single woman and her children, Mary Watts Holmes for over fifty years. Her daughter, Julia Holmes Ledbetter lived in the house with her husband and children as well. Most of the original materials have been replaced, but the site holds social and community value.

2020: This property is located in the potential 10th & Page Historic District, which is recommended as potentially eligible for listing in the NRHP. Further study is recommended to determine if the 10th & Page Historic District is eligible for listing in the NRHP under Criterion A in the areas of Ethnic Heritage, Community Planning and Development, and Social History, and under Criterion C in the area of Architecture. This property includes one contributing primary resource and two non-contributing secondary resources.

Surveyor Recommendation: Recommended Not Eligible

Ownership

Ownership Category Private	Ownership Entity No Data
--------------------------------------	------------------------------------

Primary Resource Information

Resource Category:	Domestic
Resource Type:	Single Dwelling
NR Resource Type:	Building
Date of Construction:	ca 1923
Date Source:	Local Records
Historic Time Period:	World War I to World War II (1917 - 1945)
Historic Context(s):	Domestic
Other ID Number:	No Data

Architectural Style: Vernacular
Form: *No Data*
Number of Stories: 2.0
Condition: Good
Threats to Resource: None Known

Architectural Description:

2016: This two-bay, two-story, frame and stucco house was built around 1923. The current dwelling has a hipped standing seam metal roof and a central interior brick chimney. A one-story, gable roof addition with aluminum siding is located at the back of the structure. Across the façade is a two-bay, standing seam metal hipped roof porch with a parged concrete foundation, rectangular wood posts and rails. The front-facing windows are 6/6vinyl sash type

Exterior Components

Component	Component Type	Material	Material Treatment
Structural System and Exterior Treatment	Wood Frame	Unknown	Stuccoed
Roof	Hipped	Metal	<i>No Data</i>
Porch	1-Story Full-Width	Wood	Posts
Windows	Double-hung	Vinyl	<i>No Data</i>
Chimneys	Interior Central	Brick	Strechter Bond

Secondary Resource Information

Secondary Resource #1

Resource Category: Domestic
Resource Type: Shed
NR Resource Type: Building
Date of Construction: ca 2016
Date Source: Map
Historic Time Period: Post Cold War (1992 - Present)
Historic Context(s): Domestic
Other ID Number: *No Data*
Architectural Style: No discernible style
Form: *No Data*
Number of Stories: 1.0
Condition: Good
Threats to Resource: None Known

Architectural Description:

January 2020: There is a one-story shed in the west corner of the lot.

Secondary Resource #2

Resource Category: Domestic
Resource Type: Shed
NR Resource Type: Building
Date of Construction: ca 2018
Date Source: Map
Historic Time Period: Post Cold War (1992 - Present)
Historic Context(s): Domestic
Other ID Number: *No Data*
Architectural Style: No discernible style
Form: *No Data*
Number of Stories: 1.0
Condition: Good
Threats to Resource: None Known

Architectural Description:

January 2020: There is a plastic shed in the north corner of the lot.

Historic District Information

Historic District Name: *No Data*
Local Historic District Name: *No Data*
Historic District Significance: *No Data*

CRM Events

Event Type: Survey:Phase I/Reconnaissance

Project Review File Number: *No Data*
Investigator: Erin Que
Organization/Company: The 106 Group Ltd.
Photographic Media: Digital
Survey Date: 2/5/2020
Dhr Library Report Number: *No Data*

Project Staff/Notes:

Erin Que, Principal Investigator and Sr. Architectural Historian
Holly Good, Architectural Historian
Saleh Miller, Sr. Architectural Historian

Project Bibliographic Information:

City of Charlottesville GIS Viewer
2020 Property Record. Electronic document, <http://gisweb.charlottesville.org/GisViewer/>, accessed January 27, 2020.

Hill Directory Co.
1931, 1940, 1950, 1959 Hill's Charlottesville City Directory. Hill Directory Co., Inc., Publishers, Richmond, Virginia.

National Environmental Title Research, LLC [NETR]
1963-2016 Historical Aerial Photograph, Charlottesville Independent City, Virginia. Electronic document, <http://historicaerials.com/>, accessed March 19, 2020.

Neighborhood Development Services
2012-2016 The 10th and Page Historic Survey. On file at the City of Charlottesville Neighborhood Development Services, Charlottesville, Virginia.

Sanborn Map Company
1907, 1913, 1920, 1929, 1950 Fire Insurance Map of Charlottesville, Virginia. Sanborn Map Company, New York, New York.

United States Geological Survey [USGS]
1994-2019 Historical Aerial Photograph, Charlottesville Independent City, Virginia. Electronic document, accessed on Google Earth, February 20, 2020.

Bibliographic Information

Bibliography:

No Data

Property Notes:

No Data

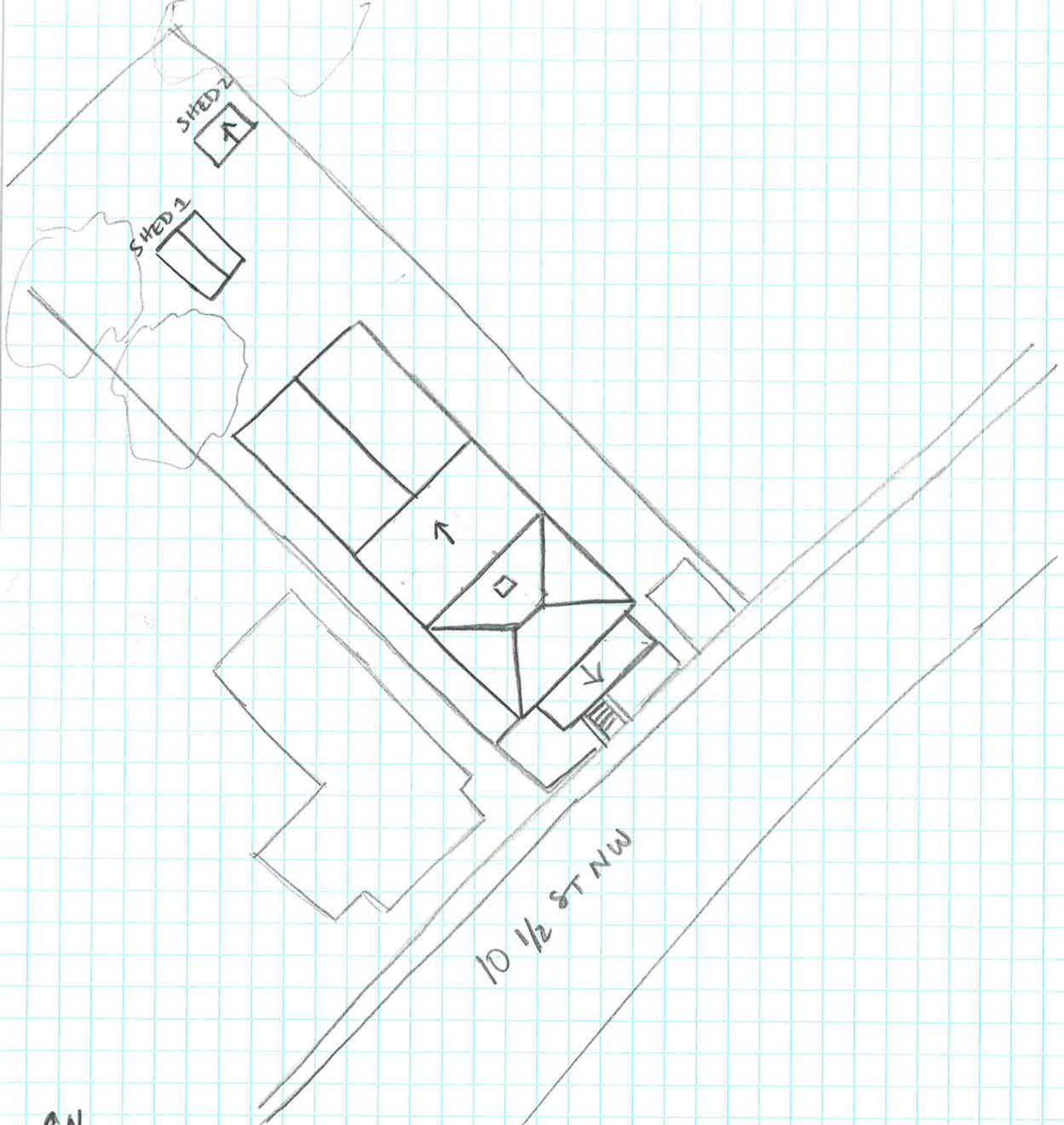

↑ N

House
104-5667

325 10 1/2 ST NW
SURVEY DATE 2/1/2020
NOT TO SCALE