

Property Information

Property Names

Name Explanation	Name
Function/Location	House, 337 10 1/2 Street NW

Property Evaluation Status

Property Addresses

Current - 337 10 1/2 Street NW

County/Independent City(s):	Charlottesville (Ind. City)
Incorporated Town(s):	No Data
Zip Code(s):	22903
Magisterial District(s):	No Data
Tax Parcel(s):	No Data
USGS Quad(s):	CHARLOTTESVILLE EAST

Additional Property Information

Architecture Setting: Urban

Acres: No Data

Site Description:

2016: This property was surveyed in 2012-2016 by City of Charlottesville Neighborhood Development Services. The front of the lot has a concrete walkway leading from the sidewalk to the entrance. Hedge plantings line the porch area and a privacy fence separates the front from the rear of the house. There is a shed in the backyard.

Surveyor Assessment:

2016: Ownership History
S.P. Purvis sold the property to Julian Corbett (and G.M. and Martha McNutt (married)) on August 5, 1916(City 29 – 87). Corbett et al divided the property into two lots: Lot one was sold in 1925 to F.L. Watson, then to W.F. Souder that same year, and then to William R. Carter in 1926 (City 52 – 87), (City 52 – 104) and (City 52 – 482). Lot 2 was sold to Cornelia Norris in 1924 and then to Rosa Norris in 1929 (City 47 – 418). Rosa Norris and William R. Carter combined their properties, selling to Charlottesville Perpetual Building and Loan Corporation in 1929 (City 64 – 306). George Gilmer purchased the land in 1934, as a Trustee for his daughter Betsy Gilmer (City 81-135). Betsy Gilmer married Myron Tremain and became Betsy Gilmer Tremain. She sold the property to Matilda C. Walker in 1945 (City 121 – 328). Alfred Saunders purchased the house and land in 1946, becoming the first owner who would live in rather than renting out the residence (City 125 – 49). The Saunders family sold the property in 2005.

Social History

From 1929 until 1946, the house was rented out to several African American families including Fleming Cooper, a porter, and his wife Norma Cooper (1929-1931); Annie Roanes, a maid (1931-1934); and Lennie Washington, a domestic servant (1934-1945). During this period the home was owned and occupied by African American women. In 1946, until their deaths, Alfred C. Saunders, an African American cook at UVA, and his wife Mary E. Saunders lived in the house.

Statement of Significance

This rental house has had a number of female owners and was purchased by resident Alfred Saunders in 1946. The Saunders family owned the home for more than fifty years. The original materials have mostly been replaced.

2020: This property is located in the potential 10th & Page Historic District, which is recommended as potentially eligible for listing in the NRHP. Further study is recommended to determine if the 10th & Page Historic District is eligible for listing in the NRHP under Criterion A in the areas of Ethnic Heritage, Community Planning and Development, and Social History, and under Criterion C in the area of Architecture. This property includes one contributing primary resource and one non-contributing secondary resource.

Surveyor Recommendation: Recommended Not Eligible

Ownership

Ownership Category	Ownership Entity
Private	No Data

Primary Resource Information

Resource Category:	Domestic
Resource Type:	Single Dwelling
NR Resource Type:	Building
Date of Construction:	ca 1929

Date Source: Local Records
Historic Time Period: World War I to World War II (1917 - 1945)
Historic Context(s): Domestic
Other ID Number: *No Data*
Architectural Style: Vernacular
Form: *No Data*
Number of Stories: 2.0
Condition: Good
Threats to Resource: None Known

Architectural Description:

2016: This two-bay, two-story, frame and stucco dwelling house with aluminum siding was built around 1929. The front porch was replaced in 1953, and the current porch a two-bay, with a hipped roof, rectangular piers and a parged concrete foundation. A two-story, two-bay hipped roof addition was built onto the rear of the house in 1955. The addition has a one-story, one-bay screened porch with a shed roof. The current dwelling has a hipped asphalt shingle roof and a central interior brick chimney. The front-facing windows are 1/1 vinyl sash type.

Exterior Components

Component	Component Type	Material	Material Treatment
Structural System and Exterior Treatment	Wood Frame	Aluminum	Siding
Porch	1-Story Full-Width	Wood	Square
Roof	Hipped	Asphalt	<i>No Data</i>
Chimneys	Interior Slope	Brick	Stretcher Bond
Windows	Double-hung	Vinyl	<i>No Data</i>

Secondary Resource Information

Secondary Resource #1

Resource Category: Domestic
Resource Type: Shed
NR Resource Type: Building
Date of Construction: ca 2009
Date Source: Map
Historic Time Period: Post Cold War (1992 - Present)
Historic Context(s): Domestic
Other ID Number: *No Data*
Architectural Style: No discernible style
Form: *No Data*
Number of Stories: 1.0
Condition: Good
Threats to Resource: None Known

Architectural Description:

January 2020: There is a one-story shed in the west corner of the lot.

Historic District Information

Historic District Name: *No Data*
Local Historic District Name: *No Data*
Historic District Significance: *No Data*

CRM Events

Event Type: Survey:Phase I/Reconnaissance

Project Review File Number: *No Data*
Investigator: Erin Que
Organization/Company: The 106 Group Ltd.
Photographic Media: Digital
Survey Date: 2/5/2020
Dhr Library Report Number: *No Data*

Project Staff/Notes:

Erin Que, Principal Investigator and Sr. Architectural Historian
Holly Good, Architectural Historian
Saleh Miller, Sr. Architectural Historian

Project Bibliographic Information:

City of Charlottesville GIS Viewer
2020 Property Record. Electronic document, <http://gisweb.charlottesville.org/GisViewer/>, accessed January 27, 2020.

Hill Directory Co.
1931, 1940, 1950, 1959 Hill's Charlottesville City Directory. Hill Directory Co., Inc., Publishers, Richmond, Virginia.

National Environmental Title Research, LLC [NETR]
1963-2016 Historical Aerial Photograph, Charlottesville Independent City, Virginia. Electronic document, <http://historicaerials.com/>, accessed March 19, 2020.

Neighborhood Development Services
2012-2016 The 10th and Page Historic Survey. On file at the City of Charlottesville Neighborhood Development Services, Charlottesville, Virginia.

Sanborn Map Company
1907, 1913, 1920, 1929, 1950 Fire Insurance Map of Charlottesville, Virginia. Sanborn Map Company, New York, New York.

United States Geological Survey [USGS]
1994-2019 Historical Aerial Photograph, Charlottesville Independent City, Virginia. Electronic document, accessed on Google Earth, February 20, 2020.

Bibliographic Information

Bibliography:

No Data

Property Notes:

No Data

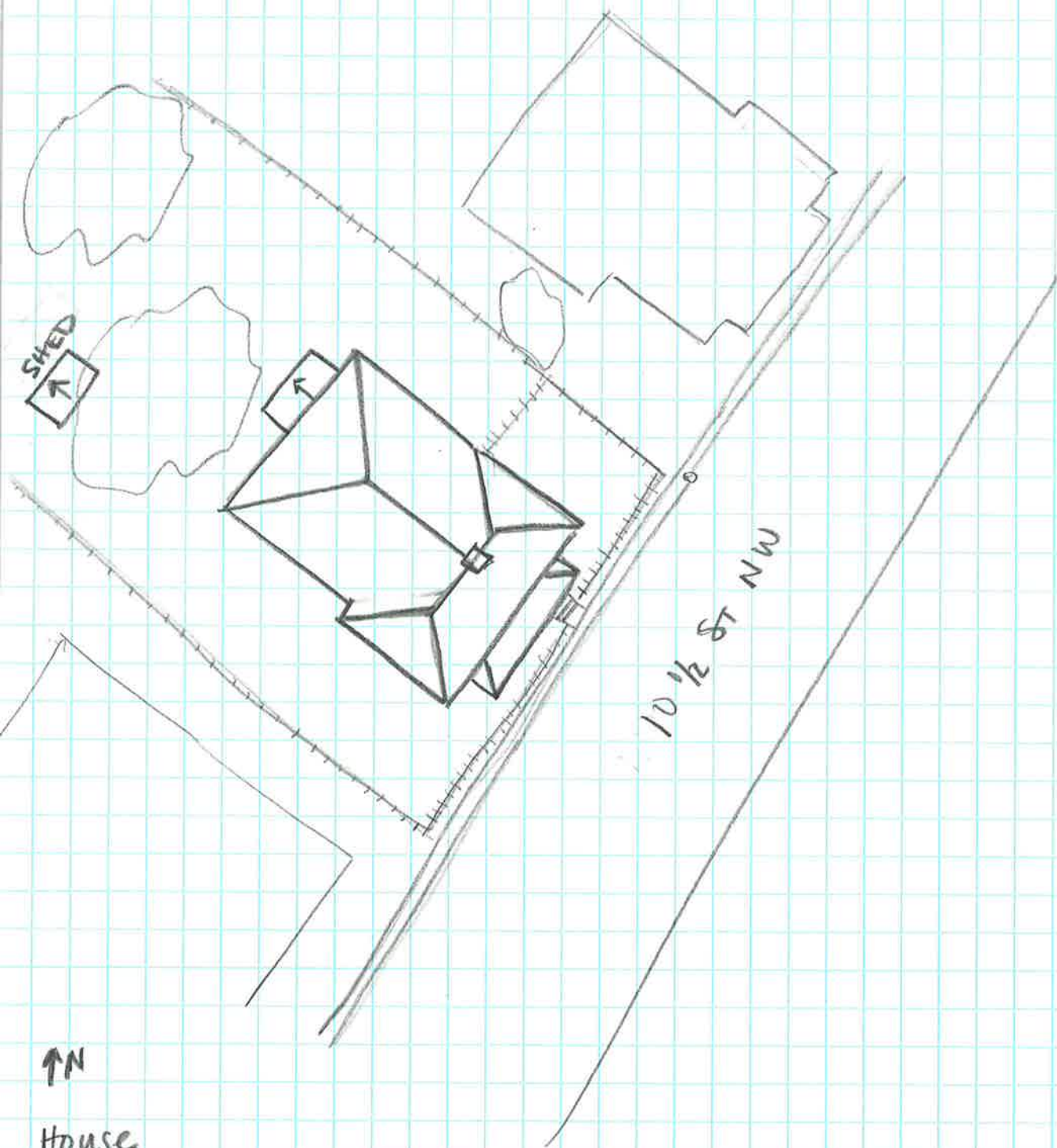

↑N

House
104-5671
337 10 1/2 ST NW
SURVEY DATE 2/1/2020
NOT TO SCALE