

**Property Information**

**Property Names**

<b>Name Explanation</b>	<b>Name</b>
Function/Location	House, 339 10 1/2 Street NW

Property Evaluation Status

**Property Addresses**

Current - 339 10 1/2 Street NW

<b>County/Independent City(s):</b>	Charlottesville (Ind. City)
<b>Incorporated Town(s):</b>	No Data
<b>Zip Code(s):</b>	22903
<b>Magisterial District(s):</b>	No Data
<b>Tax Parcel(s):</b>	No Data
<b>USGS Quad(s):</b>	CHARLOTTESVILLE EAST

**Additional Property Information**

**Architecture Setting:** Urban

**Acreage:** No Data

**Site Description:**

2016: This property was surveyed in 2012-2016 by City of Charlottesville Neighborhood Development Services. The front of the lot has a concrete walkway leads from the sidewalk to the central entrance. Hedge plantings line the porch area.

January 2020: There is a shed in the backyard.

**Surveyor Assessment:**

2016: Ownership History  
 S.P. Purvis sold the property to Julian Corbett on August 5, 1916(City 29 – 87). Corbett sold to F.L. Watson and Mary W. Watson in 1925 (City 52 – 87). The Watsons resold the property the next year, in 1926 to Norman Lewis Shaw and Betty A. Shaw (City 52 – 328). Laura J. Richardson purchased the property in 1977 from the Shaw estate (City 382-794).Richardson still owns the property today.

Social History  
 The African American Shaw family lived in the house from 1914, until 1977. Norman Shaw, a janitor, lived in the house until his death in the mid 1950s. Norman’s wife Betty A. Shaw, a nurse, lived in the house with their children as a widow until she passed away in the 1970s.

Statement of Significance  
 The Shaw family lived in and owned this house for over fifty years. The majority of the materials have been replaced, although there is one original wood 6/6 window on the first floor.

2020: This property is located in the potential 10th & Page Historic District, which is recommended as potentially eligible for listing in the NRHP. Further study is recommended to determine if the 10th & Page Historic District is eligible for listing in the NRHP under Criterion A in the areas of Ethnic Heritage, Community Planning and Development, and Social History, and under Criterion C in the area of Architecture. This property includes one contributing primary resource and one non-contributing secondary resource.

**Surveyor Recommendation:** Recommended Not Eligible

**Ownership**

<b>Ownership Category</b>	<b>Ownership Entity</b>
Private	No Data

**Primary Resource Information**

<b>Resource Category:</b>	Domestic
<b>Resource Type:</b>	Single Dwelling
<b>NR Resource Type:</b>	Building
<b>Date of Construction:</b>	ca 1914
<b>Date Source:</b>	Local Records
<b>Historic Time Period:</b>	Reconstruction and Growth (1866 - 1916)
<b>Historic Context(s):</b>	Domestic

**Other ID Number:** *No Data*  
**Architectural Style:** Vernacular  
**Form:** *No Data*  
**Number of Stories:** 2.0  
**Condition:** Good  
**Threats to Resource:** None Known

**Architectural Description:**

2016: This two-bay, two-story, frame and stucco dwelling house was built around 1914. The house had several rehabilitations in 1951, 1955, and 1967. The 1955 work was done by Charlottesville Lumber Corporation. The current dwelling has a hipped asphalt shingle roof and a central interior brick chimney. Across the façade is a two-bay, hipped roof porch with a parged concrete foundation, battered piers, and a concrete block decorative screen. There is a one-bay, one-story side addition and a two-bay, two-story hipped roof addition. The front-facing windows are 4/4 vinyl sash type, with one 6/6 wood sash window.

**Exterior Components**

Component	Component Type	Material	Material Treatment
Structural System and Exterior Treatment	Wood Frame	Unknown	Stuccoed
Roof	Hipped	Asphalt	<i>No Data</i>
Chimneys	Interior Central	Brick	Stretcher Bond
Windows	Double-hung	Vinyl	<i>No Data</i>
Porch	1-Story Full-Width	Stucco	Columns/Posts on Piers

**Secondary Resource Information**

**Secondary Resource #1**

**Resource Category:** Domestic  
**Resource Type:** Shed  
**NR Resource Type:** Building  
**Date of Construction:** ca 1994  
**Date Source:** Map  
**Historic Time Period:** Post Cold War (1992 - Present)  
**Historic Context(s):** Domestic  
**Other ID Number:** *No Data*  
**Architectural Style:** No discernible style  
**Form:** *No Data*  
**Number of Stories:** 1.0  
**Condition:** Fair  
**Threats to Resource:** None Known

**Architectural Description:**

January 2020: There is a one-story shed in the backyard.

**Historic District Information**

**Historic District Name:** *No Data*  
**Local Historic District Name:** *No Data*  
**Historic District Significance:** *No Data*

**CRM Events**

**Event Type: Survey:Phase I/Reconnaissance**

**Project Review File Number:** *No Data*

**Investigator:** Erin Que  
**Organization/Company:** The 106 Group Ltd.  
**Photographic Media:** Digital  
**Survey Date:** 2/5/2020  
**Dhr Library Report Number:** *No Data*

**Project Staff/Notes:**

Erin Que, Principal Investigator and Sr. Architectural Historian  
Holly Good, Architectural Historian  
Saleh Miller, Sr. Architectural Historian

**Project Bibliographic Information:**

City of Charlottesville GIS Viewer  
2020 Property Record. Electronic document, <http://gisweb.charlottesville.org/GisViewer/>, accessed January 27, 2020.

Hill Directory Co.  
1931, 1940, 1950, 1959 Hill's Charlottesville City Directory. Hill Directory Co., Inc., Publishers, Richmond, Virginia.

National Environmental Title Research, LLC [NETR]  
1963-2016 Historical Aerial Photograph, Charlottesville Independent City, Virginia. Electronic document, <http://historicaerials.com/>, accessed March 19, 2020.

Neighborhood Development Services  
2012-2016 The 10th and Page Historic Survey. On file at the City of Charlottesville Neighborhood Development Services, Charlottesville, Virginia.

Sanborn Map Company  
1907, 1913, 1920, 1929, 1950 Fire Insurance Map of Charlottesville, Virginia. Sanborn Map Company, New York, New York.

United States Geological Survey [USGS]  
1994-2019 Historical Aerial Photograph, Charlottesville Independent City, Virginia. Electronic document, accessed on Google Earth, February 20, 2020.

**Bibliographic Information**

**Bibliography:**

*No Data*

**Property Notes:**

*No Data*

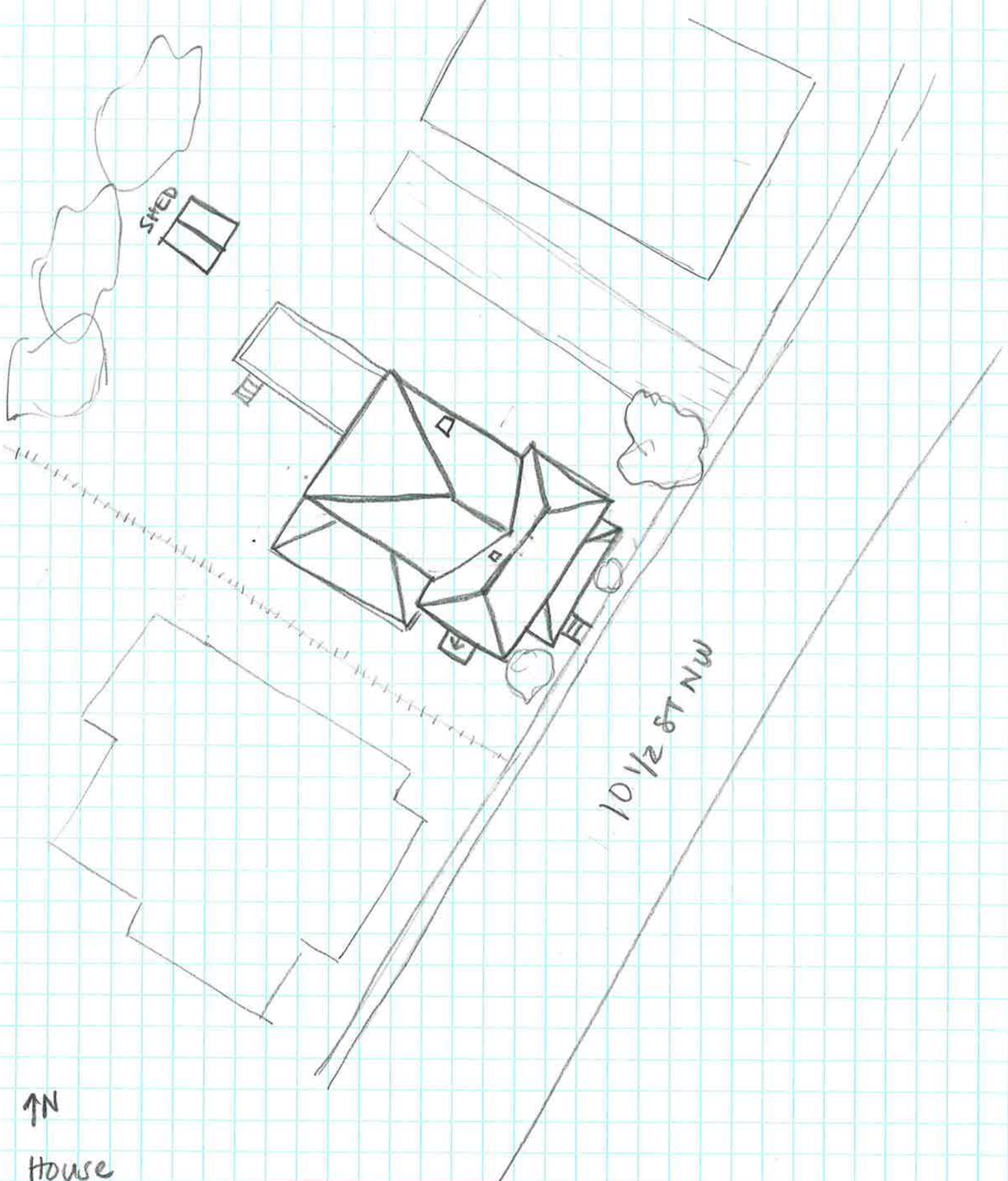

↑N

House  
104-5673  
339 10 1/2 ST NW  
SURVEY DATE 2/1/2020  
NOT TO SCALE