

Property Information

Property Names

Name Explanation	Name
Function/Location	House, 408 11th Street NW

Property Evaluation Status

Property Addresses

Current - 408 11th Street NW

County/Independent City(s):	Charlottesville (Ind. City)
Incorporated Town(s):	No Data
Zip Code(s):	22903
Magisterial District(s):	No Data
Tax Parcel(s):	No Data
USGS Quad(s):	CHARLOTTESVILLE EAST

Additional Property Information

Architecture Setting: Urban

Acreage: No Data

Site Description:

2016: This property was surveyed in 2012-2016 by City of Charlottesville Neighborhood Development Services. The front yard and sidewalk are separated by a privet hedge and a brick walkway leads from the sidewalk to the front door. A one-bay, outbuilding with gable roof and vinyl siding is sited at the end of an unpaved driveway at the side of the house. A similar outbuilding was located on the site in the late 1920s (see Sanborn Map) and it is possible this current structure is the same one.

Surveyor Assessment:

2016: Ownership History

Frank Thomas purchased the property from James D. Viand and James G. Ballard on December 9, 1905 (County 131 - 436). The property remained in the Thomas family for twenty-one years. Mr. Thomas sold the property in 1914 to his wife Mary Thomas (County 157 - 343). Mrs. Thomas willed the property to her daughter Eve Thomas Slaughter in 1924 and Mrs. Slaughter sold it through trustee John S. Graves to Bertha Compton in 1926 (City 55 - 38 and 293). She owned the house until 1973 (351 - 184).

Social History

Mary Thomas, the earliest resident of the house, was an African American domestic servant. Her husband Frank had purchased the property in 1905 and the couple lived in the house they built together with their daughter Eve until Frank's death in 1914 and Mary's death in 1924. Eve Thomas married into the Slaughter family and continued to live in the house until the late 1920s when she sold the property to African American laundress Bertha Compton. Bertha lived in the house for seven years, until 1935 when she married Granville Cooper, a butler, and changed her last name to his. The Coopers lived in the house until 1973.

Statement of Significance

Although the structure is mostly modern materials, the site maintains its original significance through connections to the social history of its residents. Several women owned and lived in the house with their families, including widow Mattie Thomas who continued to manage the property after her husband's death and Bertha Compton/Cooper who lived in the house with her husband Granville and their children for more than fifty years.

2020: This property is located in the potential 10th & Page Historic District, which is recommended as potentially eligible for listing in the NRHP. Further study is recommended to determine if the 10th & Page Historic District is eligible for listing in the NRHP under Criterion A in the areas of Ethnic Heritage, Community Planning and Development, and Social History, and under Criterion C in the area of Architecture. This property includes one contributing primary resource and one non-contributing secondary resource.

Surveyor Recommendation: Recommended Not Eligible

Ownership

Ownership Category	Ownership Entity
Private	No Data

Primary Resource Information

Resource Category:	Domestic
Resource Type:	Single Dwelling
NR Resource Type:	Building
Date of Construction:	ca 1914

Date Source: Local Records
Historic Time Period: Reconstruction and Growth (1866 - 1916)
Historic Context(s): Domestic
Other ID Number: *No Data*
Architectural Style: Vernacular
Form: *No Data*
Number of Stories: 2.0
Condition: Good
Threats to Resource: None Known

Architectural Description:

2016: This two-bay, two-story, frame dwelling was built around 1914. The first major rehabilitation took place in 1978, and the porch floor was replaced in 1987 (City Tax Records). The current dwelling has a hipped roof with asphalt shingles and an interior plaster-coated brick chimney. The windows are 1/1 vinyl sash with vinyl louvered shutters. Across the façade is a 2-bay front porch with simple, Doric columns, a shed roof, and contemporary wood railing.

Exterior Components

Component	Component Type	Material	Material Treatment
Structural System and Exterior Treatment	Wood Frame	Vinyl	Siding
Roof	Hipped	Asphalt	<i>No Data</i>
Chimneys	Interior Slope	Brick	Stuccoed/Parged
Windows	Double-hung	Vinyl	<i>No Data</i>
Porch	1-Story Full-Width	Wood	Doric

Secondary Resource Information

Secondary Resource #1

Resource Category: Domestic
Resource Type: Shed
NR Resource Type: Building
Date of Construction: ca 1994
Date Source: Map
Historic Time Period: Post Cold War (1992 - Present)
Historic Context(s): Domestic
Other ID Number: *No Data*
Architectural Style: No discernible style
Form: *No Data*
Number of Stories: 1.0
Condition: Good
Threats to Resource: None Known

Architectural Description:

2016: A one-bay, outbuilding with gable roof and vinyl siding is sited at the end of an unpaved driveway at the side of the house.

Historic District Information

Historic District Name: *No Data*
Local Historic District Name: *No Data*
Historic District Significance: *No Data*

CRM Events

Event Type: Survey:Phase I/Reconnaissance

Project Review File Number: *No Data*
Investigator: Erin Que
Organization/Company: The 106 Group Ltd.
Photographic Media: Digital
Survey Date: 2/5/2020
Dhr Library Report Number: *No Data*

Project Staff/Notes:

Erin Que, Principal Investigator and Sr. Architectural Historian
Holly Good, Architectural Historian
Saleh Miller, Sr. Architectural Historian

Project Bibliographic Information:

City of Charlottesville GIS Viewer
2020 Property Record. Electronic document, <http://gisweb.charlottesville.org/GisViewer/>, accessed January 27, 2020.

Hill Directory Co.
1931, 1940, 1950, 1959 Hill's Charlottesville City Directory. Hill Directory Co., Inc., Publishers, Richmond, Virginia.

National Environmental Title Research, LLC [NETR]
1963-2016 Historical Aerial Photograph, Charlottesville Independent City, Virginia. Electronic document, <http://historicaerials.com/>, accessed March 19, 2020.

Neighborhood Development Services
2012-2016 The 10th and Page Historic Survey. On file at the City of Charlottesville Neighborhood Development Services, Charlottesville, Virginia.

Sanborn Map Company
1907, 1913, 1920, 1929, 1950 Fire Insurance Map of Charlottesville, Virginia. Sanborn Map Company, New York, New York.

United States Geological Survey [USGS]
1994-2019 Historical Aerial Photograph, Charlottesville Independent City, Virginia. Electronic document, accessed on Google Earth, February 20, 2020.

Bibliographic Information

Bibliography:

No Data

Property Notes:

No Data

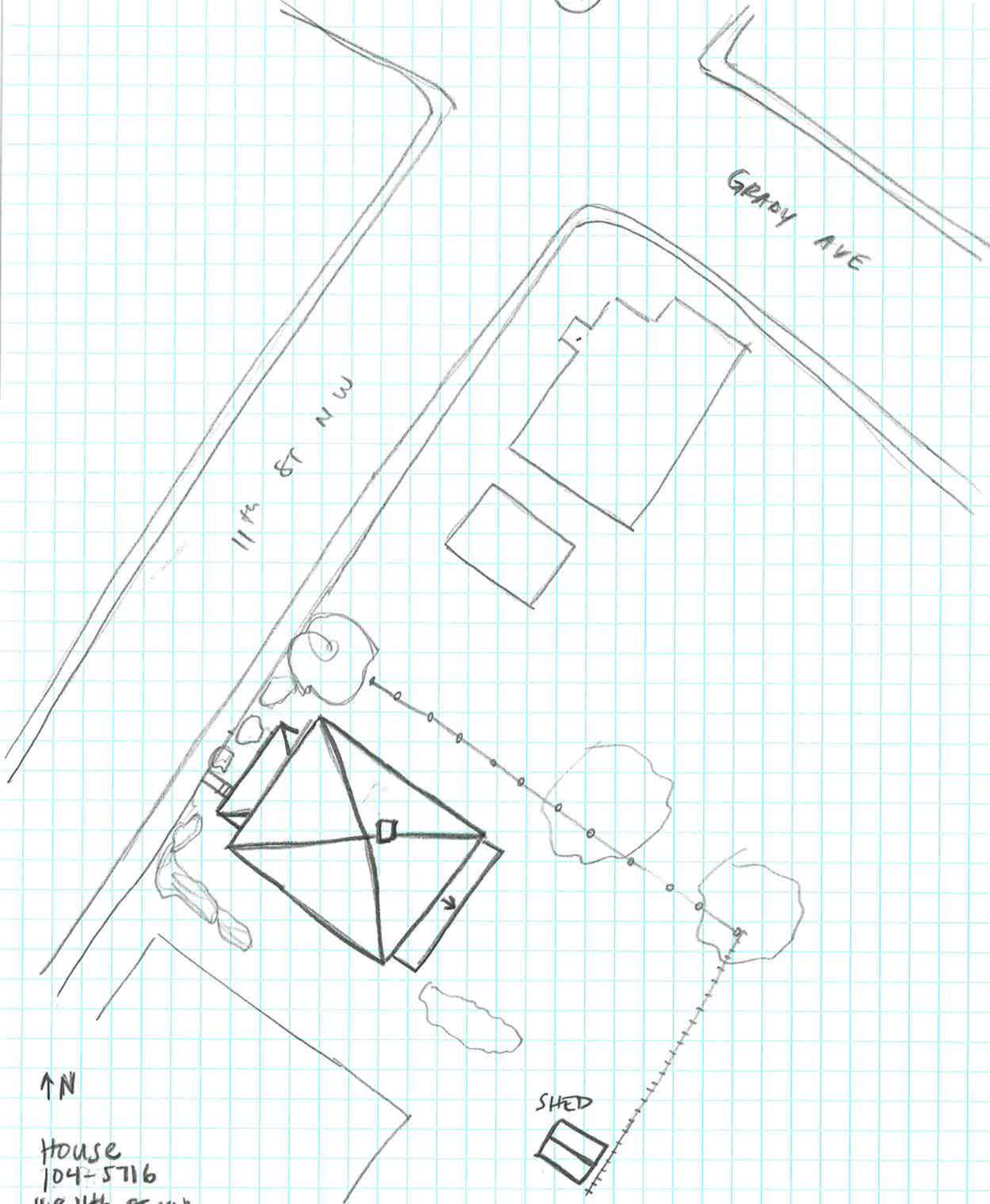

GRADY AVE

11th ST NW

SHED

↑ N

HOUSE
104-5716
408 11th ST NW
SURVEY DATE 2/1/2020
NOT TO SCALE