

Property Information

Property Names

Name Explanation Function/Location	Name House, 505 12th Street NW
--	--

Property Evaluation Status

Property Addresses

Current - 505 12th Street NW

County/Independent City(s):	Charlottesville (Ind. City)
Incorporated Town(s):	No Data
Zip Code(s):	22903
Magisterial District(s):	No Data
Tax Parcel(s):	No Data
USGS Quad(s):	CHARLOTTESVILLE EAST

Additional Property Information

Architecture Setting: Urban

Acreage: No Data

Site Description:

January 2020: This two-story house is located on the west side of 12th Street NW, halfway between Gordon and Grady Avenues. There is a small box hedge in the front yard, a small bush and a large tree near the northeast elevation of the house, and several large trees in the rear. A chain link fence runs along the northeast property line. This property consists of a house.

Surveyor Assessment:

January 2020: According to the Charlottesville City Property Records, this house was constructed in 1928 (City of Charlottesville GIS Viewer 2020). This date is confirmed by Sanborn Maps, which depicts two fairly different houses in 1920 and 1929. This house originally was a two-story, L-shaped dwelling with a full-width, one-story open front porch. The rear of the building was an L-shaped, one-story wing with a one-story open porch between the front half and the back half. As of 1929, there was a garage and an outbuilding in the rear of the property. By 1950, a secondary dwelling was built on the northeast elevation of the shed (Sanborn Map Company 1920; Sanborn Map Company 1929; Sanborn Map Company 1950). By 1968, the house achieved its present-day form through a second-story addition in the rear. The garage was demolished by 1968 and the secondary dwelling was demolished between 2002 and 2006 (NETR 1968; City of Charlottesville GIS Viewer 2020). This property was also historically addressed 407 12th Street NW. Vandrew Gross lived here between 1931 and 1959, if not longer (Hill Directory Co. 1931; Hill Directory Co. 1940; Hill Directory Co. 1950; Hill Directory Co. 1959). Otis Lee owned this property from 1963 to 2003, along with several other properties on this block (City of Charlottesville GIS Viewer 2020).

This property retains good integrity of location and setting. The integrity of design, materials, and workmanship has been compromised by replacement windows. This property retains good integrity of feeling and association. Overall, this property retains good integrity.

This property is recommended as not individually eligible for listing in the NRHP due to a lack of historical significance. However, it is located in the potential 10th & Page Historic District, which is recommended as potentially eligible for listing in the NRHP. Further study is recommended to determine if the 10th & Page Historic District is eligible for listing in the NRHP under Criterion A in the areas of Ethnic Heritage, Community Planning and Development, and Social History, and under Criterion C in the area of Architecture. This property includes one contributing primary resource.

Surveyor Recommendation: Recommended Not Eligible

Ownership

Ownership Category Private	Ownership Entity No Data
--------------------------------------	------------------------------------

Primary Resource Information

Resource Category:	Domestic
Resource Type:	Single Dwelling
NR Resource Type:	Building
Date of Construction:	1928
Date Source:	Local Records
Historic Time Period:	World War I to World War II (1917 - 1945)

Historic Context(s): Domestic
Other ID Number: *No Data*
Architectural Style: Vernacular
Form: *No Data*
Number of Stories: 2.0
Condition: Good
Threats to Resource: None Known

Architectural Description:

January 2020: This two-story house is clad in stucco and has a hipped roof that is covered with asphalt shingles. On the southeast-facing façade, the southwest half projects slightly forward. There is also a one-story, full-width, open porch on the facade. The porch is clad in stucco and has square stuccoed columns that round at the top to form arches and a hipped roof with asphalt shingles. There are woven blinds in the openings between the columns. The entranceway is located at the northeast end and accessed by concrete steps. There is an interior concrete block chimney near the ridge line and a vertical stack along the center of the northeast elevation. The stack is clad in vertical wood siding; this was likely a chimney that has been enclosed and truncated. There is a one-story wing on the northwest elevation that extends slightly beyond the northeast elevation. The wing is clad in stucco and has a shed roof. There is an exterior concrete block chimney near the north corner. Visible fenestration consists of one-over-one, double-hung, vinyl windows with faux dividers; and a single-leaf wood door with a metal and glass storm door.

Exterior Components

Component	Component Type	Material	Material Treatment
Chimneys	Interior Central	Concrete	Stuccoed/Parged
Porch	1-Story Full-Width	Stucco	Square
Structural System and Exterior Treatment	Wood Frame	Unknown	Stuccoed
Windows	Double-hung	Vinyl	<i>No Data</i>
Roof	Hipped	Asphalt	<i>No Data</i>

Secondary Resource Information

Historic District Information

Historic District Name: *No Data*
Local Historic District Name: *No Data*
Historic District Significance: *No Data*

CRM Events

Event Type: Survey:Phase I/Reconnaissance

Project Review File Number: *No Data*
Investigator: Erin Que
Organization/Company: The 106 Group Ltd.
Photographic Media: Digital
Survey Date: 2/5/2020
Dhr Library Report Number: *No Data*

Project Staff/Notes:

Erin Que, Principal Investigator and Sr. Architectural Historian
 Holly Good, Architectural Historian
 Saleh Miller, Sr. Architectural Historian

Project Bibliographic Information:

City of Charlottesville GIS Viewer
 2020 Property Record. Electronic document, <http://gisweb.charlottesville.org/GisViewer/>, accessed January 27, 2020.

Hill Directory Co.
 1931, 1940, 1950, 1959 Hill's Charlottesville City Directory. Hill Directory Co., Inc., Publishers, Richmond, Virginia.

National Environmental Title Research, LLC [NETR]
1963-2016 Historical Aerial Photograph, Charlottesville Independent City, Virginia. Electronic document, <http://historicaerials.com/>, accessed March 19, 2020.

Neighborhood Development Services
2012-2016 The 10th and Page Historic Survey. On file at the City of Charlottesville Neighborhood Development Services, Charlottesville, Virginia.

Sanborn Map Company
1907, 1913, 1920, 1929, 1950 Fire Insurance Map of Charlottesville, Virginia. Sanborn Map Company, New York, New York.

United States Geological Survey [USGS]
1994-2019 Historical Aerial Photograph, Charlottesville Independent City, Virginia. Electronic document, accessed on Google Earth, February 20, 2020.

Bibliographic Information

Bibliography:

No Data

Property Notes:

No Data

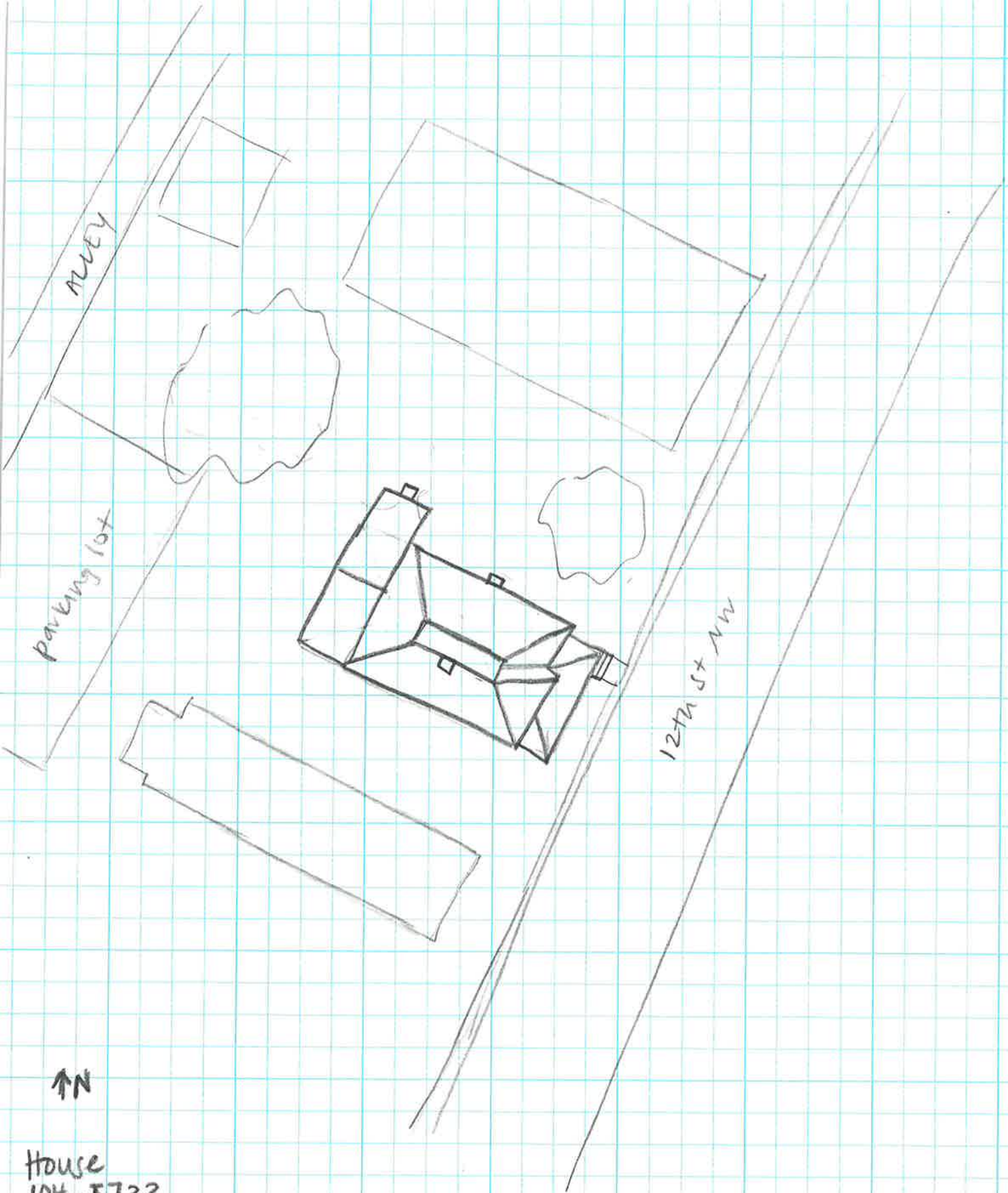

↑N

House
104-5733
505 12th St NW
SURVEY DATE 1/28/2020
NOT TO SCALE