

Property Information

Property Names

| | |
|-------------------------|---------------------------|
| Name Explanation | Name |
| Function/Location | House, 502 13th Street NW |

Property Evaluation Status

Property Addresses

Current - 502 13th Street NW

| | |
|------------------------------------|-----------------------------|
| County/Independent City(s): | Charlottesville (Ind. City) |
| Incorporated Town(s): | No Data |
| Zip Code(s): | 22903 |
| Magisterial District(s): | No Data |
| Tax Parcel(s): | No Data |
| USGS Quad(s): | CHARLOTTESVILLE EAST |

Additional Property Information

Architecture Setting: Urban

Acreage: No Data

Site Description:

January 2020: This house is located on the east side of 13th Street NW. There are large hedges in the front yard and along the northeast and southwest sides of the property. A chain link fence encloses the rear yard. A paved parking pad is located to the south of the house. This property consists of a house.

Surveyor Assessment:

January 2020: According to the Charlottesville City Property Records, this house was constructed in 1895 (City of Charlottesville GIS Viewer 2020). This street was first mapped by the Sanborn Map Company in 1920. In 1920, the property included a two-story, L-shaped dwelling with an open one-story porch on the façade and a one-story wing in the corner of the "L" (Sanborn Map Company 1920). By 1929, a one-story wing was constructed on the rear elevation and the wing in the corner of the "L" was extended to the east. The 1929 Sanborn Map also depicts a one-story outbuilding sited south of the house and one in the northeast corner of the lot, both of which are no longer extant (Sanborn Map Company 1929). According to the 1950 Sanborn Map, no changes had been made to the property by 1950 (Sanborn Map Company 1950). It is unknown when the wing in the corner of the "L" at the south corner of the house was replaced by the current two-story addition and louvered window enclosed one-story addition. According to aerial photographs, the present configuration of the house was achieved prior to 2002 (NETR 2002). This property also historically had an address of 402 13th Street NW. Various people resided at this property during the twentieth century, including William M. Carter, Rosa Carter, Clarence Watson, and Ernest B. Allen and his descendants until 2008 (Hill Directory Co. 1931; Hill Directory Co. 1940; Hill Directory Co. 1950; Hill Directory Co. 1959; City of Charlottesville GIS Viewer 2020).

This property retains good integrity of location and setting. The integrity of design, materials, and workmanship has been slightly compromised by replacement windows and additions on the southeast elevation. This property retains good integrity of feeling and association. Overall, this property retains good integrity.

This property is recommended as not individually eligible for listing in the NRHP due to a lack of historical significance. However, it is located in the potential 10th & Page Historic District, which is recommended as potentially eligible for listing in the NRHP. Further study is recommended to determine if the 10th & Page Historic District is eligible for listing in the NRHP under Criterion A in the areas of Ethnic Heritage, Community Planning and Development, and Social History, and under Criterion C in the area of Architecture. This property includes one contributing primary resource.

Surveyor Recommendation: Recommended Not Eligible

Ownership

| | |
|---------------------------|-------------------------|
| Ownership Category | Ownership Entity |
| Private | No Data |

Primary Resource Information

| | |
|------------------------------|---|
| Resource Category: | Domestic |
| Resource Type: | Single Dwelling |
| NR Resource Type: | Building |
| Date of Construction: | 1895 |
| Date Source: | Local Records |
| Historic Time Period: | Reconstruction and Growth (1866 - 1916) |

Historic Context(s): Domestic
Other ID Number: *No Data*
Architectural Style: Vernacular
Form: L-Plan
Number of Stories: 2.0
Condition: Good
Threats to Resource: None Known

Architectural Description:

January 2020: This two-story, L-shaped house rests on a concrete foundation, is faced in clapboard siding, and has a hipped roof that is covered with asphalt shingles. There is a one-story, almost full-width, open porch on the northwest-facing facade. The porch has brick piers that support tapered square columns and is covered by a hipped roof with asphalt shingles. The primary entrance on the façade is at the southwest end of the porch and is accessed by concrete steps. An exterior stretcher bond brick chimney is located at the northwest end of the northeast elevation. A one-story, shed roof wing is located on the rear elevation, and is faced in clapboard siding. Two late twentieth century additions are located in the corner of the "L" at the south corner of the house. The first is two stories in height and faced in clapboard siding. The second is one story in height with a shed roof and is enclosed with jalousied windows. Visible fenestration consists of two-over-two and one-over-one, double-hung vinyl windows; a single-leaf wood door; and a single-leaf wood door with six lights and a transom.

Exterior Components

| Component | Component Type | Material | Material Treatment |
|--|--------------------|----------|--------------------|
| Chimneys | Exterior End | Brick | Stretcher Bond |
| Foundation | Solid/Continuous | Concrete | Stuccoed/Parged |
| Porch | 1-Story Full-Width | Wood | Square |
| Structural System and Exterior Treatment | Wood Frame | Wood | Siding |
| Windows | Double-hung | Vinyl | <i>No Data</i> |
| Roof | Hipped | Asphalt | <i>No Data</i> |

Secondary Resource Information

Historic District Information

Historic District Name: *No Data*
Local Historic District Name: *No Data*
Historic District Significance: *No Data*

CRM Events

Event Type: Survey:Phase I/Reconnaissance

Project Review File Number: *No Data*
Investigator: Erin Que
Organization/Company: The 106 Group Ltd.
Photographic Media: Digital
Survey Date: 2/5/2020
Dhr Library Report Number: *No Data*

Project Staff/Notes:

Erin Que, Principal Investigator and Sr. Architectural Historian
 Holly Good, Architectural Historian
 Saleh Miller, Sr. Architectural Historian

Project Bibliographic Information:

City of Charlottesville GIS Viewer
 2020 Property Record. Electronic document, <http://gisweb.charlottesville.org/GisViewer/>, accessed January 27, 2020.
 Hill Directory Co.
 1931, 1940, 1950, 1959 Hill's Charlottesville City Directory. Hill Directory Co., Inc., Publishers, Richmond, Virginia.

National Environmental Title Research, LLC [NETR]
1963-2016 Historical Aerial Photograph, Charlottesville Independent City, Virginia. Electronic document, <http://historicaerials.com/>, accessed March 19, 2020.

Neighborhood Development Services
2012-2016 The 10th and Page Historic Survey. On file at the City of Charlottesville Neighborhood Development Services, Charlottesville, Virginia.

Sanborn Map Company
1907, 1913, 1920, 1929, 1950 Fire Insurance Map of Charlottesville, Virginia. Sanborn Map Company, New York, New York.

United States Geological Survey [USGS]
1994-2019 Historical Aerial Photograph, Charlottesville Independent City, Virginia. Electronic document, accessed on Google Earth, February 20, 2020.

Bibliographic Information

Bibliography:

No Data

Property Notes:

No Data

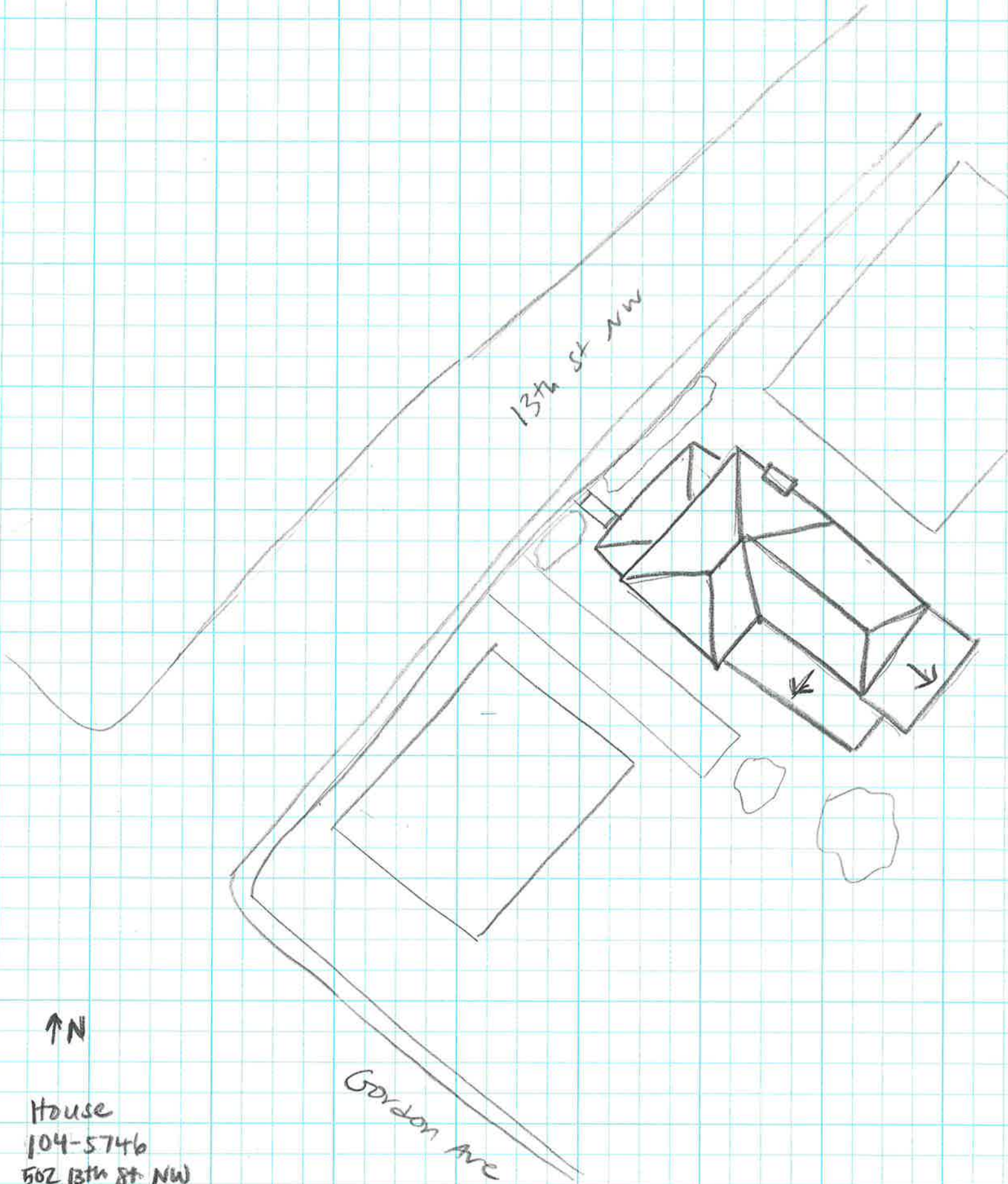

13th St NW

Gordon Ave

↑ N

House
104-5746
502 13th St NW
SURVEY DATE 1/28/2020
NOT TO SCALE