

### Property Information

**Property Names**

<b>Name Explanation</b>	<b>Name</b>
Function/Location	House, 508 13th Street NW

<b>Property Evaluation Status</b>
-----------------------------------

**Property Addresses**

Current - 508 13th Street NW

<b>County/Independent City(s):</b>	Charlottesville (Ind. City)
<b>Incorporated Town(s):</b>	No Data
<b>Zip Code(s):</b>	22903
<b>Magisterial District(s):</b>	No Data
<b>Tax Parcel(s):</b>	No Data
<b>USGS Quad(s):</b>	CHARLOTTESVILLE EAST

### Additional Property Information

**Architecture Setting:** Urban

**Acreeage:** No Data

**Site Description:**

January 2020: This one-story house is located on the east side of 13th Street NW. There are mature trees in the southeast (rear) half of the property. There is a shed in the east corner of the lot. A paved driveway is located at the southwest end. This property consists of a house and a shed.

**Surveyor Assessment:**

January 2020: According to the Charlottesville City Property Records, this house was constructed in 1920 (City of Charlottesville GIS Viewer 2020). This house first appears in the 1929 Sanborn Map as a one-story, rectangular dwelling with an open-story, partial width porch on the façade. A one-story outbuilding was also located to the east of the house, in the rear yard. According to aerial photographs, this outbuilding appears to be the extant rear structure (NETR 1968; NETR 2002; Sanborn Map Company 1929; Sanborn Map Company 1950). According to Google Streetview between 2012 and 2019, the hipped roof, one-story porch on the façade was replaced with the current front-gabled wood timber porch; and the siding and front door were replaced. This property historically had an address of 412 13th Street NW. The original owner was likely George W. King. The property was owned by King and his descendants until 2012 (City of Charlottesville GIS Viewer 2020; Hill Directory Co. 1931; Hill Directory Co. 1959).

This property retains good integrity of location and setting. The integrity of design, materials, and workmanship has been slightly compromised by replacement cladding and windows, and the reconstruction of the front porch. This property retains good integrity of feeling and association. Overall, this property retains fair integrity.

This property is recommended as not individually eligible for listing in the NRHP due to a lack of historical significance. However, it is located in the potential 10th & Page Historic District, which is recommended as potentially eligible for listing in the NRHP. Further study is recommended to determine if the 10th & Page Historic District is eligible for listing in the NRHP under Criterion A in the areas of Ethnic Heritage, Community Planning and Development, and Social History, and under Criterion C in the area of Architecture. This property includes one contributing primary resource and one contributing secondary resource.

**Surveyor Recommendation:** Recommended Not Eligible

**Ownership**

<b>Ownership Category</b>	<b>Ownership Entity</b>
Private	No Data

### Primary Resource Information

<b>Resource Category:</b>	Domestic
<b>Resource Type:</b>	Single Dwelling
<b>NR Resource Type:</b>	Building
<b>Date of Construction:</b>	1920
<b>Date Source:</b>	Local Records
<b>Historic Time Period:</b>	World War I to World War II (1917 - 1945)
<b>Historic Context(s):</b>	Domestic
<b>Other ID Number:</b>	No Data

**Architectural Style:** No discernible style  
**Form:** *No Data*  
**Number of Stories:** 1.0  
**Condition:** Good  
**Threats to Resource:** None Known

**Architectural Description:**

January 2020: This one-story house rests on a concrete foundation, is clad in vinyl siding, and has a cross gable roof that is covered with asphalt shingles. There is a one-story, open porch that spans two-thirds of the northwest-facing facade. The porch has a concrete foundation, square wood columns and beams, and a front gable roof. It is accessed by two concrete steps in the center. The main entranceway is centrally located on the facade. Visible fenestration consists of one-over-one, double-hung, vinyl windows; and a single-leaf wood door with a fanlight and inoperable wood shutters.

**Exterior Components**

Component	Component Type	Material	Material Treatment
Foundation	Solid/Continuous	Concrete	Uncoursed
Porch	1-Story Partial Width	Wood	Posts
Structural System and Exterior Treatment	Not Visible	Vinyl	Siding
Windows	Double-hung	Vinyl	<i>No Data</i>
Roof	Cross Gable	Asphalt	<i>No Data</i>

**Secondary Resource Information**

**Secondary Resource #1**

**Resource Category:** Domestic  
**Resource Type:** Shed  
**NR Resource Type:** Building  
**Date of Construction:** ca 1920  
**Date Source:** Map  
**Historic Time Period:** World War I to World War II (1917 - 1945)  
**Historic Context(s):** Domestic  
**Other ID Number:** *No Data*  
**Architectural Style:** No discernible style  
**Form:** *No Data*  
**Number of Stories:** 1.0  
**Condition:** Good  
**Threats to Resource:** None Known

**Architectural Description:**

January 2020: There is a one-story shed located to the east of the house. It is clad in clad in stucco and has a front gable roof that is covered with asphalt shingles. Visible fenestration consists of a single-leaf wood door.

**Exterior Components**

Component	Component Type	Material	Material Treatment
Structural System and Exterior Treatment	Not Visible	Unknown	Stuccoed
Roof	Front Gable	Asphalt	<i>No Data</i>

**Historic District Information**

**Historic District Name:** *No Data*  
**Local Historic District Name:** *No Data*  
**Historic District Significance:** *No Data*

## CRM Events

### Event Type: Survey:Phase I/Reconnaissance

**Project Review File Number:** *No Data*  
**Investigator:** Erin Que  
**Organization/Company:** The 106 Group Ltd.  
**Photographic Media:** Digital  
**Survey Date:** 2/5/2020  
**Dhr Library Report Number:** *No Data*

**Project Staff/Notes:**

Erin Que, Principal Investigator and Sr. Architectural Historian  
Holly Good, Architectural Historian  
Saleh Miller, Sr. Architectural Historian

**Project Bibliographic Information:**

City of Charlottesville GIS Viewer  
2020 Property Record. Electronic document, <http://gisweb.charlottesville.org/GisViewer/>, accessed January 27, 2020.

Hill Directory Co.  
1931, 1940, 1950, 1959 Hill's Charlottesville City Directory. Hill Directory Co., Inc., Publishers, Richmond, Virginia.

National Environmental Title Research, LLC [NETR]  
1963-2016 Historical Aerial Photograph, Charlottesville Independent City, Virginia. Electronic document, <http://historicaerials.com/>, accessed March 19, 2020.

Neighborhood Development Services  
2012-2016 The 10th and Page Historic Survey. On file at the City of Charlottesville Neighborhood Development Services, Charlottesville, Virginia.

Sanborn Map Company  
1907, 1913, 1920, 1929, 1950 Fire Insurance Map of Charlottesville, Virginia. Sanborn Map Company, New York, New York.

United States Geological Survey [USGS]  
1994-2019 Historical Aerial Photograph, Charlottesville Independent City, Virginia. Electronic document, accessed on Google Earth, February 20, 2020.

## Bibliographic Information

**Bibliography:**

*No Data*

**Property Notes:**

*No Data*

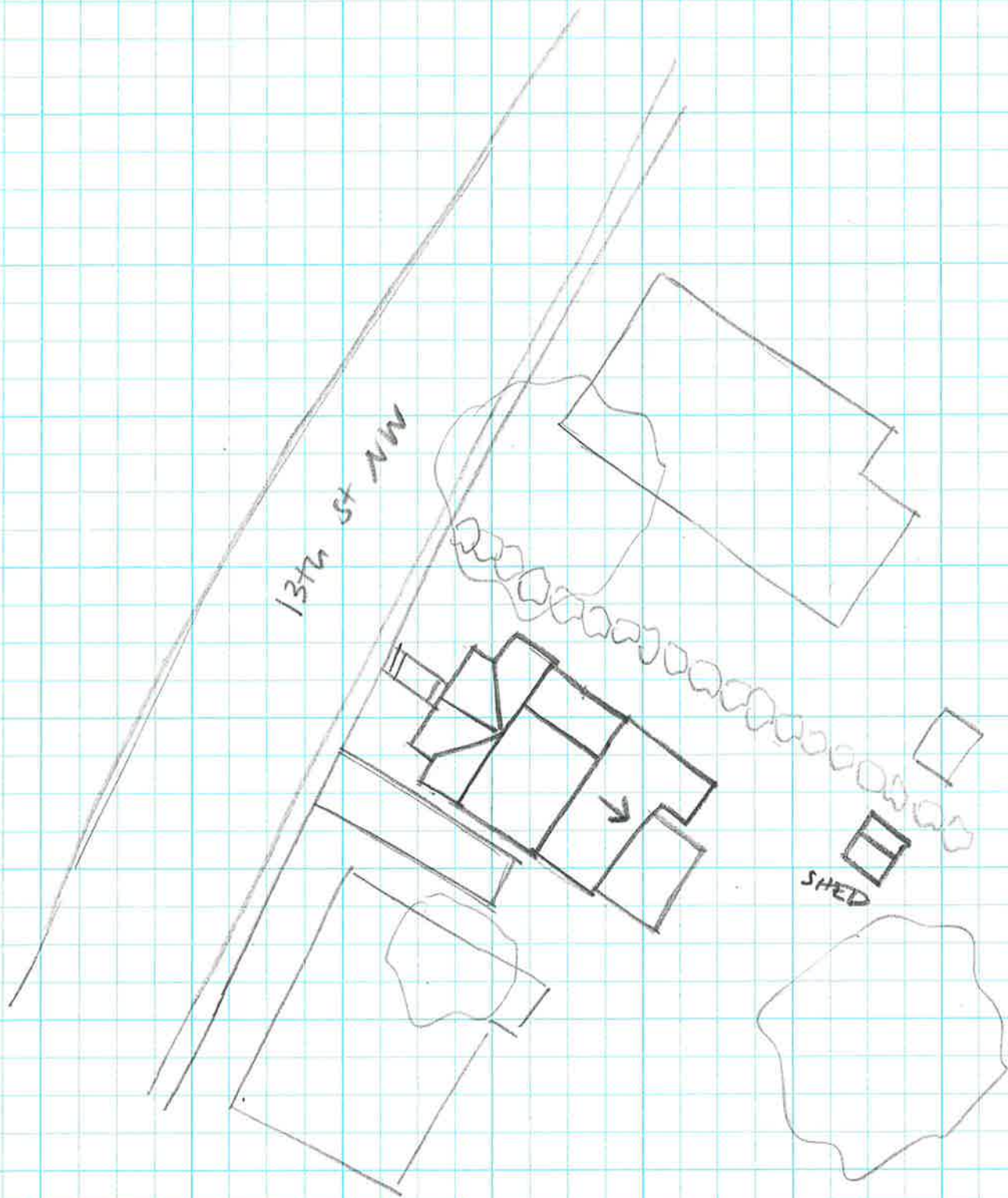

↑N

House  
104-5747  
508 13th ST NW  
SURVEY DATE 1/28/2020  
NOT TO SCALE