

Property Information

Property Names

Name Explanation	Name
Function/Location	House, 604 13th Street NW

Property Evaluation Status

Property Addresses

Current - 604 13th Street NW

County/Independent City(s):	Charlottesville (Ind. City)
Incorporated Town(s):	<i>No Data</i>
Zip Code(s):	22903
Magisterial District(s):	<i>No Data</i>
Tax Parcel(s):	<i>No Data</i>
USGS Quad(s):	CHARLOTTESVILLE EAST

Additional Property Information

Architecture Setting: Urban

Acreage: *No Data*

Site Description:

January 2020: This property is located on the east side of 13th Street NW, north of Grady Avenue. There is a large tree in the west corner of the lot, and box hedges along the northeast property line. A chain link fence surrounds the rear yard. There is a shed in the east corner of the lot. This property consists of a house and a shed.

Surveyor Assessment:

January 2020: According to the Charlottesville City Property Records, this house was constructed in 1900 (City of Charlottesville GIS Viewer 2020). However, this house does not appear on Sanborn Maps until 1950. Originally, the house was a small one-story structure with a full-width porch on the façade (Sanborn Map Company 1950; NETR 1968). The large rear addition was constructed between 2006 and 2009. The shed in the rear yard was also built between 2006 and 2009 (City of Charlottesville GIS Viewer 2020). This property seems to historically have had an address of 506 13th Street NW (Hill Directory Co. 1940; Hill Directory Co. 1959).

This property retains good integrity of location, setting, and association. The integrity of design, materials, workmanship, and feeling have been compromised by the multiple additions that completely obscure the original form and design of the house. Overall, this property retains poor integrity.

This property is recommended as not individually eligible for listing in the NRHP due to a lack of historical significance. However, it is located in the potential 10th & Page Historic District, which is recommended as potentially eligible for listing in the NRHP. Further study is recommended to determine if the 10th & Page Historic District is eligible for listing in the NRHP under Criterion A in the areas of Ethnic Heritage, Community Planning and Development, and Social History, and under Criterion C in the area of Architecture. This property includes one non-contributing primary resource and one non-contributing secondary resource.

Surveyor Recommendation: Recommended Not Eligible

Ownership

Ownership Category	Ownership Entity
Private	<i>No Data</i>

Primary Resource Information

Resource Category:	Domestic
Resource Type:	Single Dwelling
NR Resource Type:	Building
Date of Construction:	ca 1940
Date Source:	Local Records
Historic Time Period:	World War I to World War II (1917 - 1945)
Historic Context(s):	Domestic
Other ID Number:	<i>No Data</i>
Architectural Style:	No discernible style
Form:	<i>No Data</i>

Number of Stories: 2.0
Condition: Remodeled
Threats to Resource: None Known

Architectural Description:

2016: This house has been greatly remodeled over the years. According to Sanborn Maps, the one-story stucco clad portion of the house that is sited closest to the street (northwest) appears to be original, while the rear (southeast) two-story portion is all a modern addition (Sanborn Map Company 1950). The original main block is clad in stucco and has a side gable roof clad in green asphalt shingles with exposed rafter tails. A one-story, partial-width, open-air porch is located on the façade. The hipped roof porch is supported by wood posts. The main block has an exterior-end brick chimney on the southwest elevation. The addition consists of a large two-story portion on the rear of the main block, and a one-story, hipped roof porch on the western corner, that serves as the entrance to the addition. This large addition rests on a concrete block foundation, is clad in wood siding, and has a hipped roof with exposed rafter tails. A projecting one-story bay is located in the south corner of this addition. A one-story screened-in porch, with a second-story deck is located on the rear elevation of the addition. Visible fenestration includes fixed, square and diamond paned windows; single-leaf wood doors with one-light and metal storm doors; and two-over-two and 2016six-over-six, double hung, wood windows.

Exterior Components

Component	Component Type	Material	Material Treatment
Chimneys	Exterior End	Brick	Stretcher Bond
Foundation	Solid/Continuous	Concrete	Block
Porch	1-Story Partial Width	Wood	Posts
Structural System and Exterior Treatment	Wood Frame	Unknown	Stuccoed
Windows	Double-hung	Wood	No Data
Roof	Side Gable	Asphalt	No Data

Secondary Resource Information

Secondary Resource #1

Resource Category: Domestic
Resource Type: Shed
NR Resource Type: Building
Date of Construction: ca 2009
Date Source: Map
Historic Time Period: Post Cold War (1992 - Present)
Historic Context(s): Domestic
Other ID Number: No Data
Architectural Style: No discernible style
Form: No Data
Number of Stories: 1.0
Condition: Good
Threats to Resource: None Known

Architectural Description:

January 2020: There is a one-story shed located to the east of the house. It is clad in wood siding and has an asymmetrical side gable roof that is covered with asphalt shingles. Visible fenestration consists of a fixed, two-light, wood window.

Exterior Components

Component	Component Type	Material	Material Treatment
Structural System and Exterior Treatment	Wood Frame	Wood	Siding
Roof	Side Gable	Asphalt	No Data

Historic District Information

Historic District Name: No Data
Local Historic District Name: No Data
Historic District Significance: No Data

CRM Events

Event Type: Survey:Phase I/Reconnaissance

Project Review File Number: *No Data*
Investigator: Erin Que
Organization/Company: The 106 Group Ltd.
Photographic Media: Digital
Survey Date: 2/5/2020
Dhr Library Report Number: *No Data*

Project Staff/Notes:

Erin Que, Principal Investigator and Sr. Architectural Historian
Holly Good, Architectural Historian
Saleh Miller, Sr. Architectural Historian

Project Bibliographic Information:

City of Charlottesville GIS Viewer
2020 Property Record. Electronic document, <http://gisweb.charlottesville.org/GisViewer/>, accessed January 27, 2020.

Hill Directory Co.
1931, 1940, 1950, 1959 Hill's Charlottesville City Directory. Hill Directory Co., Inc., Publishers, Richmond, Virginia.

National Environmental Title Research, LLC [NETR]
1963-2016 Historical Aerial Photograph, Charlottesville Independent City, Virginia. Electronic document, <http://historicaerials.com/>, accessed March 19, 2020.

Neighborhood Development Services
2012-2016 The 10th and Page Historic Survey. On file at the City of Charlottesville Neighborhood Development Services, Charlottesville, Virginia.

Sanborn Map Company
1907, 1913, 1920, 1929, 1950 Fire Insurance Map of Charlottesville, Virginia. Sanborn Map Company, New York, New York.

United States Geological Survey [USGS]
1994-2019 Historical Aerial Photograph, Charlottesville Independent City, Virginia. Electronic document, accessed on Google Earth, February 20, 2020.

Bibliographic Information

Bibliography:

No Data

Property Notes:

No Data

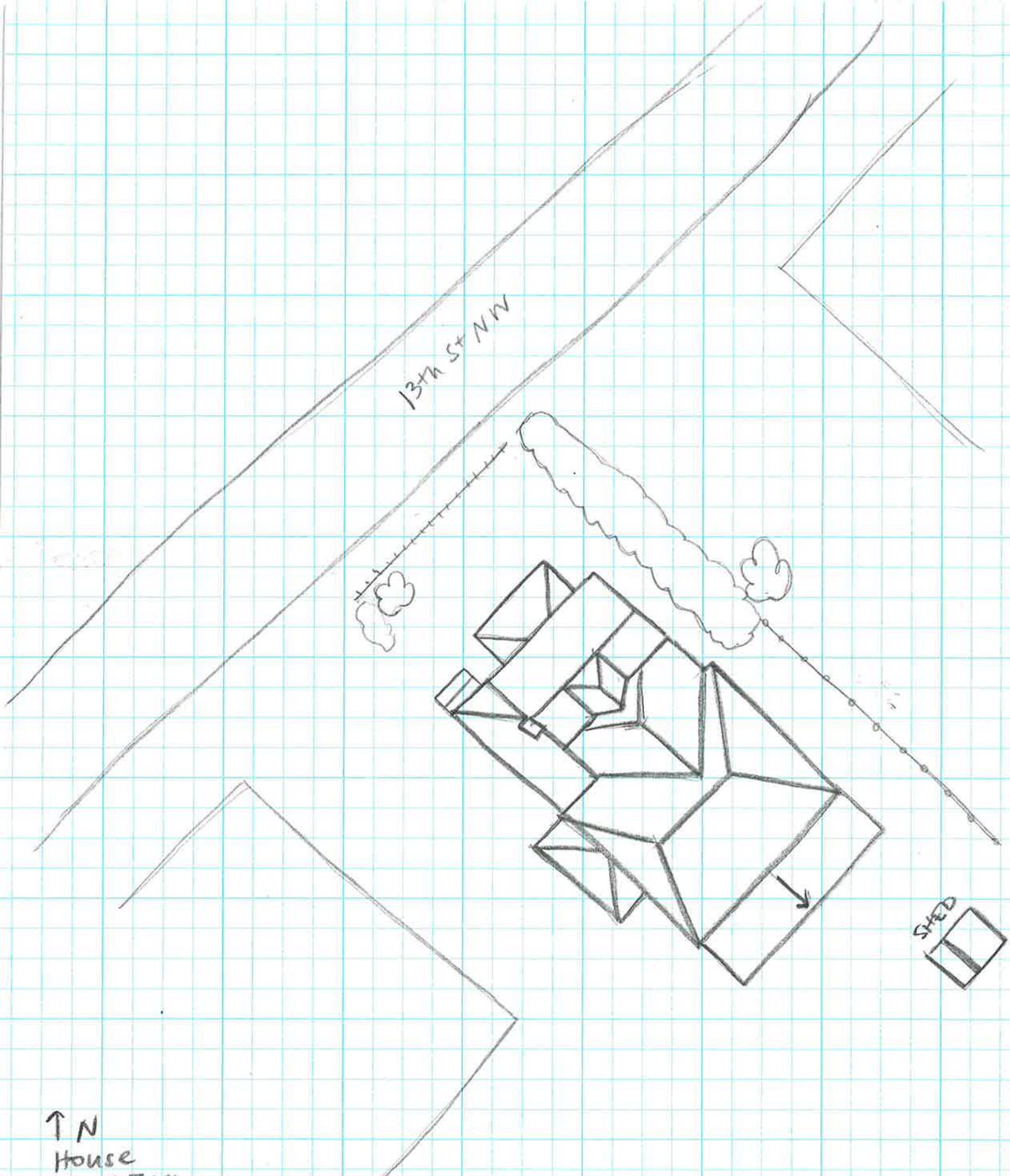

↑ N
House
104-5754
604 13th St NW
Survey Date 1/28/20
Not to Scale

SHED