

Property Information

Property Names

Name Explanation	Name
Function/Location	House, 314 8th Street NW

Property Evaluation Status

Property Addresses

Current - 314 8th Street NW

County/Independent City(s):	Charlottesville (Ind. City)
Incorporated Town(s):	No Data
Zip Code(s):	22903
Magisterial District(s):	No Data
Tax Parcel(s):	No Data
USGS Quad(s):	CHARLOTTESVILLE EAST

Additional Property Information

Architecture Setting: Urban

Acreage: No Data

Site Description:

January 2020: This two-story house is located on the east side of 8th Street NW, halfway between Anderson and Page Streets. There is a fieldstone along the front (northwest) property line. There is a large, deciduous tree in the southwest corner of the lot and a shed to the east of the house. The rear of the property is surrounded by a thin, metal and chicken-wire fence. This property consists of a house and a shed.

Surveyor Assessment:

January 2020: According to Charlottesville City Property Records, this house was constructed in 1925 (City of Charlottesville GIS Viewer 2020). However, this house first appears on the 1920 Sanborn Map with the same footprint it has on the other Sanborn Maps and into today, indicating it was built prior to 1920 (Sanborn Map Company 1920; Sanborn Map Company 1929; Sanborn Map Company 1950). A rear deck on the south corner of the house was installed c. 2017, at the same time as the rear shed (USGS 2016; USGS 2017). This property was owned by Lucille Anderson from 1962 to 1991 (City of Charlottesville GIS Viewer 2020).

This property retains excellent integrity of location and setting. The integrity of design, materials, and workmanship has been compromised through replacement windows, replacement cladding, and the addition of the rear deck. This property retains excellent integrity of feeling and association. Overall, this property retains good integrity.

This property is recommended as not individually eligible for listing in the NRHP due to a lack of historical significance. However, it is located in the potential 10th & Page Historic District, which is recommended as potentially eligible for listing in the NRHP. Further study is recommended to determine if the 10th & Page Historic District is eligible for listing in the NRHP under Criterion A in the areas of Ethnic Heritage, Community Planning and Development, and Social History, and under Criterion C in the area of Architecture. This property includes one contributing primary resource and one non-contributing secondary resource.

Surveyor Recommendation: Recommended Not Eligible

Ownership

Ownership Category	Ownership Entity
Private	No Data

Primary Resource Information

Resource Category:	Domestic
Resource Type:	Single Dwelling
NR Resource Type:	Building
Date of Construction:	ca 1920
Date Source:	Map
Historic Time Period:	World War I to World War II (1917 - 1945)
Historic Context(s):	Domestic
Other ID Number:	No Data
Architectural Style:	Vernacular
Form:	T-Plan

Number of Stories: 2.0
Condition: Good
Threats to Resource: None Known

Architectural Description:

January 2020: This two-story house sits on a concrete foundation, is clad in aluminum siding, and has a cross-gabled roof covered in standing seam metal. There are two, interior, brick chimneys located on the ridgeline. The front (northwest) facing façade features an almost full-width, one-story, open porch with a hipped roof. The porch roof is supported by turned wood columns with decorative brackets and the porch has a concrete floor. The main entrance to the house is located in the middle of this façade. The rear (southeast) elevation features a one-story, wood deck on the south corner. This deck has wood railings and is accessed by wood stairs with wood railings. Visible fenestration includes six-over-six, double-hung, vinyl windows, most with fixed wood shutters; a single-leaf, wood door with a single-light and four stained-glass squares above and below.

Exterior Components

Component	Component Type	Material	Material Treatment
Chimneys	Interior Central	Brick	Stretcher Bond
Foundation	Solid/Continuous	Concrete	Stuccoed/Parged
Porch	1-Story Full-Width	Wood	Posts
Structural System and Exterior Treatment	Wood Frame	Aluminum	Siding
Windows	Double-hung	Vinyl	No Data
Roof	Cross Gable	Metal	No Data

Secondary Resource Information

Secondary Resource #1

Resource Category: Domestic
Resource Type: Shed
NR Resource Type: Building
Date of Construction: ca 2017
Date Source: Map
Historic Time Period: Post Cold War (1992 - Present)
Historic Context(s): Domestic
Other ID Number: No Data
Architectural Style: No discernible style
Form: Rectangular
Number of Stories: 1.0
Condition: Excellent
Threats to Resource: None Known

Architectural Description:

January 2020: This shed is clad in vertical wood siding and has a shed roof covered in metal roofing. It also has a porch on the northwest façade. This porch has a shed roof and is supported by square, wood posts. Visible fenestration includes fixed, stained-glass, wood windows with multiple lights; and a single-leaf, vertical wood door.

Exterior Components

Component	Component Type	Material	Material Treatment
Porch	1-Story Full-Width	Wood	Posts
Structural System and Exterior Treatment	Wood Frame	Wood	Vertical Board
Windows	Fixed	Wood	No Data
Roof	Shed	Metal	No Data

Historic District Information

Historic District Name: No Data
Local Historic District Name: No Data
Historic District Significance: No Data

CRM Events

Event Type: Survey:Phase I/Reconnaissance

Project Review File Number: *No Data*
Investigator: Erin Que
Organization/Company: The 106 Group Ltd.
Photographic Media: Digital
Survey Date: 2/5/2020
Dhr Library Report Number: *No Data*

Project Staff/Notes:

Erin Que, Principal Investigator and Sr. Architectural Historian
Holly Good, Architectural Historian
Saleh Miller, Sr. Architectural Historian

Project Bibliographic Information:

City of Charlottesville GIS Viewer
2020 Property Record. Electronic document, <http://gisweb.charlottesville.org/GisViewer/>, accessed January 27, 2020.

Hill Directory Co.
1931, 1940, 1950, 1959 Hill's Charlottesville City Directory. Hill Directory Co., Inc., Publishers, Richmond, Virginia.

National Environmental Title Research, LLC [NETR]
1963-2016 Historical Aerial Photograph, Charlottesville Independent City, Virginia. Electronic document, <http://historicaerials.com/>, accessed March 19, 2020.

Neighborhood Development Services
2012-2016 The 10th and Page Historic Survey. On file at the City of Charlottesville Neighborhood Development Services, Charlottesville, Virginia.

Sanborn Map Company
1907, 1913, 1920, 1929, 1950 Fire Insurance Map of Charlottesville, Virginia. Sanborn Map Company, New York, New York.

United States Geological Survey [USGS]
1994-2019 Historical Aerial Photograph, Charlottesville Independent City, Virginia. Electronic document, accessed on Google Earth, February 20, 2020.

Bibliographic Information

Bibliography:

No Data

Property Notes:

No Data

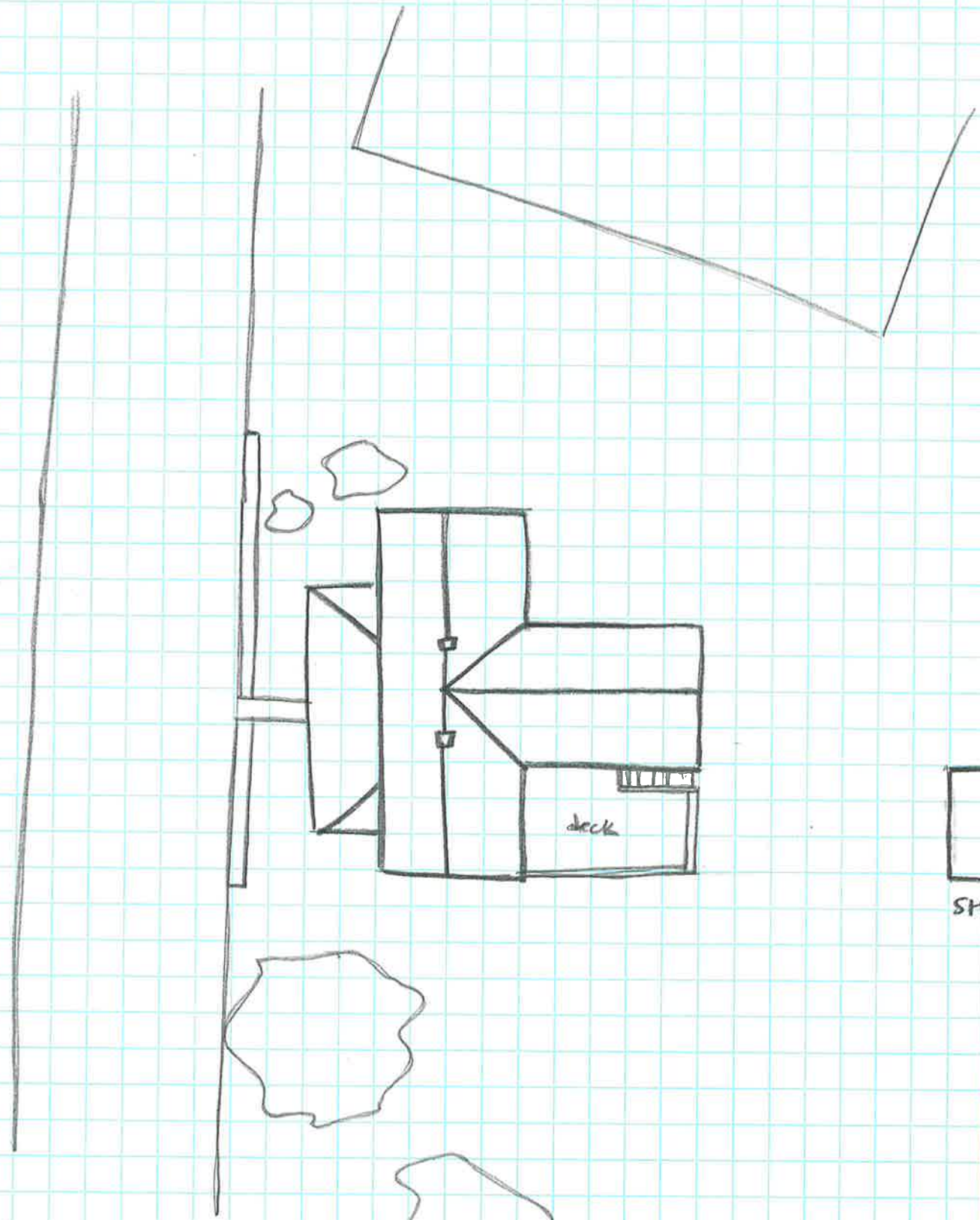

↑ N
HOUSE
104-5765
314 8th St NW
Survey Date 2/3/20
Not to Scale