

Property Information

Property Names

Name Explanation	Name
Function/Location	House, 208 9th Street NW

Property Evaluation Status

Property Addresses

Current - 208 9th Street NW

County/Independent City(s):	Charlottesville (Ind. City)
Incorporated Town(s):	No Data
Zip Code(s):	22903
Magisterial District(s):	No Data
Tax Parcel(s):	No Data
USGS Quad(s):	CHARLOTTESVILLE EAST

Additional Property Information

Architecture Setting: Urban

Acreage: No Data

Site Description:

January 2020: This two-story house is located on the west side of 9th Street NW, just south of Paoli Street. There is a low, concrete block retaining wall along the southeast property line with brick piers at a break in the wall for a concrete step to provide access to the house. This concrete wall connects to the retaining walls of adjacent properties. There is a large evergreen tree in the southeast corner of the lot, and additional trees in the rear of the lot, as well as a gravel driveway in the east corner. The backyard is surrounded by a horizontal, wood fence. There is a temporary, canvas shed in the southwest corner of the lot. This property consists of a house and a shed.

Surveyor Assessment:

January 2020: According to Charlottesville City Property Records, this house was constructed in 1925 (City of Charlottesville GIS Viewer 2020). However, the house first appears in the 1920 Sanborn Map with the same footprint that is evident in the other Sanborn Maps – indicating it was likely built prior to 1920. By 1929, there was a full-width, one-story rear addition and a partial-width, one-story addition on the northwest elevation of the larger rear addition (Sanborn Map Company 1920; Sanborn Map Company 1929; Sanborn Map Company 1950). Sanborn Maps also depict a one-story, engaged, open porch on the northeast elevation that was enclosed at an unknown date (USGS 2017). This house has almost the same roof structure and footprint as 214 and 210 9th Street NW and was likely constructed at the same time (USGS 1994; USGS 2017). The temporary, canvas shed in the southwest corner of the lot was erected sometime c. 2018 (City of Charlottesville GIS Viewer 2020).

This property retains excellent integrity of location and setting. The integrity of design, materials, and workmanship has been compromised by replacement windows, replacement cladding, and the enclosure of the historic porch on the northeast elevation. This property retains excellent integrity of feeling and association. Overall, this house retains good integrity.

This property is recommended as not individually eligible for listing in the NRHP due to a lack of historical significance. However, it is located in the potential 10th & Page Historic District, which is recommended as potentially eligible for listing in the NRHP. Further study is recommended to determine if the 10th & Page Historic District is eligible for listing in the NRHP under Criterion A in the areas of Ethnic Heritage, Community Planning and Development, and Social History, and under Criterion C in the area of Architecture. This property includes one contributing primary resource and one non-contributing secondary resource.

Surveyor Recommendation: Recommended Not Eligible

Ownership

Ownership Category	Ownership Entity
Private	No Data

Primary Resource Information

Resource Category:	Domestic
Resource Type:	Single Dwelling
NR Resource Type:	Building
Date of Construction:	ca 1920
Date Source:	Map
Historic Time Period:	World War I to World War II (1917 - 1945)

Historic Context(s): Domestic
Other ID Number: *No Data*
Architectural Style: Folk Victorian
Form: Rectangular
Number of Stories: 2.0
Condition: Good
Threats to Resource: None Known

Architectural Description:

January 2020: This two-story house sits on a brick foundation with concrete block infill, is clad in asbestos siding, and has a hipped roof with lower cross gables covered with asphalt shingles. There is an interior, central, brick chimney located in the center of the crosses on the ridge line. The front (southeast) facing façade features a full-width, one-story, open porch with a hipped roof. The porch roof is supported by turned wood columns resting on square brick piers with perforated brick knee walls in between. Along the cornice line, there is decorative spindlework and extended brackets. The porch is accessed by wide, wood stairs with wood railings. The front-facing gable projects slightly forward from the rest of the building. The main entrance to the house is located at the north end of this façade. The rear (northwest) facing elevation includes a full-width, one-story, asymmetrical front-gabled addition. In turn, there is an almost full-width, one-story, shed roof addition on the northwest elevation of the first addition (USGS 2017). Visible fenestration includes a single-leaf, wood door with a metal and glass storm door and a three-light transom with three-light sidelights; and two-over-two, double-hung, wood windows, some with metal screens.

Exterior Components

Component	Component Type	Material	Material Treatment
Chimneys	Interior Central	Brick	Stretcher Bond
Foundation	Solid/Continuous	Brick	Stretcher Bond
Porch	1-Story Full-Width	Wood	Turned
Structural System and Exterior Treatment	Wood Frame	Asbestos	Siding
Windows	Double-hung	Wood	<i>No Data</i>
Roof	Hipped w/Lower Cross Gables	Asphalt	<i>No Data</i>

Secondary Resource Information

Secondary Resource #1

Resource Category: Domestic
Resource Type: Shed
NR Resource Type: Building
Date of Construction: ca 2018
Date Source: Map
Historic Time Period: Post Cold War (1992 - Present)
Historic Context(s): Domestic
Other ID Number: *No Data*
Architectural Style: No discernible style
Form: Square
Number of Stories: 1.0
Condition: Excellent
Threats to Resource: None Known

Architectural Description:

January 2020: There is a temporary shed to the northwest of the house covered in plastic sheeting with a front-gabled roof also clad in plastic sheeting.

Exterior Components

Component	Component Type	Material	Material Treatment
Roof	Front Gable	Unknown	<i>No Data</i>

Historic District Information

Historic District Name: *No Data*
Local Historic District Name: *No Data*

Historic District Significance: *No Data*

CRM Events

Event Type: Survey:Phase I/Reconnaissance

Project Review File Number: *No Data*
Investigator: Erin Que
Organization/Company: The 106 Group Ltd.
Photographic Media: Digital
Survey Date: 2/5/2020
Dhr Library Report Number: *No Data*

Project Staff/Notes:

Erin Que, Principal Investigator and Sr. Architectural Historian
Holly Good, Architectural Historian
Saleh Miller, Sr. Architectural Historian

Project Bibliographic Information:

City of Charlottesville GIS Viewer
2020 Property Record. Electronic document, <http://gisweb.charlottesville.org/GisViewer/>, accessed January 27, 2020.

Hill Directory Co.
1931, 1940, 1950, 1959 Hill's Charlottesville City Directory. Hill Directory Co., Inc., Publishers, Richmond, Virginia.

National Environmental Title Research, LLC [NETR]
1963-2016 Historical Aerial Photograph, Charlottesville Independent City, Virginia. Electronic document, <http://historicaerials.com/>, accessed March 19, 2020.

Neighborhood Development Services
2012-2016 The 10th and Page Historic Survey. On file at the City of Charlottesville Neighborhood Development Services, Charlottesville, Virginia.

Sanborn Map Company
1907, 1913, 1920, 1929, 1950 Fire Insurance Map of Charlottesville, Virginia. Sanborn Map Company, New York, New York.

United States Geological Survey [USGS]
1994-2019 Historical Aerial Photograph, Charlottesville Independent City, Virginia. Electronic document, accessed on Google Earth, February 20, 2020.

Bibliographic Information

Bibliography:

No Data

Property Notes:

No Data

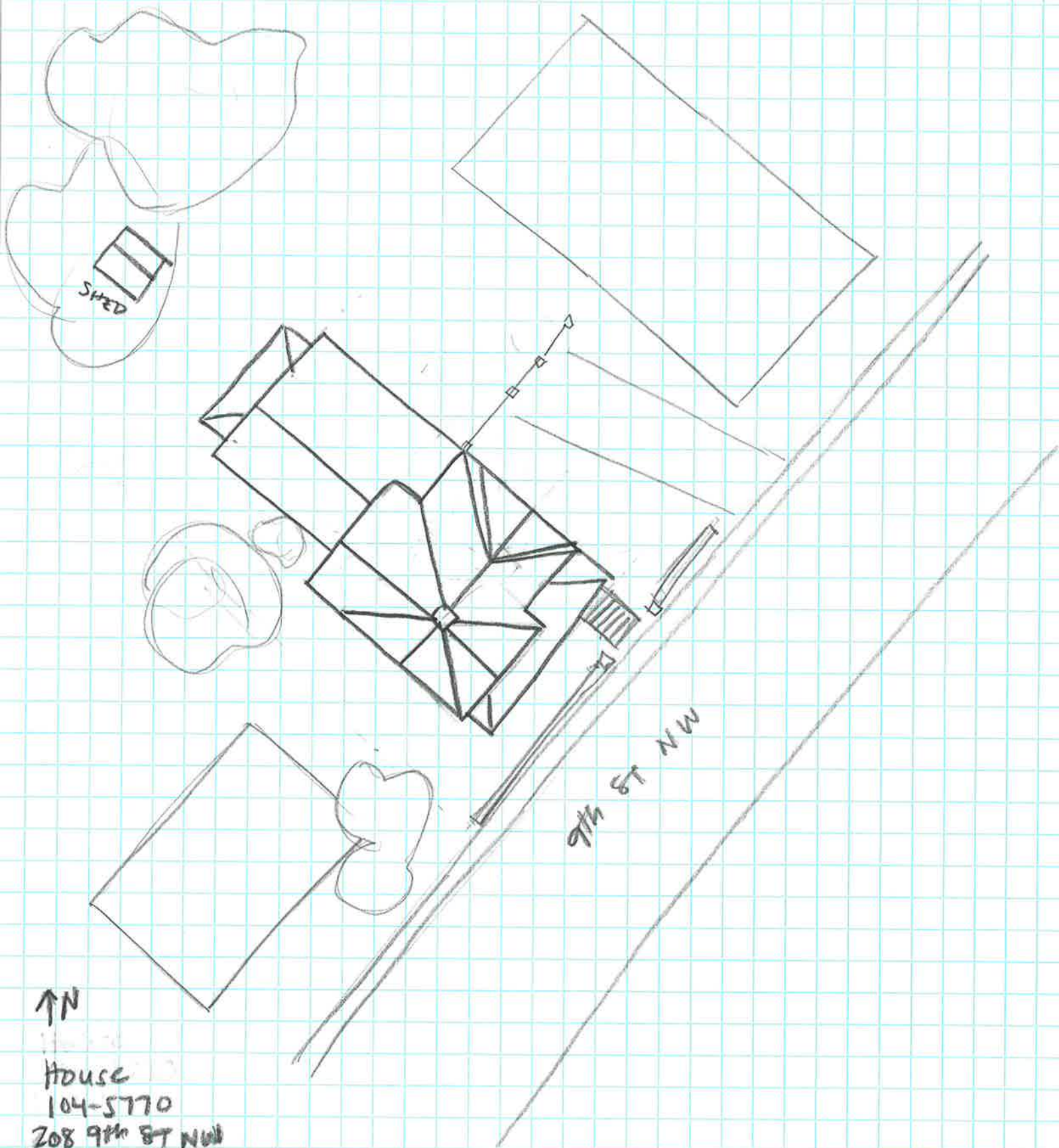

House
104-5770
208 9th St NW
SURVEY DATE 2/4/2020
NOT TO SCALE