

Property Information

Property Names

Name Explanation	Name
Function/Location	House, 213 9th Street NW

Property Evaluation Status

Property Addresses

Current - 213 9th Street NW

County/Independent City(s):	Charlottesville (Ind. City)
Incorporated Town(s):	No Data
Zip Code(s):	22903
Magisterial District(s):	No Data
Tax Parcel(s):	No Data
USGS Quad(s):	CHARLOTTESVILLE EAST

Additional Property Information

Architecture Setting: Urban

Acreeage: No Data

Site Description:

January 2020: This two-story house sits on the east side of 9th Street NW at the intersection of Paoli Street and 9th Street NW. There is a low, concrete and brick retaining wall along the northwest property line that continues along the southwest property line. There is a concrete patio on the northeast elevation of the house. The gravel parking pad near the north corner seems to belong to the neighboring house to the north. There is a large tree in the rear of the property as well as a metal, chain-link fence that runs along the southeast property line. This property consists of a house.

Surveyor Assessment:

January 2020: According to Charlottesville City Property Records, this house was constructed in 1947 (City of Charlottesville GIS Viewer 2020). This is supported by the Sanborn Maps, since the building first appeared on the 1950 Sanborn Map with the same general footprint it maintains today (Sanborn Map Company 1950). The rear, open, partial-width porch present in this map was enclosed in the early 2000s. Also at this time, a shed roof awning was added to the north end of the southeast elevation, likely above a basement entrance (Sanborn Map Company 1950; USGS 1994; USGS 2003; USGS 2005). This property was owned by Virginia Banks Carrington from 1962 to 2003 (City of Charlottesville GIS Viewer 2020).

This property retains excellent integrity of location and setting. The integrity of design, materials, and workmanship has been compromised by the rear porch changes, some replacement windows, and the addition of the front awnings. This property retains good integrity of feeling and association. Overall, this property retains fair integrity.

This property is recommended as not individually eligible for listing in the NRHP due to a lack of historical significance. However, it is located in the potential 10th & Page Historic District, which is recommended as potentially eligible for listing in the NRHP. Further study is recommended to determine if the 10th & Page Historic District is eligible for listing in the NRHP under Criterion A in the areas of Ethnic Heritage, Community Planning and Development, and Social History, and under Criterion C in the area of Architecture. This property includes one contributing primary resource.

Surveyor Recommendation: Recommended Not Eligible

Ownership

Ownership Category	Ownership Entity
Private	No Data

Primary Resource Information

Resource Category:	Domestic
Resource Type:	Single Dwelling
NR Resource Type:	Building
Date of Construction:	1947
Date Source:	Local Records
Historic Time Period:	The New Dominion (1946 - 1991)
Historic Context(s):	Domestic
Other ID Number:	No Data

Architectural Style: Vernacular
Form: Rectangular
Number of Stories: 2.0
Condition: Good
Threats to Resource: None Known

Architectural Description:

January 2020: This two-story house sits on a concrete block foundation, is constructed of concrete block, and has a front-gabled roof covered in asphalt shingles. There is an exterior, concrete block chimney on the northeast elevation; it has some brick infill. The front (northwest) facing façade features a partial-width, one-story, open porch with a hipped roof. The porch roof is supported by square wood posts and the porch is accessed by concrete block steps, covered in green felt, with metal railings. This porch and all of the windows on this façade have metal, shed-roof awnings. The southeast elevation features a half-width, enclosed porch with a shed roof in the south end and a shed roof awning in the north end (USGS 2016). All of the windows on the house also have sills comprised of header bricks. Visible fenestration includes six-over-six, double-hung, wood windows, some with metal storm windows/screens; six-over-six, double-hung, vinyl windows, some with metal storm windows/screens; and a single-leaf, wood door with two lights, and a metal and glass storm door.

Exterior Components

Component	Component Type	Material	Material Treatment
Chimneys	Exterior End	Concrete	Block
Foundation	Solid/Continuous	Concrete	Block
Porch	1-Story Partial Width	Wood	Square
Structural System and Exterior Treatment	Masonry	Concrete	Block
Windows	Double-hung	Wood	No Data
Roof	Front Gable	Asphalt	No Data

Secondary Resource Information

Historic District Information

Historic District Name: No Data
Local Historic District Name: No Data
Historic District Significance: No Data

CRM Events

Event Type: Survey:Phase I/Reconnaissance

Project Review File Number: No Data
Investigator: Erin Que
Organization/Company: The 106 Group Ltd.
Photographic Media: Digital
Survey Date: 2/5/2020
Dhr Library Report Number: No Data

Project Staff/Notes:

Erin Que, Principal Investigator and Sr. Architectural Historian
 Holly Good, Architectural Historian
 Saleh Miller, Sr. Architectural Historian

Project Bibliographic Information:

City of Charlottesville GIS Viewer
 2020 Property Record. Electronic document, <http://gisweb.charlottesville.org/GisViewer/>, accessed January 27, 2020.

Hill Directory Co.
 1931, 1940, 1950, 1959 Hill's Charlottesville City Directory. Hill Directory Co., Inc., Publishers, Richmond, Virginia.

National Environmental Title Research, LLC [NETR]
 1963-2016 Historical Aerial Photograph, Charlottesville Independent City, Virginia. Electronic document, <http://historicaerials.com/>, accessed March 19, 2020.

Neighborhood Development Services
2012-2016 The 10th and Page Historic Survey. On file at the City of Charlottesville Neighborhood Development Services, Charlottesville, Virginia.

Sanborn Map Company
1907, 1913, 1920, 1929, 1950 Fire Insurance Map of Charlottesville, Virginia. Sanborn Map Company, New York, New York.

United States Geological Survey [USGS]
1994-2019 Historical Aerial Photograph, Charlottesville Independent City, Virginia. Electronic document, accessed on Google Earth, February 20, 2020.

Bibliographic Information

Bibliography:

No Data

Property Notes:

No Data

PAOLI ST

9th St NW

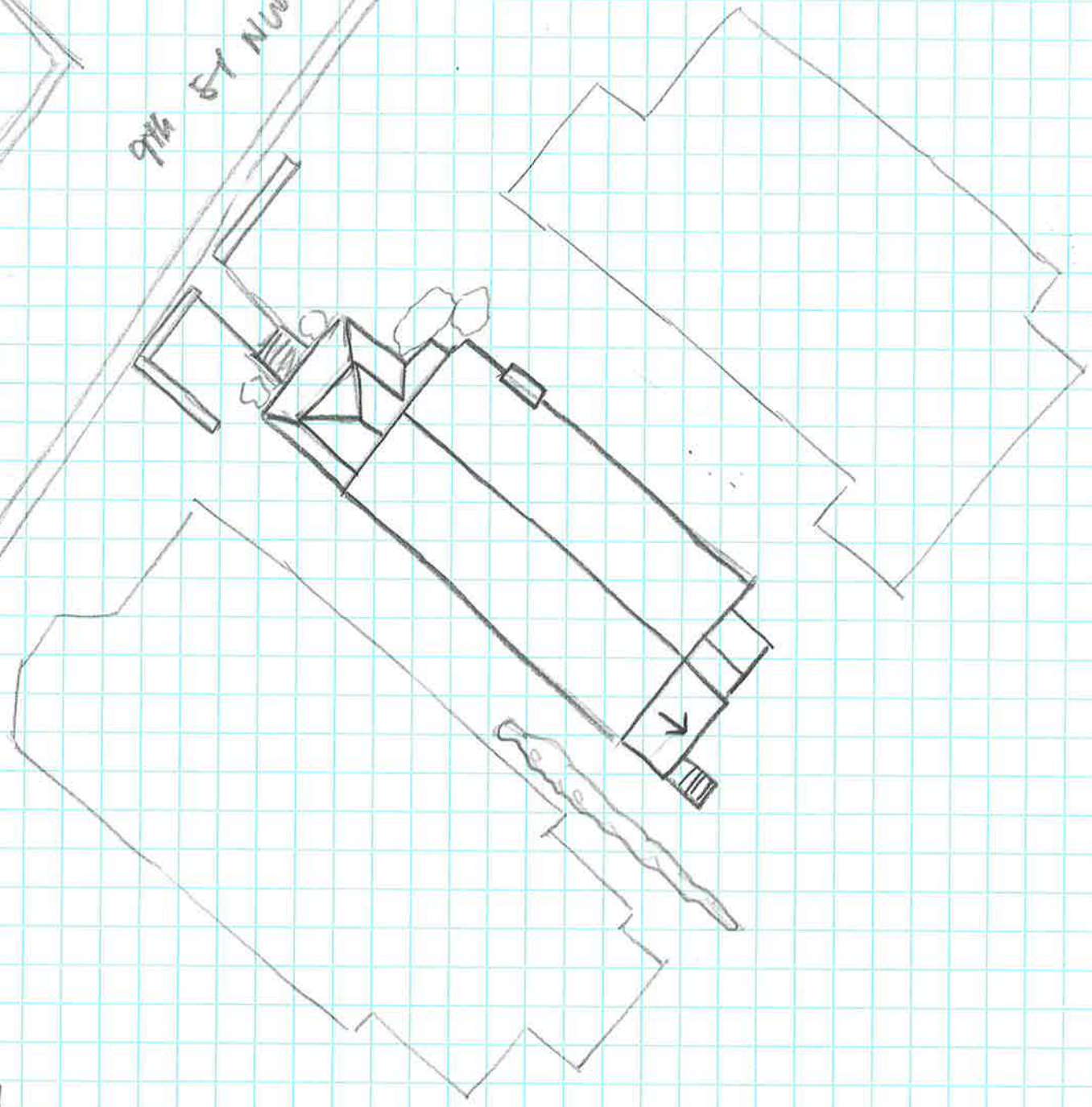

↑N

House

104-5773

213 9th St NW

SURVEY DATE 2/4/2020

NOT TO SCALE