

### Property Information

#### Property Names

Name Explanation	Name
Function/Location	House, 409 9th Street NW

#### Property Evaluation Status

#### Property Addresses

Current - 409 9th Street NW

County/Independent City(s):	Charlottesville (Ind. City)
Incorporated Town(s):	No Data
Zip Code(s):	22903
Magisterial District(s):	No Data
Tax Parcel(s):	No Data
USGS Quad(s):	CHARLOTTESVILLE EAST

### Additional Property Information

Architecture Setting: Urban

Acreage: No Data

#### Site Description:

January 2020: This two-story house is located on the west side of 9th Street NW, north of Anderson Street. The property is surrounded by a metal, chain-link fence with a white picket fence near the entrance to the house. The rear of the property is also enclosed by a wood fence. There are small box hedges dotted throughout the property. This property consists of a house and a shed.

#### Surveyor Assessment:

January 2020: According to Charlottesville City Property Records, this house was constructed in 1925 (City of Charlottesville GIS Viewer 2020). This is confirmed by the Sanborn Maps, since it first appears on the 1929 Sanborn Map, as 123 Alfonsa Street, replacing an earlier residence on the same property (Sanborn Map Company 1929; Sanborn Map Company 1950). On both the 1929 and 1950 Sanborn Maps, there is a one-story, rear wing, which was expanded to a two-story wing after 1994 (Sanborn Map Company 1929; Sanborn Map Company 1950; USGS 1994; USGS 2003). A small rear addition was built c. 2016 (City of Charlottesville GIS Viewer 2020). The shed in the northwest corner of the property was also constructed in the early 2000s (USGS 2003; USGS 2005; USGS 2006). The front porch was enclosed at an unknown date.

This property retains excellent integrity of location and setting. The integrity of design, materials, and workmanship has been compromised by replacement windows, some replacement cladding, the front porch enclosure, and changes to the rear wing. The property retains excellent integrity of feeling and association. Overall, this property retains good integrity.

This property is recommended as not individually eligible for listing in the NRHP due to a lack of historical significance. However, it is located in the potential 10th & Page Historic District, which is recommended as potentially eligible for listing in the NRHP. Further study is recommended to determine if the 10th & Page Historic District is eligible for listing in the NRHP under Criterion A in the areas of Ethnic Heritage, Community Planning and Development, and Social History, and under Criterion C in the area of Architecture. This property includes one contributing primary resource and one non-contributing secondary resource.

Surveyor Recommendation: Recommended Not Eligible

#### Ownership

Ownership Category	Ownership Entity
Private	No Data

### Primary Resource Information

Resource Category:	Domestic
Resource Type:	Single Dwelling
NR Resource Type:	Building
Date of Construction:	1925
Date Source:	Local Records
Historic Time Period:	World War I to World War II (1917 - 1945)
Historic Context(s):	Domestic
Other ID Number:	No Data
Architectural Style:	Vernacular

**Form:** Rectangular  
**Number of Stories:** 2.0  
**Condition:** Good  
**Threats to Resource:** None Known

**Architectural Description:**

January 2020: This two-story house sits on a stuccoed foundation, is clad in stucco, and has a front-gabled roof covered in asphalt shingles. The front (southeast) facing façade features an almost full-width, one-story, enclosed porch with a hipped roof covered in asphalt shingles. The porch roof is supported by square wood columns. The porch is clad in vertical wood siding and screens, and is accessed by concrete steps with wood railings. The main entrance to this house is located at the north end of this façade. The northwest (rear) facing elevation features a two-story, full-width, front-gabled wing. The second story of this wing is clad in vinyl siding while the first is stuccoed like the rest of the house. Aerial photographs also indicate that there is a one-story, partial-width addition on the northwest elevation with a shed roof (USGS 2016). Visible fenestration includes one-over-one, double-hung, vinyl windows, some with plastic screens; screened openings; and a single-leaf, wood door with a wood and glass storm door.

**Exterior Components**

Component	Component Type	Material	Material Treatment
Foundation	Solid/Continuous	Unknown	Stuccoed/Parged
Porch	1-Story Full-Width	Wood	Screened/Enclosed
Structural System and Exterior Treatment	Wood Frame	Unknown	Stuccoed
Windows	Double-hung	Vinyl	No Data
Roof	Front Gable	Asphalt	No Data

**Secondary Resource Information**

**Secondary Resource #1**

**Resource Category:** Domestic  
**Resource Type:** Shed  
**NR Resource Type:** Building  
**Date of Construction:** ca 2000  
**Date Source:** Map  
**Historic Time Period:** Post Cold War (1992 - Present)  
**Historic Context(s):** Domestic  
**Other ID Number:** No Data  
**Architectural Style:** No discernible style  
**Form:** No Data  
**Number of Stories:** 1.0  
**Condition:** Good  
**Threats to Resource:** None Known

**Architectural Description:**

January 2020: There is a one-story shed to the northwest of this house. This shed is clad in vertical plywood siding and has a gambrel roof covered in asphalt shingles. Visible fenestration includes wood paneled swing doors.

**Exterior Components**

Component	Component Type	Material	Material Treatment
Structural System and Exterior Treatment	Wood Frame	Wood	Vertical Board
Roof	Gambrel	Asphalt	No Data

**Historic District Information**

**Historic District Name:** No Data  
**Local Historic District Name:** No Data  
**Historic District Significance:** No Data

## CRM Events

### Event Type: Survey:Phase I/Reconnaissance

**Project Review File Number:** *No Data*  
**Investigator:** Erin Que  
**Organization/Company:** The 106 Group Ltd.  
**Photographic Media:** Digital  
**Survey Date:** 2/5/2020  
**Dhr Library Report Number:** *No Data*

**Project Staff/Notes:**

Erin Que, Principal Investigator and Sr. Architectural Historian  
Holly Good, Architectural Historian  
Saleh Miller, Sr. Architectural Historian

**Project Bibliographic Information:**

City of Charlottesville GIS Viewer  
2020 Property Record. Electronic document, <http://gisweb.charlottesville.org/GisViewer/>, accessed January 27, 2020.

Hill Directory Co.  
1931, 1940, 1950, 1959 Hill's Charlottesville City Directory. Hill Directory Co., Inc., Publishers, Richmond, Virginia.

National Environmental Title Research, LLC [NETR]  
1963-2016 Historical Aerial Photograph, Charlottesville Independent City, Virginia. Electronic document, <http://historicaerials.com/>, accessed March 19, 2020.

Neighborhood Development Services  
2012-2016 The 10th and Page Historic Survey. On file at the City of Charlottesville Neighborhood Development Services, Charlottesville, Virginia.

Sanborn Map Company  
1907, 1913, 1920, 1929, 1950 Fire Insurance Map of Charlottesville, Virginia. Sanborn Map Company, New York, New York.

United States Geological Survey [USGS]  
1994-2019 Historical Aerial Photograph, Charlottesville Independent City, Virginia. Electronic document, accessed on Google Earth, February 20, 2020.

## Bibliographic Information

**Bibliography:**

*No Data*

**Property Notes:**

*No Data*

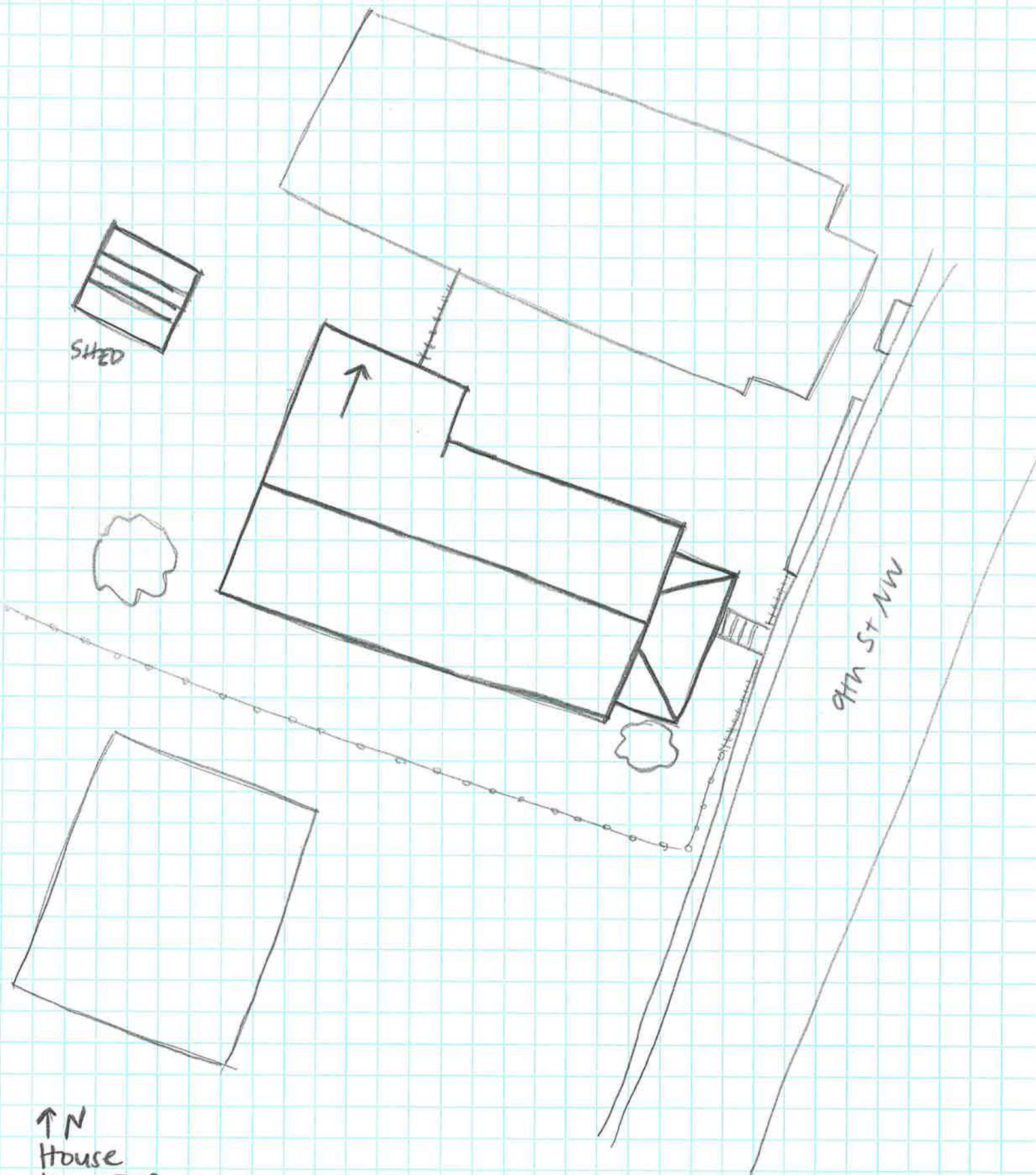

↑ N  
House  
104-5778  
409 9th St NW  
Survey Date 2/4/20  
Not to Scale