

Property Information

Property Names

Name Explanation	Name
Function/Location	House, 702 Anderson Street

Property Evaluation Status

Property Addresses

Current - 702 Anderson Street

County/Independent City(s):	Charlottesville (Ind. City)
Incorporated Town(s):	No Data
Zip Code(s):	22903
Magisterial District(s):	No Data
Tax Parcel(s):	No Data
USGS Quad(s):	CHARLOTTESVILLE EAST

Additional Property Information

Architecture Setting: Urban

Acreage: No Data

Site Description:

January 2020: This one-and-a-half story house is located on the west corner of Anderson Street and 7th Street NW, before the street becomes Albemarle Street. It is surrounded by a rounded, rough-cut, wood fence. There is a gravel parking pad in the northeast corner of the lot, and it is the largest lot on the street. The site slopes away from the street towards the south, exposing a large basement. There is a large tree near the east corner and some bushes in the front yard. This property consists of a house.

Surveyor Assessment:

January 2020: According to Charlottesville City Property Records, this house was constructed in 1931 (City of Charlottesville GIS Viewer 2020). This property first appears on the 1950 Sanborn Map with an open front porch and an open, partial-width, rear porch, as well as a garage in the southeast corner of the lot, accessed by an alleyway from 7th Street NW (Sanborn Map Company 1950). The rear porch was demolished and replaced with a smaller porch in the early 1990s, when the shed was demolished as well (USGS 1994; NETR 1968). Shelton Flood lived here until at least 1959 (Hill Directory Co. 1940; Hill Directory Co. 1959). The property has been owned by Irene Burton since 1977 (City of Charlottesville GIS Viewer 2020).

This property retains excellent integrity of location and setting. The integrity of design, materials, and workmanship has been compromised by replacement cladding, replacement windows, and changes to the rear porch. This property retains excellent integrity of feeling and association. Overall, this property retains good integrity.

This property is recommended as not individually eligible for listing in the NRHP due to a lack of historical significance. However, it is located in the potential 10th & Page Historic District, which is recommended as potentially eligible for listing in the NRHP. Further study is recommended to determine if the 10th & Page Historic District is eligible for listing in the NRHP under Criterion A in the areas of Ethnic Heritage, Community Planning and Development, and Social History, and under Criterion C in the area of Architecture. This property includes one contributing primary resource.

Surveyor Recommendation: Recommended Not Eligible

Ownership

Ownership Category	Ownership Entity
Private	No Data

Primary Resource Information

Resource Category:	Domestic
Resource Type:	Single Dwelling
NR Resource Type:	Building
Date of Construction:	1931
Date Source:	Local Records
Historic Time Period:	World War I to World War II (1917 - 1945)
Historic Context(s):	Domestic
Other ID Number:	No Data
Architectural Style:	Vernacular

Form: Square
Number of Stories: 1.5
Condition: Good
Threats to Resource: None Known

Architectural Description:

January 2020: This one-and-a-half-story house sits on a concrete block foundation, is clad in vinyl siding on the first story, wood shakes on the second story, and has a side-gabled roof covered in asphalt shingles that extends to cover a full-width, one-story open porch. This porch, on the front (northeast) has square wood posts with wood railings and a wood floor. There are two concrete chimneys on the ridgeline, to either side of center. There is also a prominent, front-gabled dormer on the facade, clad in vinyl siding. The rear (southwest) facing elevation includes a partial-width, one-story, open porch with a shed roof. The porch is supported by square wood columns, has wood railings, and is accessed by wood steps on the northwest side. There is also a shed roof wall dormer in the center of this elevation. Visible fenestration includes one-over-one, double-hung, vinyl windows with wood surrounds; a single-leaf wood door with a metal screen door; and a single-leaf wood door with one light and a metal and glass storm door.

Exterior Components

Component	Component Type	Material	Material Treatment
Chimneys	Interior Central	Concrete	Uncoursed
Dormer	Gable	Vinyl	No Data
Foundation	Solid/Continuous	Concrete	Block
Porch	1-Story Full-Width	Wood	Square
Structural System and Exterior Treatment	Wood Frame	Vinyl	Siding
Windows	Double-hung	Vinyl	No Data
Roof	Side Gable	Asphalt	No Data

Secondary Resource Information

Historic District Information

Historic District Name: No Data
Local Historic District Name: No Data
Historic District Significance: No Data

CRM Events

Event Type: Survey:Phase I/Reconnaissance

Project Review File Number: No Data
Investigator: Erin Que
Organization/Company: The 106 Group Ltd.
Photographic Media: Digital
Survey Date: 2/5/2020
Dhr Library Report Number: No Data

Project Staff/Notes:

Erin Que, Principal Investigator and Sr. Architectural Historian
 Holly Good, Architectural Historian
 Saleh Miller, Sr. Architectural Historian

Project Bibliographic Information:

City of Charlottesville GIS Viewer
 2020 Property Record. Electronic document, <http://gisweb.charlottesville.org/GisViewer/>, accessed January 27, 2020.

Hill Directory Co.
 1931, 1940, 1950, 1959 Hill's Charlottesville City Directory. Hill Directory Co., Inc., Publishers, Richmond, Virginia.

National Environmental Title Research, LLC [NETR]
 1963-2016 Historical Aerial Photograph, Charlottesville Independent City, Virginia. Electronic document, <http://historicaerials.com/>, accessed March 19, 2020.

Neighborhood Development Services
2012-2016 The 10th and Page Historic Survey. On file at the City of Charlottesville Neighborhood Development Services, Charlottesville, Virginia.

Sanborn Map Company
1907, 1913, 1920, 1929, 1950 Fire Insurance Map of Charlottesville, Virginia. Sanborn Map Company, New York, New York.

United States Geological Survey [USGS]
1994-2019 Historical Aerial Photograph, Charlottesville Independent City, Virginia. Electronic document, accessed on Google Earth, February 20, 2020.

Bibliographic Information

Bibliography:

No Data

Property Notes:

No Data

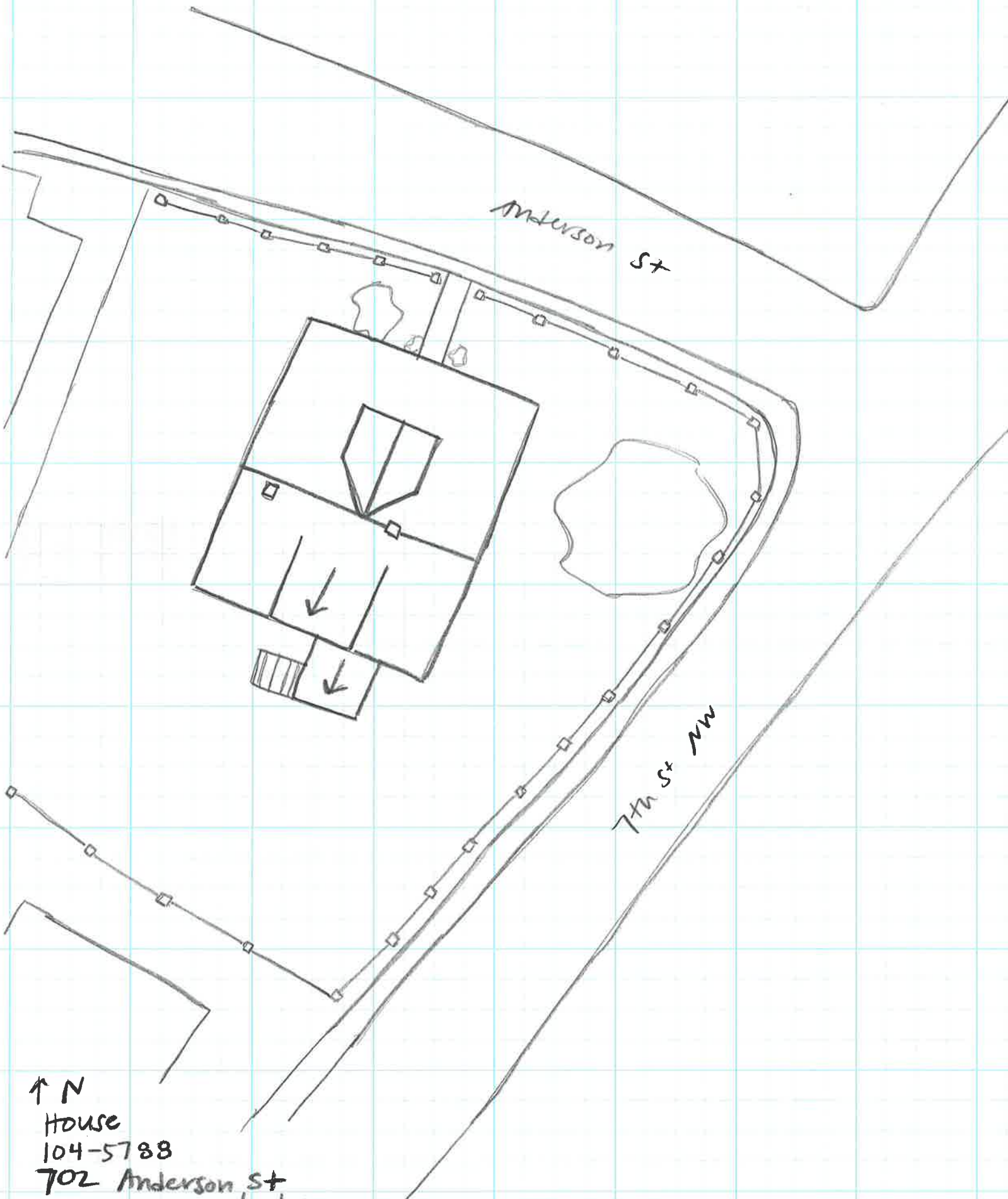

Anderson St

7th St NW

↑ N
House
104-5788
702 Anderson St
Survey Date 1/31/20
Not to Scale