

Property Information

Property Names

| Name Explanation | Name |
|-------------------|----------------------------|
| Function/Location | House, 703 Anderson Street |

Property Evaluation Status

Property Addresses

Current - 703 Anderson Street

| | |
|-----------------------------|-----------------------------|
| County/Independent City(s): | Charlottesville (Ind. City) |
| Incorporated Town(s): | No Data |
| Zip Code(s): | 22903 |
| Magisterial District(s): | No Data |
| Tax Parcel(s): | No Data |
| USGS Quad(s): | CHARLOTTESVILLE EAST |

Additional Property Information

Architecture Setting: Urban

Acreage: No Data

Site Description:

January 2020: This one-story house is located on the north side of Anderson Street, just west of 7th Street NW. There is a low concrete block retaining wall along the southwest property line, topped by a metal, chain link fence that extends around the whole property. There are small shrubs and trees dotted throughout the property. This property has a shed in the east corner, and a carport in the north corner, accessed by an alleyway off of 7th Street NW. This property consists of a house, a shed, and a carport.

Surveyor Assessment:

January 2020: According to Charlottesville City Property Records, this house was constructed in 1955 (City of Charlottesville GIS Viewer 2020). This build date is supported by aerial photographs, and the house does not appear on the 1950 Sanborn Map (Sanborn Map Company 1950; NETR 1963). The shed in the northeast corner of the lot was constructed in 2010 (USGS 2009; USGS 2011). The carport in the northwest corner of the lot was constructed prior to 1994, though the exact date is difficult to see on aerial photographs (USGS 1994; NETR 1968).

This property retains good integrity of location and setting. The integrity of design, materials, and workmanship has been compromised by replacement cladding on the rear wing, replacement windows. This property retains excellent integrity of feeling and association. Overall, this property retains good integrity.

This property is recommended as not individually eligible for listing in the NRHP due to a lack of historical significance. However, it is located in the potential 10th & Page Historic District, which is recommended as potentially eligible for listing in the NRHP. Further study is recommended to determine if the 10th & Page Historic District is eligible for listing in the NRHP under Criterion A in the areas of Ethnic Heritage, Community Planning and Development, and Social History, and under Criterion C in the area of Architecture. This property includes one contributing primary resource and two non-contributing secondary resources.

Surveyor Recommendation: Recommended Not Eligible

Ownership

| Ownership Category | Ownership Entity |
|--------------------|------------------|
| Private | No Data |

Primary Resource Information

| | |
|-----------------------|--------------------------------|
| Resource Category: | Domestic |
| Resource Type: | Single Dwelling |
| NR Resource Type: | Building |
| Date of Construction: | 1955 |
| Date Source: | Local Records |
| Historic Time Period: | The New Dominion (1946 - 1991) |
| Historic Context(s): | Domestic |
| Other ID Number: | No Data |
| Architectural Style: | Minimal Traditional |
| Form: | Square |

Number of Stories: 1.0
Condition: Good
Threats to Resource: None Known

Architectural Description:

January 2020: This one-story house sits on an exposed concrete block foundation, is constructed of concrete block with brick quoins, and has a side-gabled roof with a rear, one-story, shed-roof wing to the northeast (rear). There is an interior brick and concrete block chimney on the southwest roof slope. There is a front-facing gable projection on the southwest-facing façade in the east end. In the west end, the facade features a partial-width, engaged, wood porch with a shed roof and canvas rolled screens. This porch roof is supported by turned wood columns. The porch sits on a concrete block foundation, has wood railings, and is accessed by concrete steps. The rear wing is clad in vinyl siding. Visible fenestration includes one-over-one, double-hung, vinyl windows; a fixed, vinyl picture window flanked by one-over-one, double-hung, vinyl windows; a double-leaf wood door with large lights; and a nine-light, single-leaf, wood door with a metal and glass storm door.

Exterior Components

| Component | Component Type | Material | Material Treatment |
|--|------------------|----------|--------------------|
| Chimneys | Interior End | Concrete | Block |
| Foundation | Solid/Continuous | Concrete | Block |
| Porch | Inset/Engaged | Wood | Turned |
| Structural System and Exterior Treatment | Masonry | Concrete | Block |
| Windows | Double-hung | Vinyl | No Data |
| Roof | Side Gable | Asphalt | No Data |

Secondary Resource Information

Secondary Resource #1

Resource Category: Domestic
Resource Type: Shed
NR Resource Type: Building
Date of Construction: ca 2010
Date Source: Map
Historic Time Period: Post Cold War (1992 - Present)
Historic Context(s): Domestic
Other ID Number: No Data
Architectural Style: No discernible style
Form: Square
Number of Stories: 1.0
Condition: Good
Threats to Resource: None Known

Architectural Description:

January 2020: There is a one-story shed in the east corner of the lot. It sits on a rough, concrete block foundation, is clad in plywood panels, and has a front-gabled roof covered in asphalt shingles. There is no visible fenestration.

Exterior Components

| Component | Component Type | Material | Material Treatment |
|--|------------------|------------------------|--------------------|
| Foundation | Solid/Continuous | Concrete | Block |
| Structural System and Exterior Treatment | Wood Frame | Plywood/Particle Board | Panels |
| Roof | Front Gable | Asphalt | No Data |

Secondary Resource #2

Resource Category: Domestic
Resource Type: Carport
NR Resource Type: Structure
Date of Construction: ca 1990
Date Source: Map
Historic Time Period: The New Dominion (1946 - 1991)
Historic Context(s): Domestic
Other ID Number: No Data

Architectural Style: No discernible style
Form: Rectangular
Number of Stories: *No Data*
Condition: Good
Threats to Resource: None Known

Architectural Description:

January 2020: There is a carport located in the north corner of this property. It is supported by square wood posts, has a front-gabled roof covered in asphalt shingles. The gable ends are clad in vinyl siding. There is no visible fenestration and it is an open structure with screen covers.

Historic District Information

Historic District Name: *No Data*
Local Historic District Name: *No Data*
Historic District Significance: *No Data*

CRM Events

Event Type: Survey:Phase I/Reconnaissance

Project Review File Number: *No Data*
Investigator: Erin Que
Organization/Company: The 106 Group Ltd.
Photographic Media: Digital
Survey Date: 2/5/2020
Dhr Library Report Number: *No Data*

Project Staff/Notes:

Erin Que, Principal Investigator and Sr. Architectural Historian
Holly Good, Architectural Historian
Saleh Miller, Sr. Architectural Historian

Project Bibliographic Information:

City of Charlottesville GIS Viewer
2020 Property Record. Electronic document, <http://gisweb.charlottesville.org/GisViewer/>, accessed January 27, 2020.

Hill Directory Co.
1931, 1940, 1950, 1959 Hill's Charlottesville City Directory. Hill Directory Co., Inc., Publishers, Richmond, Virginia.

National Environmental Title Research, LLC [NETR]
1963-2016 Historical Aerial Photograph, Charlottesville Independent City, Virginia. Electronic document, <http://historicaerials.com/>, accessed March 19, 2020.

Neighborhood Development Services
2012-2016 The 10th and Page Historic Survey. On file at the City of Charlottesville Neighborhood Development Services, Charlottesville, Virginia.

Sanborn Map Company
1907, 1913, 1920, 1929, 1950 Fire Insurance Map of Charlottesville, Virginia. Sanborn Map Company, New York, New York.

United States Geological Survey [USGS]
1994-2019 Historical Aerial Photograph, Charlottesville Independent City, Virginia. Electronic document, accessed on Google Earth, February 20, 2020.

Bibliographic Information

Bibliography:

No Data

Property Notes:

No Data

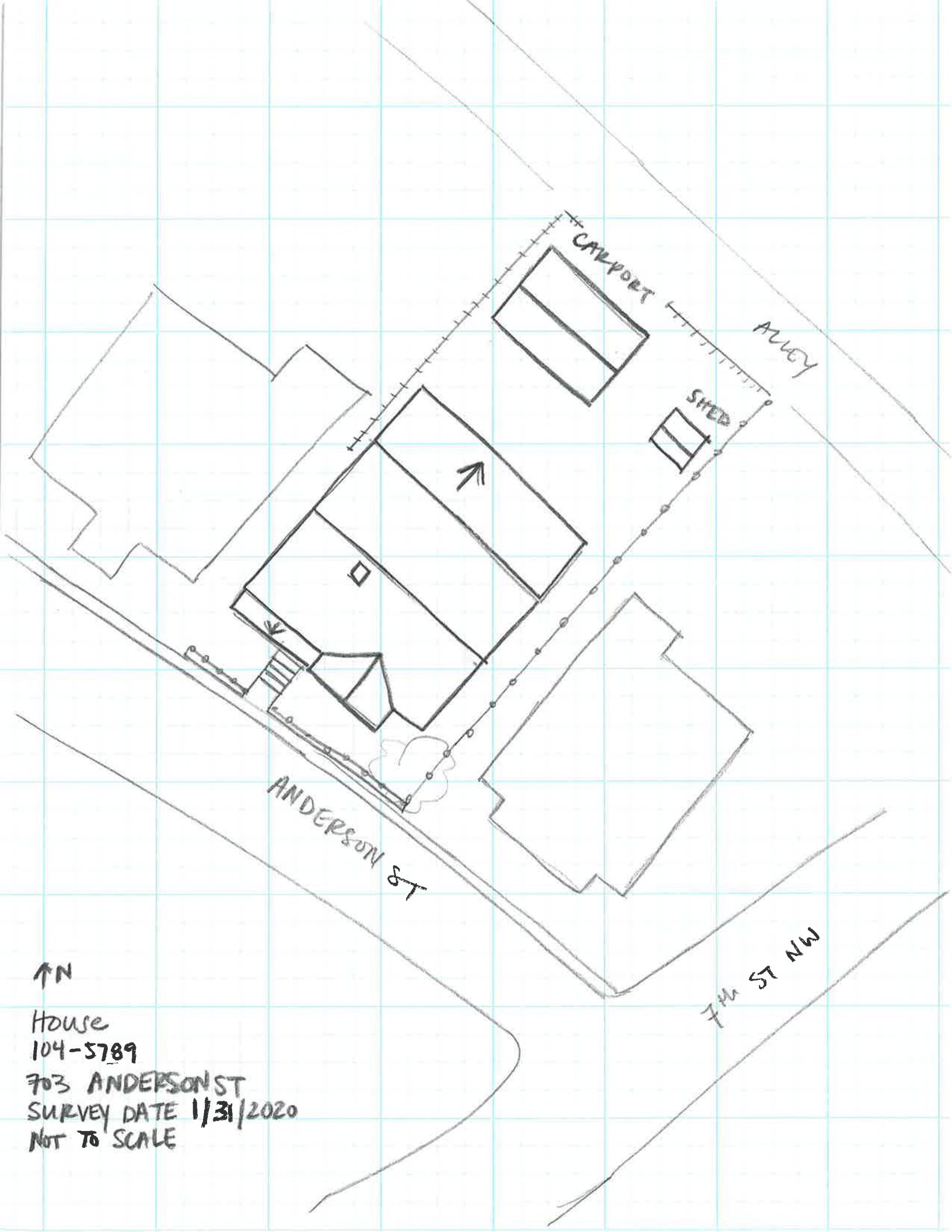

↑N

House
104-5789

703 ANDERSON ST
SURVEY DATE 1/31/2020
NOT TO SCALE