

### Property Information

#### Property Names

Name Explanation	Name
Function/Location	House, 801 Anderson Street

#### Property Evaluation Status

#### Property Addresses

Current - 801 Anderson Street

County/Independent City(s):	Charlottesville (Ind. City)
Incorporated Town(s):	No Data
Zip Code(s):	22903
Magisterial District(s):	No Data
Tax Parcel(s):	No Data
USGS Quad(s):	CHARLOTTESVILLE EAST

### Additional Property Information

Architecture Setting: Urban

Acreeage: No Data

#### Site Description:

January 2020: This one-and-a-half story house is located on the north corner of Anderson Street and 8th Street NW. There is extensive vegetation to the southwest of this property, obscuring that side of the building, as well as large deciduous trees in the front of the property and in the rear as well. The southwest (front) property line is lined by a low, concrete-block retaining wall, which extends around the southeast side of the lot. The rear is accessible through an alleyway off of 8th Street NW. This property consists of a house.

#### Surveyor Assessment:

January 2020: According to Charlottesville City Property Records, this property was constructed in 1925 and has been owned by the same family, the Morris family, since 1976 (Charlottesville City GIS Viewer 2020). However, the house first appears on the 1920 Sanborn Map with the same footprint it retains today, except with a wrap-around porch (Sanborn Map Company 1920). This porch appears to have been shortened to only a front porch in the early 1960s (NETR 1968). In the 1929 and 1950 Sanborn Maps, this property is accompanied by two small sheds in the northwest corner, both of which were demolished between 1950 and 1963 (Sanborn Map Company 1950; NETR 1963).

This property retains excellent integrity of location and setting. The integrity of design, materials, and workmanship has been compromised by replacement cladding. This property retains good integrity of feeling and association. Overall, this property retains good integrity.

This property is recommended as not individually eligible for listing in the NRHP due to a lack of historical significance. However, it is located in the potential 10th & Page Historic District, which is recommended as potentially eligible for listing in the NRHP. Further study is recommended to determine if the 10th & Page Historic District is eligible for listing in the NRHP under Criterion A in the areas of Ethnic Heritage, Community Planning and Development, and Social History, and under Criterion C in the area of Architecture. This property includes one contributing primary resource.

Surveyor Recommendation: Recommended Not Eligible

#### Ownership

Ownership Category	Ownership Entity
Private	No Data

### Primary Resource Information

Resource Category:	Domestic
Resource Type:	Single Dwelling
NR Resource Type:	Building
Date of Construction:	ca 1920
Date Source:	Map
Historic Time Period:	World War I to World War II (1917 - 1945)
Historic Context(s):	Domestic
Other ID Number:	No Data
Architectural Style:	Vernacular

**Form:** *No Data*  
**Number of Stories:** 1.5  
**Condition:** Good  
**Threats to Resource:** None Known

**Architectural Description:**

January 2020: This one-and-a-half-story house sits on a concrete block foundation, is clad in vinyl siding, and has a hipped roof covered in asphalt shingles. The front (southwest) facing façade features a hipped roof dormer clad in vinyl siding and a full-length, one-story, open porch with a shed roof. The porch also rests on a concrete block foundation, which is inhabitable as there are basement windows. The porch roof is covered in standing seam metal and supported by metal filigree columns. The porch has metal railings, and is accessed by concrete block steps. The southeast elevation also features a hipped dormer clad in vinyl siding. All visible windows on the first story have fixed wood shutters. There is a partial-width, one-story, shed-roof wing in the center of the northeast elevation. It contains a secondary entrance and is accessed by wood stairs with wood railings. Visible fenestration includes two-over-two, double-hung, wood windows, some with faux dividers and some with metal screens; one-over-one, double-hung, wood windows; and a single-leaf, wood door with a metal and glass screen door.

**Exterior Components**

Component	Component Type	Material	Material Treatment
Dormer	Hipped	Vinyl	<i>No Data</i>
Foundation	Solid/Continuous	Concrete	Block
Porch	1-Story Full-Width	Metal	Cast Metal Supports
Structural System and Exterior Treatment	Wood Frame	Vinyl	Siding
Windows	Double-hung	Wood	<i>No Data</i>
Roof	Hipped	Asphalt	<i>No Data</i>

**Secondary Resource Information**

**Historic District Information**

**Historic District Name:** *No Data*  
**Local Historic District Name:** *No Data*  
**Historic District Significance:** *No Data*

**CRM Events**

**Event Type: Survey:Phase I/Reconnaissance**

**Project Review File Number:** *No Data*  
**Investigator:** Erin Que  
**Organization/Company:** The 106 Group Ltd.  
**Photographic Media:** Digital  
**Survey Date:** 2/5/2020  
**Dhr Library Report Number:** *No Data*

**Project Staff/Notes:**

Erin Que, Principal Investigator and Sr. Architectural Historian  
 Holly Good, Architectural Historian  
 Saleh Miller, Sr. Architectural Historian

**Project Bibliographic Information:**

City of Charlottesville GIS Viewer  
 2020 Property Record. Electronic document, <http://gisweb.charlottesville.org/GisViewer/>, accessed January 27, 2020.

Hill Directory Co.  
 1931, 1940, 1950, 1959 Hill's Charlottesville City Directory. Hill Directory Co., Inc., Publishers, Richmond, Virginia.

National Environmental Title Research, LLC [NETR]  
 1963-2016 Historical Aerial Photograph, Charlottesville Independent City, Virginia. Electronic document, <http://historicaerials.com/>, accessed March 19, 2020.

Neighborhood Development Services

2012-2016 The 10th and Page Historic Survey. On file at the City of Charlottesville Neighborhood Development Services, Charlottesville, Virginia.

Sanborn Map Company  
1907, 1913, 1920, 1929, 1950 Fire Insurance Map of Charlottesville, Virginia. Sanborn Map Company, New York, New York.

United States Geological Survey [USGS]  
1994-2019 Historical Aerial Photograph, Charlottesville Independent City, Virginia. Electronic document, accessed on Google Earth, February 20, 2020.

### **Bibliographic Information**

**Bibliography:**

No Data

**Property Notes:**

No Data

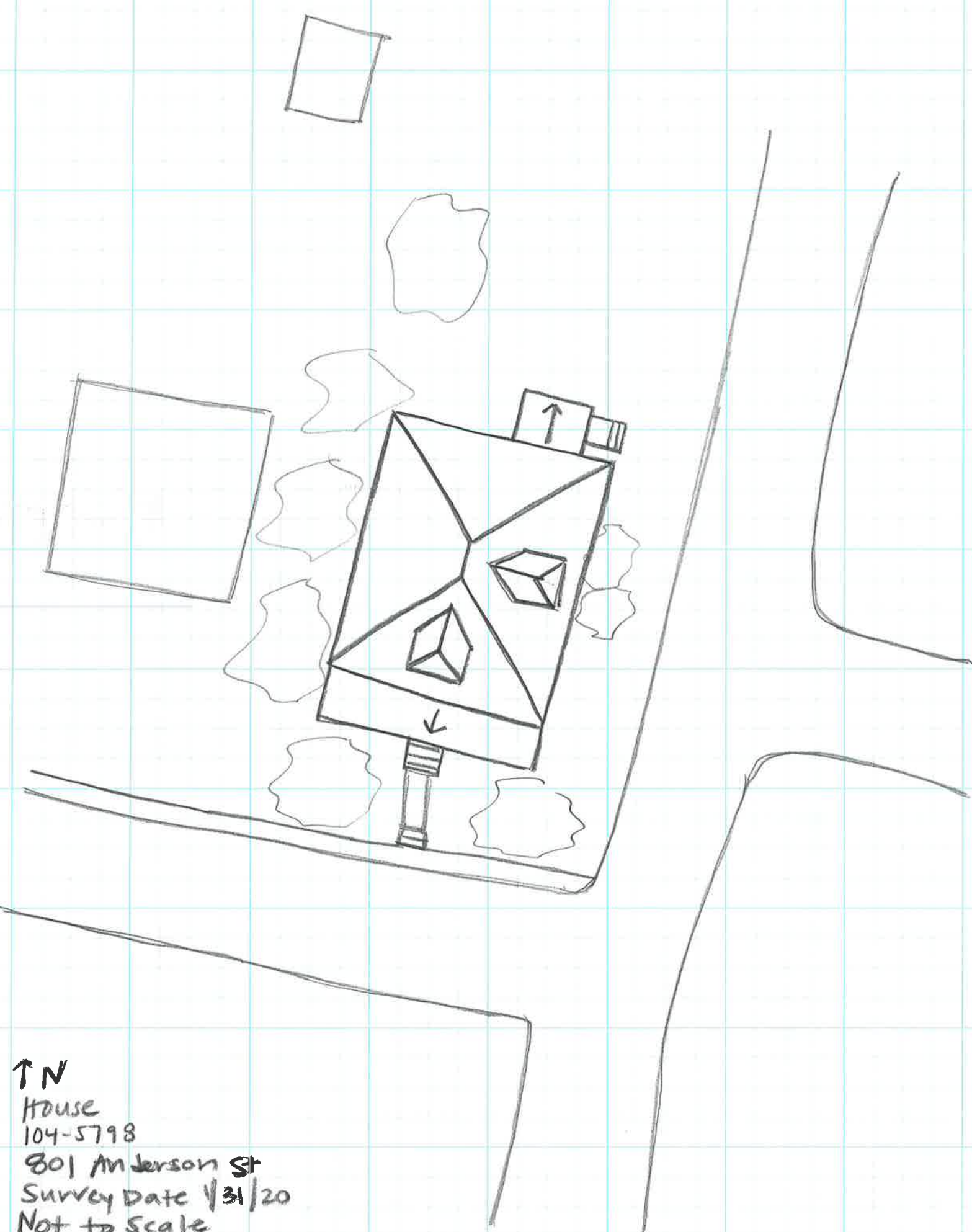

↑ N  
House  
104-5798  
801 Anderson St  
Survey Date 1/31/20  
Not to Scale