

Property Information

Property Names

Name Explanation	Name
Function/Location	House, 805 Anderson Street

Property Evaluation Status

Property Addresses

Current - 805 Anderson Street

County/Independent City(s):	Charlottesville (Ind. City)
Incorporated Town(s):	No Data
Zip Code(s):	22903
Magisterial District(s):	No Data
Tax Parcel(s):	No Data
USGS Quad(s):	CHARLOTTESVILLE EAST

Additional Property Information

Architecture Setting: Urban

Acreage: No Data

Site Description:

January 2020: This one-and-a-half-story house is located on the north side of Anderson Street, west of 8th Street NW. The house is sited at a significantly higher elevation than street level. The southwest (front) property line has a low brick retaining wall that continues along the adjacent properties. The house is accessed by a curving concrete sidewalk with periodic brick steps. The rear and southeast side of the property are dotted with large, deciduous trees and sheds. This property consists of a house.

Surveyor Assessment:

January 2020: According to Charlottesville City Property Records, this house was constructed in 1940 has been owned by the Byers family since it was constructed (City of Charlottesville GIS Viewer 2020; Hill Directory Co. 1931; Hill Directory Co. 1959). The house first appears on the 1950 Sanborn Map with an open porch on the southeast facing elevation, and no rear addition (Sanborn Map Company 1950). This porch was enclosed, and the rear addition added sometime before 1963 (Sanborn Map Company 1950; NETR 1963; USGS 2017).

This property retains excellent integrity of location and setting. The integrity of design, materials, and workmanship has been compromised by replacement windows. This property retains excellent integrity of feeling and association. Overall, this property retains good integrity.

This property is recommended as not individually eligible for listing in the NRHP due to a lack of historical significance. However, it is located in the potential 10th & Page Historic District, which is recommended as potentially eligible for listing in the NRHP. Further study is recommended to determine if the 10th & Page Historic District is eligible for listing in the NRHP under Criterion A in the areas of Ethnic Heritage, Community Planning and Development, and Social History, and under Criterion C in the area of Architecture. This property includes one contributing primary resource.

Surveyor Recommendation: Recommended Not Eligible

Ownership

Ownership Category	Ownership Entity
Private	No Data

Primary Resource Information

Resource Category:	Domestic
Resource Type:	Single Dwelling
NR Resource Type:	Building
Date of Construction:	1940
Date Source:	Local Records
Historic Time Period:	World War I to World War II (1917 - 1945)
Historic Context(s):	Domestic
Other ID Number:	No Data
Architectural Style:	Colonial Revival
Form:	Cape Cod

Number of Stories: 1.5
Condition: Good
Threats to Resource: None Known

Architectural Description:

January 2020: This one-and-a-half-story house is clad in stretcher-bond brick, and has a side-gabled roof covered in asphalt shingles. There is an exterior brick chimney on the southeast elevation at the ridgeline. The front (southwest) facing façade includes a brick stoop with metal railings at the main entrance in the middle of the façade. The two first-story windows have jack brick lintels with center concrete keystones. There are also two front-gabled dormers clad in aluminum siding on this facade. The southeast elevation includes a one-story, partial-width, hipped roof sunroom. It features jalousied windows and has long, metal shed roof awnings on all sides. The rear (northeast) facing elevation features an almost full-width shed roof dormer clad in aluminum on the northeast roof slope. On the first story, there is a brick-clad, hipped roof wing at the southeast end. In the middle of the northeast elevation, there is a two-story wing that connects to the shed roof dormer. This wing has a front-gabled roof and is clad in aluminum siding. The first story of this wing contains a garage (USGS 2017). Visible fenestration includes eight-over-eight, double-hung, wood windows with fixed wood shutters; six-over-six, double-hung, vinyl windows, some with metal storm windows; metal jalousied windows; and a single-leaf, wood door with a metal and glass storm door and a decorative door surround.

Exterior Components

Component	Component Type	Material	Material Treatment
Chimneys	Exterior End	Brick	Stretcher Bond
Dormer	Gable	Aluminum	No Data
Porch	Stoop/Deck	Brick	Not Visible
Structural System and Exterior Treatment	Unknown	Brick	Stretcher Bond
Windows	Double-hung	Vinyl	No Data
Roof	Side Gable	Asphalt	No Data

Secondary Resource Information

Historic District Information

Historic District Name: No Data
Local Historic District Name: No Data
Historic District Significance: No Data

CRM Events

Event Type: Survey:Phase I/Reconnaissance

Project Review File Number: No Data
Investigator: Erin Que
Organization/Company: The 106 Group Ltd.
Photographic Media: Digital
Survey Date: 2/5/2020
Dhr Library Report Number: No Data

Project Staff/Notes:

Erin Que, Principal Investigator and Sr. Architectural Historian
 Holly Good, Architectural Historian
 Saleh Miller, Sr. Architectural Historian

Project Bibliographic Information:

City of Charlottesville GIS Viewer
 2020 Property Record. Electronic document, <http://gisweb.charlottesville.org/GisViewer/>, accessed January 27, 2020.

Hill Directory Co.
 1931, 1940, 1950, 1959 Hill's Charlottesville City Directory. Hill Directory Co., Inc., Publishers, Richmond, Virginia.

National Environmental Title Research, LLC [NETR]
 1963-2016 Historical Aerial Photograph, Charlottesville Independent City, Virginia. Electronic document, <http://historicaerials.com/>, accessed March 19, 2020.

Neighborhood Development Services
2012-2016 The 10th and Page Historic Survey. On file at the City of Charlottesville Neighborhood Development Services, Charlottesville, Virginia.

Sanborn Map Company
1907, 1913, 1920, 1929, 1950 Fire Insurance Map of Charlottesville, Virginia. Sanborn Map Company, New York, New York.

United States Geological Survey [USGS]
1994-2019 Historical Aerial Photograph, Charlottesville Independent City, Virginia. Electronic document, accessed on Google Earth, February 20, 2020.

Bibliographic Information

Bibliography:

No Data

Property Notes:

No Data

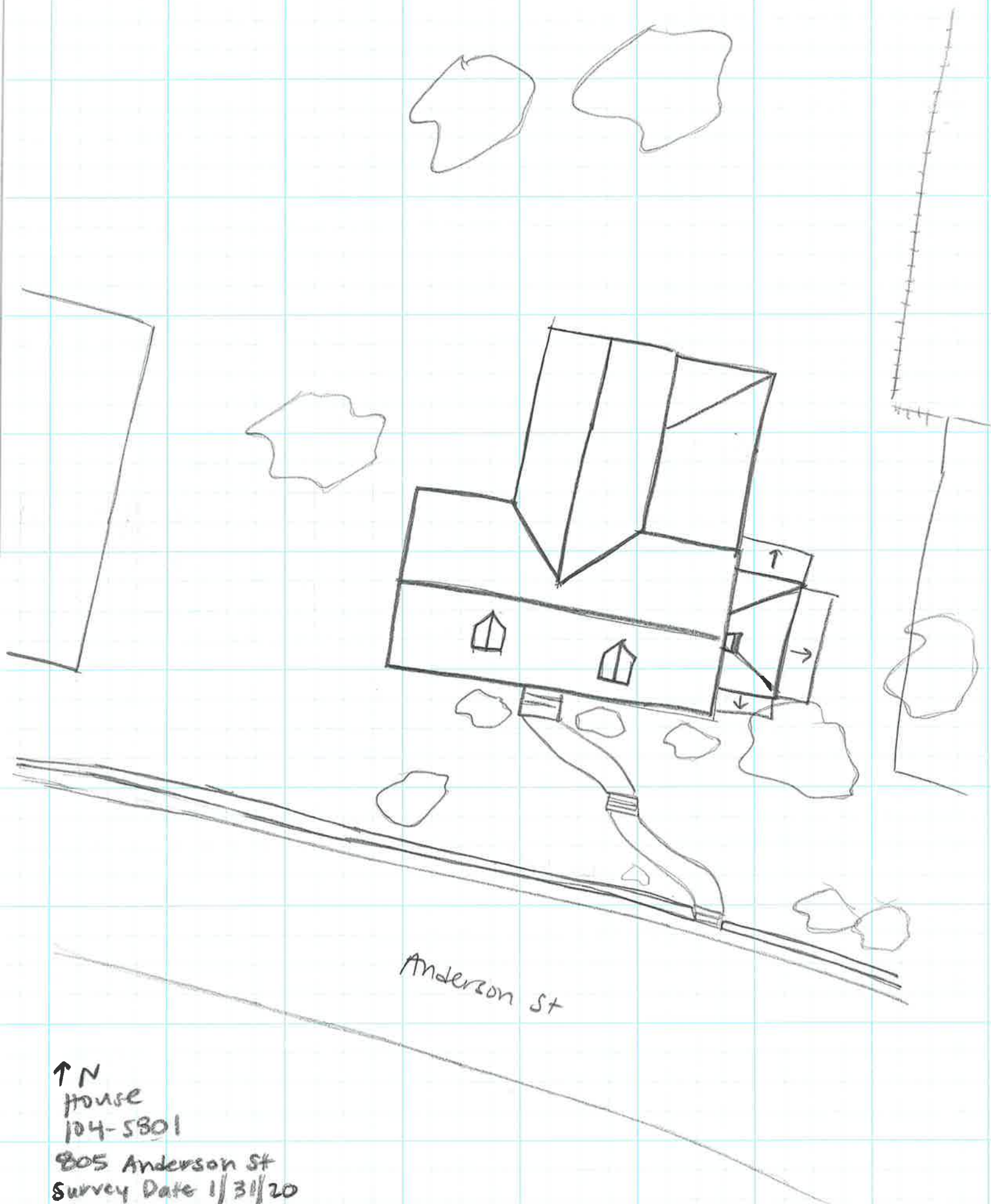

↑ N
House
104-5801

805 Anderson St
Survey Date 1/31/20
Not to Scale