

Property Information

Property Names

Name Explanation	Name
Function/Location	House, 808 Anderson Street

Property Evaluation Status

Property Addresses

Current - 808 Anderson Street

County/Independent City(s):	Charlottesville (Ind. City)
Incorporated Town(s):	No Data
Zip Code(s):	22903
Magisterial District(s):	No Data
Tax Parcel(s):	No Data
USGS Quad(s):	CHARLOTTESVILLE EAST

Additional Property Information

Architecture Setting: Urban

Acreage: No Data

Site Description:

January 2020: This two-story house is located on the south side of Anderson Street, west of 8th Street NW. There is a low, concrete-block retaining wall along the northeast property line. This is topped by a row of box hedges. There are large, deciduous trees throughout the rear of the lot. There is a tall wood fence along the northwest property line. This property consists of a house.

Surveyor Assessment:

January 2020: According to Charlottesville City Property Records, this house was constructed in 1925 (City of Charlottesville GIS Viewer 2020). This property first appeared on the 1929 Sanborn Map as 806 Anderson Street, and maintained the same footprint into the 1950 Sanborn Map and today (Sanborn Map Company 1929; Sanborn Map Company 1950; USGS 2017). The adjacent house to the west, 810 Anderson Street, was demolished in the 1990s and rebuilt in 2000 (NETR 1968; NETR 1994; USGS 1994; USGS 2003; City of Charlottesville GIS Viewer 2020).

This property retains good integrity of location and setting, with the setting compromised by the demolition and reconstruction of the house to the west. The integrity of design, materials, and workmanship has been compromised by replacement windows. This property retains excellent integrity of feeling and association. Overall, this property retains good integrity.

This property is recommended as not individually eligible for listing in the NRHP due to a lack of historical significance. However, it is located in the potential 10th & Page Historic District, which is recommended as potentially eligible for listing in the NRHP. Further study is recommended to determine if the 10th & Page Historic District is eligible for listing in the NRHP under Criterion A in the areas of Ethnic Heritage, Community Planning and Development, and Social History, and under Criterion C in the area of Architecture. This property includes one contributing primary resource.

Surveyor Recommendation: Recommended Not Eligible

Ownership

Ownership Category	Ownership Entity
Private	No Data

Primary Resource Information

Resource Category:	Domestic
Resource Type:	Single Dwelling
NR Resource Type:	Building
Date of Construction:	1925
Date Source:	Local Records
Historic Time Period:	World War I to World War II (1917 - 1945)
Historic Context(s):	Domestic
Other ID Number:	No Data
Architectural Style:	Vernacular
Form:	Rectangular

Number of Stories: 2.0
Condition: Good
Threats to Resource: None Known

Architectural Description:

January 2020: This two-story house rests on a stuccoed foundation, is clad in stucco, and has a side-gabled roof with a central front-gable covered in asphalt shingles. There is an interior brick chimney on the southeast roof slope. The front (northeast) facing façade includes a full-width, one-story, open porch with a hipped roof. The porch roof is supported by square wood columns and the porch has wood railings. There is wood latticework at the top surrounding the porch. The rear (southwest) facing elevation includes a full-width, one-story, front-gabled wing. Visible fenestration includes two-over-two, double-hung, wood windows with metal storm windows; two-over-two and one-over-one, double-hung, wood windows, some with metal storm windows; and a single-leaf, wood door with a metal and glass storm door.

Exterior Components

Component	Component Type	Material	Material Treatment
Chimneys	Interior Slope	Brick	Stretcher Bond
Foundation	Solid/Continuous	Unknown	Stuccoed/Parged
Porch	1-Story Full-Width	Wood	Square
Structural System and Exterior Treatment	Wood Frame	Unknown	Stuccoed
Windows	Double-hung	Wood	No Data
Roof	Gable w/Central Front Gable	Asphalt	No Data

Secondary Resource Information

Historic District Information

Historic District Name: No Data
Local Historic District Name: No Data
Historic District Significance: No Data

CRM Events

Event Type: Survey:Phase I/Reconnaissance

Project Review File Number: No Data
Investigator: Erin Que
Organization/Company: The 106 Group Ltd.
Photographic Media: Digital
Survey Date: 2/5/2020
Dhr Library Report Number: No Data

Project Staff/Notes:

Erin Que, Principal Investigator and Sr. Architectural Historian
 Holly Good, Architectural Historian
 Saleh Miller, Sr. Architectural Historian

Project Bibliographic Information:

City of Charlottesville GIS Viewer
 2020 Property Record. Electronic document, <http://gisweb.charlottesville.org/GisViewer/>, accessed January 27, 2020.

Hill Directory Co.
 1931, 1940, 1950, 1959 Hill's Charlottesville City Directory. Hill Directory Co., Inc., Publishers, Richmond, Virginia.

National Environmental Title Research, LLC [NETR]
 1963-2016 Historical Aerial Photograph, Charlottesville Independent City, Virginia. Electronic document, <http://historicaerials.com/>, accessed March 19, 2020.

Neighborhood Development Services
 2012-2016 The 10th and Page Historic Survey. On file at the City of Charlottesville Neighborhood Development Services, Charlottesville, Virginia.

Sanborn Map Company
1907, 1913, 1920, 1929, 1950 Fire Insurance Map of Charlottesville, Virginia. Sanborn Map Company, New York, New York.

United States Geological Survey [USGS]
1994-2019 Historical Aerial Photograph, Charlottesville Independent City, Virginia. Electronic document, accessed on Google Earth, February 20, 2020.

Bibliographic Information

Bibliography:

No Data

Property Notes:

No Data

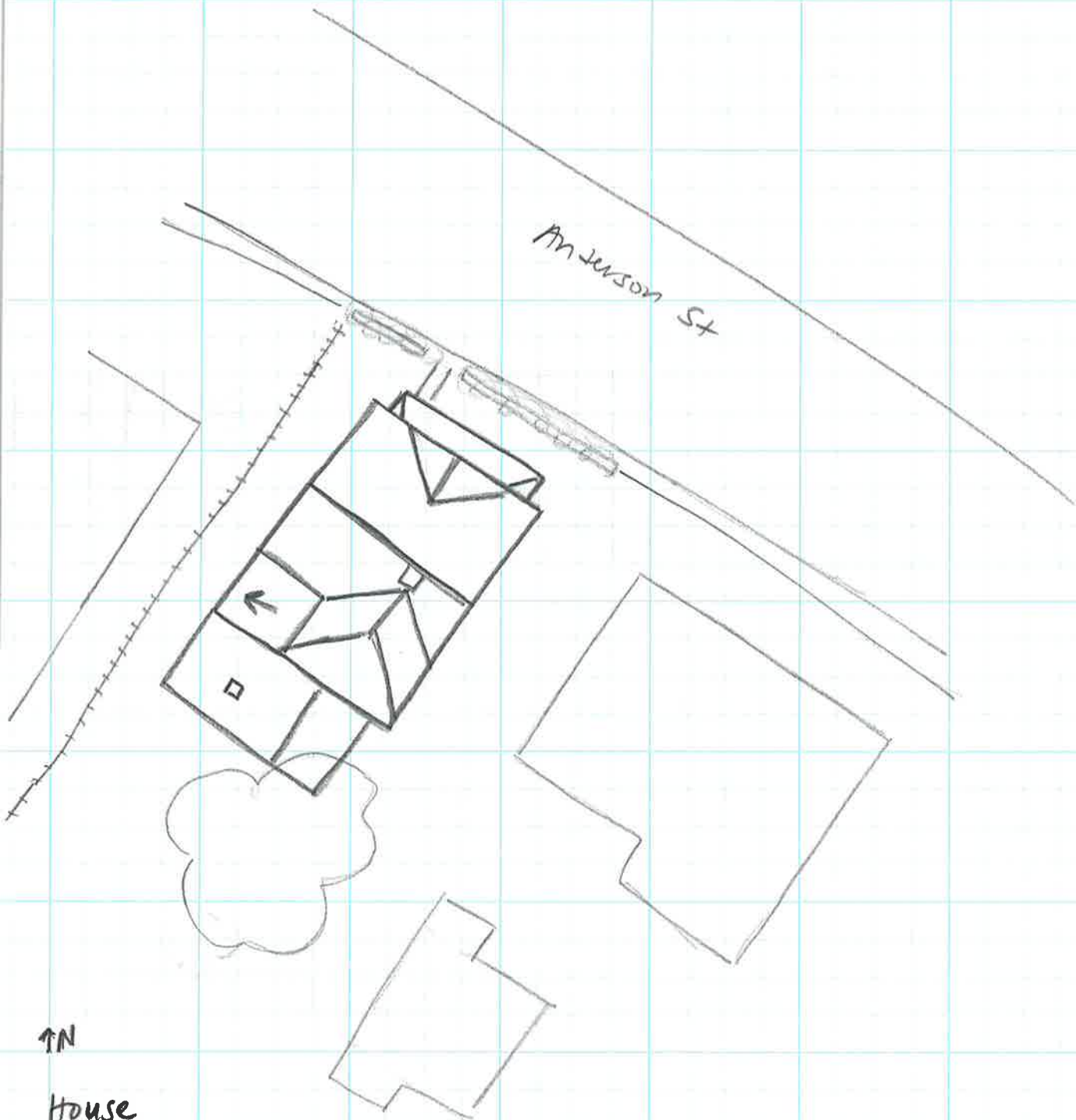

Anderson St

↑N

House
104-5802
808 ANDERSON ST
SURVEY DATE 1/31/2020
NOT TO SCALE