

Property Information

Property Names

Name Explanation	Name
Function/Location	House, 809 Anderson Street

Property Evaluation Status

Property Addresses

Current - 809 Anderson Street

County/Independent City(s):	Charlottesville (Ind. City)
Incorporated Town(s):	No Data
Zip Code(s):	22903
Magisterial District(s):	No Data
Tax Parcel(s):	No Data
USGS Quad(s):	CHARLOTTESVILLE EAST

Additional Property Information

Architecture Setting: Urban

Acreage: No Data

Site Description:

January 2020: This two-story house is located on the north side of Anderson Street, halfway between 8th and 9th Streets NW. A brick retaining wall runs along the front (southwest) property line and continues along the adjacent properties. There are large trees and bushes in both the front and the rear of the lot. This property consists of a house.

Surveyor Assessment:

January 2020: According to the Charlottesville City Property Records, this house was constructed in 1920 (City of Charlottesville GIS Viewer 2020). However, the house first appears on the 1920 Sanborn Map with the same footprint it maintains throughout the 1929 and 1950 Sanborn Maps, indicating it may have been constructed prior to 1920 (Sanborn Map Company 1920; Sanborn Map Company 1929; Sanborn Map Company 1950). These maps indicate that a rear porch on the southeast elevation was open in 1920, 1929, and 1950, but it was since enclosed at an unknown date (Sanborn Map Company 1920; Sanborn Map Company 1929; Sanborn Map Company 1950; USGS 2017). This property has been a multi-family dwelling since about 1950 (Hill Directory Co. 1950; City of Charlottesville GIS Viewer 2020).

This property retains good integrity of location and setting. The integrity of design, materials, and workmanship has been compromised by replacement windows, replacement cladding, and the enclosure of the rear porch. This property retains excellent integrity of feeling and association. Overall, this property retains good integrity.

This property is recommended as not individually eligible for listing in the NRHP due to a lack of historical significance. However, it is located in the potential 10th & Page Historic District, which is recommended as potentially eligible for listing in the NRHP. Further study is recommended to determine if the 10th & Page Historic District is eligible for listing in the NRHP under Criterion A in the areas of Ethnic Heritage, Community Planning and Development, and Social History, and under Criterion C in the area of Architecture. This property includes one contributing primary resource.

Surveyor Recommendation: Recommended Not Eligible

Ownership

Ownership Category	Ownership Entity
Private	No Data

Primary Resource Information

Resource Category:	Domestic
Resource Type:	Single Dwelling
NR Resource Type:	Building
Date of Construction:	ca 1920
Date Source:	Map
Historic Time Period:	World War I to World War II (1917 - 1945)
Historic Context(s):	Domestic
Other ID Number:	No Data
Architectural Style:	Folk Victorian

Form: Rectangular
Number of Stories: 2.0
Condition: Good
Threats to Resource: None Known

Architectural Description:

January 2020: This two-story house sits on a brick foundation, is clad in aluminum siding, and has a hipped roof with lower cross gables covered in asphalt shingles. The front-facing gable on the southwest façade projects slightly forward from the rest of the house. The façade also includes a full-length, one-story, open porch with a hipped roof covered with standing seam metal. The porch roof is supported by turned wood columns with gingerbread trim. The porch rests on brick piers, has turned wood railings, and is accessed by brick steps with brick railings. The main entrance is at the east end. All of the gable ends include decorated vergeboard and are clad in fish scale, wood shingles. There is a long, full-width, one-story front-gabled wing on the rear (northeast) elevation. The roof is covered in standing seam metal. This wing has an interior brick chimney on the ridgeline. The southeast elevation of this wing has a secondary entrance that is accessed by fieldstone steps. Visible fenestration includes one-over-one, double-hung, vinyl windows, some with metal screens; a vinyl picture window flanked by vinyl casement windows; a vinyl sliding window; a single-leaf wood door with a metal and glass storm door; and a single-leaf, wood door with a transom and sidelights, and a metal and glass storm door.

Exterior Components

Component	Component Type	Material	Material Treatment
Chimneys	Interior End	Brick	Stretcher Bond
Foundation	Solid/Continuous	Brick	Stretcher Bond
Porch	1-Story Full-Width	Wood	Turned
Structural System and Exterior Treatment	Wood Frame	Aluminum	Siding
Windows	Double-hung	Vinyl	No Data
Roof	Hipped w/Lower Cross Gables	Asphalt	No Data

Secondary Resource Information

Historic District Information

Historic District Name: No Data
Local Historic District Name: No Data
Historic District Significance: No Data

CRM Events

Event Type: Survey:Phase I/Reconnaissance

Project Review File Number: No Data
Investigator: Erin Que
Organization/Company: The 106 Group Ltd.
Photographic Media: Digital
Survey Date: 2/5/2020
Dhr Library Report Number: No Data

Project Staff/Notes:

Erin Que, Principal Investigator and Sr. Architectural Historian
 Holly Good, Architectural Historian
 Saleh Miller, Sr. Architectural Historian

Project Bibliographic Information:

City of Charlottesville GIS Viewer
 2020 Property Record. Electronic document, <http://gisweb.charlottesville.org/GisViewer/>, accessed January 27, 2020.

Hill Directory Co.
 1931, 1940, 1950, 1959 Hill's Charlottesville City Directory. Hill Directory Co., Inc., Publishers, Richmond, Virginia.

National Environmental Title Research, LLC [NETR]
 1963-2016 Historical Aerial Photograph, Charlottesville Independent City, Virginia. Electronic document, <http://historicaerials.com/>, accessed March 19, 2020.

Neighborhood Development Services
2012-2016 The 10th and Page Historic Survey. On file at the City of Charlottesville Neighborhood Development Services, Charlottesville, Virginia.

Sanborn Map Company
1907, 1913, 1920, 1929, 1950 Fire Insurance Map of Charlottesville, Virginia. Sanborn Map Company, New York, New York.

United States Geological Survey [USGS]
1994-2019 Historical Aerial Photograph, Charlottesville Independent City, Virginia. Electronic document, accessed on Google Earth, February 20, 2020.

Bibliographic Information

Bibliography:

No Data

Property Notes:

No Data

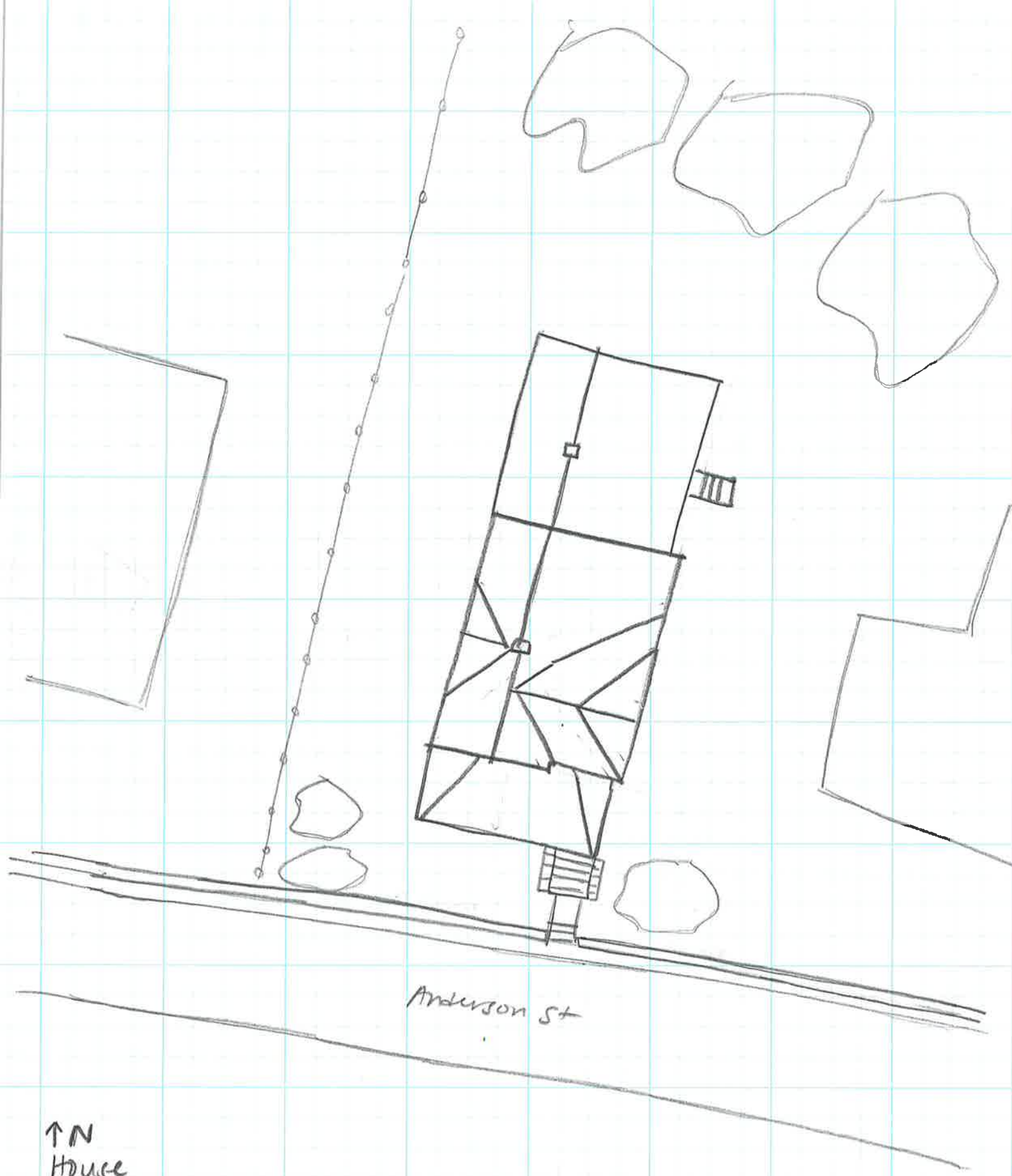

Anderson St

↑ N
House
104-5803
809 Anderson St
Survey Date 1/31/20
Not to Scale