

### Property Information

#### Property Names

Name Explanation	Name
Function/Location	House, 919 Anderson Street

#### Property Evaluation Status

#### Property Addresses

Current - 919 Anderson Street

County/Independent City(s):	Charlottesville (Ind. City)
Incorporated Town(s):	No Data
Zip Code(s):	22903
Magisterial District(s):	No Data
Tax Parcel(s):	No Data
USGS Quad(s):	CHARLOTTESVILLE EAST

### Additional Property Information

Architecture Setting: Urban

Acreage: No Data

#### Site Description:

January 2020: This two-story house is located on the north side of Anderson Street, between 10th and 9th Streets NW. The southwest property line is supported by a painted, concrete block retaining wall. Both sides of the property are lined with metal, chain-link fences with box hedges planted in them. There is a shed in the northeast corner of the lot. This property consists of a house and a shed.

#### Surveyor Assessment:

January 2020: According to the Charlottesville City Property Records, this house was constructed in 1925 (Charlottesville City GIS Viewer 2020). There is a house on the 1920 Sanborn Map with a similar footprint to this one, designated as 921 Anderson Street (Sanborn Map Company 1920). By the 1929 Sanborn Map, it was re-numbered as 919 Anderson Street, with a different rear building footprint, but the same central footprint (Sanborn Map Company 1929). This footprint remained the same through the 1950 Sanborn Map into today, and there is an open porch on the southeast elevation in the maps that was enclosed at an unknown date (Sanborn Map Company 1950; USGS 2008). There is also a rear deck, the construction date for which is unknown. The shed in the northeast corner of the property was constructed in 2010 (USGS 2009; USGS 2011).

This house was owned by the Coles family until 2004, originally owned by William Franklin Coles, son of Charles E. Coles of the Charles E. Coles and Sons construction company – one of the largest black construction companies in Charlottesville through the 1920s, until it closed after the Great Depression (Cross-White 1998:57).

This property retains excellent integrity of location and setting. The integrity of design, materials, and workmanship have been compromised through replacement windows, replacement cladding, concrete block porch steps, and the rear deck. This property retains excellent integrity of feeling and association. Overall, this property retains good integrity.

This property is recommended as potentially individually eligible for listing in the NRHP under Criterion B for its association with William Franklin Coles. Additionally, it is located in the potential 10th & Page Historic District, which is recommended as potentially eligible for listing in the NRHP. Further study is recommended to determine if the 10th & Page Historic District is eligible for listing in the NRHP under Criterion A in the areas of Ethnic Heritage, Community Planning and Development, and Social History, and under Criterion C in the area of Architecture. This property includes one contributing primary resource and one non-contributing secondary resource.

Surveyor Recommendation: Recommended Potentially Eligible

#### Ownership

Ownership Category	Ownership Entity
Private	No Data

### Primary Resource Information

Resource Category:	Domestic
Resource Type:	Single Dwelling
NR Resource Type:	Building
Date of Construction:	1925
Date Source:	Local Records
Historic Time Period:	World War I to World War II (1917 - 1945)

**Historic Context(s):** Domestic  
**Other ID Number:** *No Data*  
**Architectural Style:** Vernacular  
**Form:** Rectangular  
**Number of Stories:** 2.0  
**Condition:** Good  
**Threats to Resource:** None Known

**Architectural Description:**

January 2020: This two-story house sits on a stuccoed foundation, is clad in stucco, and has a cross-gabled roof covered in standing seam metal. The front (southwest) facing façade features a full-width, one-story, open porch with a hipped roof supported by turned wood columns with decorative brackets. The porch rests on a concrete block foundation. The front-facing gable on the façade projects forward away from the main block of the house. The main entrance to this house is located at the east end. The east corner of the house has a shed roof. In this corner, the second story hangs over the first story, which used to be an open porch (Sanborn Map Company 1950). The northeast elevation has a full-width, second-story wood deck, accessed by stairs at the southeast end. Visible fenestration includes two-over-two, double-hung, vinyl windows; two-over-two, double-hung, metal windows; and a single-leaf, wood door with a fanlight and a metal storm door.

**Exterior Components**

Component	Component Type	Material	Material Treatment
Foundation	Solid/Continuous	Unknown	Stuccoed/Parged
Porch	1-Story Full-Width	Wood	Turned
Structural System and Exterior Treatment	Wood Frame	Unknown	Stuccoed
Windows	Double-hung	Vinyl	<i>No Data</i>
Roof	Cross Gable	Metal	<i>No Data</i>

**Secondary Resource Information**

**Secondary Resource #1**

**Resource Category:** Domestic  
**Resource Type:** Shed  
**NR Resource Type:** Building  
**Date of Construction:** 2010  
**Date Source:** Map  
**Historic Time Period:** Post Cold War (1992 - Present)  
**Historic Context(s):** Domestic  
**Other ID Number:** *No Data*  
**Architectural Style:** No discernible style  
**Form:** *No Data*  
**Number of Stories:** 1.0  
**Condition:** Good  
**Threats to Resource:** None Known

**Architectural Description:**

January 2020: There is a one-story shed to the northeast of the house. It is clad in plywood and wood paneling and has a front-gabled roof covered in metal roofing. Visible fenestration includes two swing wood paneled doors; and a small swing wood door for ventilation.

**Exterior Components**

Component	Component Type	Material	Material Treatment
Structural System and Exterior Treatment	Wood Frame	Plywood/Particle Board	Panels
Roof	Front Gable	Metal	<i>No Data</i>

**Historic District Information**

**Historic District Name:** *No Data*  
**Local Historic District Name:** *No Data*  
**Historic District Significance:** *No Data*

## CRM Events

### Event Type: Survey:Phase I/Reconnaissance

**Project Review File Number:** *No Data*  
**Investigator:** Erin Que  
**Organization/Company:** The 106 Group Ltd.  
**Photographic Media:** Digital  
**Survey Date:** 2/5/2020  
**Dhr Library Report Number:** *No Data*

**Project Staff/Notes:**

Erin Que, Principal Investigator and Sr. Architectural Historian  
Holly Good, Architectural Historian  
Saleh Miller, Sr. Architectural Historian

**Project Bibliographic Information:**

City of Charlottesville GIS Viewer  
2020 Property Record. Electronic document, <http://gisweb.charlottesville.org/GisViewer/>, accessed January 27, 2020.

Hill Directory Co.  
1931, 1940, 1950, 1959 Hill's Charlottesville City Directory. Hill Directory Co., Inc., Publishers, Richmond, Virginia.

National Environmental Title Research, LLC [NETR]  
1963-2016 Historical Aerial Photograph, Charlottesville Independent City, Virginia. Electronic document, <http://historicaerials.com/>, accessed March 19, 2020.

Neighborhood Development Services  
2012-2016 The 10th and Page Historic Survey. On file at the City of Charlottesville Neighborhood Development Services, Charlottesville, Virginia.

Sanborn Map Company  
1907, 1913, 1920, 1929, 1950 Fire Insurance Map of Charlottesville, Virginia. Sanborn Map Company, New York, New York.

United States Geological Survey [USGS]  
1994-2019 Historical Aerial Photograph, Charlottesville Independent City, Virginia. Electronic document, accessed on Google Earth, February 20, 2020.

**Surveyor's NR Criteria Recommendations:**

B - Significant Individual from History

## Bibliographic Information

**Bibliography:**

Cross-White, Agnes  
1998 Images of America: Charlottesville, an African-American Community. Arcadia Publishing, Charleston, South Carolina.

**Property Notes:**

No Data

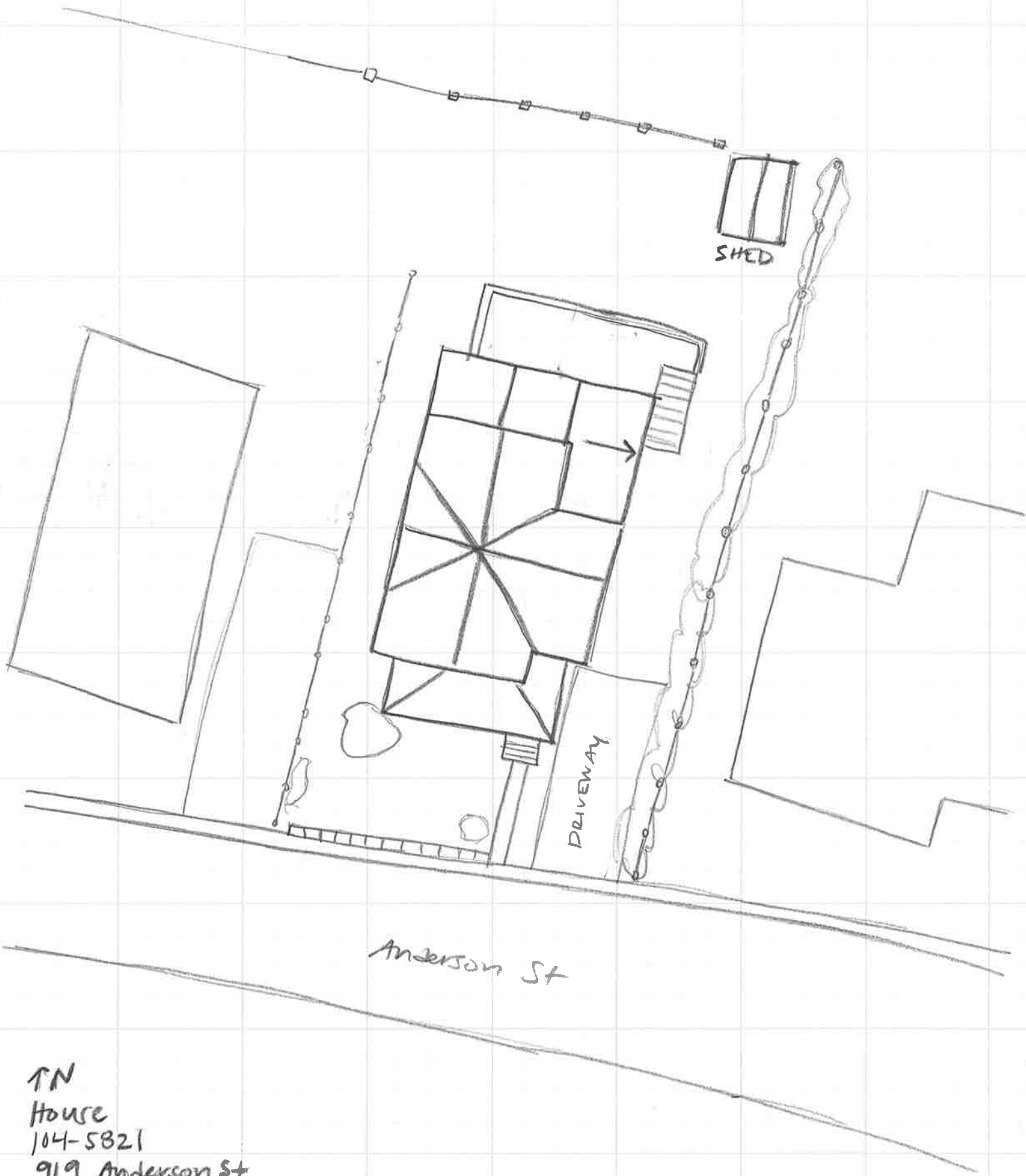

Anderson St

TN  
House  
104-5821  
919 Anderson St  
Survey Date 1/31/20  
Not to Scale