

Property Information

Property Names

Name Explanation	Name
Function/Location	House, 1307 Gordon Avenue

Property Evaluation Status

Property Addresses

Current - 1307 Gordon Avenue

County/Independent City(s):	Charlottesville (Ind. City)
Incorporated Town(s):	No Data
Zip Code(s):	22903
Magisterial District(s):	No Data
Tax Parcel(s):	No Data
USGS Quad(s):	CHARLOTTESVILLE EAST

Additional Property Information

Architecture Setting: Urban

Acreage: No Data

Site Description:

January 2020: This two-story house is located on the north side of Gordon Avenue. The site slopes downward slightly to the southeast. There are large trees in both corners of the front of the property, bushes near the front of the house, as well as large trees and box hedges along the rear property line. There is a gravel driveway along the southeast property line that leads to a parking area in the rear of the lot. There is a garage covered in vines in the northwest corner of the property. This property consists of a house and a garage.

Surveyor Assessment:

January 2020: According to Charlottesville City Property Records, this house was constructed in 1920 (City of Charlottesville GIS Viewer 2020). However, it does not appear on Sanborn Maps until 1950, indicating it was likely constructed between 1929 and 1950 (Sanborn Map Company 1929; Sanborn Map Company 1950). There is a garage on the 1950 Sanborn Map with the same footprint as the garage that still exists today, though it heavily covered with vines (Sanborn Map Company 1950; USGS 2017).

This property retains excellent integrity of location and setting. The integrity of design, materials, and workmanship for this property have been compromised by replacement windows and neglect of the rear, original garage and. This property retains good integrity of feeling and association. Overall, this property retains good integrity.

This property is recommended as not individually eligible for listing in the NRHP due to a lack of historical significance. However, it is located in the potential 10th & Page Historic District, which is recommended as potentially eligible for listing in the NRHP. Further study is recommended to determine if the 10th & Page Historic District is eligible for listing in the NRHP under Criterion A in the areas of Ethnic Heritage, Community Planning and Development, and Social History, and under Criterion C in the area of Architecture. This property includes one contributing primary resource and one contributing secondary resource.

Surveyor Recommendation: Recommended Not Eligible

Ownership

Ownership Category	Ownership Entity
Private	No Data

Primary Resource Information

Resource Category:	Domestic
Resource Type:	Single Dwelling
NR Resource Type:	Building
Date of Construction:	ca 1930
Date Source:	Map
Historic Time Period:	World War I to World War II (1917 - 1945)
Historic Context(s):	Domestic
Other ID Number:	No Data
Architectural Style:	Vernacular
Form:	No Data

Number of Stories: 2.0
Condition: Good
Threats to Resource: None Known

Architectural Description:

January 2020: This two-story house rests on a brick foundation, is clad in stretcher bond brick, and has a hipped roof covered with asphalt shingles. There is an exterior brick chimney on the northwest elevation. The east side of the southwest (front) facing façade features a partial-width, engaged, open, brick porch with a single square wood column and metal railings. The porch has a shed roof with a hipped dormer on the porch's roof. This dormer is clad in stucco. The front facade also features a two-story, brick wing on the west end of this facade with a hipped, asphalt shingled roof. The southeast elevation includes a secondary entrance covered by a hipped roof portico. Visible fenestration includes single-leaf, wood doors; one-over-one, double-hung, wood windows; six-over-one, double-hung, wood windows; one-over-one, double-hung, vinyl windows; and a metal storm door.

Exterior Components

Component	Component Type	Material	Material Treatment
Chimneys	Exterior End	Brick	Stretcher Bond
Dormer	Hipped	Stucco	No Data
Foundation	Solid/Continuous	Brick	Stretcher Bond
Porch	Inset/Engaged	Wood	Square
Structural System and Exterior Treatment	Masonry	Brick	Stretcher Bond
Windows	Double-hung	Wood	No Data
Roof	Hipped	Asphalt	No Data

Secondary Resource Information

Secondary Resource #1

Resource Category: Domestic
Resource Type: Garage
NR Resource Type: Building
Date of Construction: ca 1930
Date Source: Map
Historic Time Period: World War I to World War II (1917 - 1945)
Historic Context(s): Domestic
Other ID Number: No Data
Architectural Style: No discernible style
Form: Rectangular
Number of Stories: 1.0
Condition: Poor
Threats to Resource: None Known

Architectural Description:

January 2020: There is a one-story garage to the northwest of the property that is covered in ivy. The garage is of unknown material and is covered in vines.

Historic District Information

Historic District Name: No Data
Local Historic District Name: No Data
Historic District Significance: No Data

CRM Events

Event Type: Survey:Phase I/Reconnaissance

Project Review File Number: No Data

Investigator: Erin Que
Organization/Company: The 106 Group Ltd.
Photographic Media: Digital
Survey Date: 2/5/2020
Dhr Library Report Number: *No Data*

Project Staff/Notes:

Erin Que, Principal Investigator and Sr. Architectural Historian
Holly Good, Architectural Historian
Saleh Miller, Sr. Architectural Historian

Project Bibliographic Information:

City of Charlottesville GIS Viewer
2020 Property Record. Electronic document, <http://gisweb.charlottesville.org/GisViewer/>, accessed January 27, 2020.

Hill Directory Co.
1931, 1940, 1950, 1959 Hill's Charlottesville City Directory. Hill Directory Co., Inc., Publishers, Richmond, Virginia.

National Environmental Title Research, LLC [NETR]
1963-2016 Historical Aerial Photograph, Charlottesville Independent City, Virginia. Electronic document, <http://historicaerials.com/>, accessed March 19, 2020.

Neighborhood Development Services
2012-2016 The 10th and Page Historic Survey. On file at the City of Charlottesville Neighborhood Development Services, Charlottesville, Virginia.

Sanborn Map Company
1907, 1913, 1920, 1929, 1950 Fire Insurance Map of Charlottesville, Virginia. Sanborn Map Company, New York, New York.

United States Geological Survey [USGS]
1994-2019 Historical Aerial Photograph, Charlottesville Independent City, Virginia. Electronic document, accessed on Google Earth, February 20, 2020.

Bibliographic Information

Bibliography:

No Data

Property Notes:

No Data

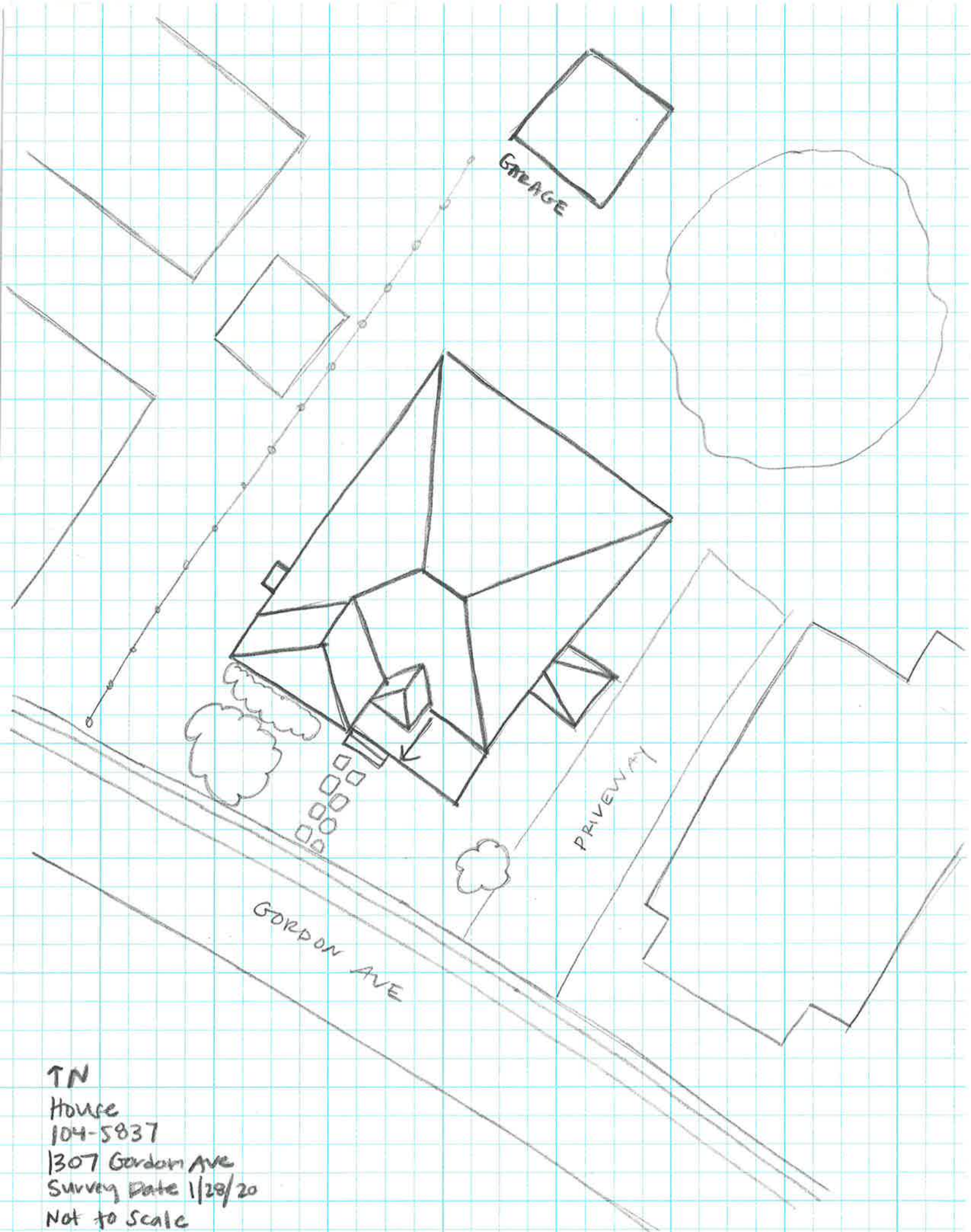

TN
House
104-5837
1307 Gordon Ave
Survey Date 1/28/20
Not to Scale